

DM. S. 147420, 118 339 S.E. Q4. 157th & MERIDIAN
 BASE LINE 64' SO. of SL ALLEY or 246' SO. SL. 157th ST.

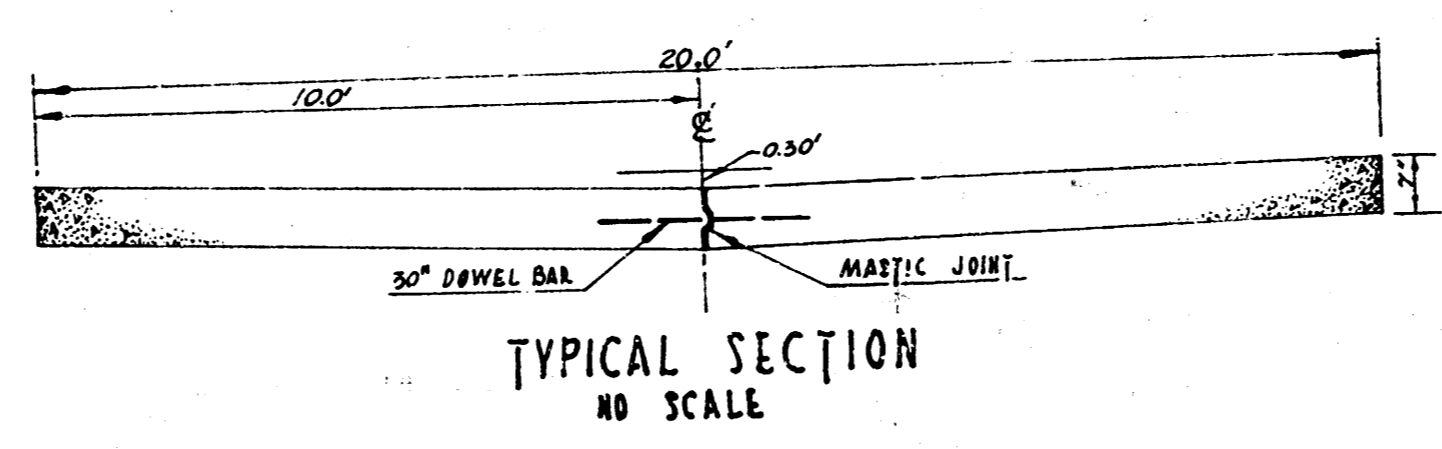

SCALE - 1" = 200'

NOTES:
 This plan shall be used only under the supervision of the engineer and shall not be used for any other purpose without the written consent of the engineer. The City of Wichita is not responsible for the accuracy of the data furnished by the contractor and inspection.

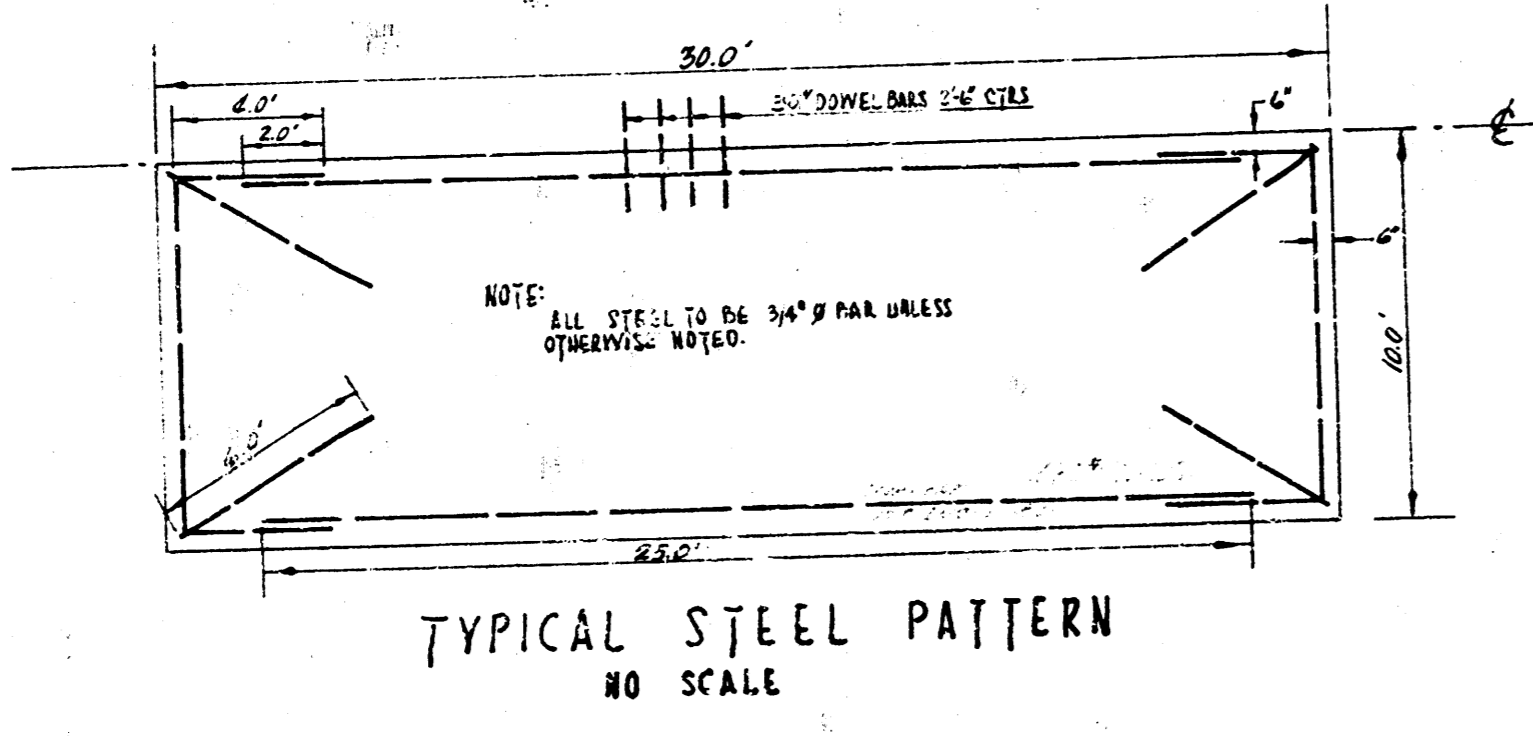
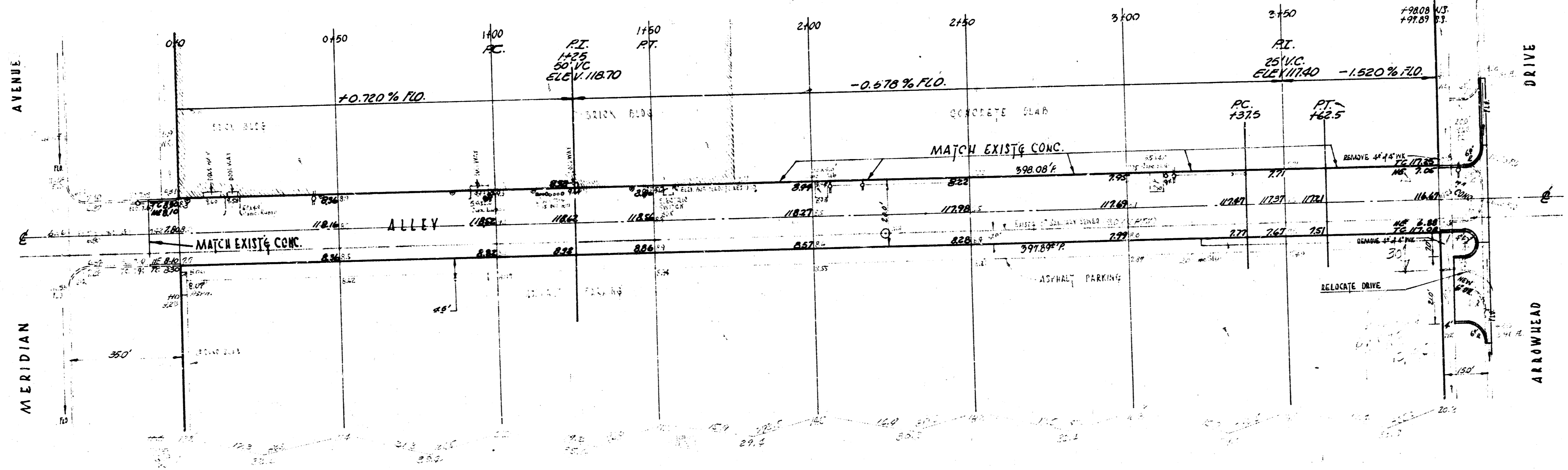

LIST OF QUANTITIES			
146.7	SQ. YDS.	1\"/>	
199.1	30 FT.	SEP. GUTTER	
265.9	CU. YDS.	EXCAVATION	
53.7	LINE FT.	SEP. CS.	
15.7	LINE FT.	SEP. CS.	
200	LINE FT.	COMP. CB. 4\"/>	
105.0	30 FT.	6\"/>	
138.0	30 FT.	DRIVE & WALK DEM.	
179	LINE FT.	C 3\"/>	
440	LB.	DL STEEL	
320	LB.	DOWEL STEEL	
400.0	LINE FT.	MASTIC JOINT	

ALLEY SOUTH OF THIRTEENTH STREET
 EL. MERIDIAN AVE - WL. ARROWHEAD DR.
 7\"/>
 CITY OF WICHITA, KANSAS
 B.E. SMITH CITY ENGINEER
 NOV. 1951 PRIVATE PROJECT

