

B.M. 108.32 IRON IN THIMBLE, & EVERETT & N.L. McCORMICK

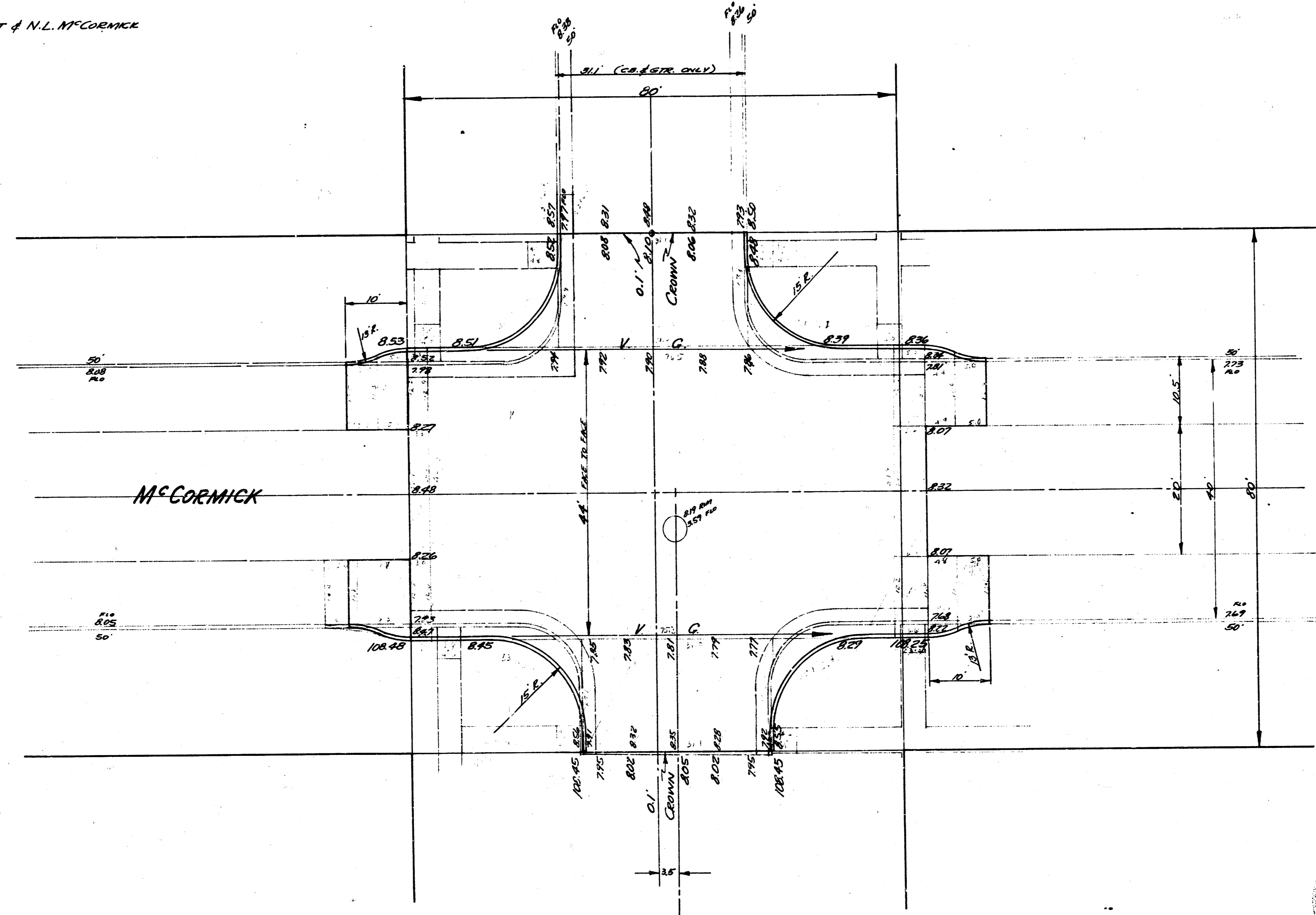

Survey done by  
GARY BRADY  
Plat No.  
City of Wichita

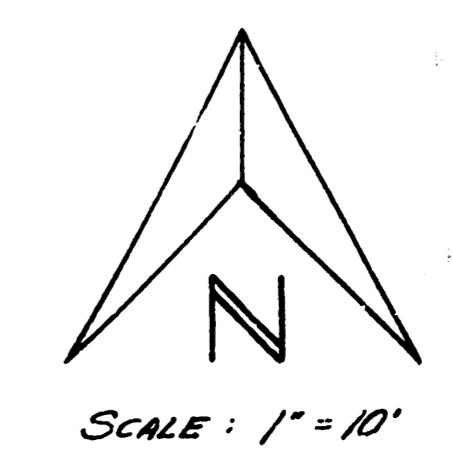

INTERSECTION OF  
McCORMICK & EVERETT  
7" CONC. - REPAVE  
CITY OF WICHITA, KANSAS  
B. E. SMITH - CITY ENGINEER  
MAY, 1954 GAS TAX REFUND

1 3 4 1