

Survey Made
Plan Below
City of Wichita
Kansas

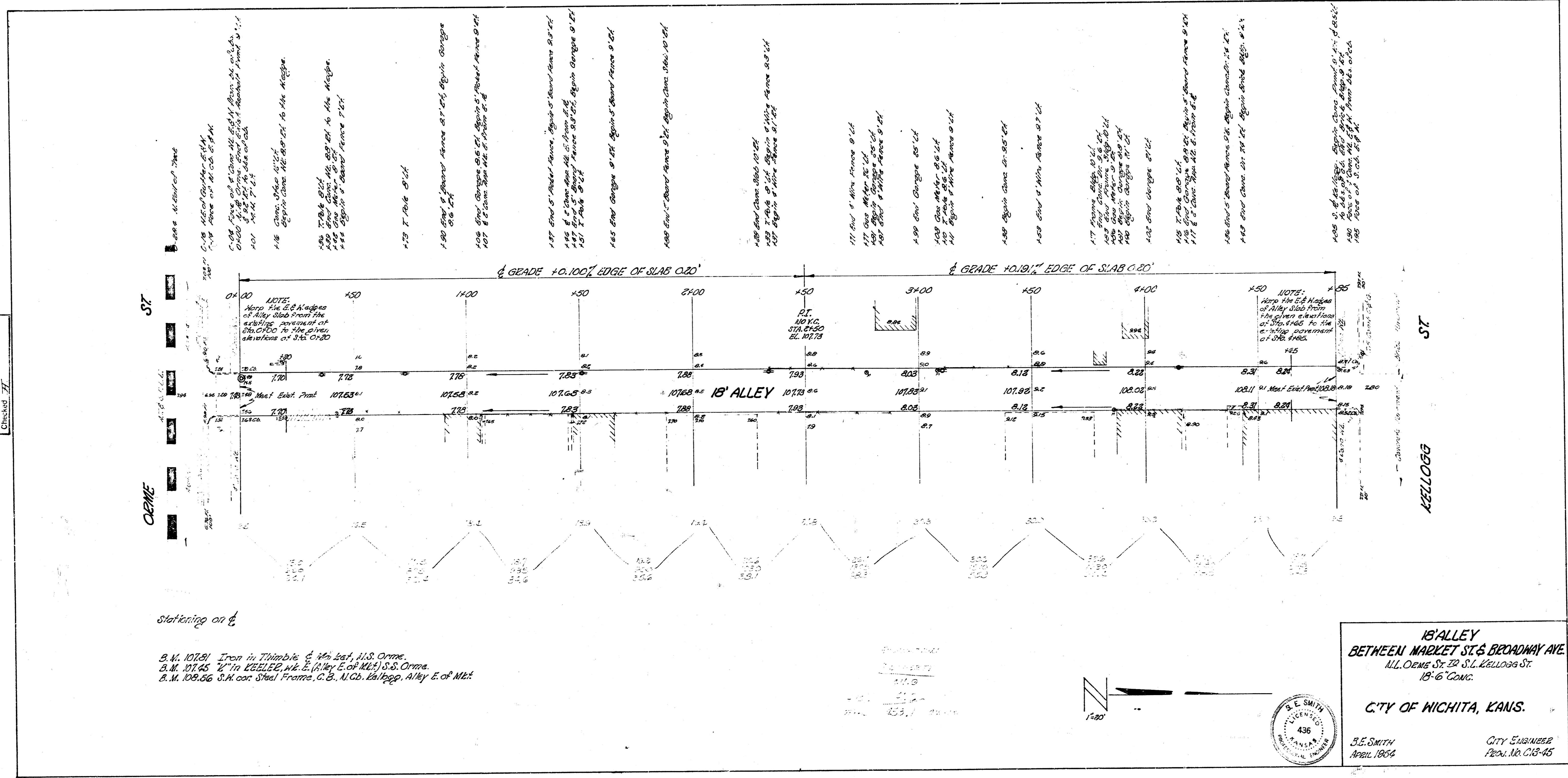

- 101 6" Water Main 10' Lt.
- 102 6" Sewer Main 10' Lt.
- 103 6" Gas Main 10' Lt.
- 104 6" Electric Main 10' Lt.
- 105 6" Water Main 10' Lt.
- 106 6" Sewer Main 10' Lt.
- 107 6" Gas Main 10' Lt.
- 108 6" Electric Main 10' Lt.
- 109 6" Water Main 10' Lt.
- 110 6" Sewer Main 10' Lt.
- 111 6" Gas Main 10' Lt.
- 112 6" Electric Main 10' Lt.
- 113 6" Water Main 10' Lt.
- 114 6" Sewer Main 10' Lt.
- 115 6" Gas Main 10' Lt.
- 116 6" Electric Main 10' Lt.
- 117 6" Water Main 10' Lt.
- 118 6" Sewer Main 10' Lt.
- 119 6" Gas Main 10' Lt.
- 120 6" Electric Main 10' Lt.
- 121 6" Water Main 10' Lt.
- 122 6" Sewer Main 10' Lt.
- 123 6" Gas Main 10' Lt.
- 124 6" Electric Main 10' Lt.
- 125 6" Water Main 10' Lt.
- 126 6" Sewer Main 10' Lt.
- 127 6" Gas Main 10' Lt.
- 128 6" Electric Main 10' Lt.
- 129 6" Water Main 10' Lt.
- 130 6" Sewer Main 10' Lt.
- 131 6" Gas Main 10' Lt.
- 132 6" Electric Main 10' Lt.
- 133 6" Water Main 10' Lt.
- 134 6" Sewer Main 10' Lt.
- 135 6" Gas Main 10' Lt.
- 136 6" Electric Main 10' Lt.
- 137 6" Water Main 10' Lt.
- 138 6" Sewer Main 10' Lt.
- 139 6" Gas Main 10' Lt.
- 140 6" Electric Main 10' Lt.
- 141 6" Water Main 10' Lt.
- 142 6" Sewer Main 10' Lt.
- 143 6" Gas Main 10' Lt.
- 144 6" Electric Main 10' Lt.
- 145 6" Water Main 10' Lt.
- 146 6" Sewer Main 10' Lt.
- 147 6" Gas Main 10' Lt.
- 148 6" Electric Main 10' Lt.
- 149 6" Water Main 10' Lt.
- 150 6" Sewer Main 10' Lt.
- 151 6" Gas Main 10' Lt.
- 152 6" Electric Main 10' Lt.
- 153 6" Water Main 10' Lt.
- 154 6" Sewer Main 10' Lt.
- 155 6" Gas Main 10' Lt.
- 156 6" Electric Main 10' Lt.
- 157 6" Water Main 10' Lt.
- 158 6" Sewer Main 10' Lt.
- 159 6" Gas Main 10' Lt.
- 160 6" Electric Main 10' Lt.
- 161 6" Water Main 10' Lt.
- 162 6" Sewer Main 10' Lt.
- 163 6" Gas Main 10' Lt.
- 164 6" Electric Main 10' Lt.
- 165 6" Water Main 10' Lt.
- 166 6" Sewer Main 10' Lt.
- 167 6" Gas Main 10' Lt.
- 168 6" Electric Main 10' Lt.
- 169 6" Water Main 10' Lt.
- 170 6" Sewer Main 10' Lt.
- 171 6" Gas Main 10' Lt.
- 172 6" Electric Main 10' Lt.
- 173 6" Water Main 10' Lt.
- 174 6" Sewer Main 10' Lt.
- 175 6" Gas Main 10' Lt.
- 176 6" Electric Main 10' Lt.
- 177 6" Water Main 10' Lt.
- 178 6" Sewer Main 10' Lt.
- 179 6" Gas Main 10' Lt.
- 180 6" Electric Main 10' Lt.
- 181 6" Water Main 10' Lt.
- 182 6" Sewer Main 10' Lt.
- 183 6" Gas Main 10' Lt.
- 184 6" Electric Main 10' Lt.
- 185 6" Water Main 10' Lt.
- 186 6" Sewer Main 10' Lt.
- 187 6" Gas Main 10' Lt.
- 188 6" Electric Main 10' Lt.
- 189 6" Water Main 10' Lt.
- 190 6" Sewer Main 10' Lt.
- 191 6" Gas Main 10' Lt.
- 192 6" Electric Main 10' Lt.
- 193 6" Water Main 10' Lt.
- 194 6" Sewer Main 10' Lt.
- 195 6" Gas Main 10' Lt.
- 196 6" Electric Main 10' Lt.
- 197 6" Water Main 10' Lt.
- 198 6" Sewer Main 10' Lt.
- 199 6" Gas Main 10' Lt.
- 200 6" Electric Main 10' Lt.

Stationing on $\frac{1}{2}$
 S.M. 10181 Iron in Timble & 1/2 S. of S. Orme.
 S.M. 10145 1/2 to KELLLOGG St. & 1/2 E. of M.E. S.S. Orme.
 S.M. 10056 S.H. cor. Steel Frame, C.B. N. Co. Kelllogg, Alley E. of Mkt.

18' ALLEY
BETWEEN MARKET ST. & BROADWAY AVE.
 ALL CURVE ST. TO S.L. KELLOGG ST.
 18'-6" CONC.
CITY OF WICHITA, KANS.
 J.E. SMITH
 APRIL, 1954
 CITY ENGINEER
 PLAN NO. C13-45

