

B.M. 1174 NE. of N.E. cor. B. & S. A. cor. Market & Douglas
 B.M. 11615 X one of S. edge above, N.W. of Alley S. of Douglas, E. of Alley E. of Main.

Note to Contractor:
 Contractor shall be responsible for any
 sidewalk or curb removed unless specifically
 marked for removal by the engineer in charge

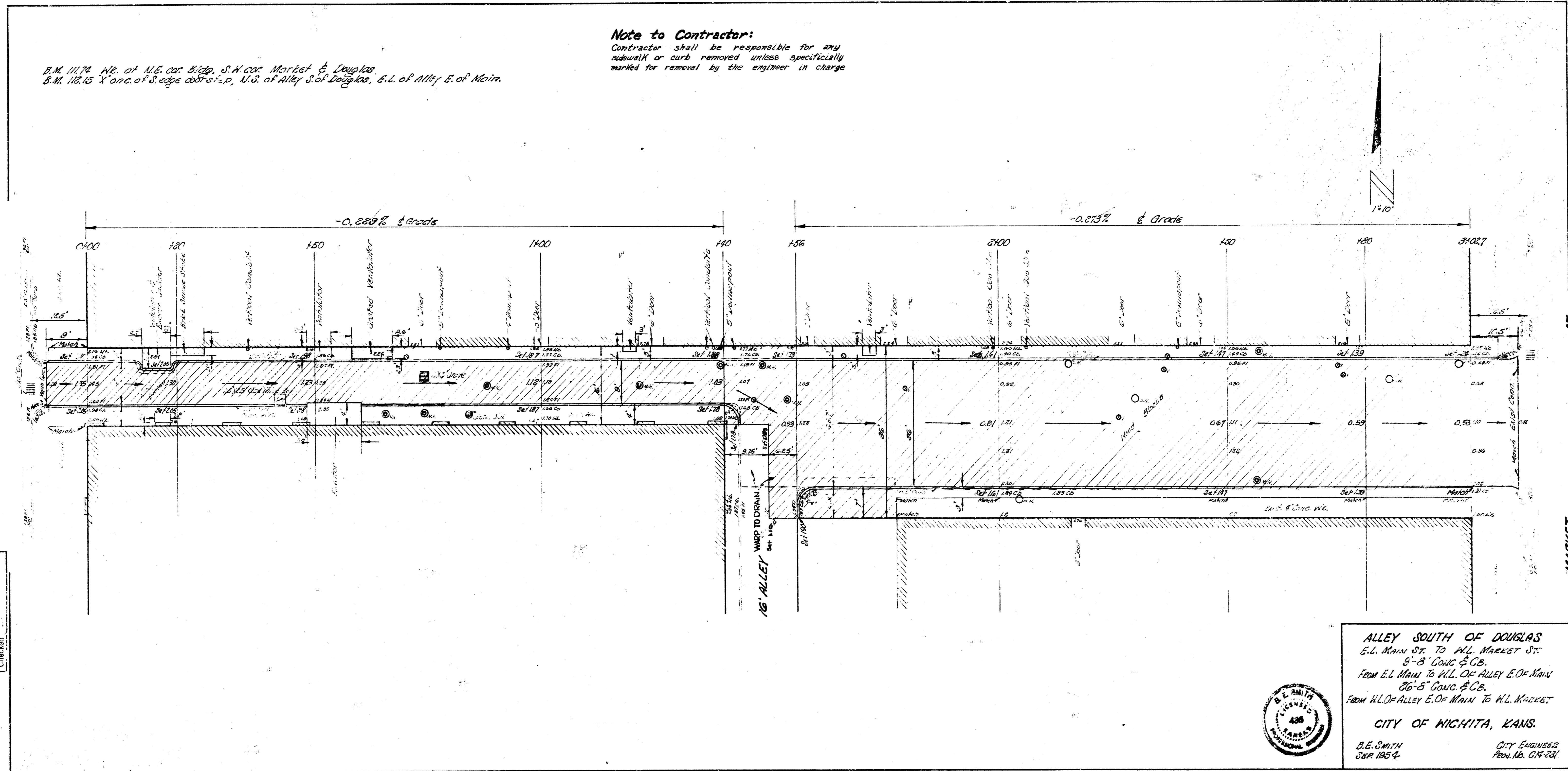

Survey 10/26
 E. L. Smith
 City of Wichita



ALLEY SOUTH OF DOUGLAS
 E. L. MAIN ST. TO W. L. MARKET ST.
 9" 8" CONC. & C.B.
 FROM E. L. MAIN TO W. L. OF ALLEY E. OF MAIN
 16" 8" CONC. & C.B.
 FROM W. L. OF ALLEY E. OF MAIN TO W. L. MARKET

CITY OF WICHITA, KANSAS.

B. E. SMITH
 SEP 1854

CITY ENGINEER
 PLAN No. 014-534