

Supply Bill  
 Checked  
 Checked

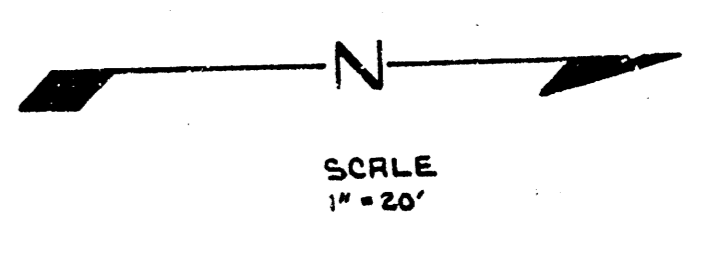
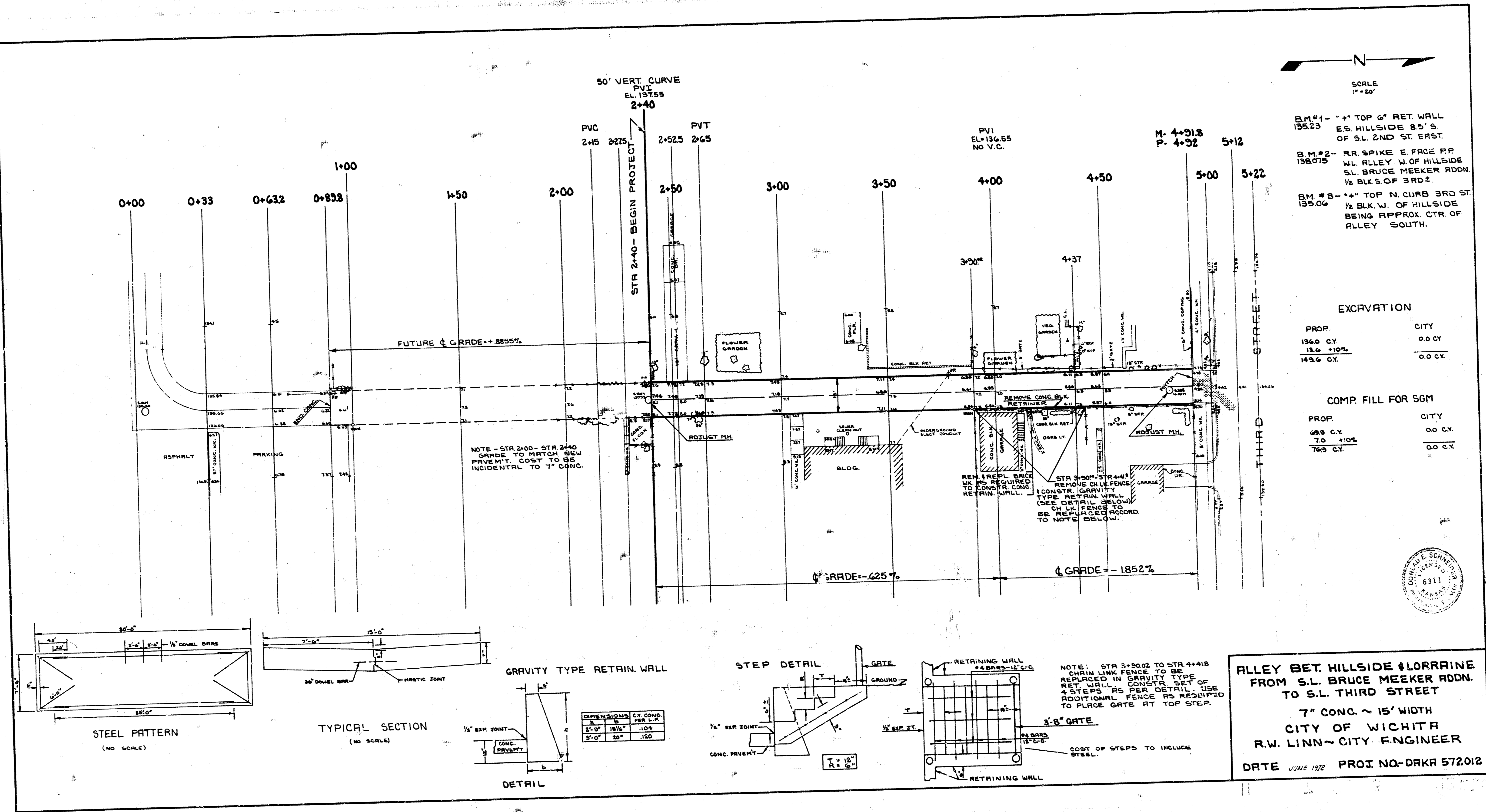

BM #1 - 4" TOP 6" RET. WALL  
 135.23 E.S. HILLSIDE 8.5' S. OF S.L. 2ND ST. EAST

BM #2 - RR SPIKE E. FACE P.P.  
 136.075 W.L. ALLEY W. OF HILLSIDE S.L. BRUCE MEEKER ADDN. 1/2 BLK. S. OF BRD.

BM #3 - 4" TOP N. CURB BRD ST.  
 135.06 1/2 BLK. W. OF HILLSIDE BEING APPROX. CTR. OF ALLEY SOUTH.

EXCAVATION

PROP.	CITY
136.0 C.Y.	0.0 C.Y.
13.6 ±10%	
149.6 C.Y.	0.0 C.Y.

COMP. FILL FOR SGM

PROP.	CITY
7.0 C.Y.	0.0 C.Y.
7.0 ±10%	
7.7 C.Y.	0.0 C.Y.

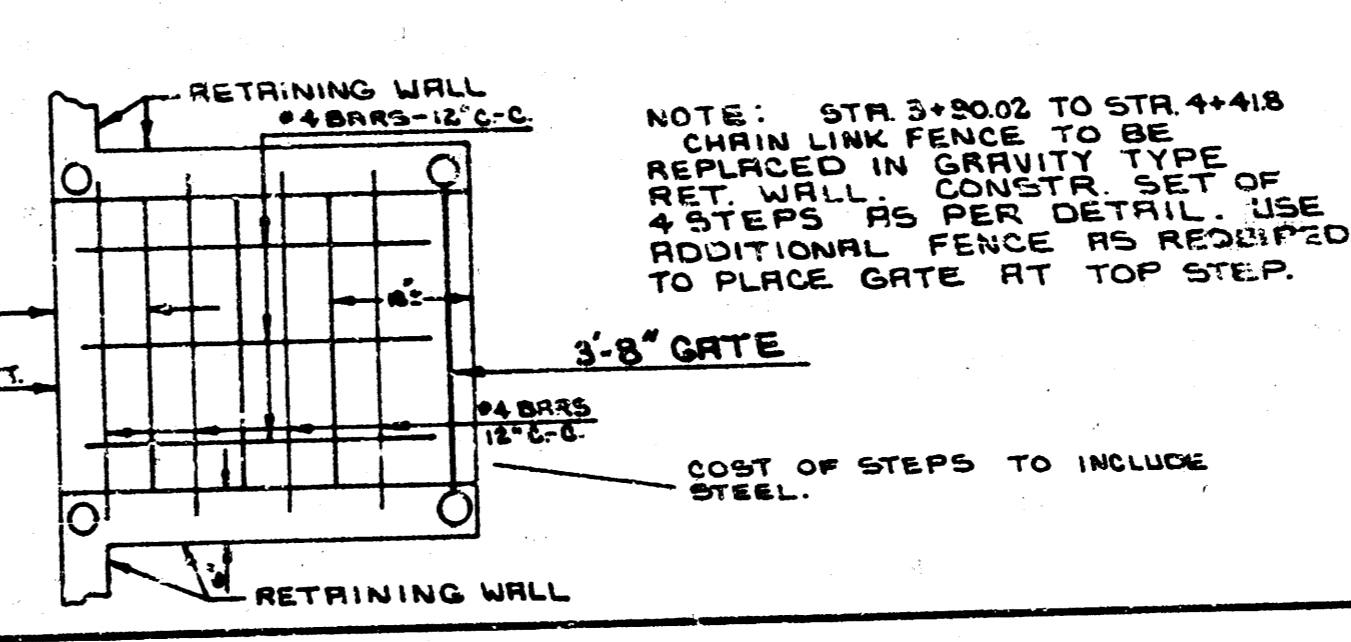
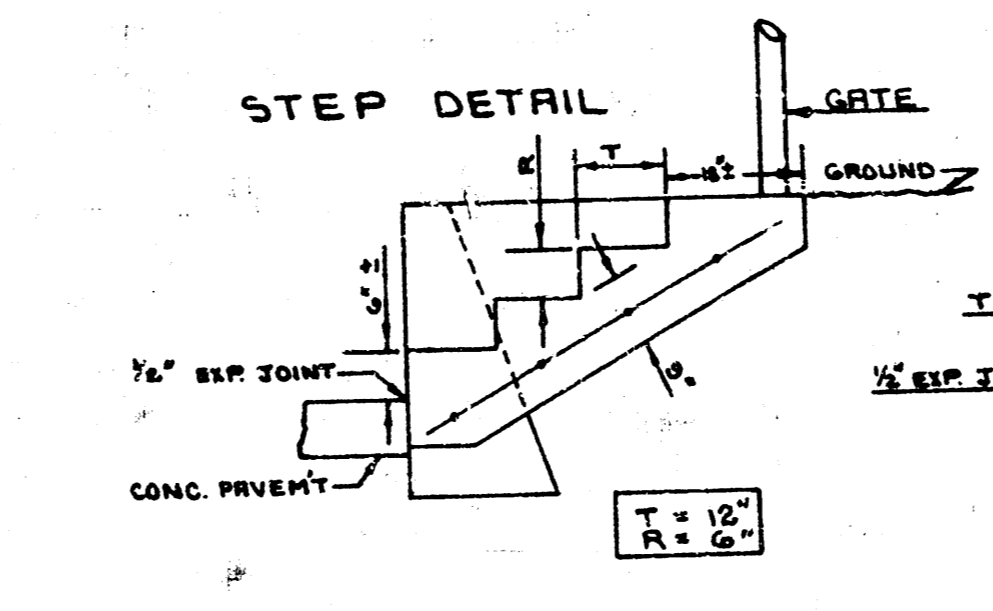
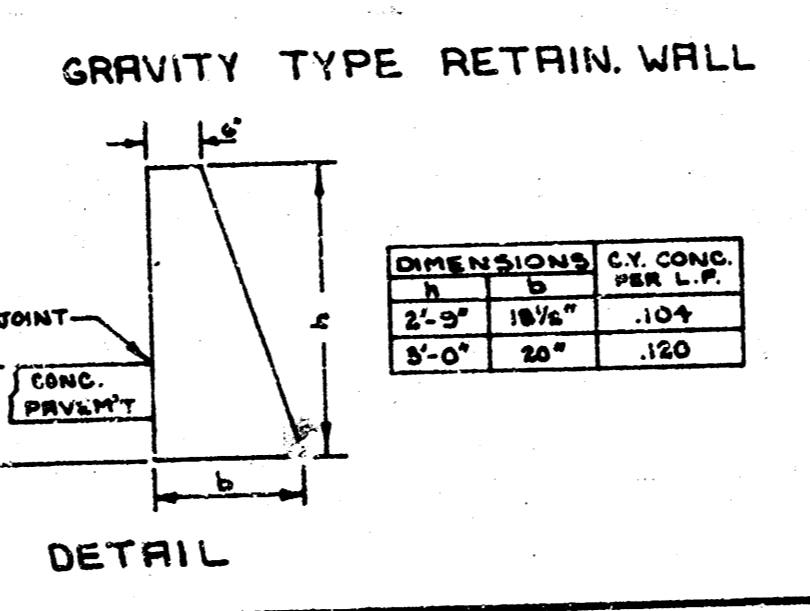
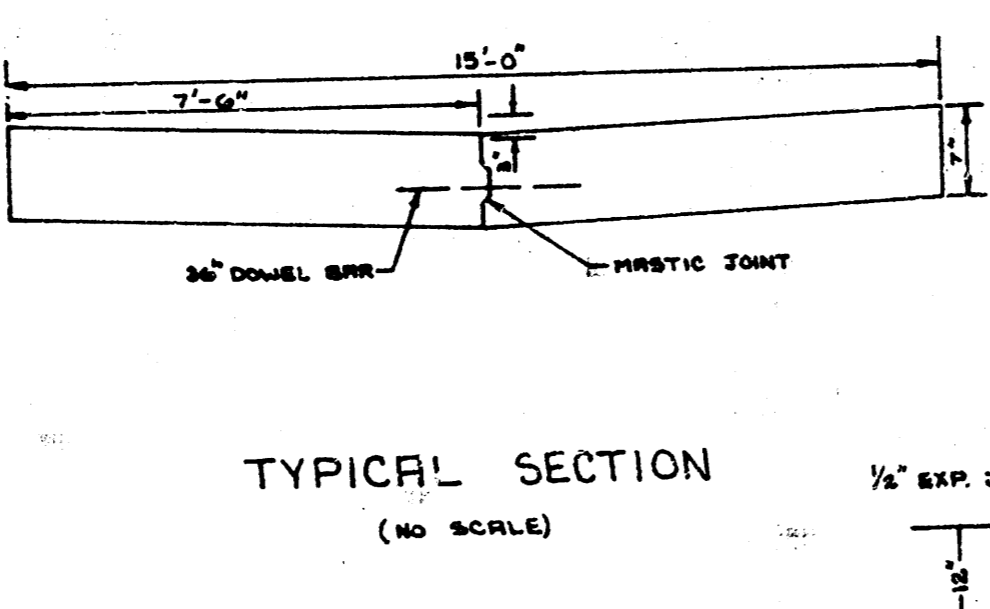
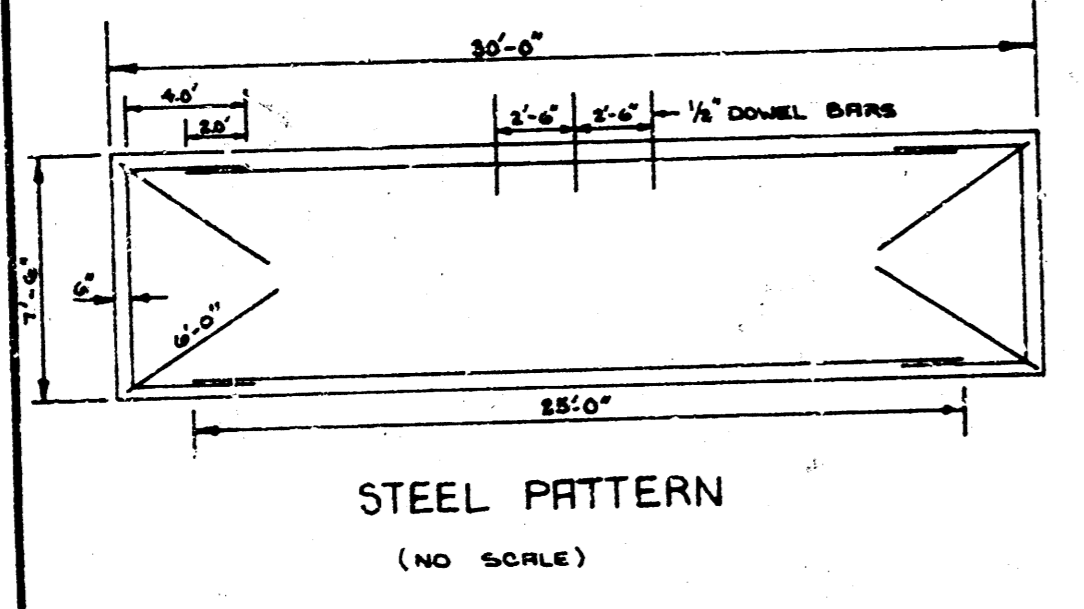

ALLEY BET. HILLSIDE & LORRAINE  
 FROM S.L. BRUCE MEEKER ADDN.  
 TO S.L. THIRD STREET

7" CONC. ~ 15' WIDTH

CITY OF WICHITA  
 R.W. LINN - CITY ENGINEER

DATE JUNE 1928 PROJ. NO. DAKR 572.012