

B.M. 100.04 RR SPIKE IN S. FACE P. PILE N. OF N. CURB WATERMAN W.S. ALLEY 50.  
 B.M. 107.37 IRON IN THIMBLE @ 104 N.L. WATERMAN

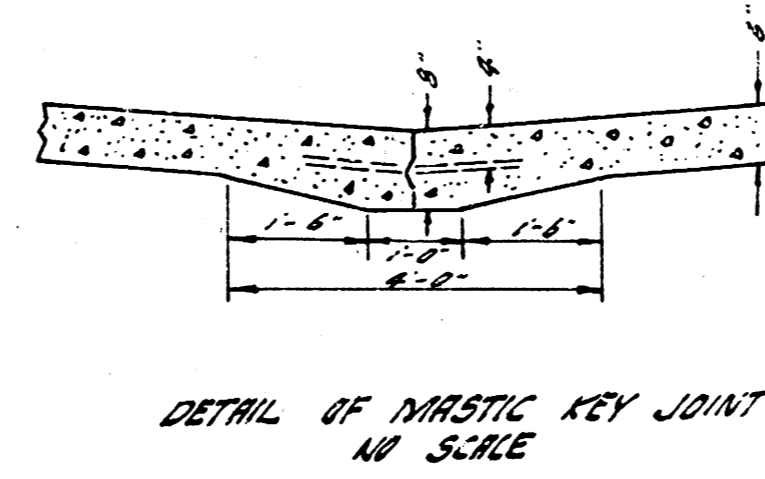

ELEVATION	CITY
357.0	3.2
357	3.2
357.7	3.2

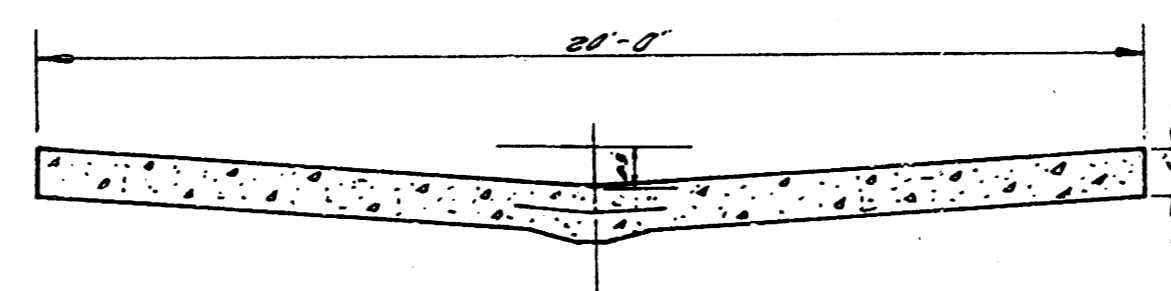
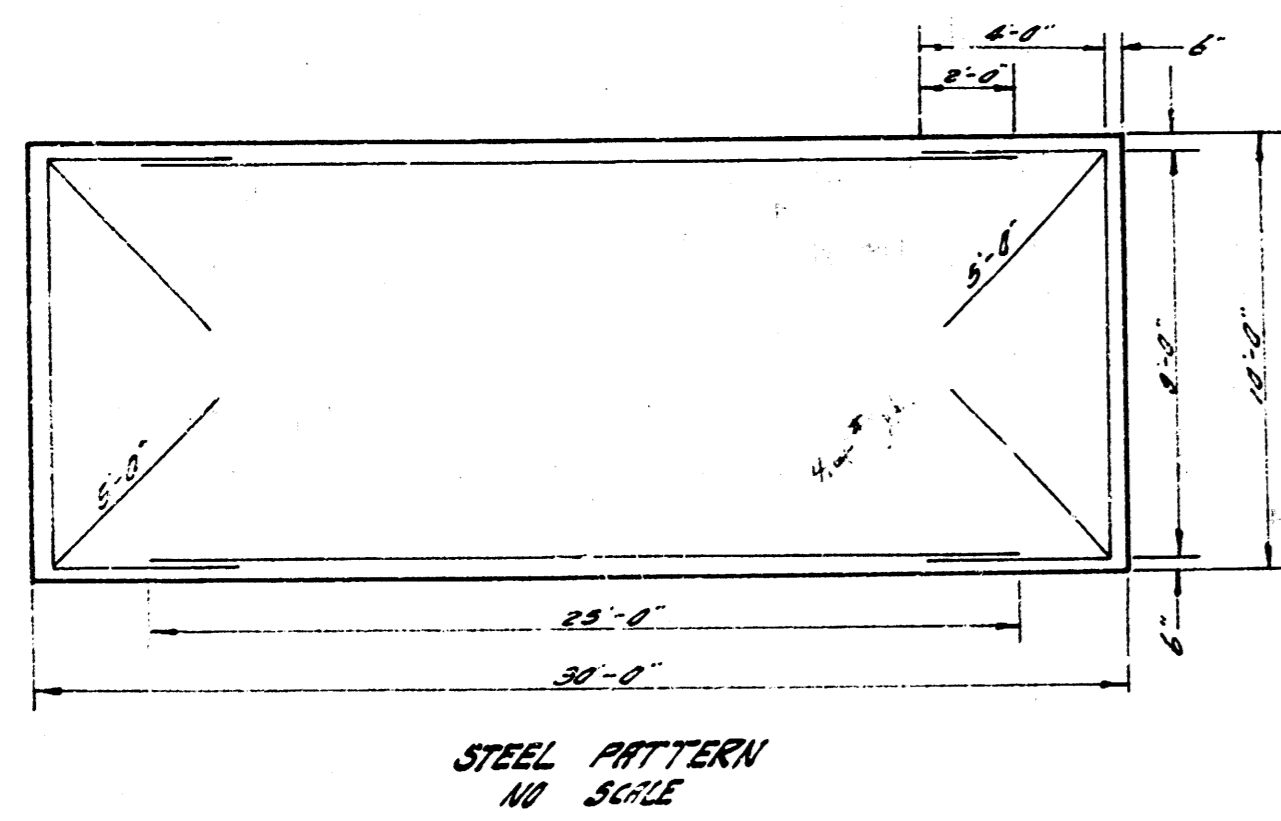
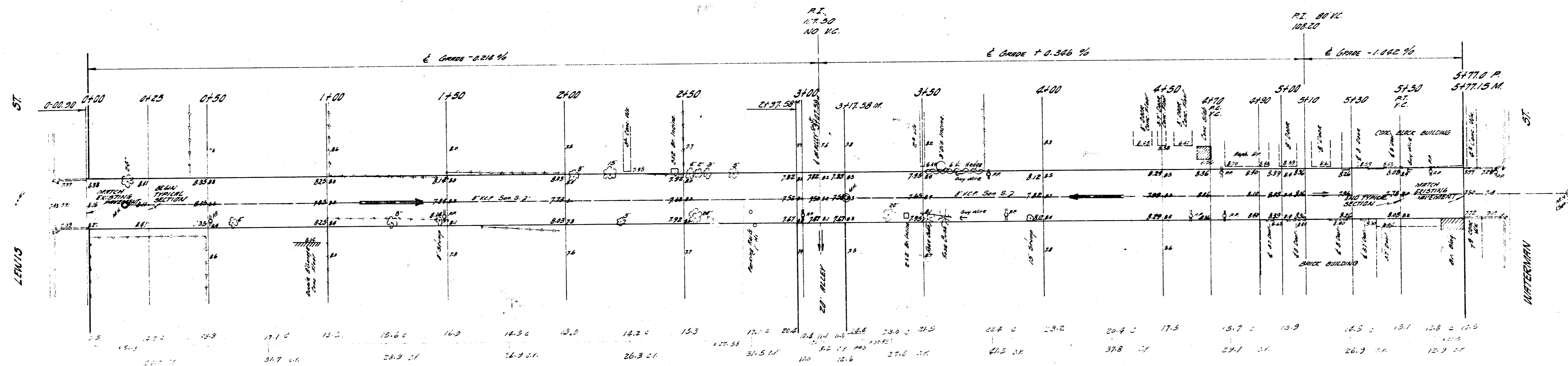
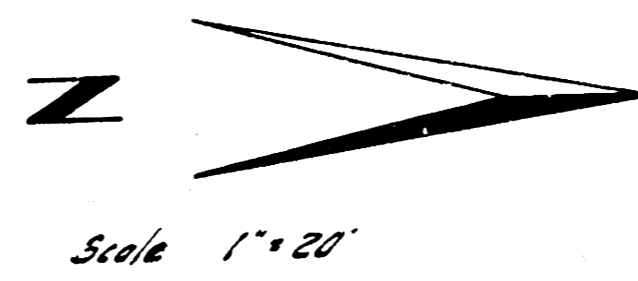

ALLEY BET. IDA & LAURA  
 N.L. LEWIS TO S.L. WATERMAN  
 20" - 6" CONC.  
 CITY OF WICHITA, KANSAS  
 B.E. SMITH, CITY ENGINEER  
 DATE APRIL 1959, PROJ. NO. C19-1