

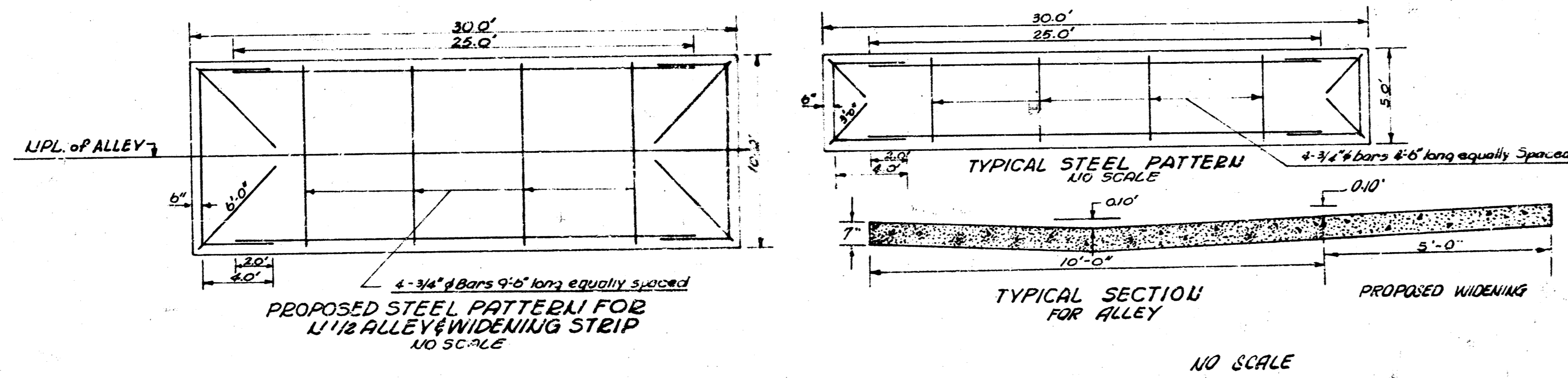

NOTE: Contractor to contact City Engineering Dept. for stakes and inspection before starting construction.

B.M. STAIRWAY SE. COR. PAWJEE & GLENN Elev. 101.942

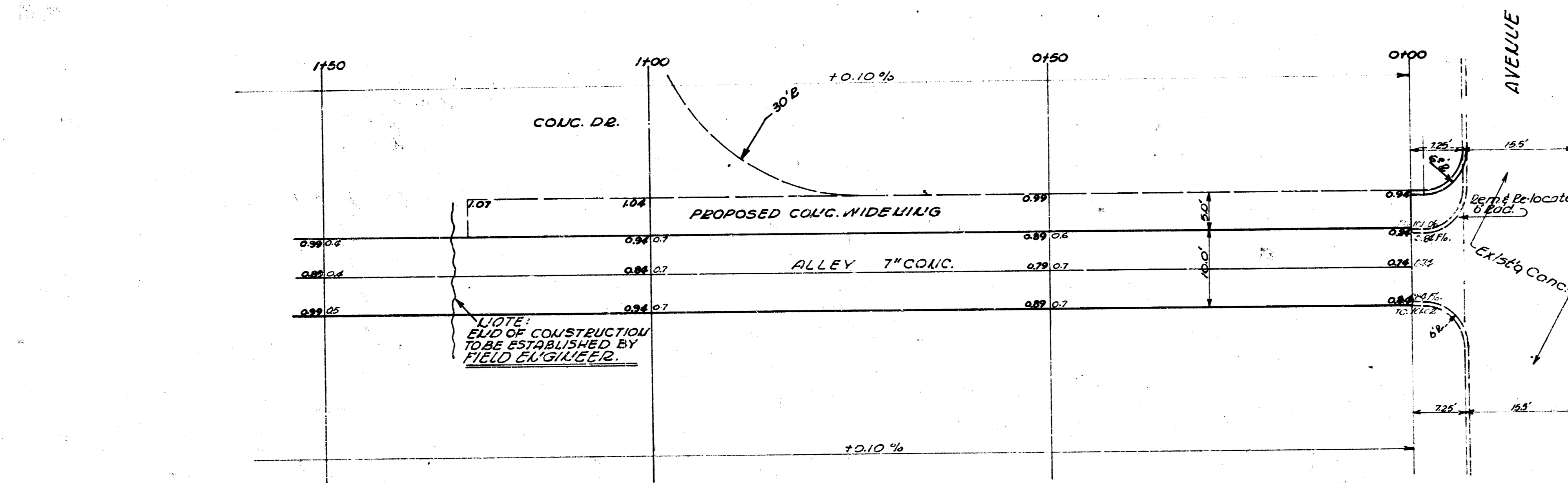

1. THE CONTRACTOR SHALL BE RESPONSIBLE FOR OBTAINING ALL NECESSARY PERMITS AND APPROVALS FROM THE CITY ENGINEERING DEPARTMENT AND THE PUBLIC WORKS DEPARTMENT BEFORE COMMENCING CONSTRUCTION.

ALLEY SO. PAWJEE W of GLENN  
PRIVATE CONSTRUCTION  
7" CONC.  
CITY OF WICHITA, KANSAS  
B.E. SMITH CITY ENGINEER  
March 1956 PROJ. NO. Private Job



Survey by B.E. Smith, B.S. 1927  
Lic. No. 435  
City of Wichita, Kansas