

BENCH MARKS:
 108.37 @ in thum. E. L. Washington & English
 104.04 @ in thum. E. Ida & English

ENGLISH ST.

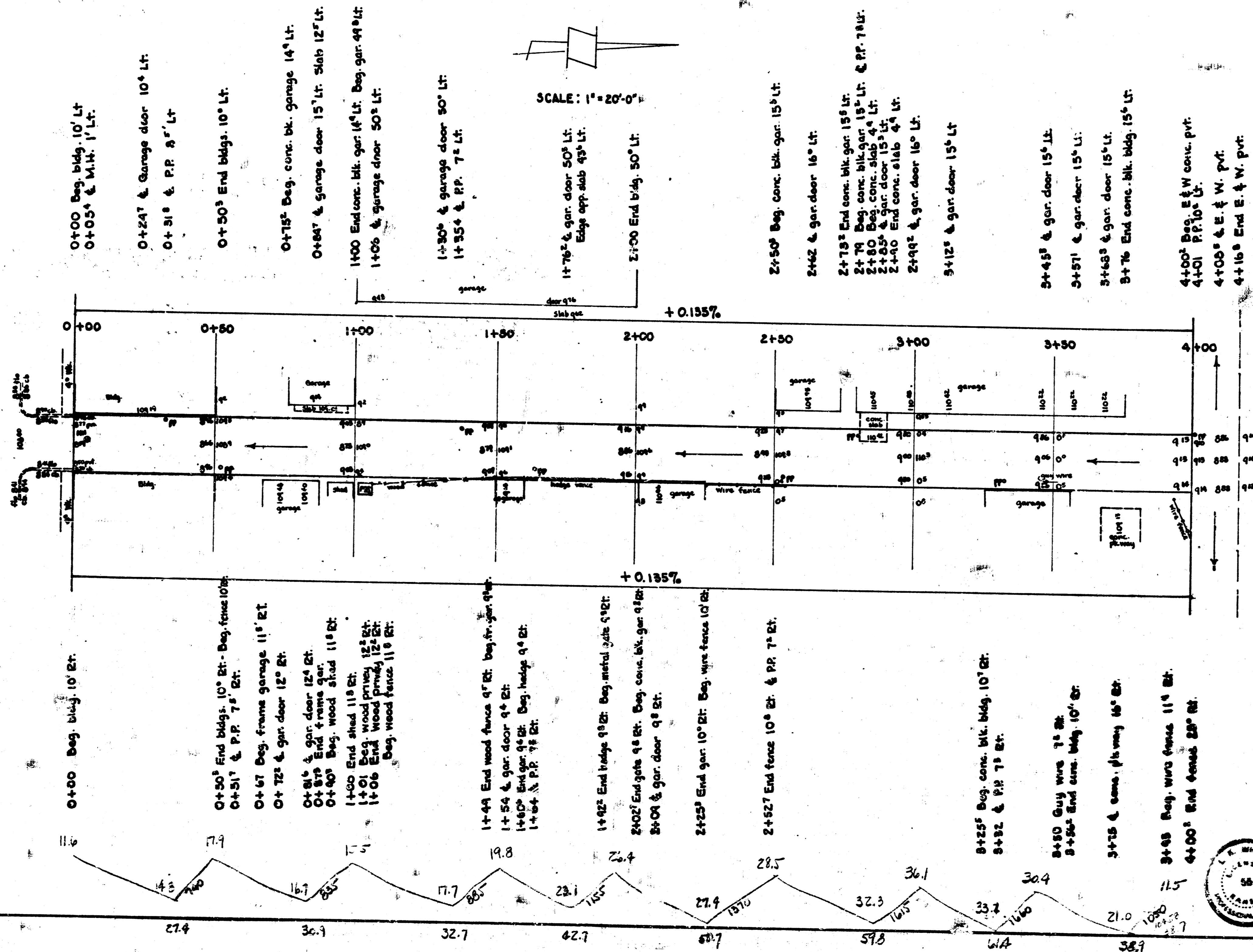

SCALE: 1" = 20'-0"

Prop.	City
27.4	0
30.9	
32.7	
42.7	
50.7	
59.8	
61.4	
38.9	
344.5	
34.5	+10%
379.0	cu yd

ALLEY EAST OF WASHINGTON
 S.L. Alley S. of Douglas To N.L. English St.
 7' Conc. - 20'
CITY OF WICHITA, KANSAS
 L.K. White City Engineer
 Nov. 1951 Proj. C11-218

