

BM = 113.51' on wall north of back clear to United Savings & Loan Building
 * 116.00' cut, top 1/2" of conc. coping rest wall on SW Corner 1st & Water

Base Line = S. Kas. Alley

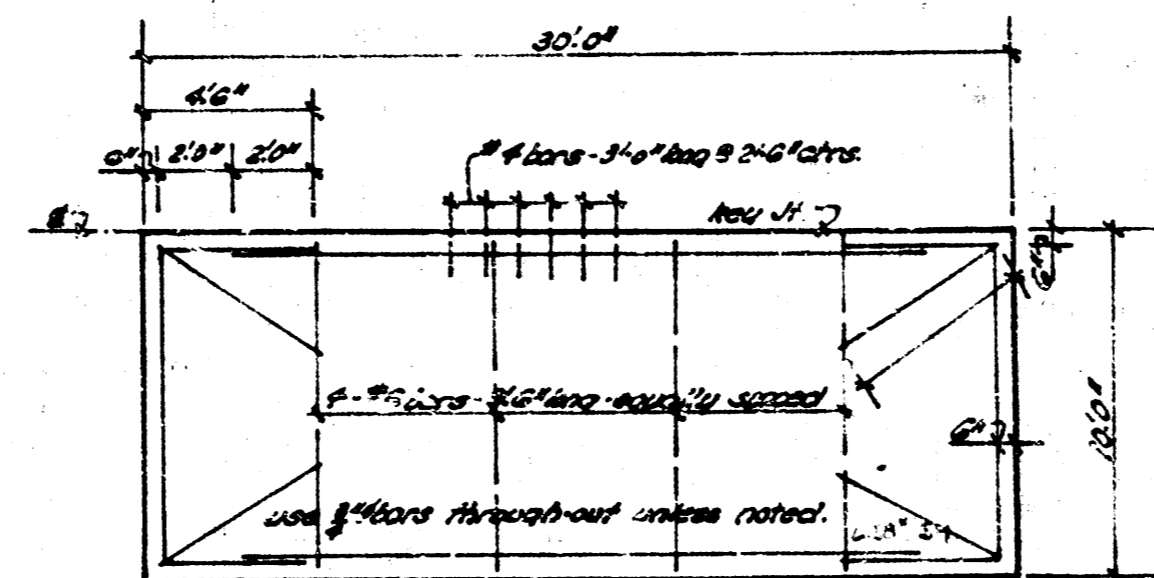

"EXHIBITORS QUANTITIES"
 Concrete 111
 38.00
 38.00

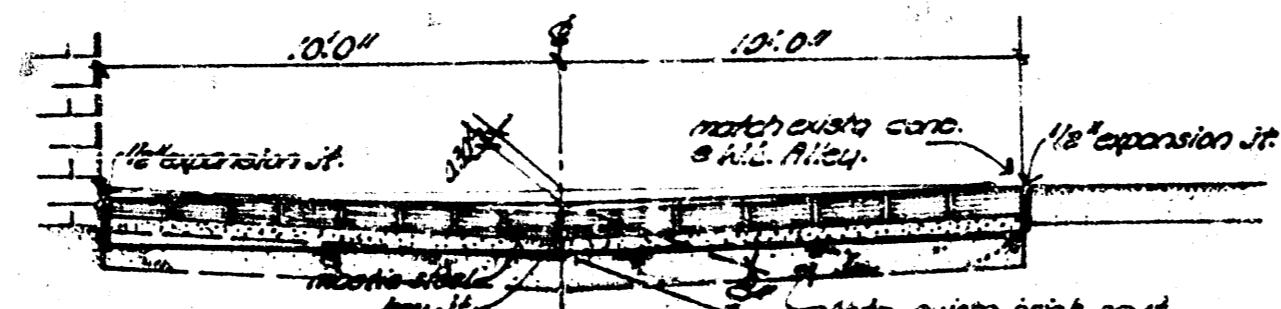
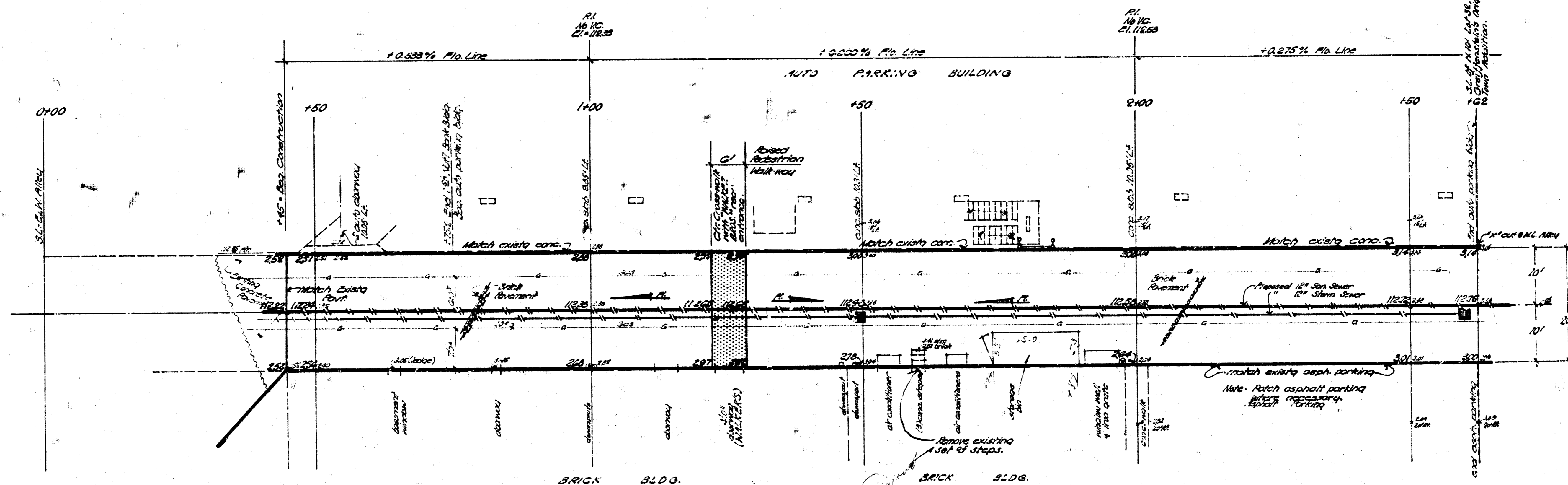

"ALLEY BET. MAIN & WATER ST."
 From 175' N. of N. Douglas Ave. to
 376' N. of Douglas Ave.
 20'-0" CONCRETE
 CITY OF WICHITA, KANSAS
 D. E. Smith - JUNE 1962 - City Engineer
 Date: Proj. No. C13-93

