

7

D.M. 113.11 Iron in thimble N.S. Murdock & Mathewson



MURDOCK

AVE.

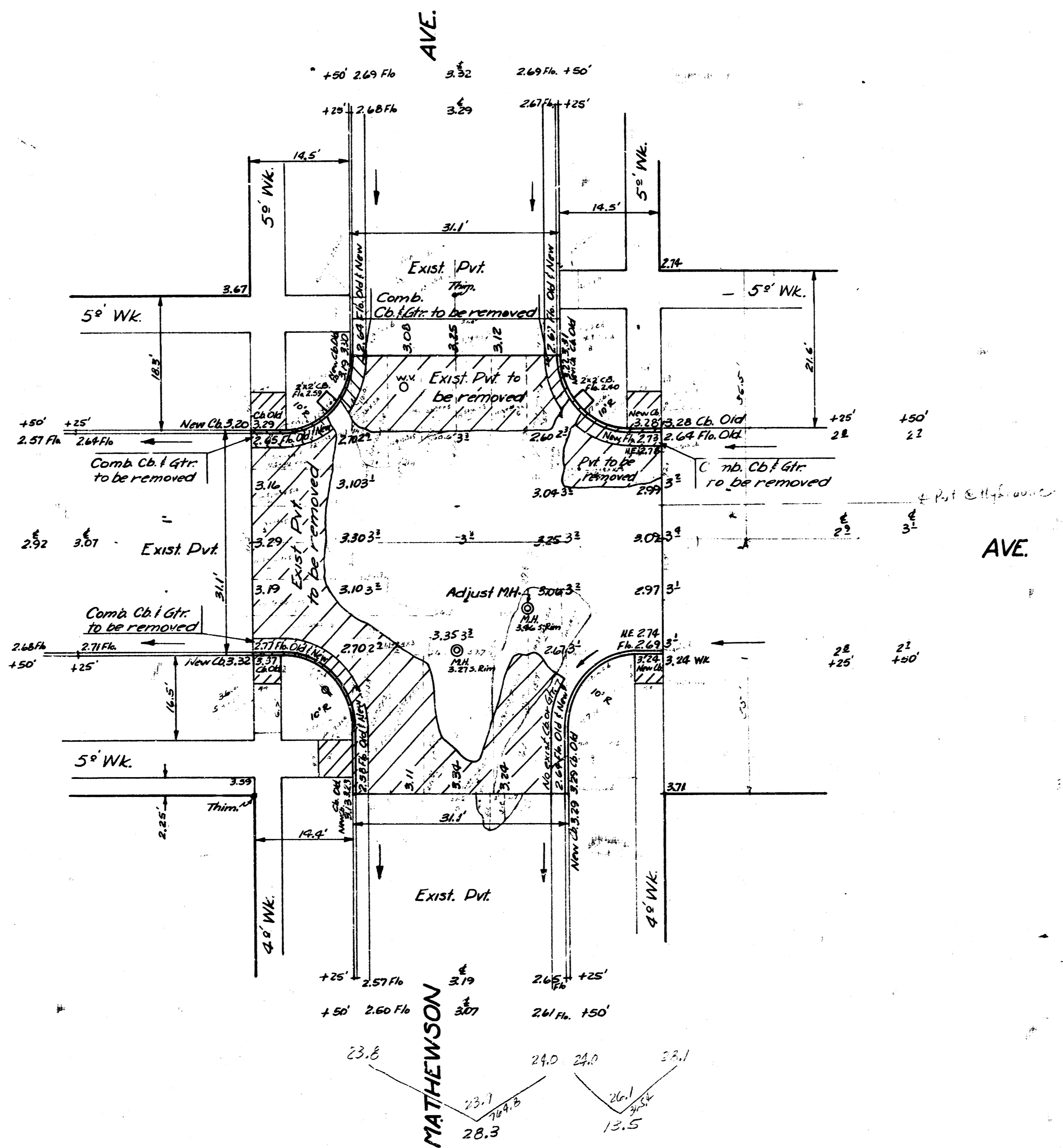

EXCAV.
 Rectangle 32' x 46'
 28.3
 13.5
 41.8
 41.8
 Total 46.0 Cu. Yds.

INTERSECTION
MURDOCK & MATHEWSON
REPAVE 8" CONC. & C.B.
CITY OF WICHITA, KANS.
L.K. WHITE CITY ENGINEER
JULY 1951 PROJ. NO. C11-118

