

B.M. 111.91 S.E. cor. conc. base for signal light N.E. Central & St. Francis.

B.M. 114.02 S.E. cor. conc. porch Apt. #606 1/2 N. Emporia

B.M. 112.81 "W" in W.B. Carter & walk east - E. side Alley & N. side Pine between Emporia & St. Francis

NOTE
Alley payment to abut conc. to basement ramp of the conc. box (2) Sta. 31.68

Scale: 1" = 20'

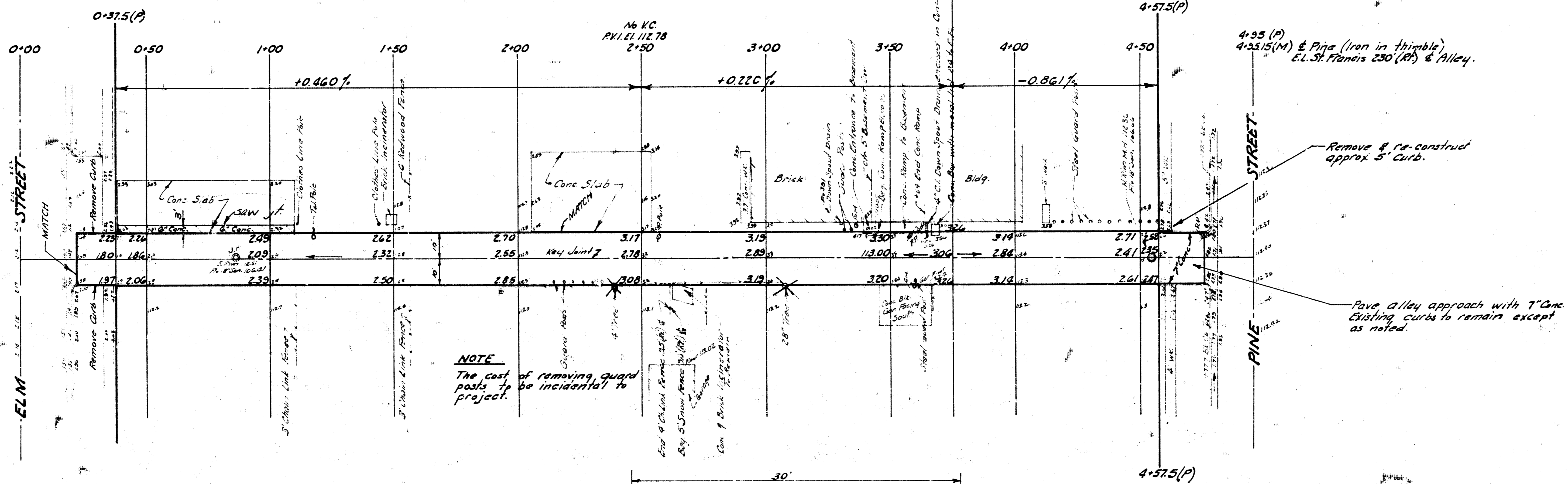

NOTE
The cost of removing guard posts to be incidental to project.

EXCAVATION

PROPERTY	CITY
288 Cu Yds.	16 Cu Yds.
10 1/2 29	2
Totals 317 Cu Yds.	18 Cu Yds.

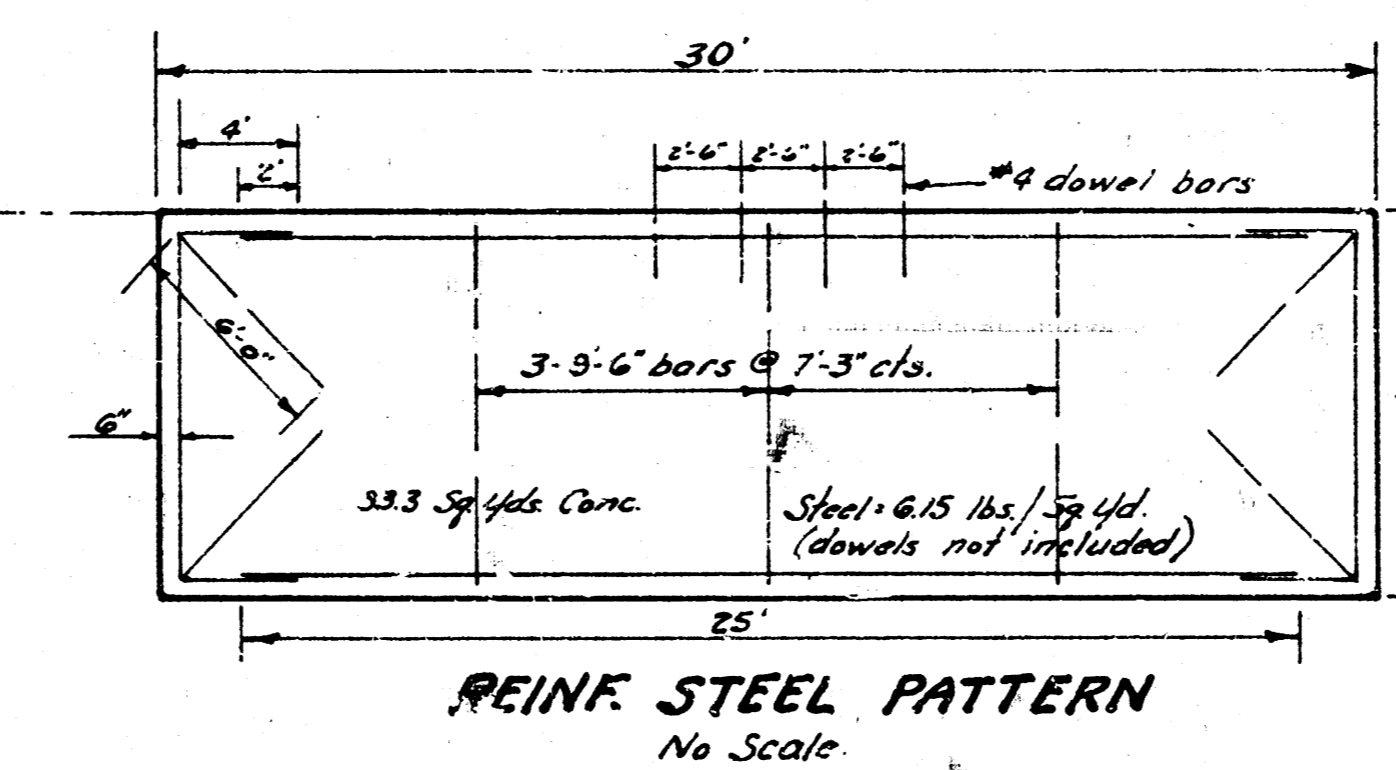
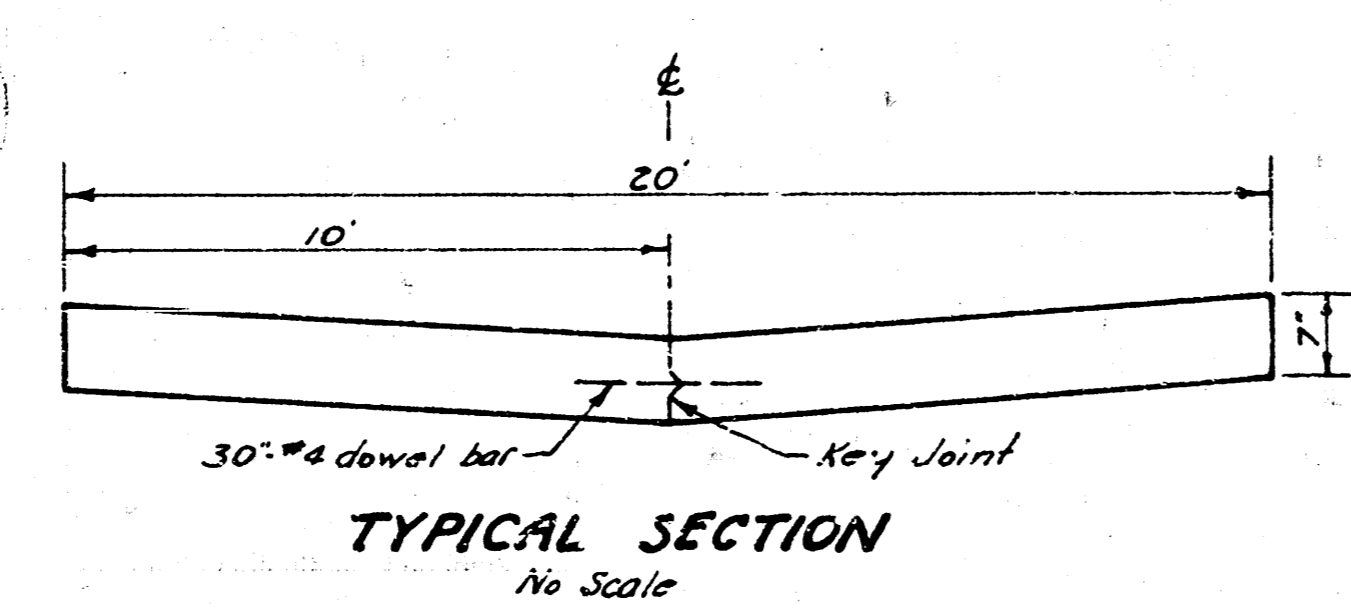

NOTE:
All reinf. steel to be #6 bars except the dowel bars.

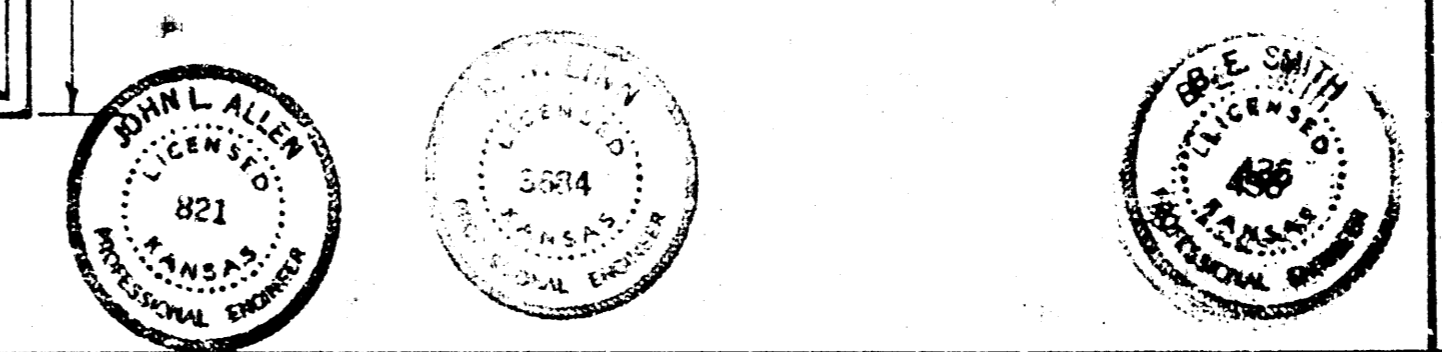

ALLEY between EMPORIA & ST. FRANCIS N.L. ELM to S.L. PINE 20'-7" CONCRETE
B.E. SMITH CITY ENGINEER CITY OF WICHITA KANSAS
 Date: Sept. 1967
 Project No. C17-53