

B.M. 115.4 High point on conc. cap on top of brick pilaster, S.E. cor. 3rd & Emporia. 382.58' From Thim E.L. Emporia To E.L. St. Francis.
 B.M. 116.00 Sg 4+62, top of all (1 1/4" pipe) N.E. cor. of Alleys, @ conc. bldg. alley S. of Central

Base = E. of Alley.

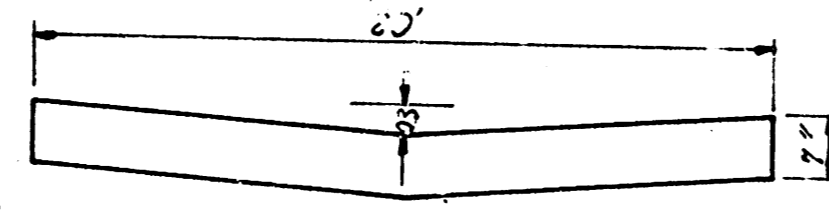

TYPICAL SECTION
 FROM STA 0+00 TO STA 4+00
 NOT TO SCALE

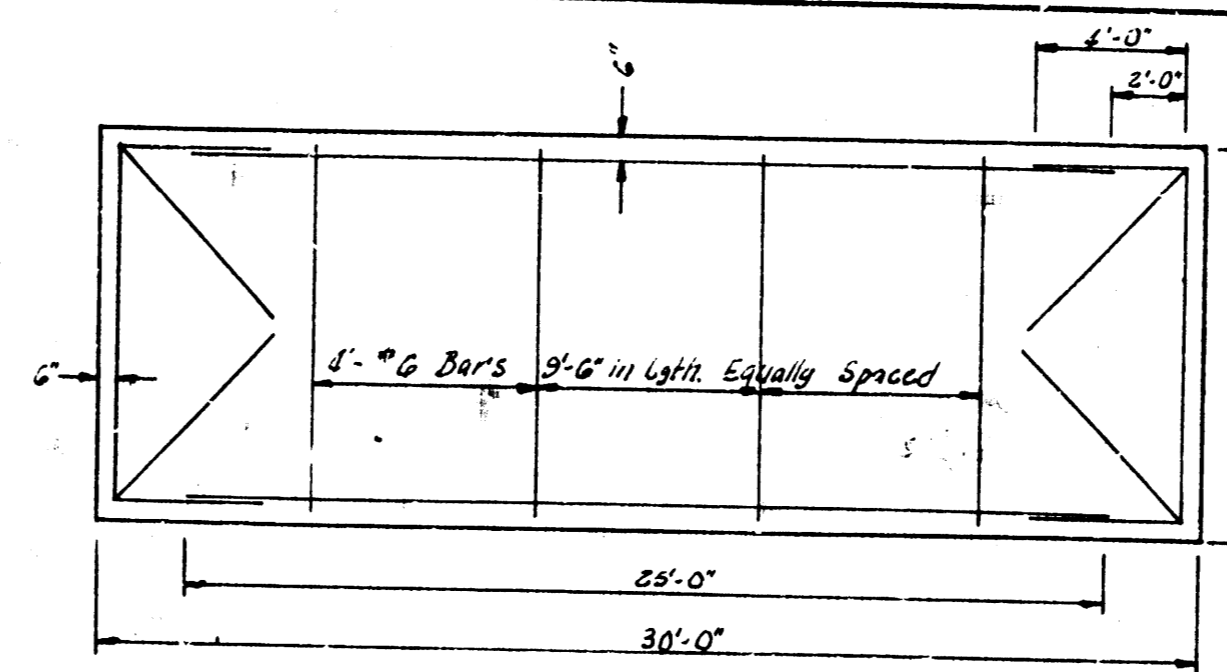

STEEL PATTERN
 NOT TO SCALE

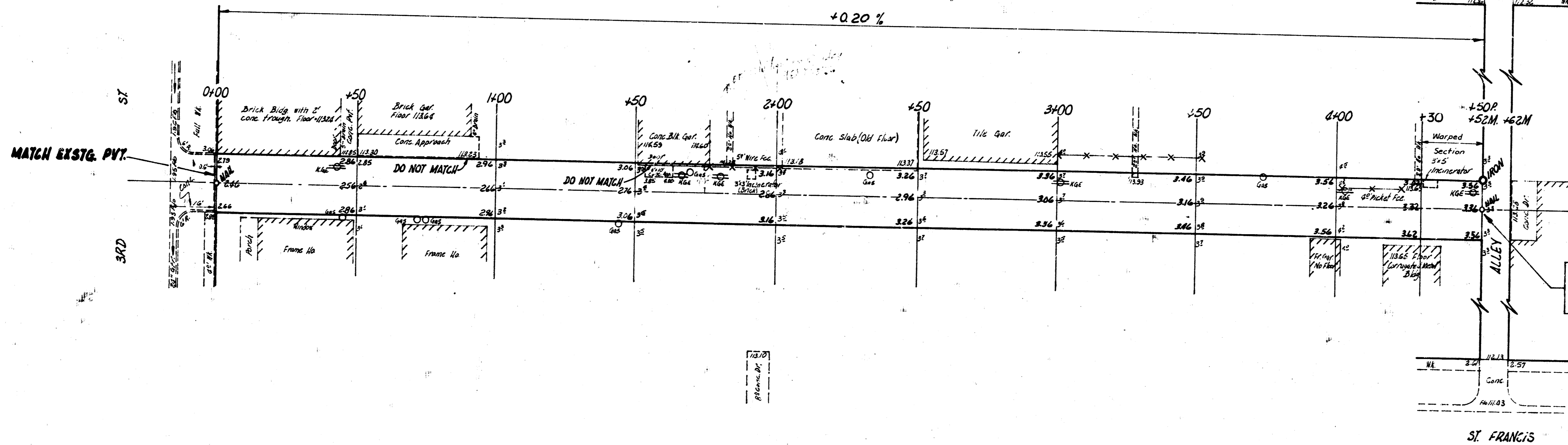

NOTE:
 Set pit covers 02' above fio
 elev. @ Sta 4+62

ALLEY BT'WN EMPORIA & ST FRANCIS
 N.L. 3RD - S.L. ALLEY S. OF CENTRAL
 20' - 1" CONC.
 CITY OF WICHITA, KANS.
 B. E. SMITH CITY ENGINEER
 June 1956 PROJ. NO. C15-200

Sheets Must
 Be
 Kept
 In
 Order
 122
 123
 124
 125
 126
 127
 128
 129
 130
 131
 132
 133
 134
 135
 136
 137
 138
 139
 140
 141
 142
 143
 144
 145
 146
 147
 148
 149
 150
 151
 152
 153
 154
 155
 156
 157
 158
 159
 160
 161
 162
 163
 164
 165
 166
 167
 168
 169
 170
 171
 172
 173
 174
 175
 176
 177
 178
 179
 180
 181
 182
 183
 184
 185
 186
 187
 188
 189
 190
 191
 192
 193
 194
 195
 196
 197
 198
 199
 200