

B.M. 123.07 K' IN KSELER 4 S. OF S.L. ALLEY ON W. E.S. VOLUTSIA  
 STATIONING & BASELINE ON E. OF ALLEY

EXCAVATION  
 1971 12.26.61  
 1972 12.26.61  
 1973 12.26.61

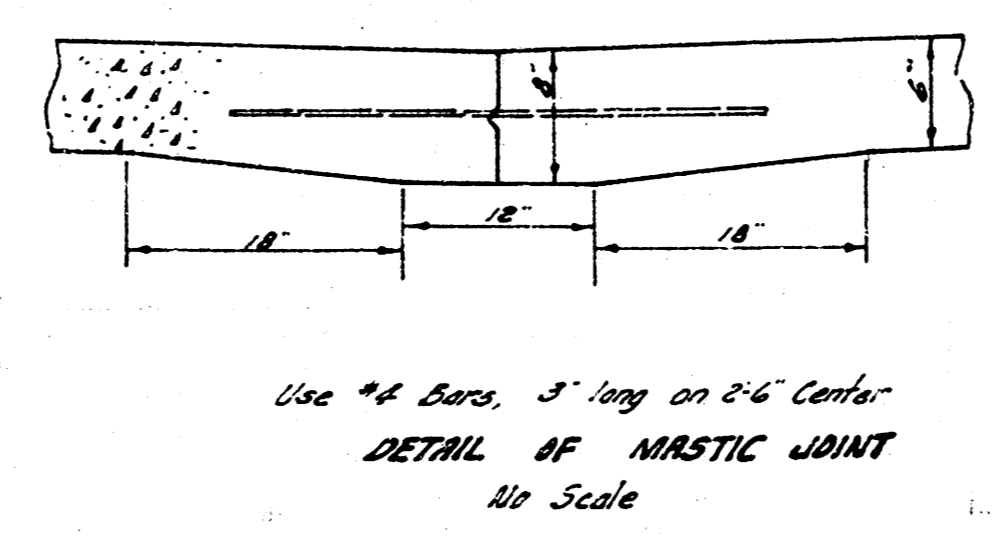
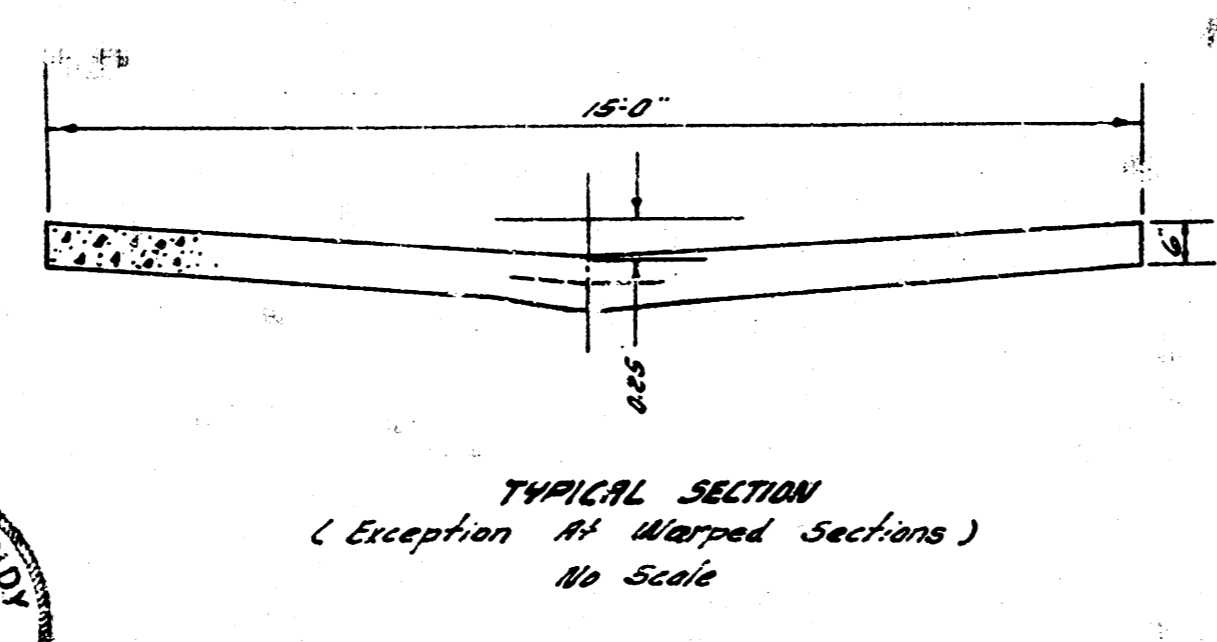
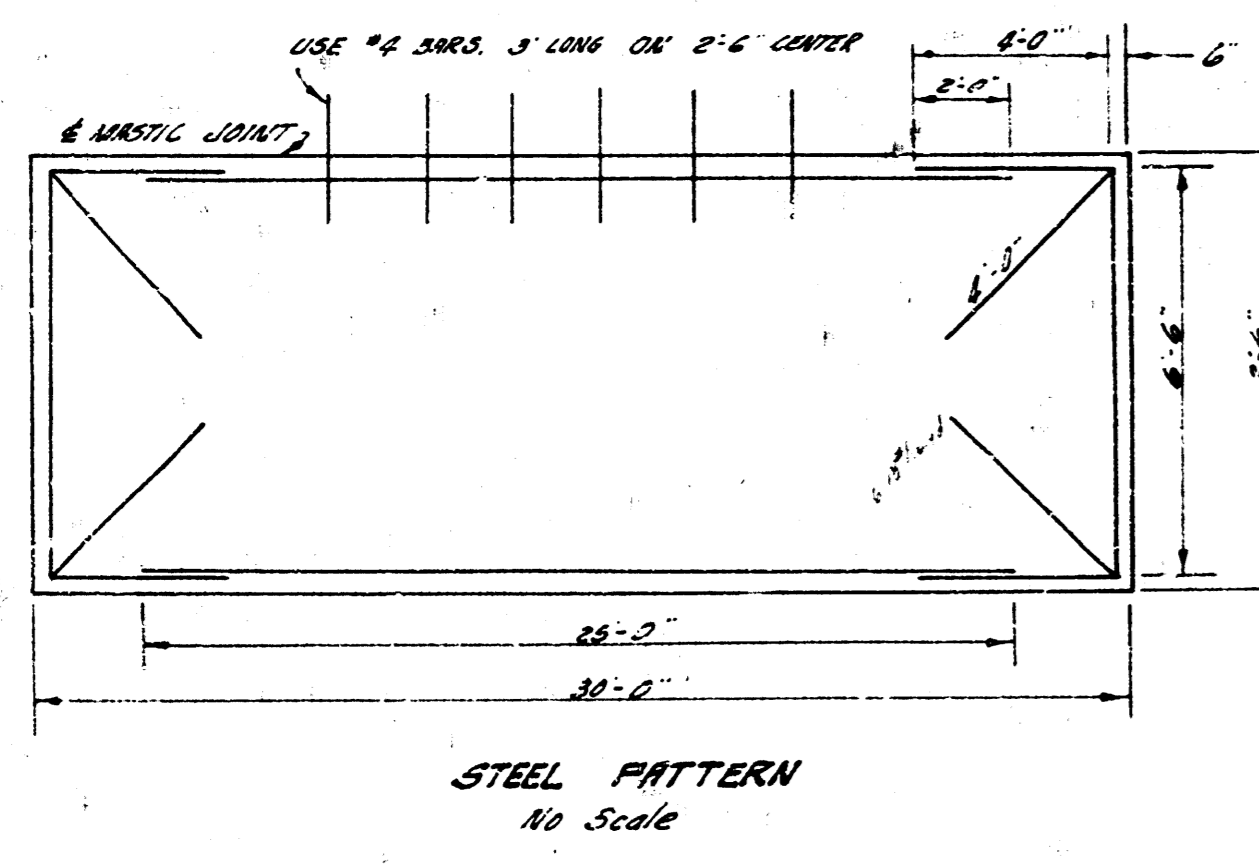
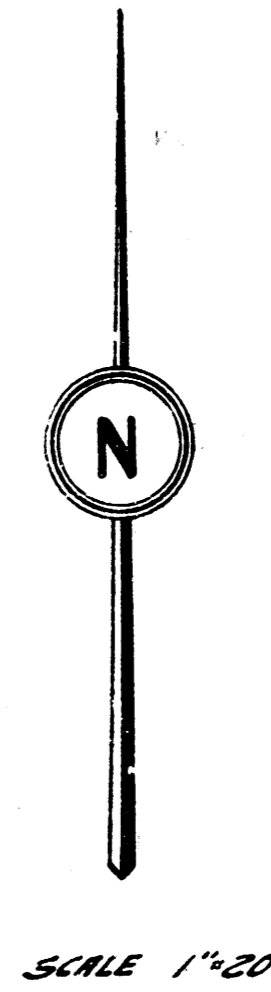
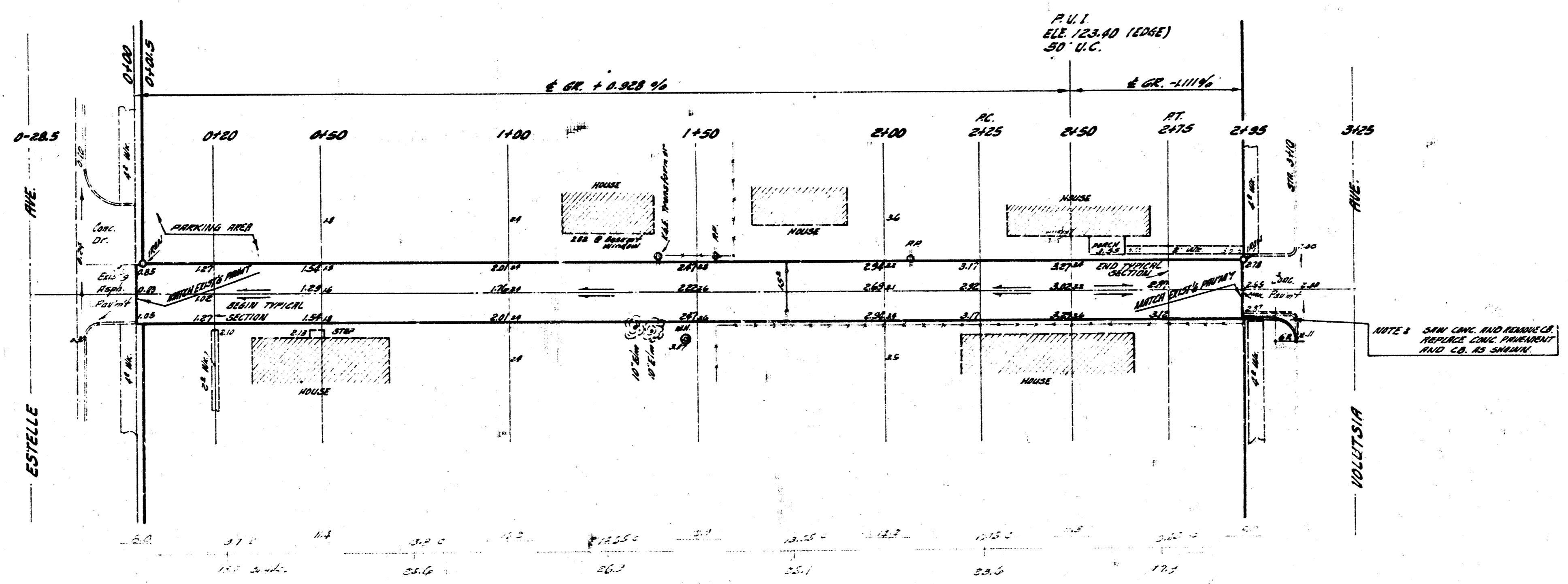

**ALLEY**  
 BETW. ESTELLE AND VOLUTSIA  
 SOUTH OF CENTRAL AVE.  
 15" CONC. 6"  
 CITY OF WICHITA, KANSAS  
 E. E. SMITH, CITY ENGINEER  
 DATE MAY 1960, PROJ. NO. C18-185

Survey conducted by  
 P. H. K. & S. L. Co.  
 L.S.C. & S.L. Co.  
 (CHICAGO) Ill.