

B.M. 96.28 N.F. Cor. Conc. Step No. 3163 Exposition.

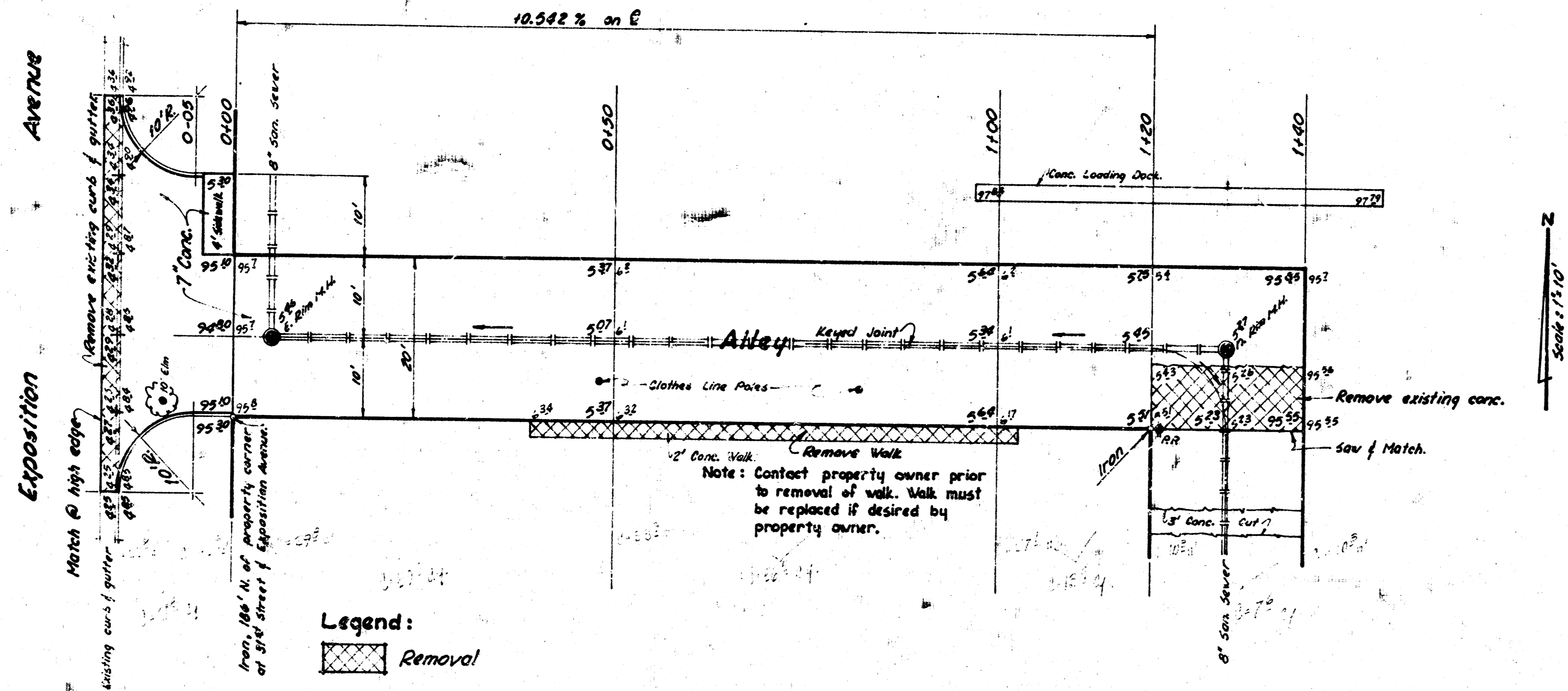

List of Quantities	
Item	Amount
7" Concrete Pavement	380 S.F.
Integral Curb	38 L.F.
Excavation	158.5 C.Y.
Key Joint	136 L.F.
Reinforcing Steel	1,993 lbs.
Manholes adjusted to grade	2 ea.
Curb & Gutter Removed	60 L.F.
7" Pavement Removed	18 S.F.
Concrete Walk Removed & Replaced(?)	120 S.F.
Saved Joint	20 L.F.
Small Trees Removed	1 ea.
Clothesline Poles Removed	2 ea.

Legend:
 Removal

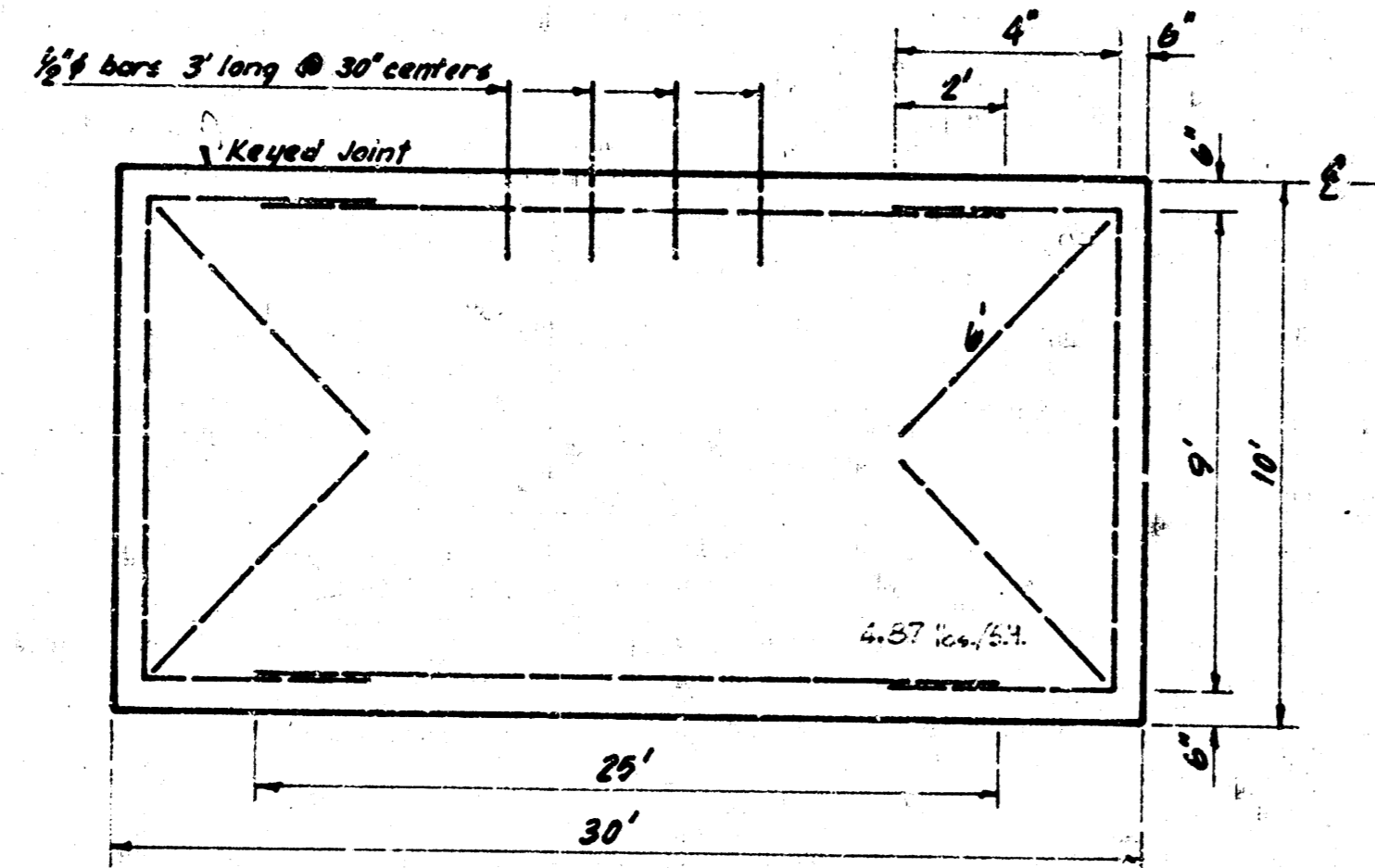

Steel Pattern No Scale
 All steel to be 3/4" # except where noted.

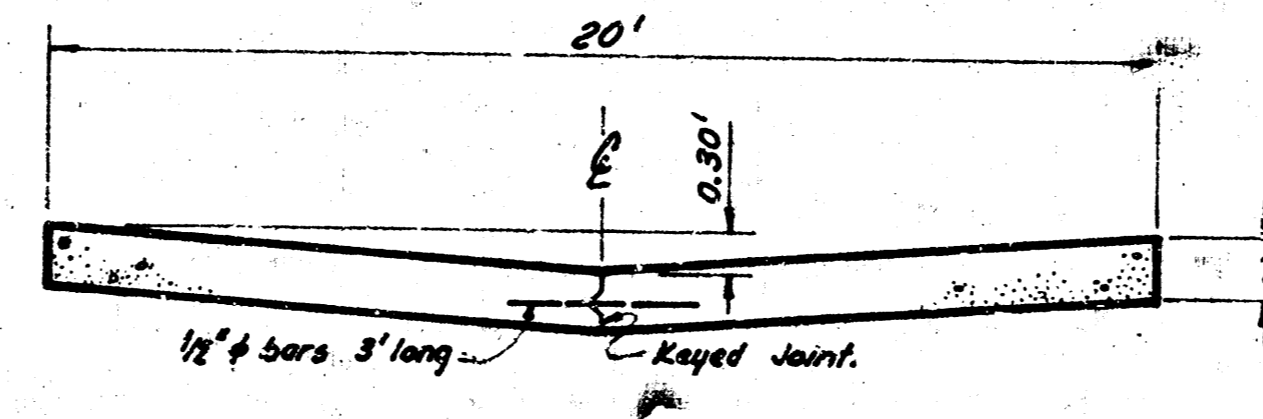

Typical Section
 No Scale

NOTE TO CONTRACTOR
 This project will be constructed under the supervision of the CITY ENGINEER and conforming to the SPECIFICATIONS of the CITY OF WICHITA. The CONTRACTOR will reimburse the City of Wichita for all cost of Engineering, Plans, and Inspection.

Alley N. of 31st St. So., Exposition
 to alley E. of Exposition.
 20' - 7" Concrete

City of Wichita, Kansas.

B. E. Smith City Engineer
 Date: Private Project

Survey: A.C. Beck, AR-41
 Plans: Schmidt
 C.E. Schmidt
 Checker: Stanley



1/1