

B.M. 9936 STEP BENCH S.S. H.L.R. NORTHEAST BLAKE AND E. 15
 B.M. 9938 BOLT W. SIDE H.L.R. 160' N. OF N.L. PANNEE. H.S. HYDRAULIC
 BASE LINE IS ON EAST @.

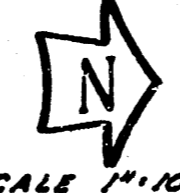

SCALE 1"=10'

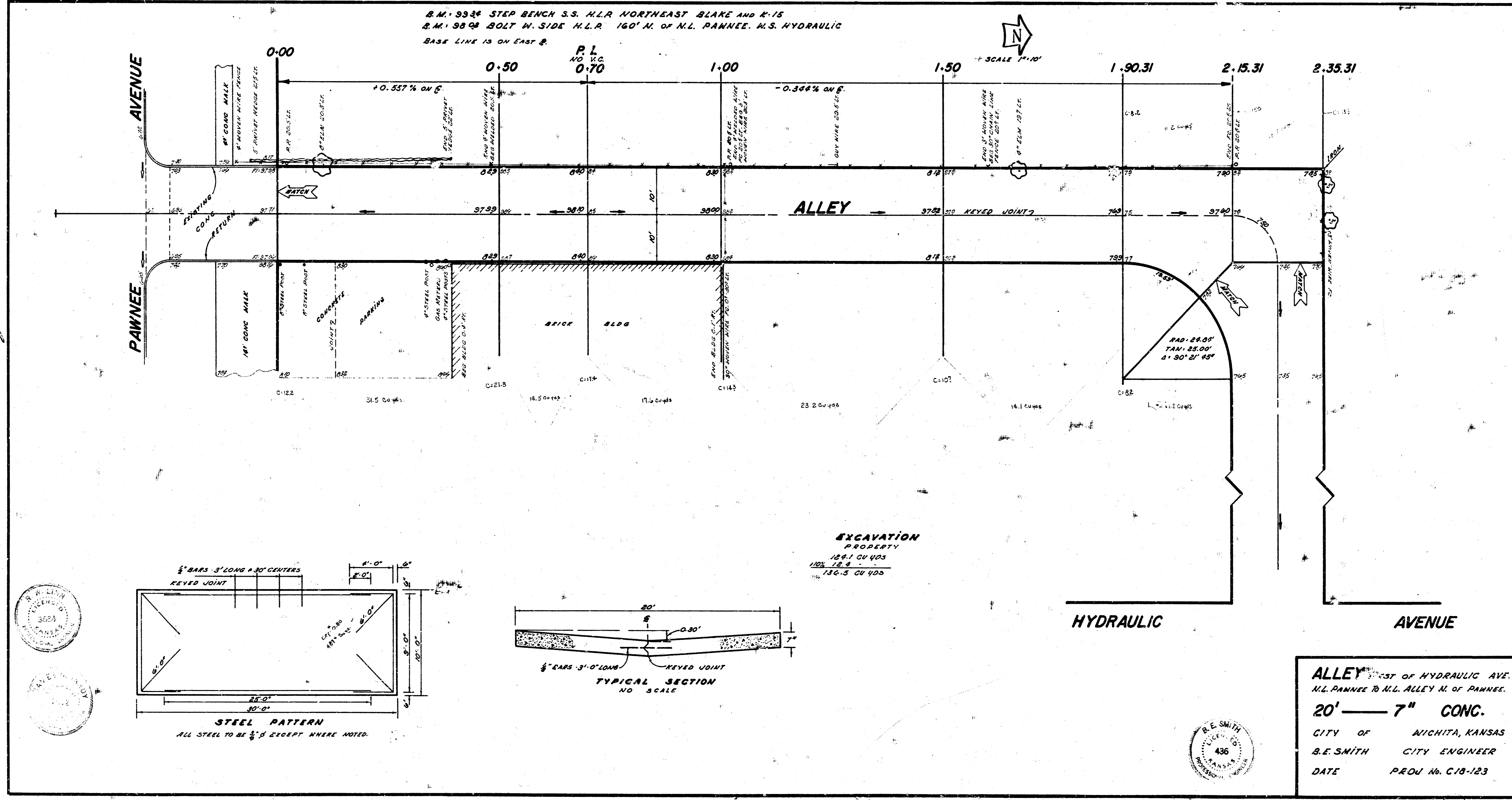

EXCAVATION
 PROPERTY
 126.1 CU YDS
 120% 151.3
 156.5 CU YDS

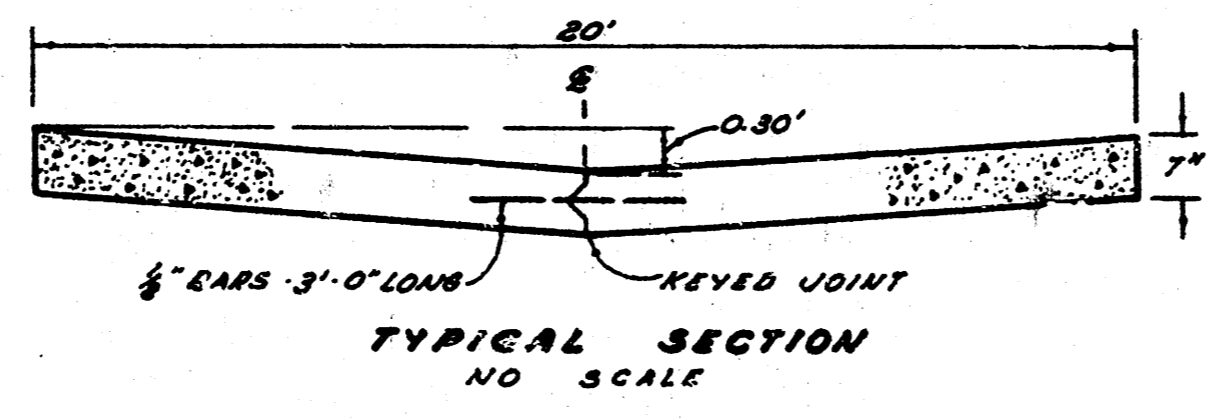
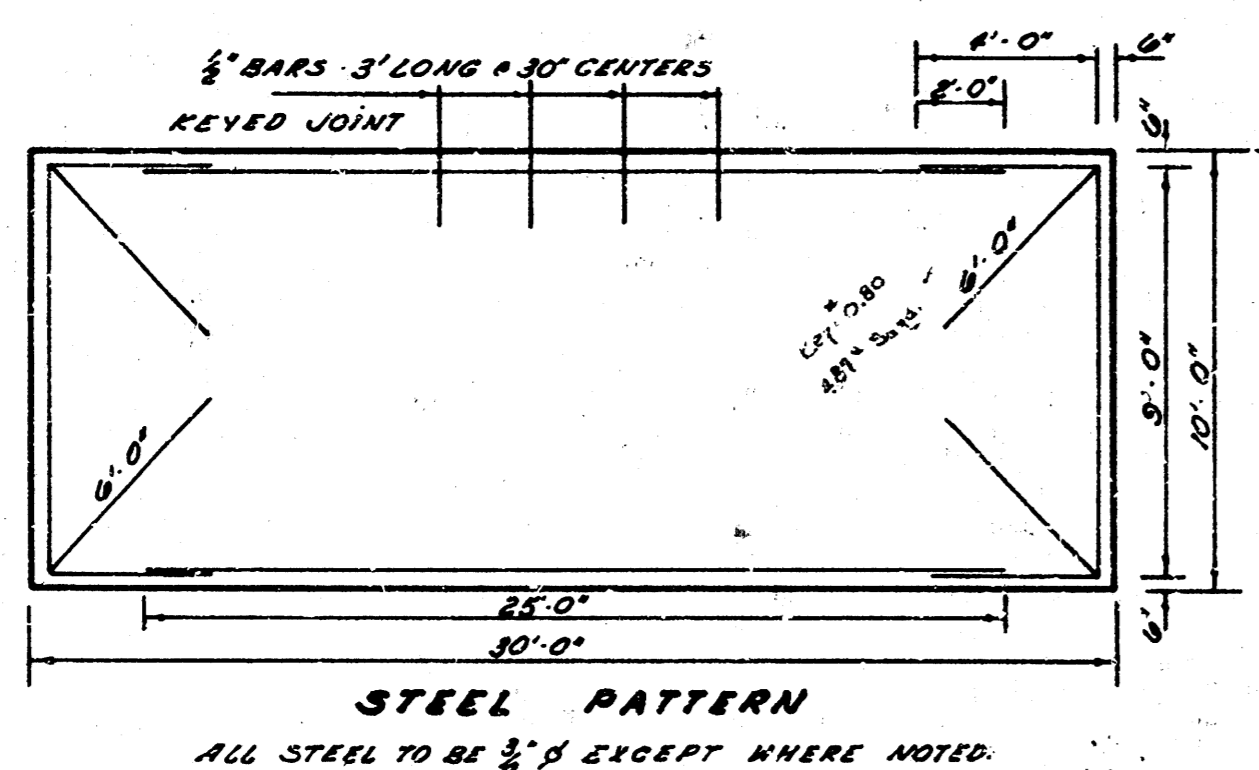

RIGGS
 ELLIOTT
 ENGINEERS



ALLEY EAST OF HYDRAULIC AVE.
 N.L. PANNEE TO N.L. ALLEY N. OF PANNEE.
20' — 7\"/>

CITY OF NICHITA, KANSAS
 B.E. SMITH CITY ENGINEER
 DATE PROJ No. C/18-123