

Base Line: is S.L. of Alley  
 BM: 101.39 S End W.Cb. Alley Return Between Meridian & St. Clair @ S.L. Pawnee.

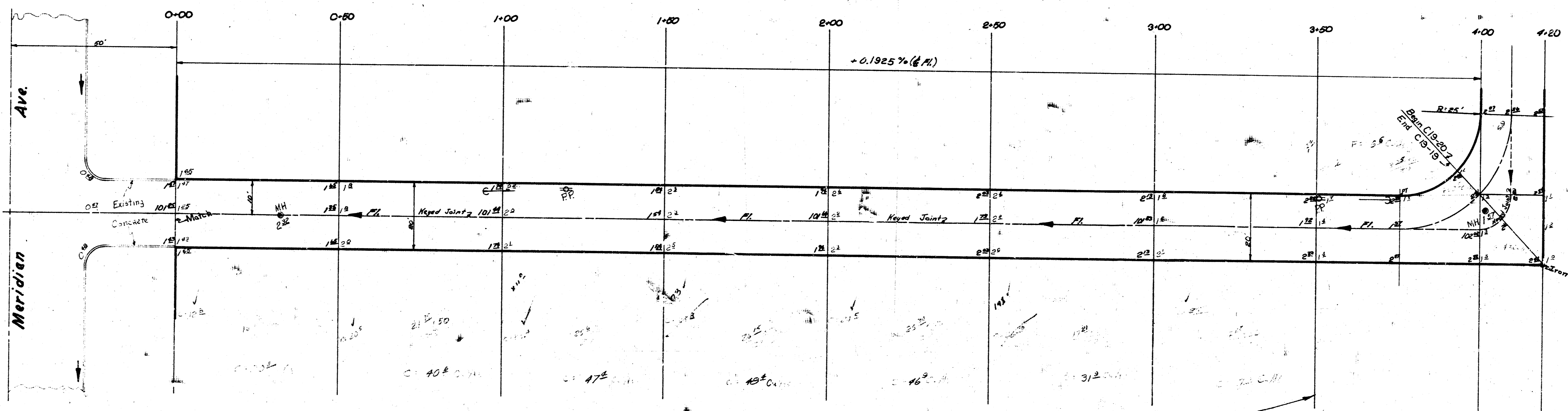

Survey Done 11/20/68  
 Plan 1/11/69  
 City Engineer

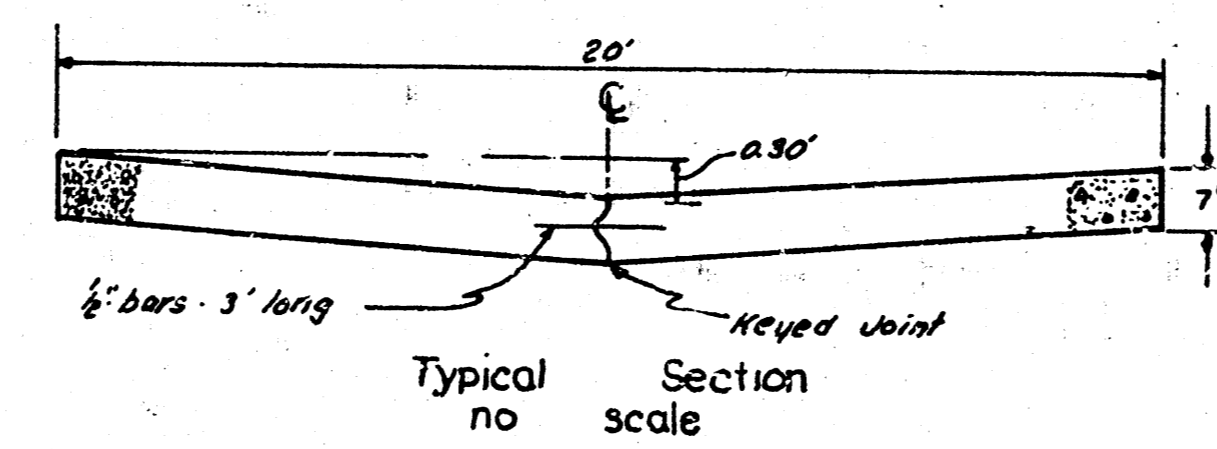
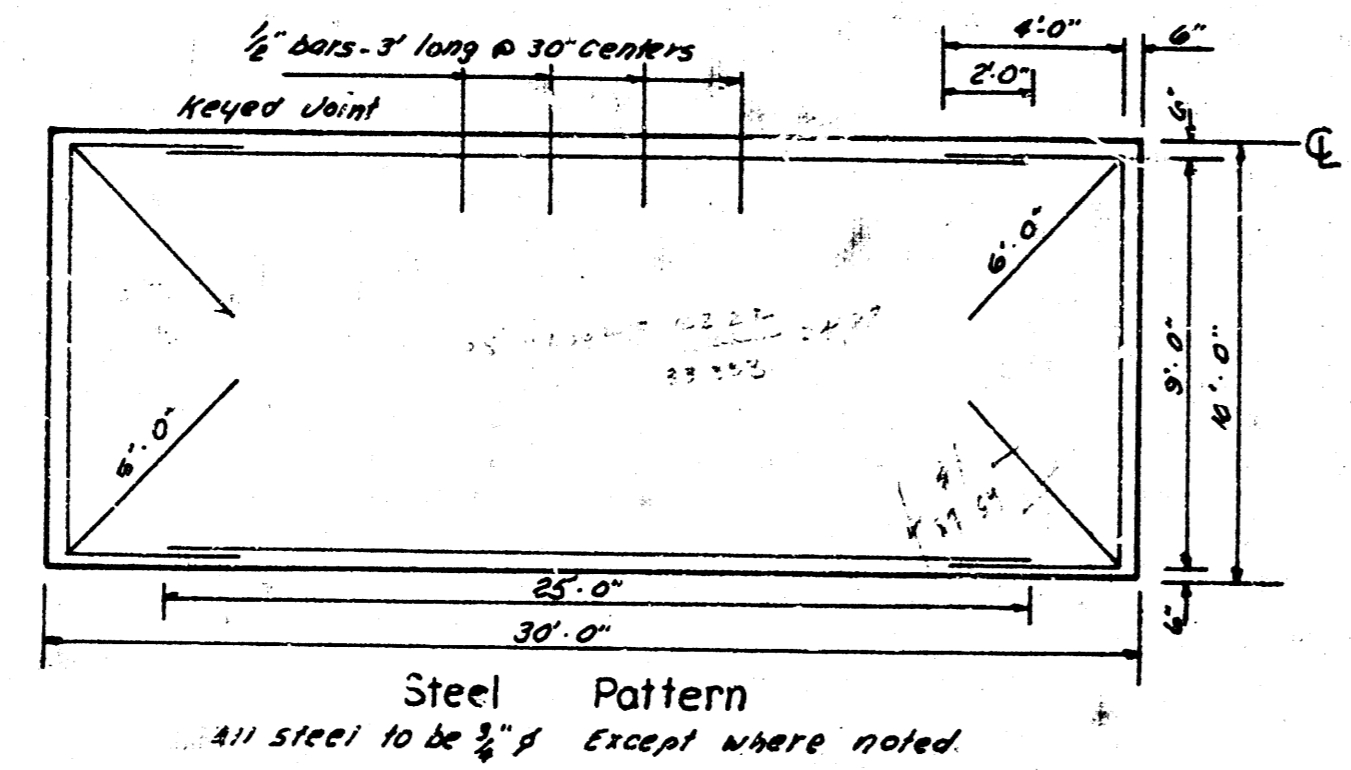

Excavation

|                      |
|----------------------|
| 253.6 Cu. Yds.       |
| +10% 25.4 "          |
| Total 279.0 Cu. Yds. |

Comp. Fill

|                     |
|---------------------|
| 13.7 Cu. Yds.       |
| +10% 1.4 "          |
| Total 15.1 Cu. Yds. |

1040 Sp. Yds. Lime Treated Sub Grade

**"ALLEY BET. PAWNEE & SAVANNAH"**

From EL. Meridian to EL. Alley W. of St. Clair.

20'-7" CONCRETE

CITY OF WICHITA, KANSAS

B.E. Smith City Engineer

Date JULY 1969 Proj. No. C19-18

