

B.M. 141.53 FEEDE K&E MANHOLE RIM AT SE COR. LORRAINE & CENTRAL  
 SET IN CONC. WALK  
 B.M. 140.98 SPIKE N.S. POWER POLE AT W. LINE OF LORRAINE & N. LINE ALLEY  
 STATION & BASE LINE ON E OF ALLEY

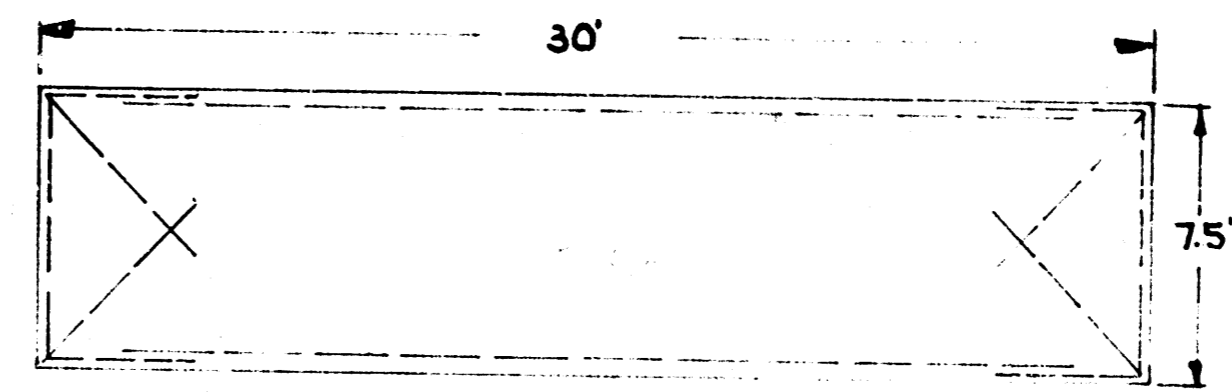

NORMAL CONC. STEELPATTERN - U BARS 14.5' LONG

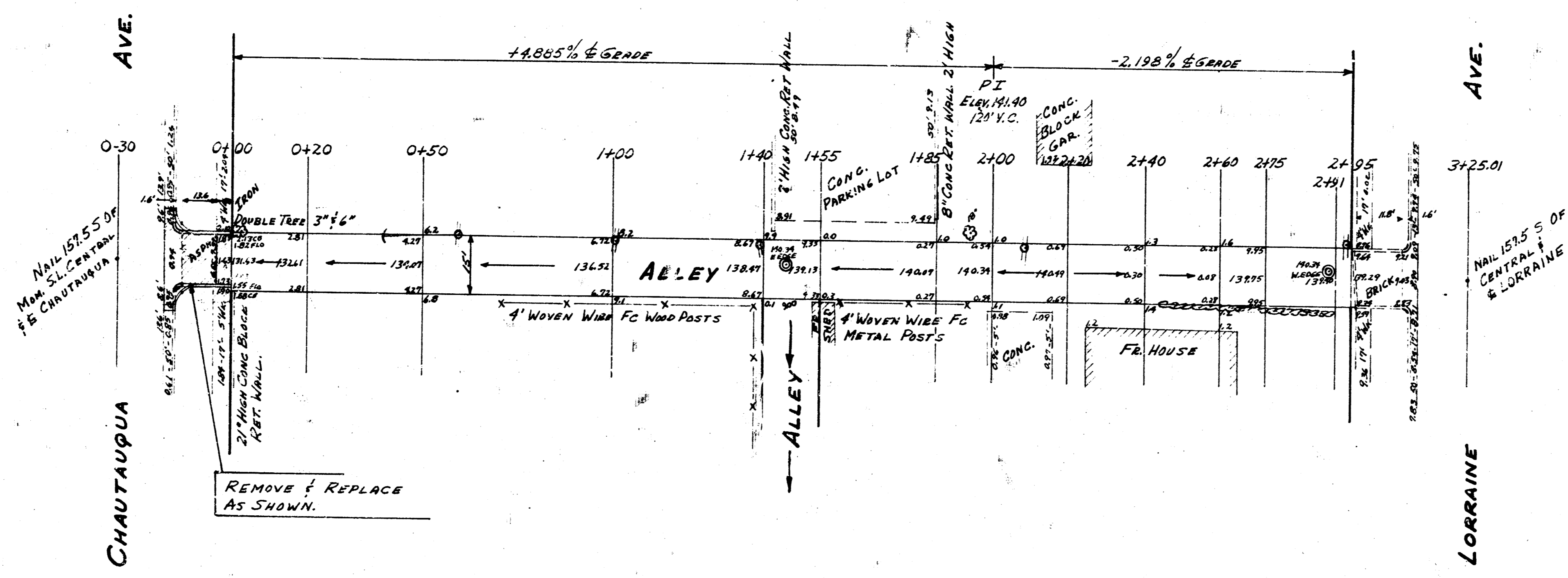

ALLEY SOUTH OF CENTRAL  
 EL CHAUTAUQUA TO WL. LORRAINE  
 15' CONC. 6" THICK.  
 CITY OF WICHITA KAN.  
 B.E. SMITH CITY ENGINEER  
 MARCH 1955 PROJ. NO. C14-907

