

B. M. 107.02 "a" on S. end opp. wk. @ N. cb. NW cor. Dewey & Topeka.  
 B. M. 108.50 NW cor. Broadway & Dewey "a" on W. cb. Broadway c. of wk. W.  
 Base = E. ALLEY

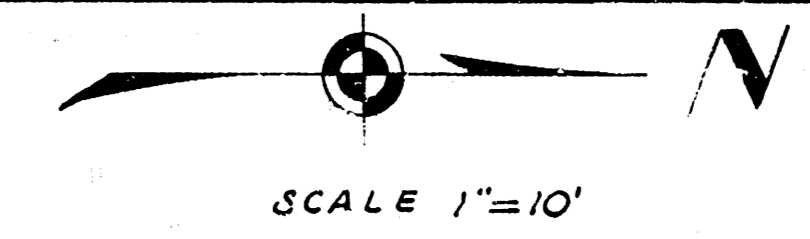

**NOTE TO CONTRACTOR**  
 This project will be constructed under the supervision of the CITY ENGINEER and conforming to the SPECIFICATIONS of the CITY OF WICHITA. The CONTRACTOR will reimburse the City of Wichita for all cost of Engineering, Plans, and Inspection.

**NOTE:**  
 Alley return at Kellogg to be constructed by State, before alley is paved. Grades shown at Kellogg are proposed grades.

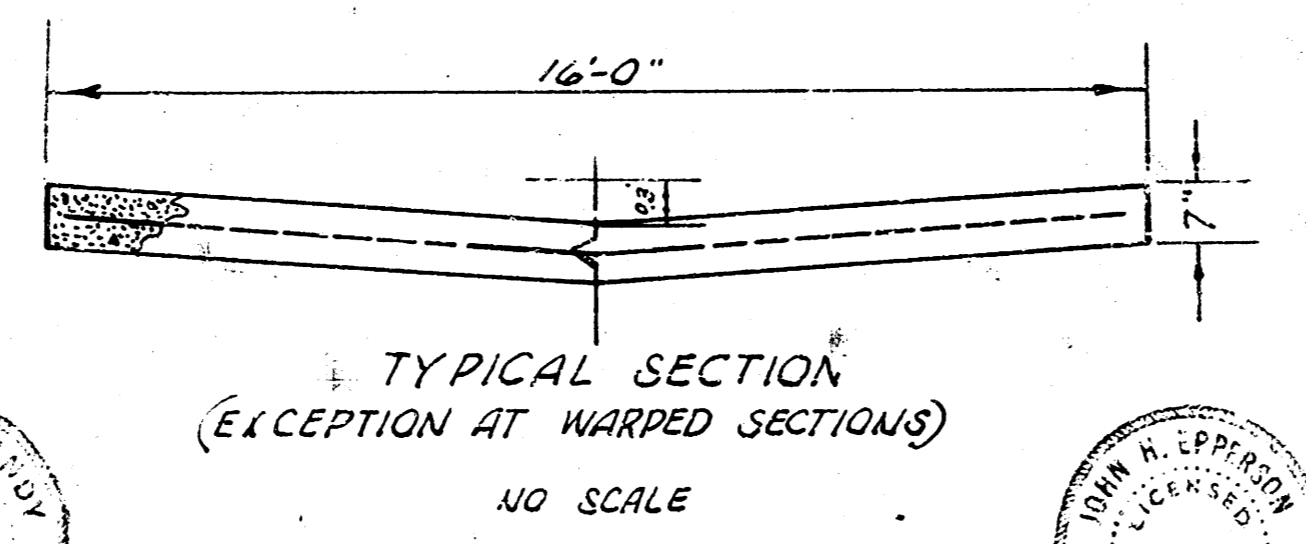
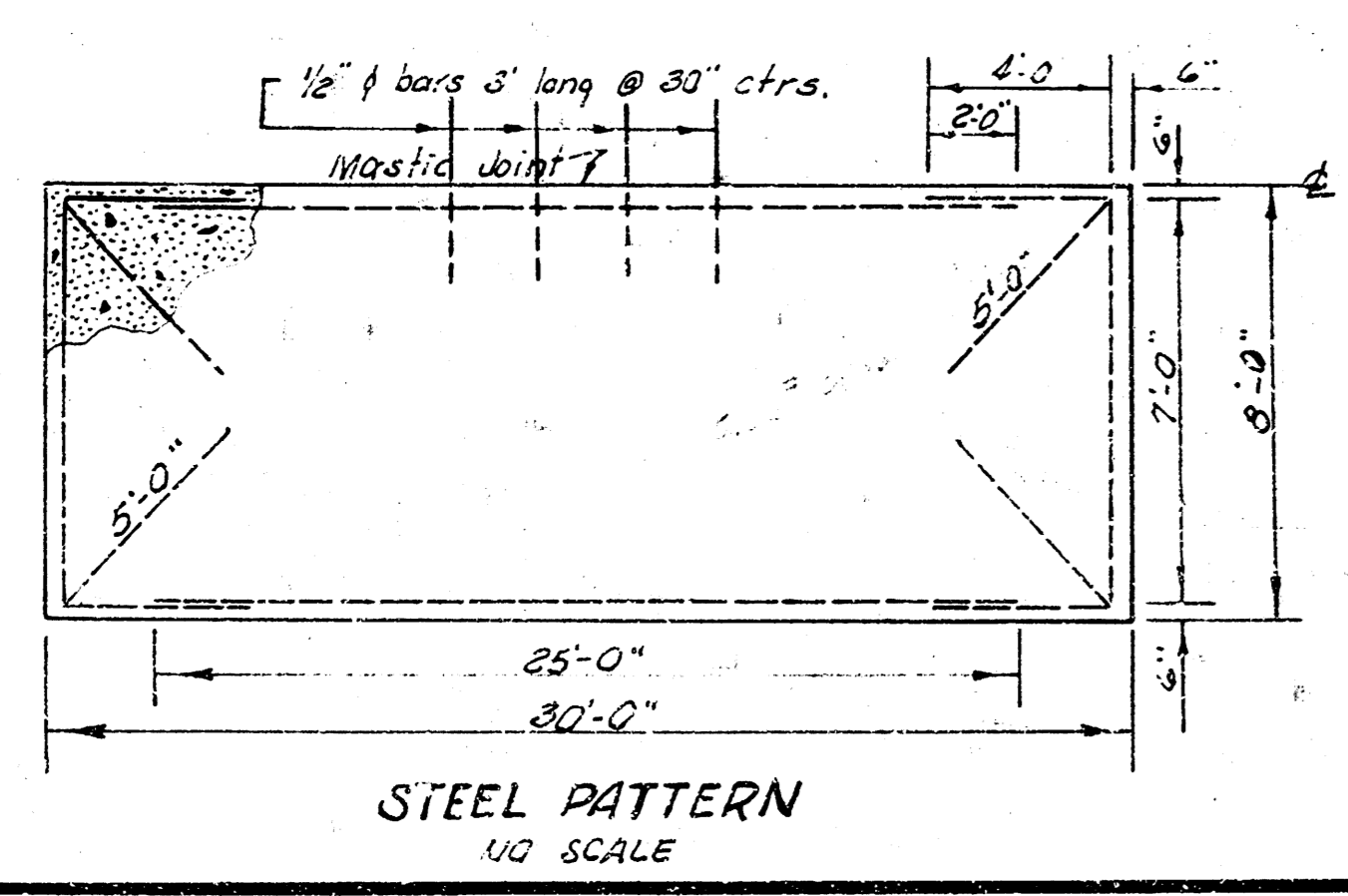
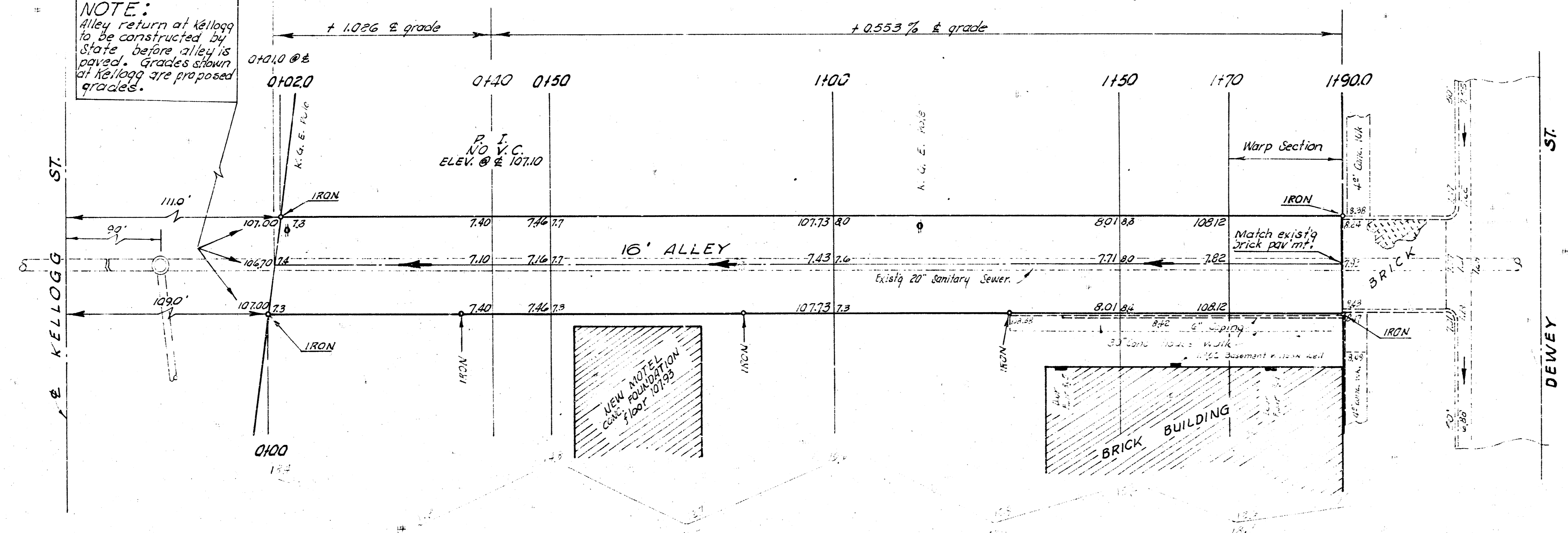

ESTIMATED QUANTITIES	
337.8	Sq. Yds 7" Conc.
2050.0	Lbs. Reinf. Steel
96.2	Cu. Yds. Excavation
190.0	Lin. Ft. Mastic Joint

**ALLEY**  
 BETW. BROADWAY AVE. & TOPEKA AVE.  
 NL KELLOGG TO SL DEWEY  
**16' CONC.-7"**  
 CITY OF WICHITA, KANSAS  
 B. E. SMITH CITY ENGINEER  
 PRIVATE CONTRACT

