

B.M. 116.20 Std. 23.5' S. & 37.5' E. Thimble at Broadway & 13th St.

B.M. 118.16 R.R. Spike in pole on E.L. Alley between Broadway & Topeka, 21' S. of & 14th St.

Scale: 1" = 20'

Sidewalk removed to be replaced with 6" walk.

NOTE:
Contractor to Excavate & Pour Concrete Pavement 6" Extra Width Under Existing Walk West Side Alley (See Detail). This Work to be Incidental To Price Bid for Sq. Yds. Pavement.

DETAIL OF WALK Sta. 0+08 to 1+56.7 (L.F.)
Scale: 1/8" = 1'

END PAVEMENT 3+66

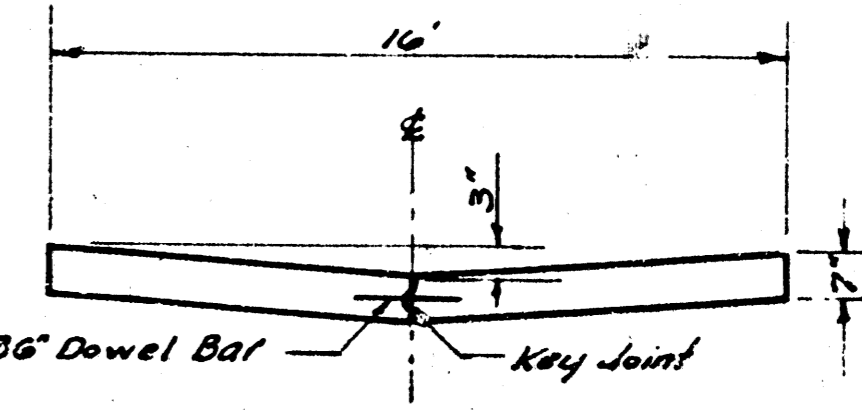

TYPICAL SECTION
No Scale:

NOTE: All steel to be #6 bars unless otherwise noted.

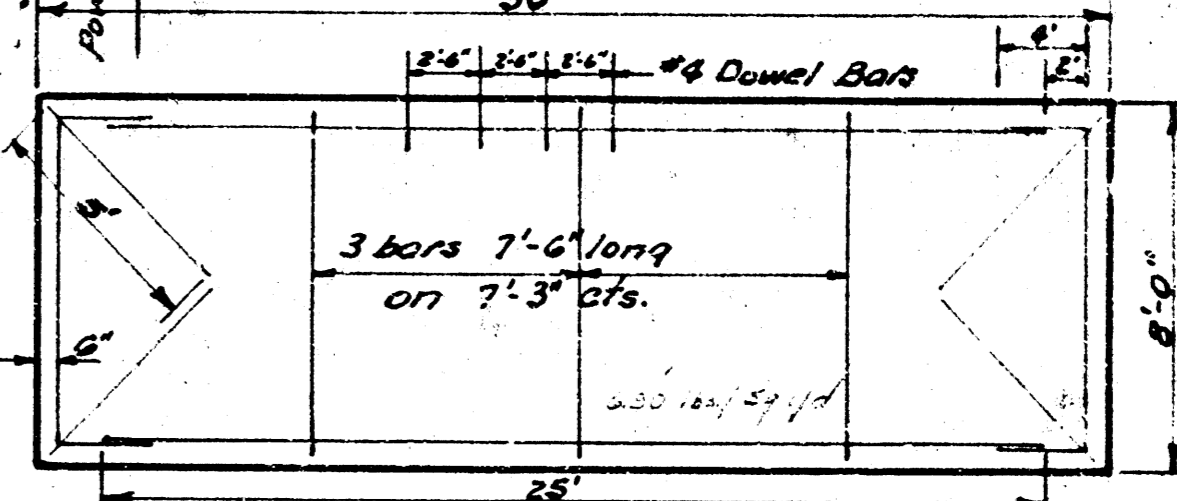

STEEL PATTERN
No Scale:

EXCAVATION		
PROPERTY	CITY	
+10 ft.	255 Cu. Yds.	5 Cu. Yds.
	26 "	"
Totals	281 Cu. Yds.	5 Cu. Yds.

ALLEY between BROADWAY and TOPEKA - N.L. 14th Sx to N.L. Lots 1 & 2 DUBOIS and CORNS ADDITION
16'-7" CONCRETE
B.E. SMITH CITY ENGINEER
CITY OF WICHITA KANSAS
Date: Dec. 1922 5443503025
Project No. C19-53

