

BM+192.15 STANDARD N.W. COR WOODLAWN & CENTRAL
 BM+184.12 "E" IN RITCHIE, W. CURB, ST JAMES & N.L. CENTRAL.
 BM+185.86 R.R. SPIKE N. SIDE P. POLE ON N. SIDE CENTRAL 40' EAST
 OF ALLEY, BET WOODLAWN & ST JAMES.

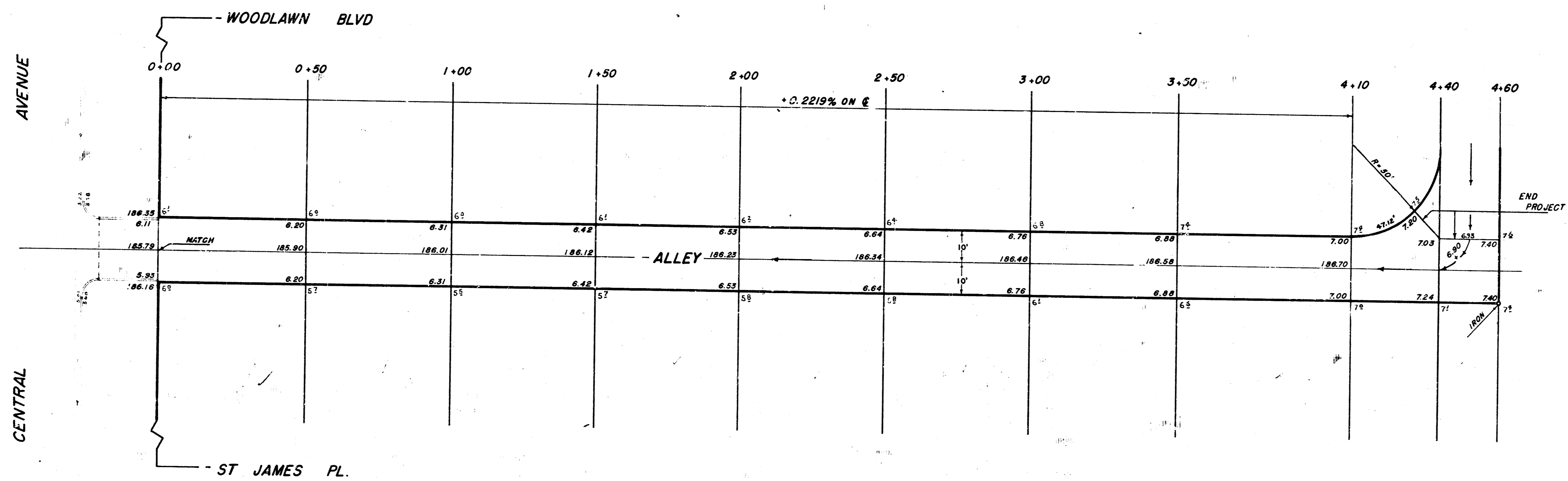

Survey Made By: R. F. F. F.
 Plan Checked By: J. H. H.
 Exc. Checked By: J. H. H.

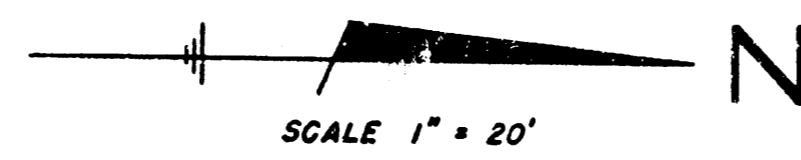
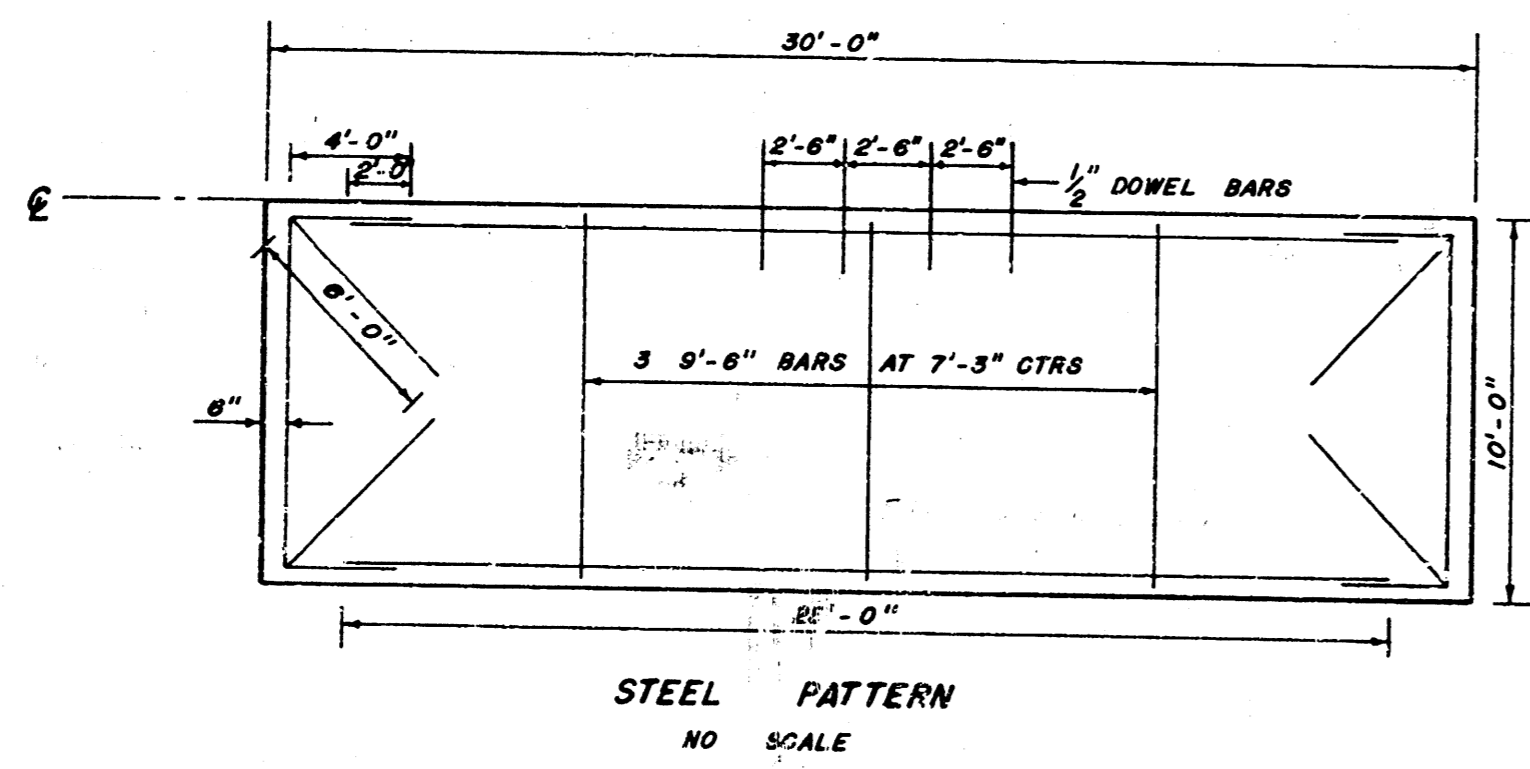

NOTE:
 ALL REINF STEEL TO
 BE 3/8" Ø BARS - EXCEPT
 DOWEL BARS.

EXCAVATION	COMP FILL
162.4' CU YARDS	3.3 CU YARDS
10% 16.2 " "	10% 0.3 " "
TOTAL 178.6 CU YARDS	3.6 CU YARDS

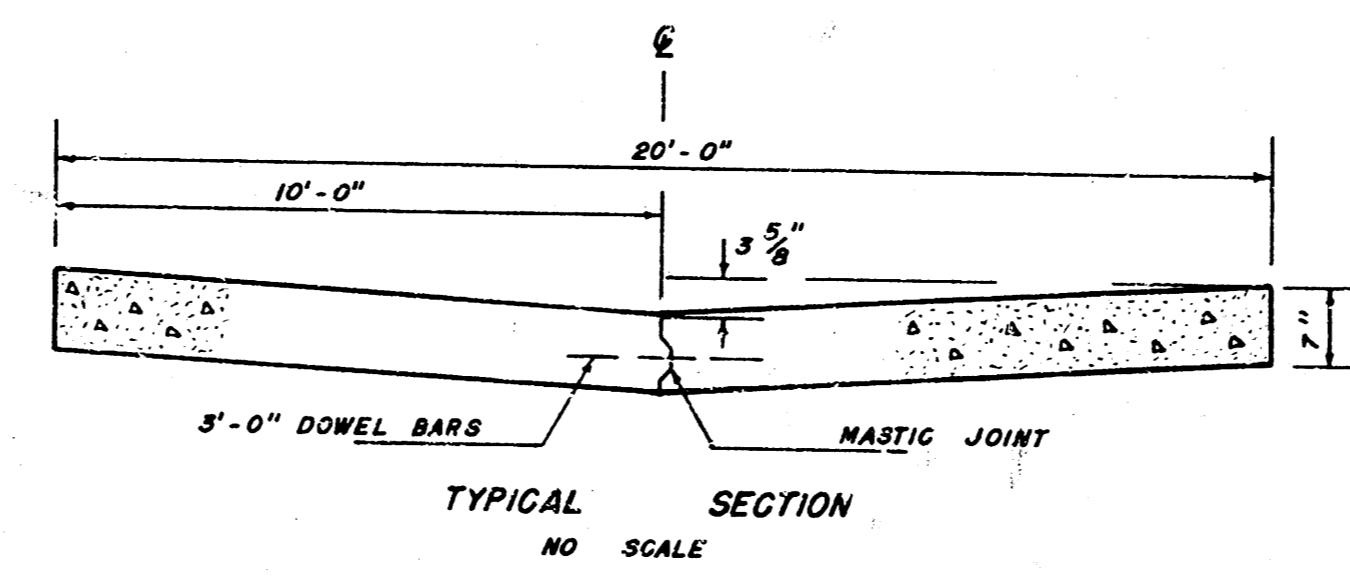

LIST OF QUANTITIES	FINAL
1030.0 SQ YDS PAVEMENT	1,040.35
178.6 CU YDS EXCAVATION	162.5 CY
3.6 CU YDS COMP FILL	3.3 CY
480.0 LIN FEET MASTIC	883.0 LF
6705.0 LBS REIN STEEL	6,920 LBS

ALLEY E. OF WOODLAWN
 N. L. CENTRAL TO N. L. ALLEY N. OF CENTRAL.
20' - 7" CONG-PAVEMENT
 B. E. SMITH CITY ENGINEER
 CITY OF WICHITA, KANSAS
 DATE: 4/20/35 PRIVATE PROJECT