

B.M. 18939 Extreme N.E. Cor Stone monument N.E. Corner 13th and Armour.
 B.M. 19732 "M" in Mueller Fire Hydrant S. side 13th 150' E. of N.S. alley E. of Woodlawn.

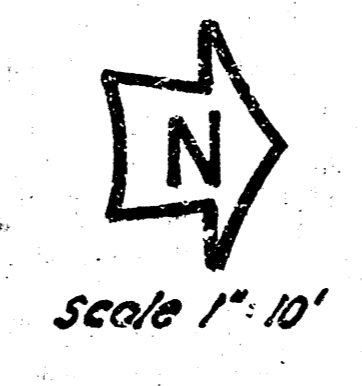

WOODLAWN BLVD

Excavation - 9.4 cu yds
 Comp Fill - 32.5 cu yds

DERBY SERVICE

Pop pump
 Island 19048

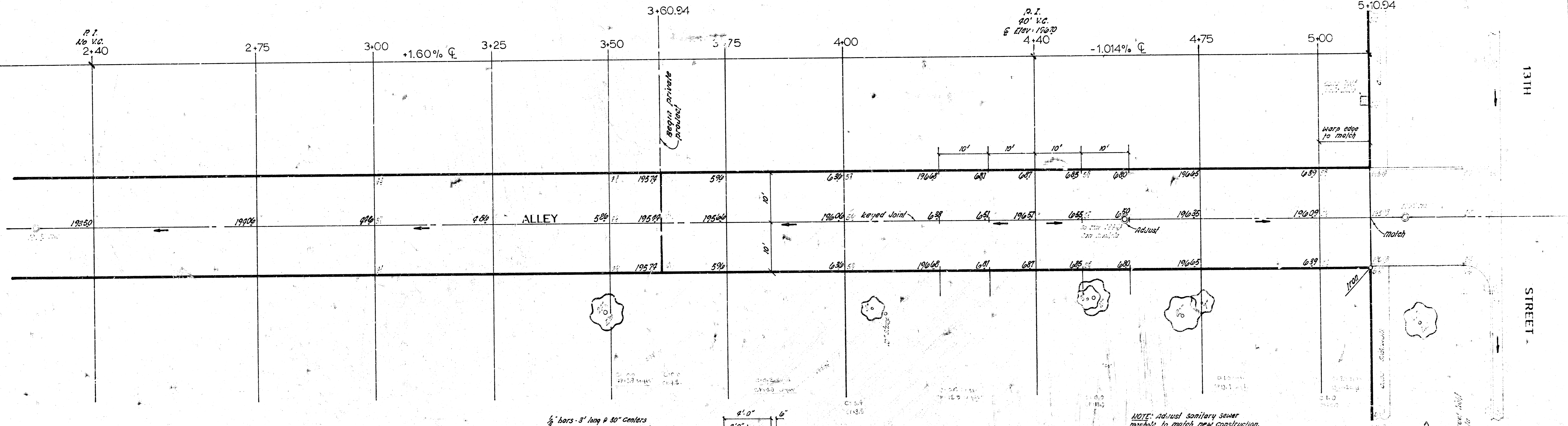

NOTE TO CONTRACTOR
 This project will be constructed under the supervision of the CITY ENGINEER and conforming to the SPECIFICATIONS of the CITY OF WICHITA. The CONTRACTOR will reimburse the City of Wichita for all cost of Engineering, Plans and Inspection.

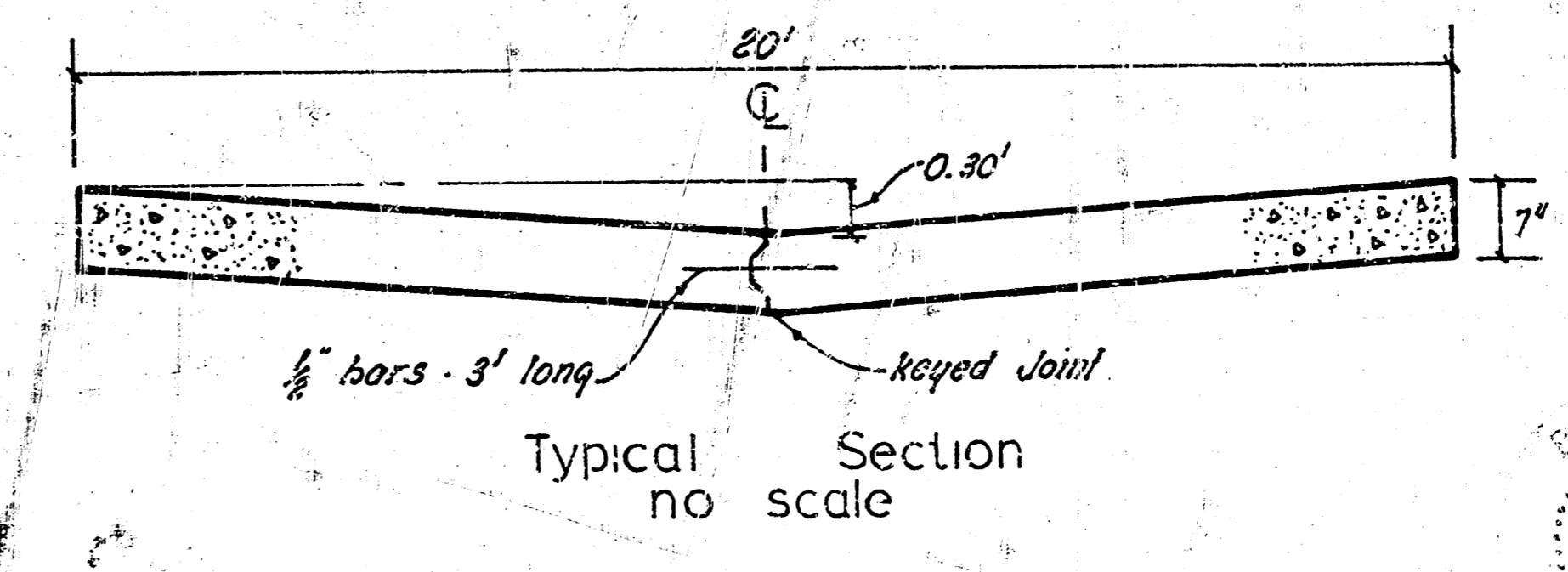
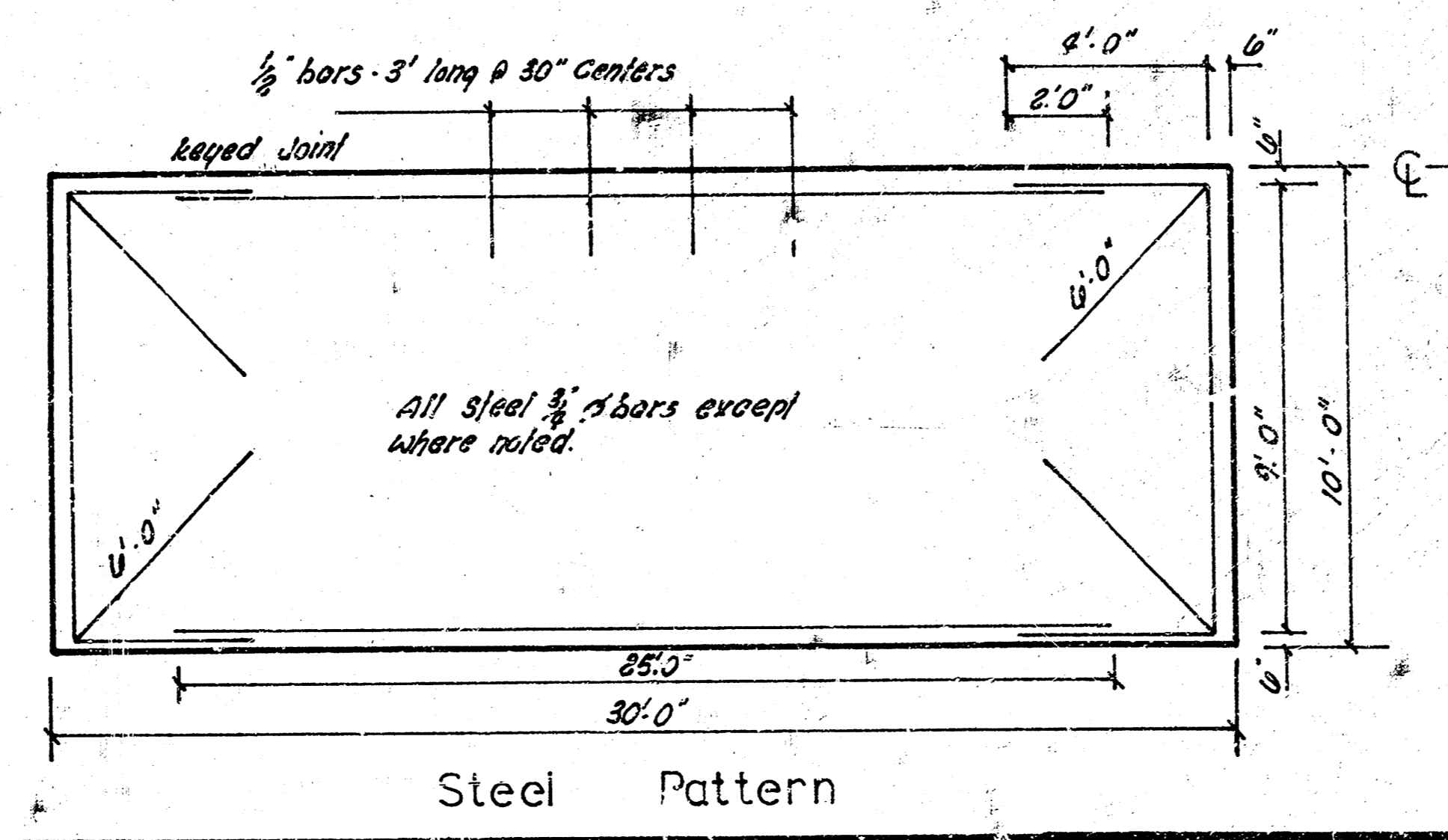

NOTE: Adjust sanitary sewer matches to match new construction.

ALLEY Bet Woodlawn and Stratford
 S.L. 13th St. to 150' South S.L. 13th St
 CITY OF WICHITA, KANSAS
 20'-0" x 7" Concrete

B.E. SMITH City Engineer

Date MARCH 1971 Private Project

