

NOTE:
 BAR SIZING, CONCRETE SPECIFICATIONS,
 AND OTHER CONSTRUCTION DETAILS TO BE
 IN ACCORDANCE WITH THE CITY OF WICHITA
 SPECIFICATIONS.

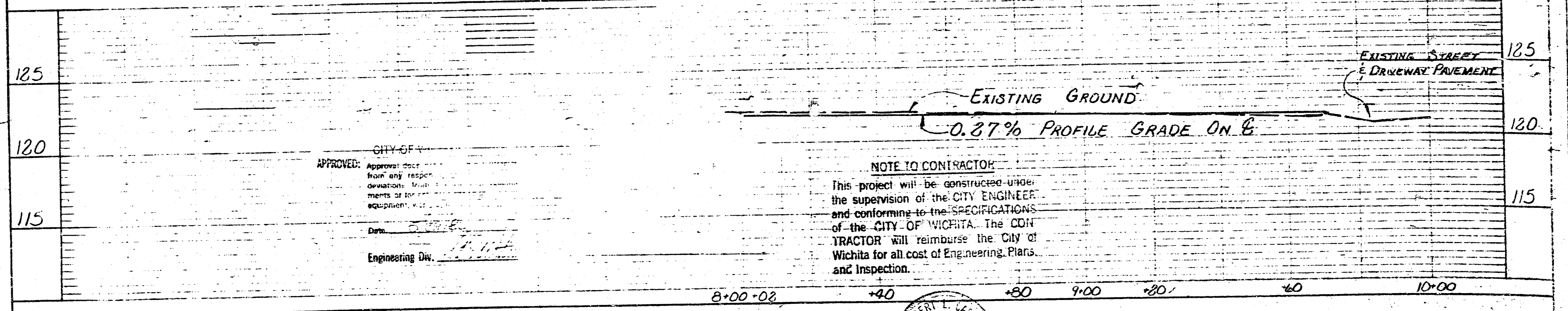

CITY OF WICHITA
 APPROVED: [Signature]
 [Title]
 [Date]

NOTE TO CONTRACTOR:
 This project will be constructed under
 the supervision of the CITY ENGINEER
 and conforming to the SPECIFICATIONS
 of the CITY OF WICHITA. The CON-
 TRACTOR will reimburse the CITY of
 Wichita for all cost of Engineering Plans
 and Inspection.

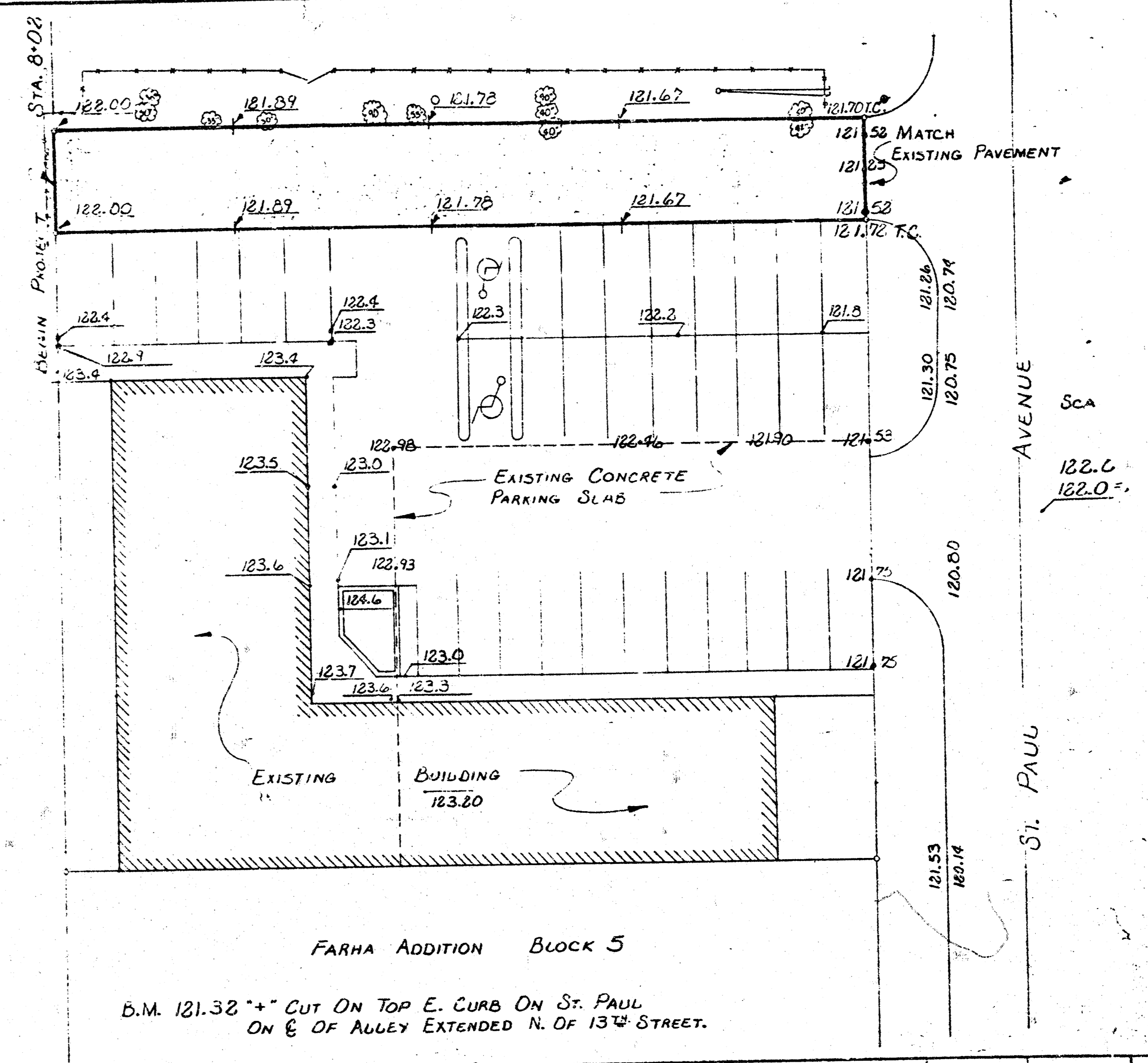
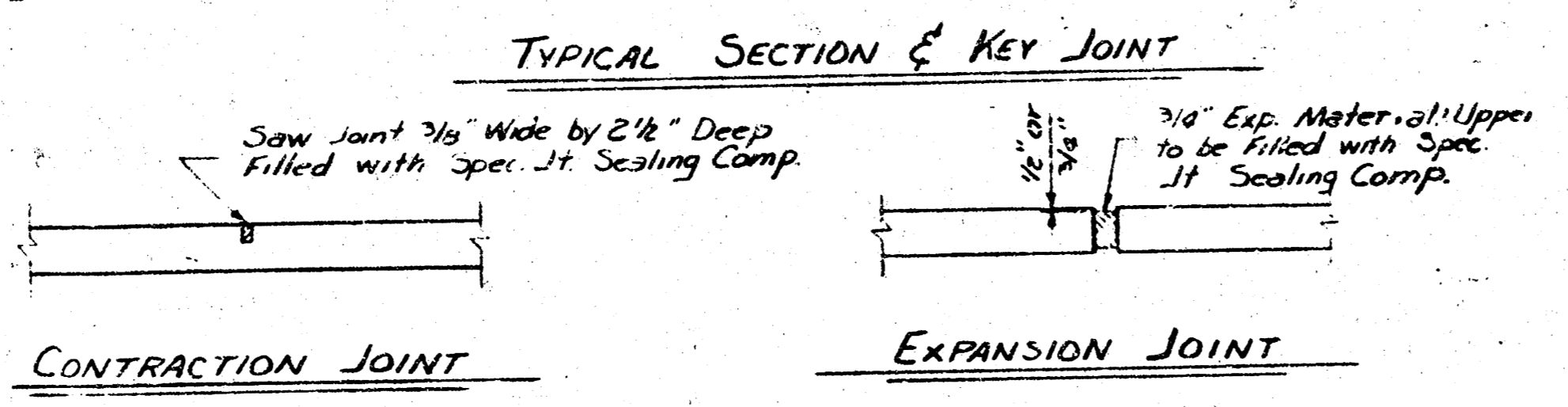
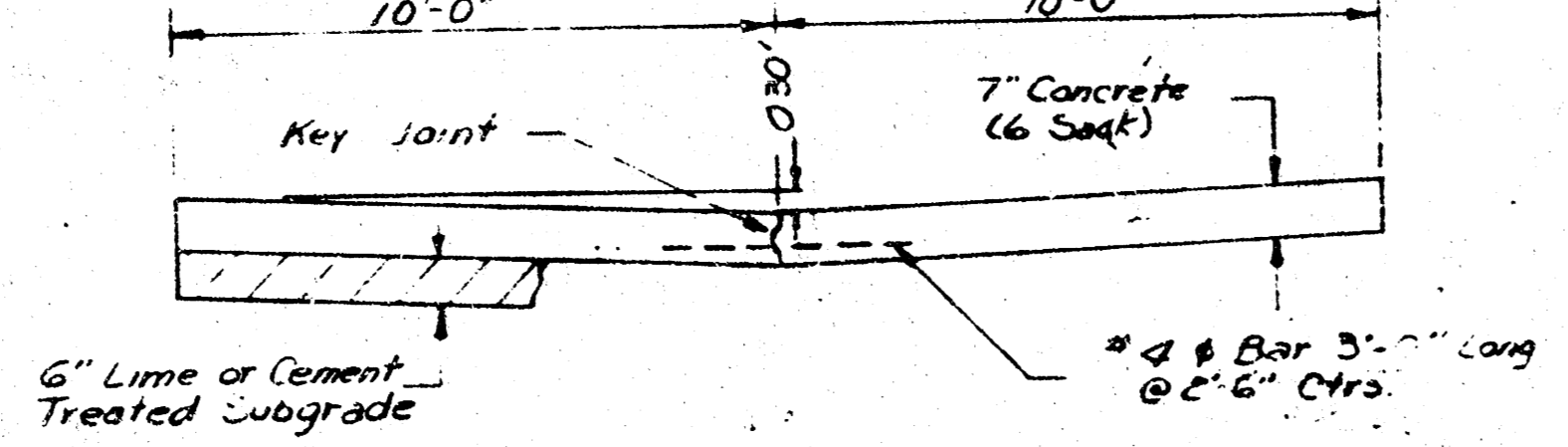
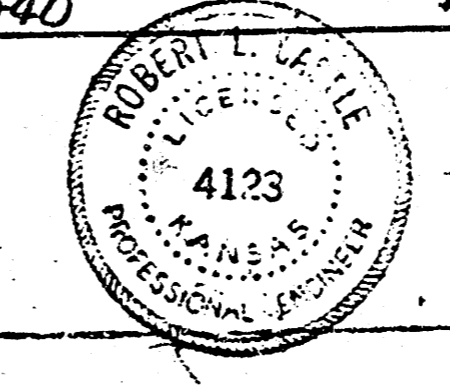

PANKRATZ CONSTRUCTION CO. INC. CO. OFF. BLDG. 1213 1/2 W. 13th St. Bldg. 111 - McCombe - GODDARD, KANSAS
 PLAN AND PROFILE
 IMPROVEMENT E-W ALLEY
 BLOCK 5 FARHA ADDITION
 MAY 1980
 SHEET 11A