

B.M. = 112.59 "C" IN CONST. ON Q. WALK WEST S.W. CORNER ST. FRANCIS & 3RD ST.

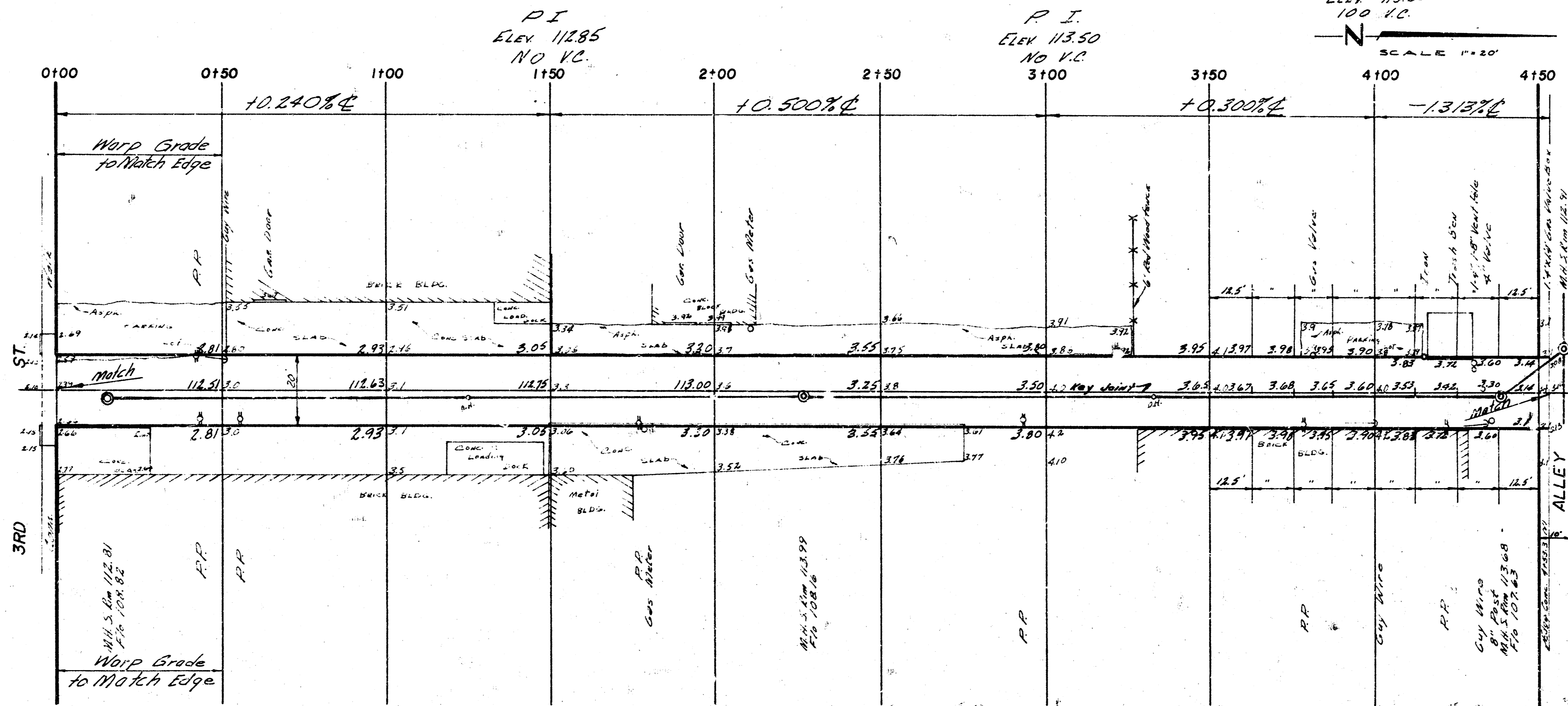

19 P.P.S. 24x30 3/4  
 7-4 CARIBBS  
 1/4" DIA. 10' LONG

NOTE: CONTINUED & FIELD ENDS.  
 NO SUBGRADE MODIFICATION  
 WILL BE REQUIRED ON  
 THIS PROJECT.

EXCAVATION  
 303.2 C.Y.  
 30.3 1.0%  
 333.5 C.Y.

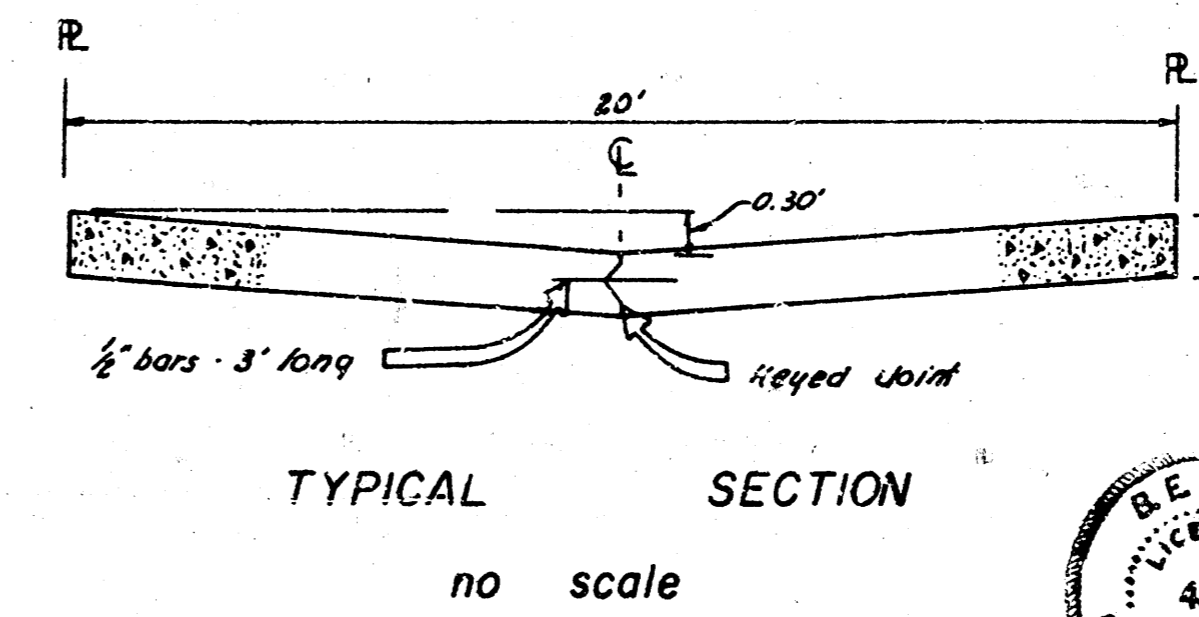
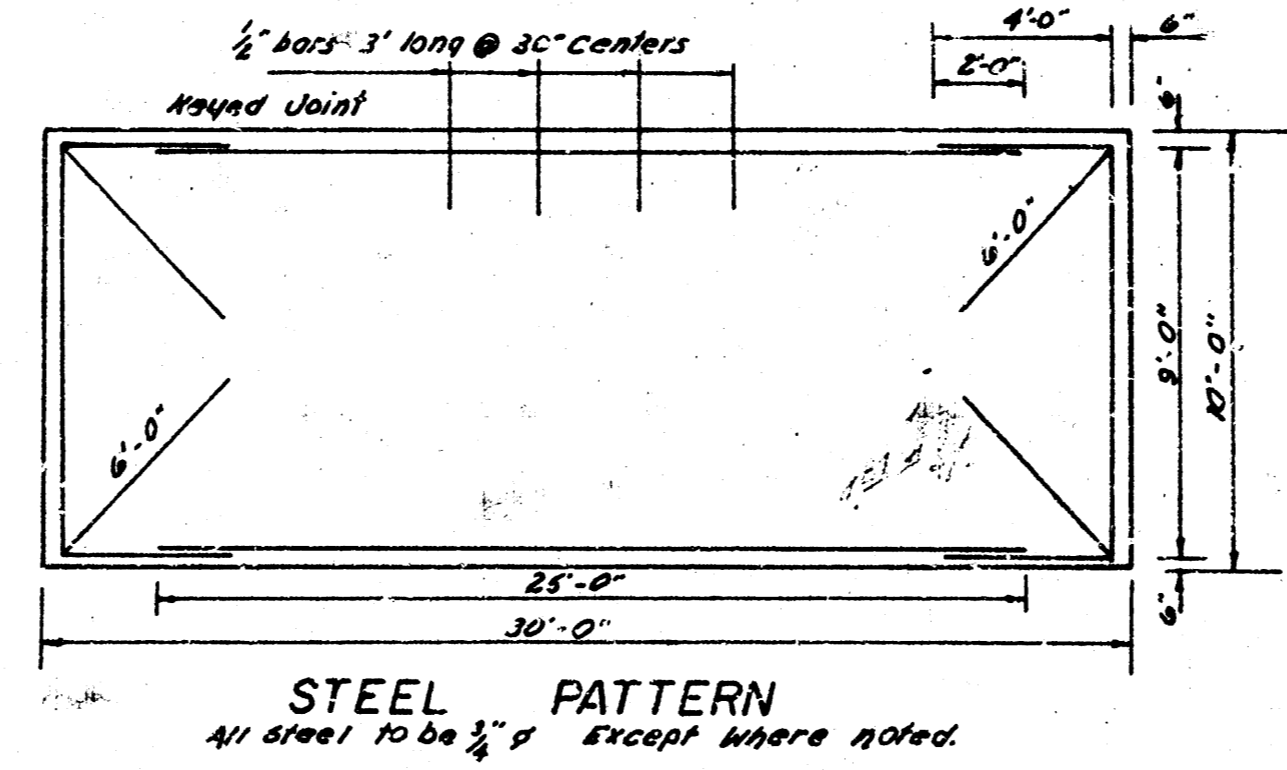

"ALLEY" Betw. St. Francis and  
 Santa Fe NL Third to S.L. of  
 Alley South of Central.  
 20' x 7" CONCRETE  
 CITY OF WICHITA, KANSAS  
 B.E. SMITH CITY ENGINEER  
 DATE 12/19/62 PROJECT C18-107

