

B.M.  
 0+00 5-0 Left and 2-6 South  
 North side M.H. ring  
 City of Wichita datum Elev 111.52

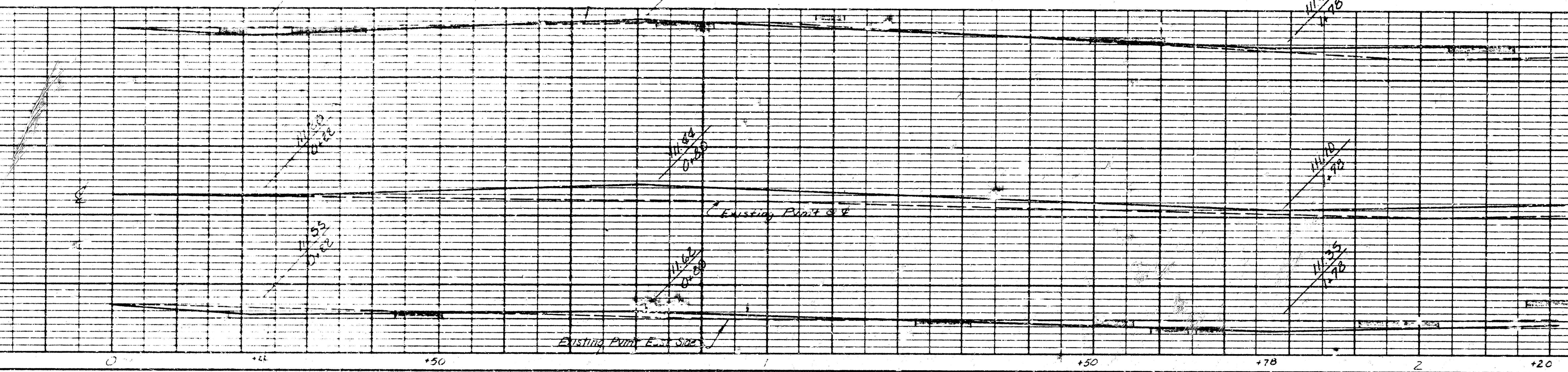

CITY OF WICHITA		NOTE TO CONTRACTOR	
APPROVED:	DATE: 7-21-78	This project will be constructed under the supervision of the CITY ENGINEER.	
DESIGNED BY:	BY: C&C	The City of Wichita reserves the right to alter or modify this plan and specifications without notice.	
CHECKED BY:	BY: C&C	The contractor shall reimburse the City of Wichita for inspection.	
APPROVED:	DATE: 7-21-78	BY: CITY ENGINEER OF WICHITA	
DESIGNED BY:	BY: C&C	APPROVED BY: [Signature]	
CHECKED BY:	BY: C&C	APPROVED BY: [Signature]	
APPROVED:	DATE: 7-21-78	BY: CITY ENGINEER OF WICHITA	
DESIGNED BY:	BY: C&C	APPROVED BY: [Signature]	
CHECKED BY:	BY: C&C	APPROVED BY: [Signature]	

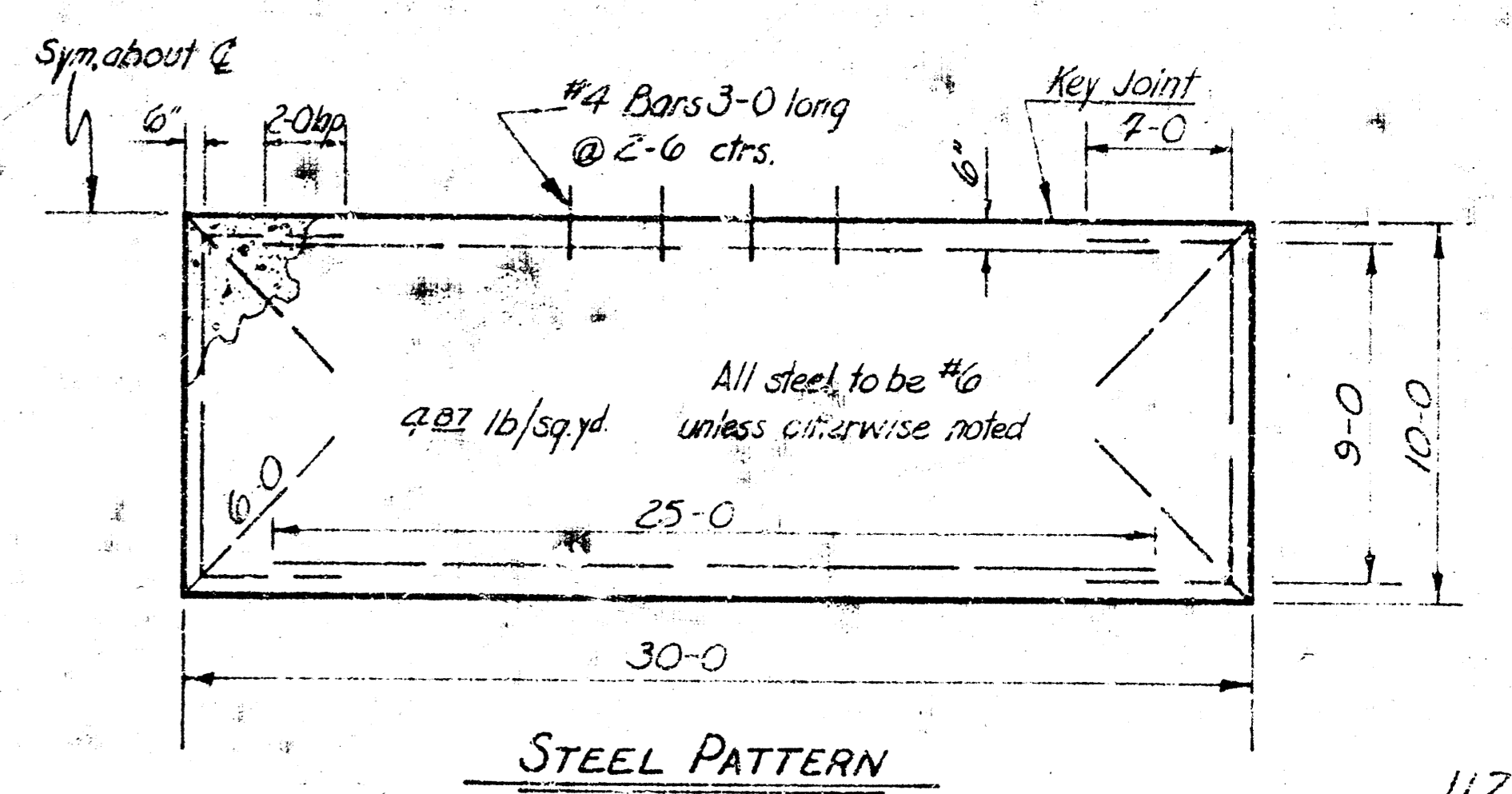
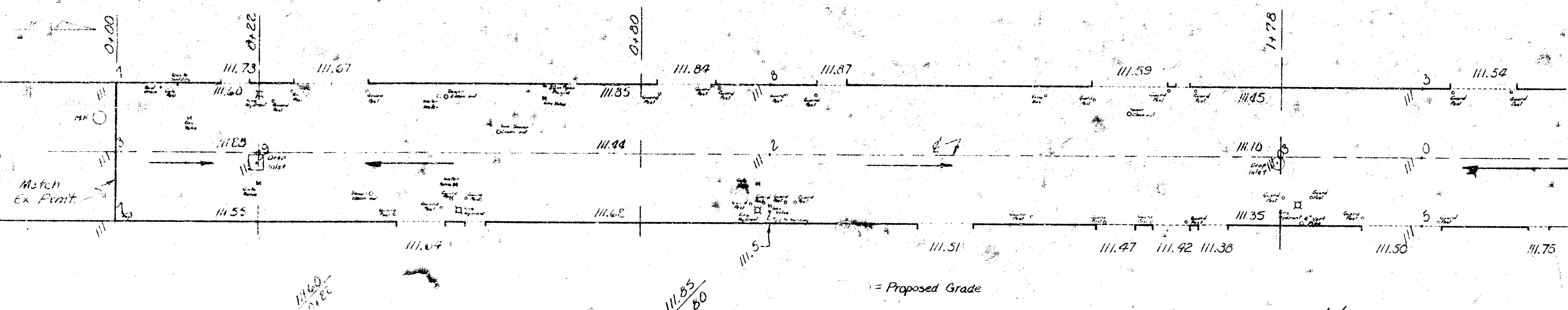
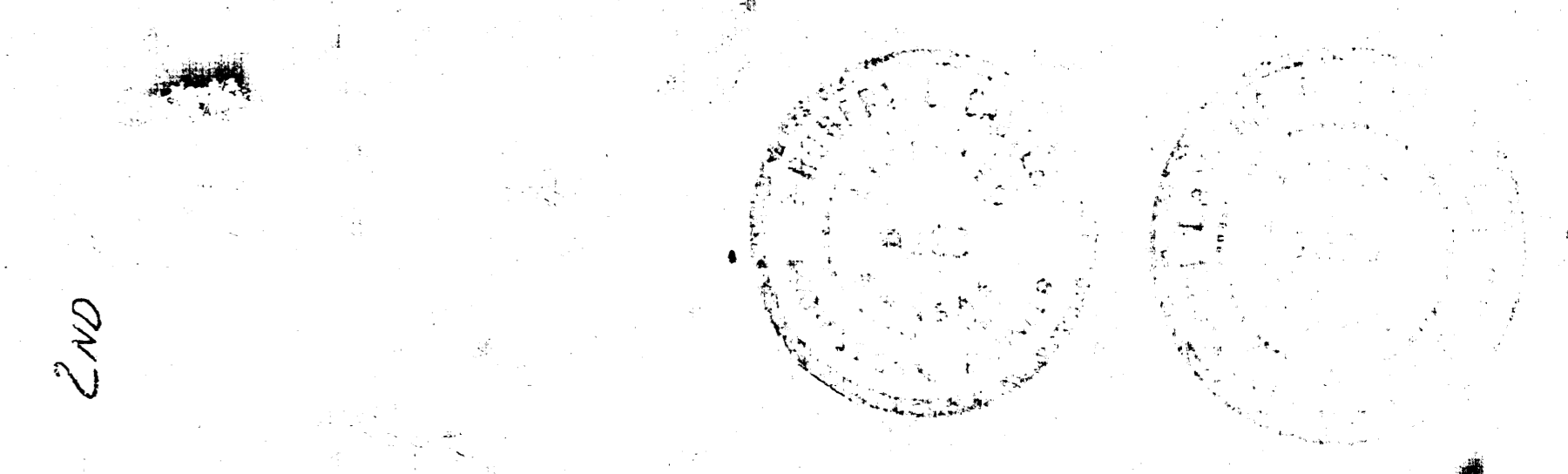
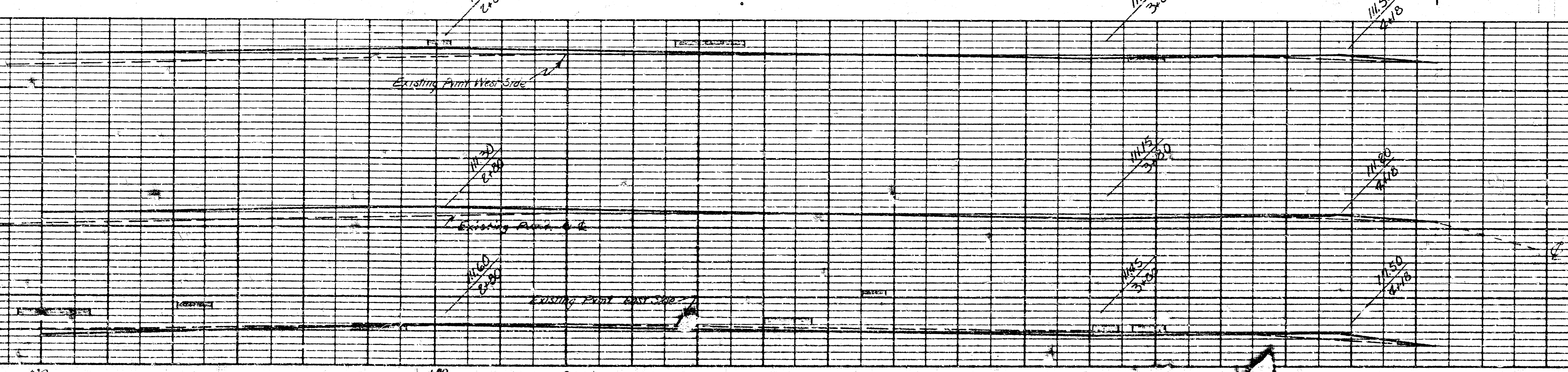
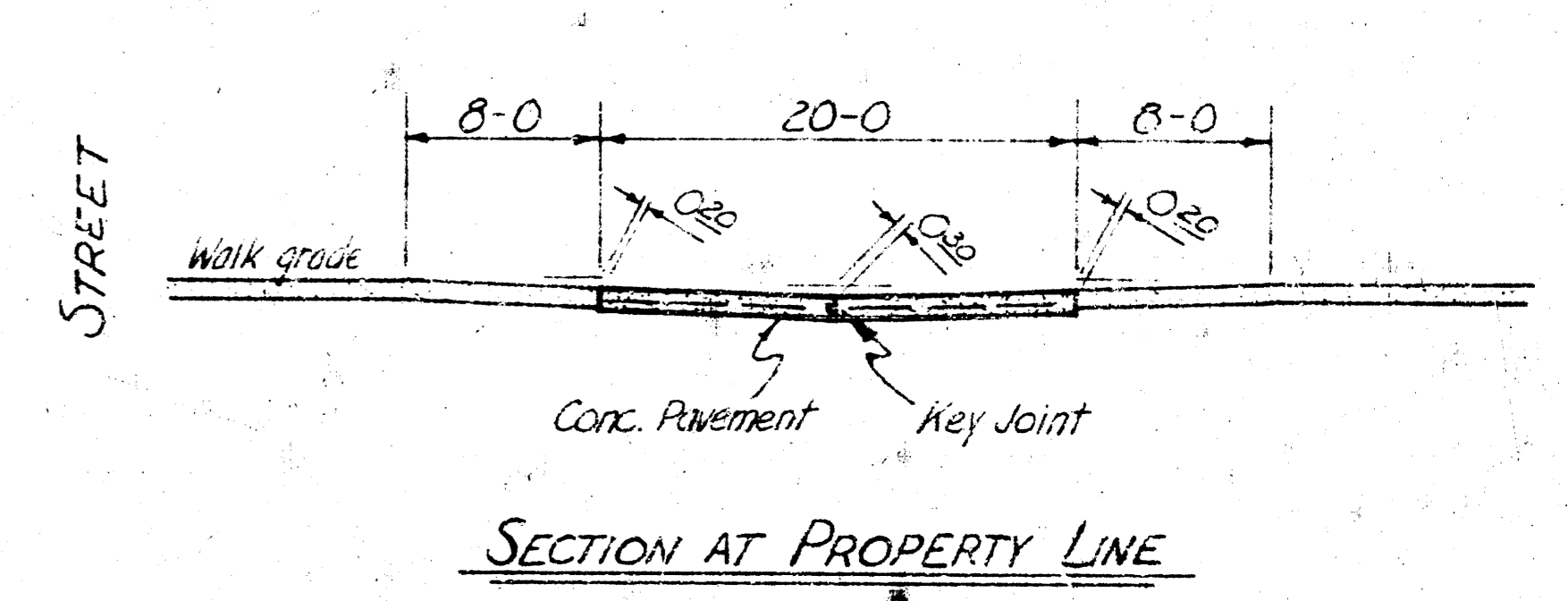
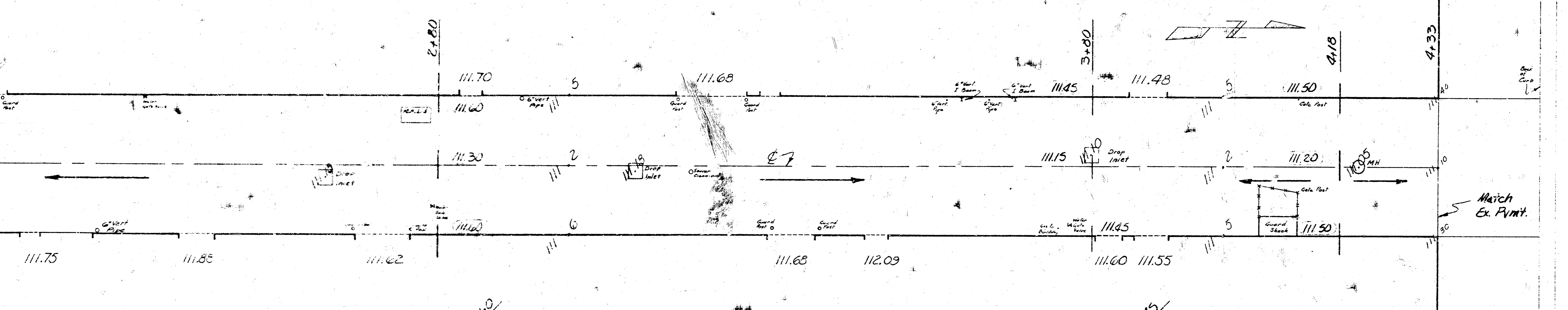

REV. A	7-21-78	R.E.M.	Deleted drop grades per City of Wichita request
MAJOR INC. WICHITA, KANSAS			
PLAN AND SPEC. AGILEY PAVEMENT			
SOUTH OF 2ND STREET, BETWEEN OF SPANAN & CAMPBELL STS.			
CAMPBELL & CASTLE	ENGINEERS	WICHITA, KANSAS	DATE: June 1978
DR. [Signature]	CH. [Signature]	APP. [Signature]	DATE: June 1978
SHEET NO 7 OF 7			REV. A