

B.M. 15145 S.E. Corner Conc. porch No. 1266 Cramer.

Scale: 1"=20'

DUNSWORTH AVE.

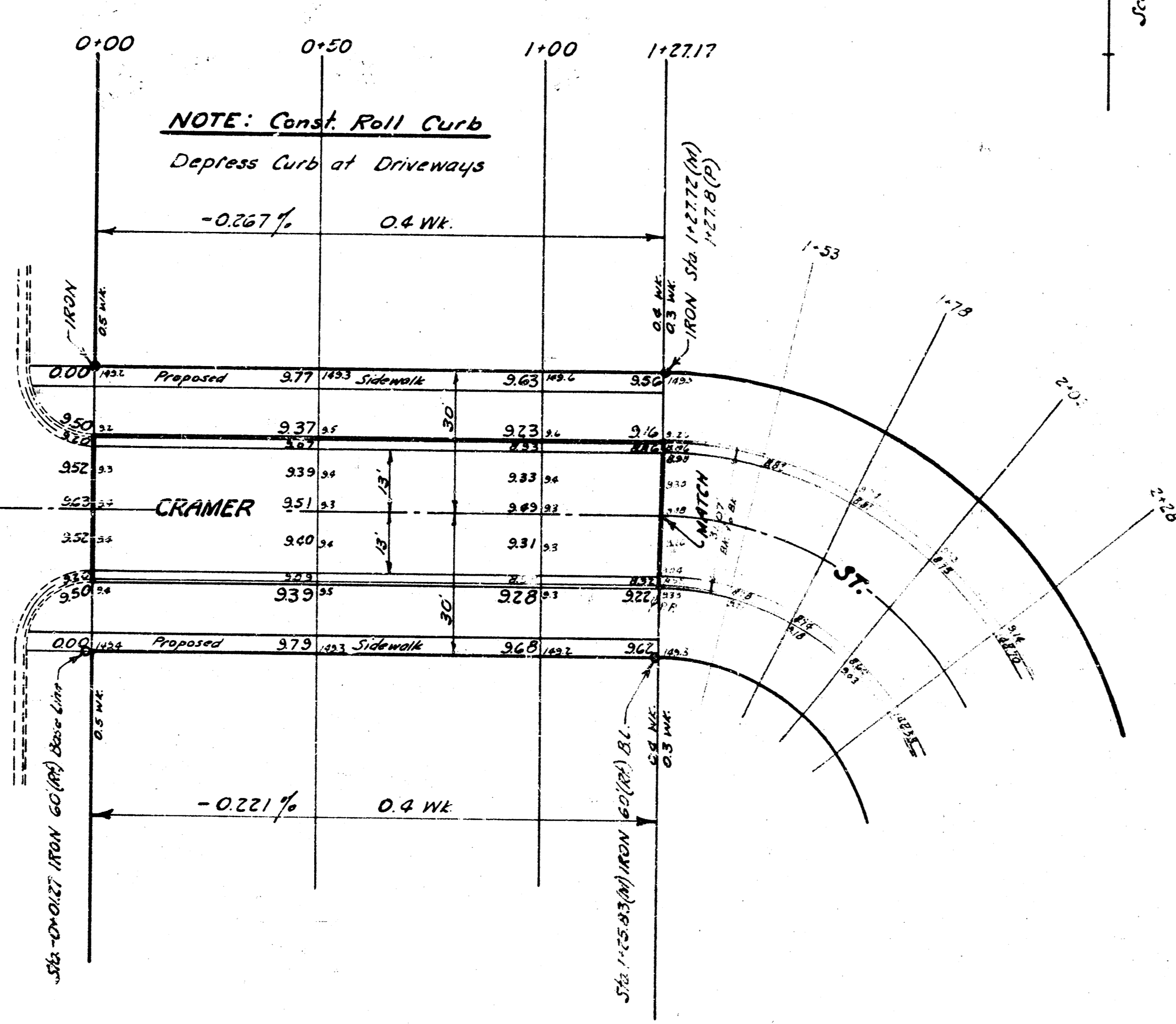

NOTE: Contractor to grade parkings, clear right-of-way and compact fill for proposed sidewalk. Sidewalk to be constructed by others.

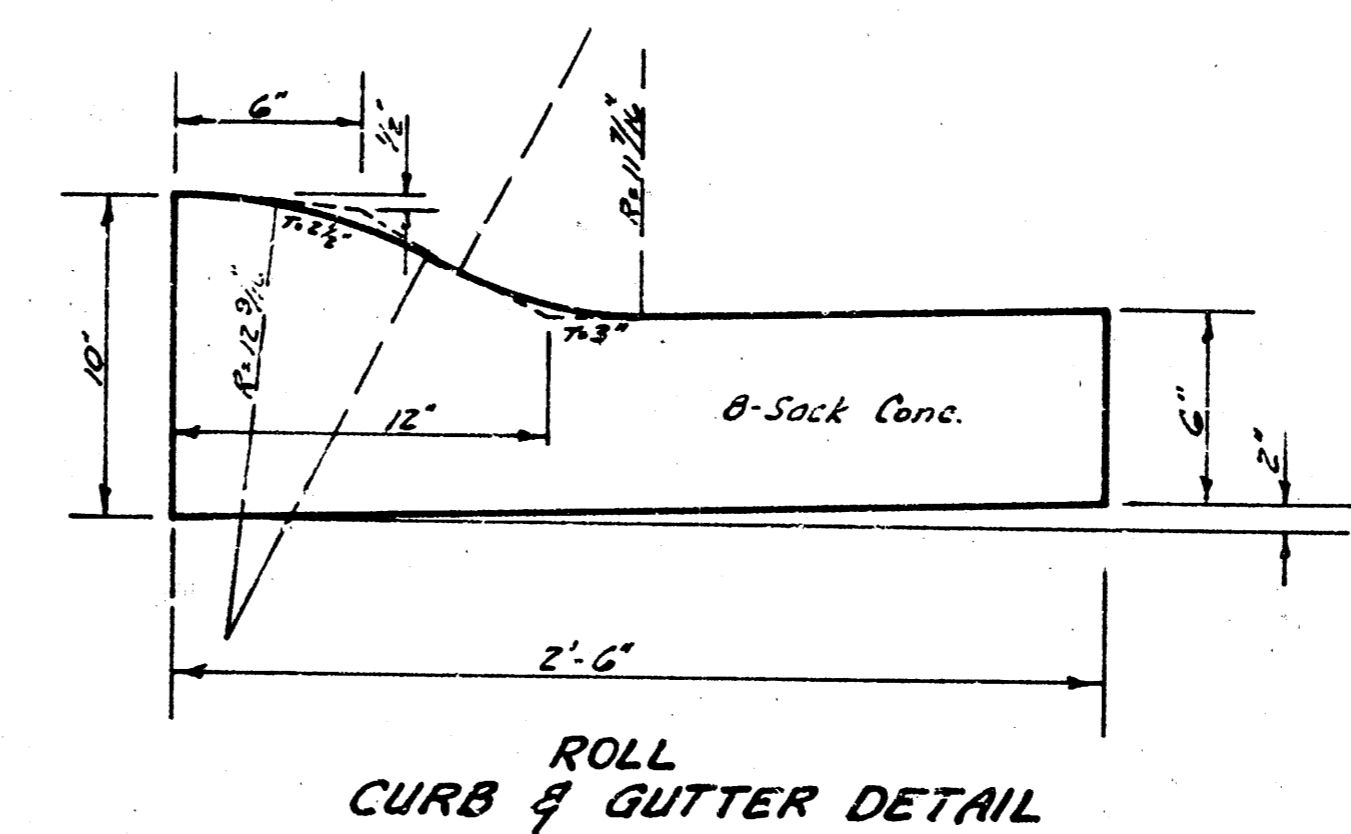

Checked by: [Signature]
 Drawn by: [Signature]

PROPERTY

	EXCAVATION	COMP. FILL
	91 Cu. Yds.	8 Cu. Yds.
+10%	9	1
Totals	100 Cu. Yds.	7 Cu. Yds.



CRAMER STREET
 From E.L. DUNSWORTH AVE.
 to E.L. SUNSET MANOR W. ADD.
 26'-2'-30' A.C.
 B.E. SMITH CITY ENGINEER
 CITY OF WICHITA KANSAS
 Date: Nov. 1935
 Project No. C 16-39