

B.M. 151.86 R.R. SPIKE N.E. FACE P.P. 25'S. AND 7' W. OF IRON N.W. COR. LOT 1, BLK. 8, WESTLINK VILLAGE TENTH ADD'L.  
 B.M. 157.08 TOP S.W. COR. H.L.P. BASE 3' SIDE K.G.F.E. WESTLINK SUB-STATION.

SCALE 1"=20'

Note:  
 Field engineer to locate transition  
 from full to roll curb to conform to  
 drive locations.

- NOTE: CONTRACTOR TO CLEAR RIGHT-OF-WAY, GRADE, PARKING & COMPACT FILL IN SIDEWALK AREAS. SIDEWALK TO BE CONSTRUCTED BY OTHERS.
- NOTE: FIELD ENGINEER TO DETERMINE WHICH PORTIONS ARE TO HAVE TREATED SUB-GRADE & WHICH PORTIONS ARE TO BE SUB-GRADE MODIFIED.
- NOTE: ALL EXCESS EXCAVATED MATERIAL FROM THIS PROJECT IS TO BE STOCKPILED AT LOCATIONS DETERMINED BY THE ENGINEER, IN WESTLINK VILLAGE 10TH ADDITION.
- NOTE: BRASELINE & CRESTLINE.
- NOTE: ROLL TYPE COMB. CB. BUTTER TO BE USED THROUGHOUT PROJECT, EXCEPT AS NOTED.
- NOTE: TRANSITION FROM FULL CURB TO ROLL CURB SHALL BE PAID AS LIN. FT. COMB. CURB & GTR.
- NOTE: STORM SEWER & INLETS TO BE CONSTRUCTED BY OTHERS PRIOR TO CONSTRUCTION OF THIS PROJECT.

SURVEY 1/24/73  
 PLAN STATE  
 C.K. STATE  
 CHICAGO

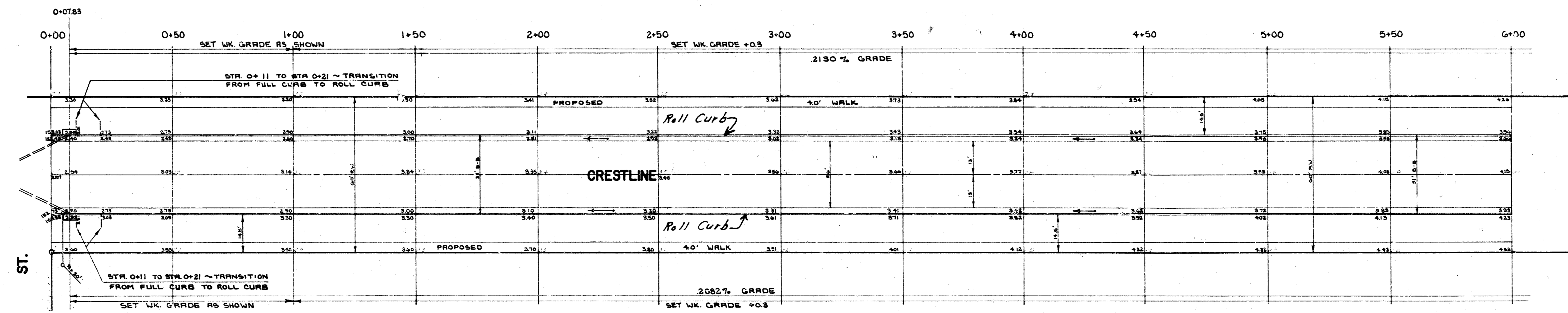

CITY EXCAVATION		PROP. EXCAVATION	
+10%	29.5 CU. YDS.	+10%	618.4 CU. YDS.
	3.0 " "		61.5 " "
	32.5 CU. YDS.		680.2 CU. YDS.
CITY COMP. FILL		PROP. COMP. FILL	
	0.0 CU. YDS.	+10%	79.2 CU. YDS.
			7.8 " "
			87.0 CU. YDS.

CRESTLINE  
 N.L. 12TH ST. TO E.L. LOT 4, BLK. 1, WESTLINK VILLAGE 10TH ADD'L.  
 ASPHALTIC CONCRETE PAVEMENT  
 3" B-B WITH COMB. CB. & GTR.  
 CITY OF WICHITA, KANSAS  
 R. W. LINN CITY ENGINEER  
 PROJ. NO. DAKS 572033  
 DATE: AUG. 1973



B.M. 15125B P.R. 3/PIKE N.E. FACE P.P. 25'S. & 7'W. OF IRON N.W. COR. LOT 1, BLK. 8, WESTLINK VILLAGE 10TH ADDN.  
 B.M. 157080 TOP S.W. COR. H.L.R. BASE S. SIDE K&E. WESTLINK SUB-STATION.

SCALE 1"=20'

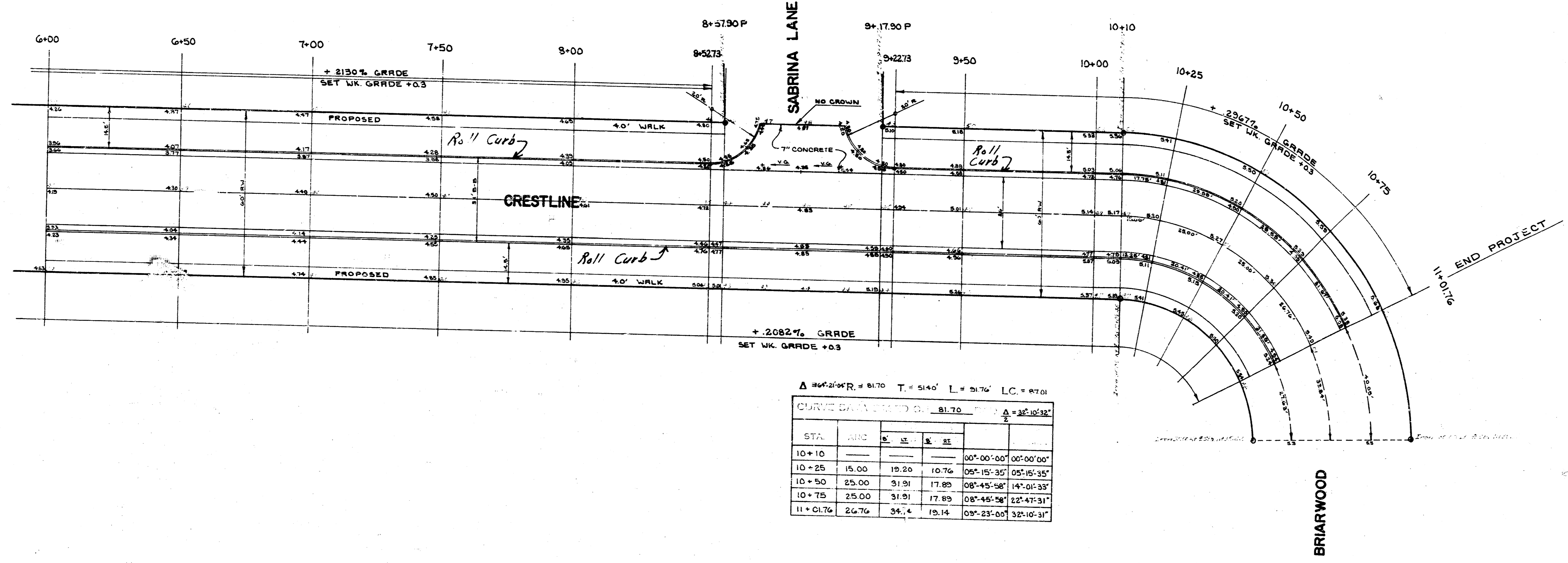

Δ 26°22'00" R = 81.70 T = 51.40' L = 51.76' LC = 87.61  
 CURVE DATA TO D. 81.70 Δ = 38°10'32"

STA.	ARC	Δ	Δ	Δ	Δ
10+10			00°00'00"	00°00'00"	
10+25	15.00	15.20	10.76	05°15'35"	05°15'35"
10+50	25.00	31.91	17.89	08°45'58"	14°01'33"
10+75	25.00	31.91	17.89	08°45'58"	22°47'31"
11+01.76	26.76	34.4	19.14	09°23'00"	32°10'31"