

DM. RR SPIKE N. SIDE RR & CRESTWAY S.S. PAWNEE ELEV. 134.60
 NOTE:
 CHAINED N. ON E. CB. LINE

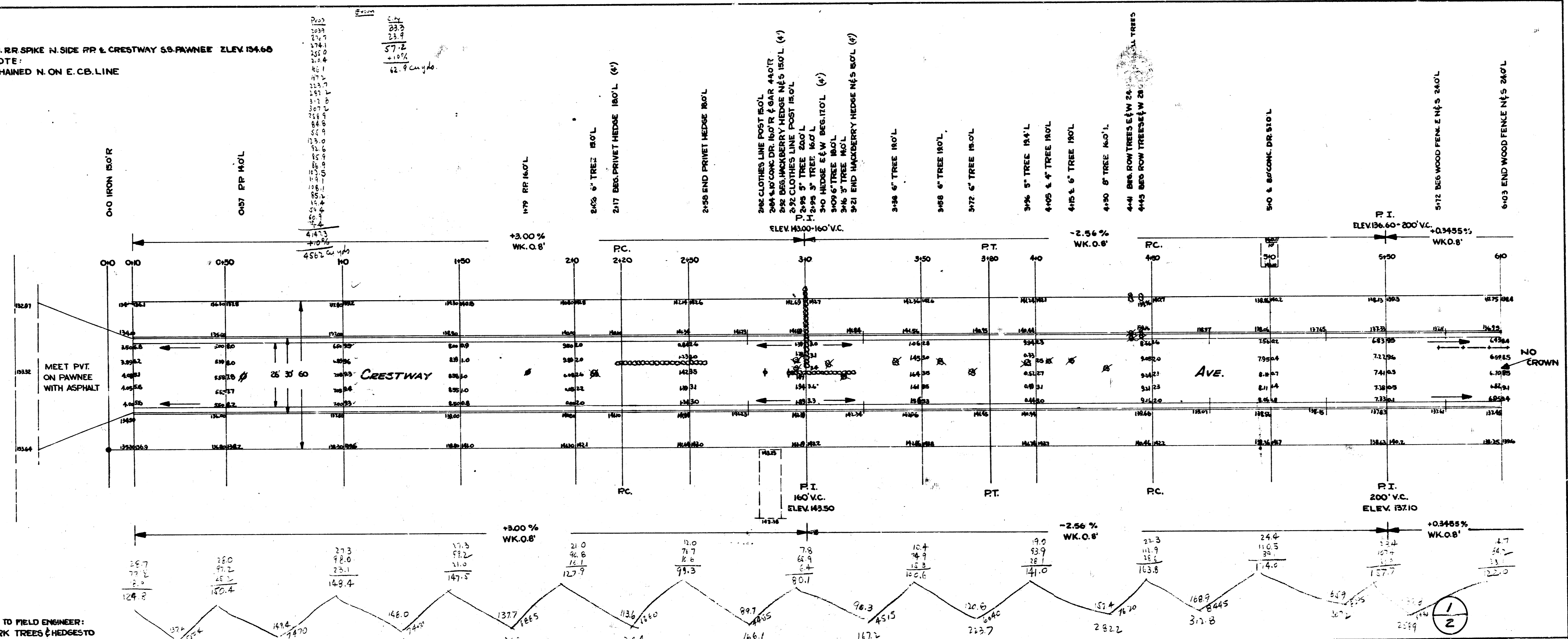

NOTE TO FIELD ENGINEER:
 MARK TREES & HEDGES TO
 BE REMOVED & TURN IN
 CARD DENOTING SAME

CRESTWAY AVE.
 N.L. PAWNEE TO S.L. KINKAID
 26-2-30 A.C.
 CITY OF WICHITA, KANSAS
 L. K. WHITE - CITY ENGINEER
 JULY 1952 PROJ. C12-37



SCALE 1"=20'

