

31 3885 Standard SE on or Sheriden 1.3.14.21.0.

Sheet of 2

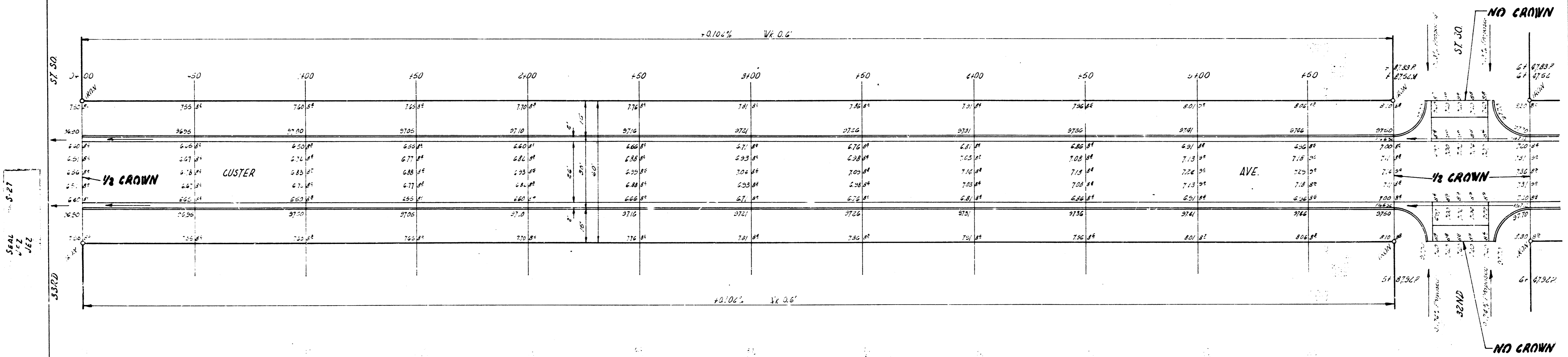

58.64
11.2
2.7

CUSTER AVE.
 NL 33RD SO. - SL 31ST SO.
 26'-2'-30" AC.
 CITY OF WICHITA, KANS.
 B.E. SMITH CITY ENGINEER
 June 1956 PROJ. C15-88

