

B.M. 114.04 CITY B.M. 41' N. of 24' W. OF & SHERIDAN MAPLE
 B.M. 116.81 RR. SPC. N.W. SIDE PP. SE. COR. MAPLE & CUSTER
 BASIC LINE ON E

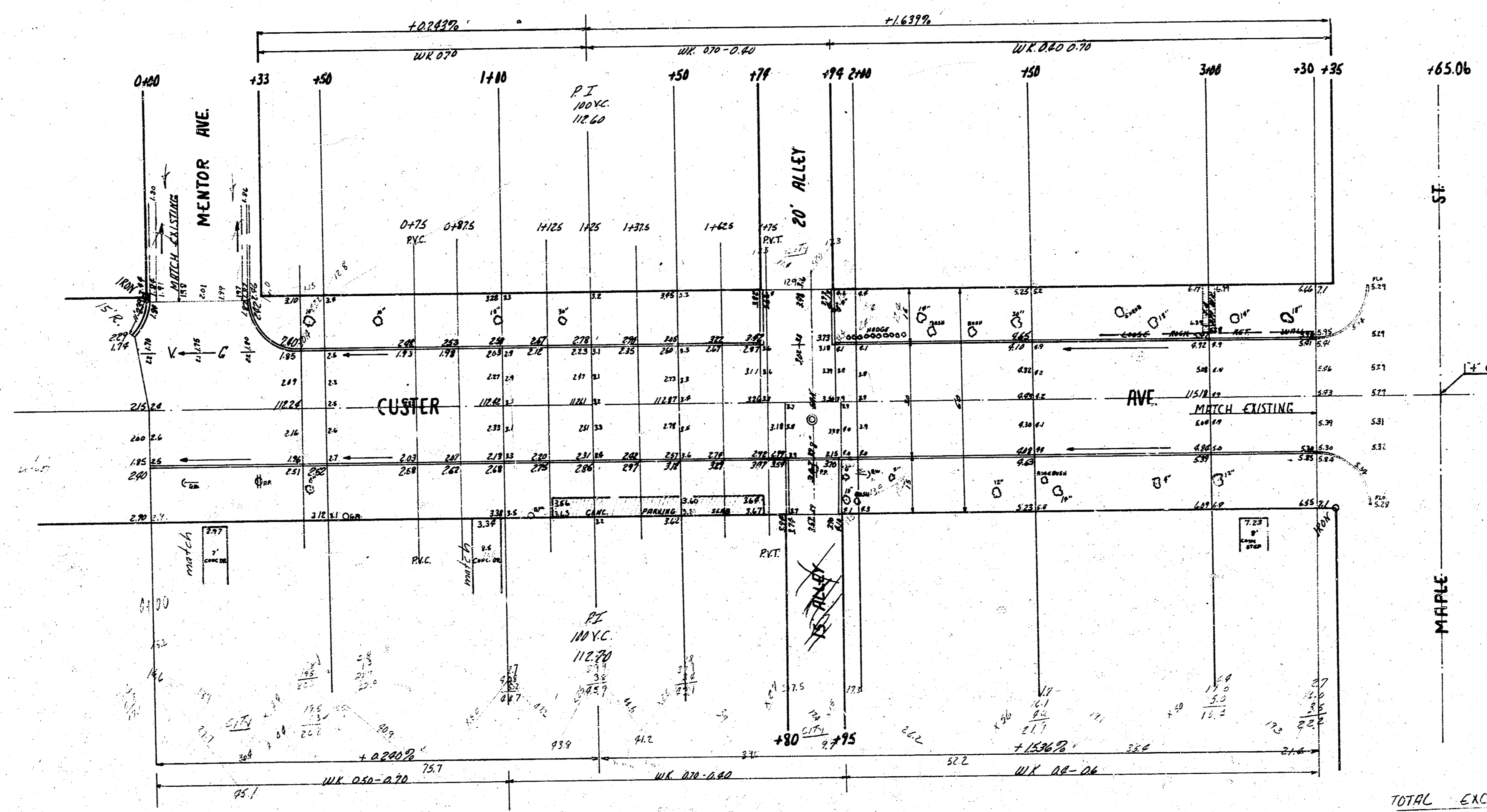

JOHN RIGGS
 Plan Review
 Exc. Engineer
 Checked J.R.

TOTAL EXCAV.	
CIT.	PROP.
705	353.8
1476.71	1476.354
776 cu/yds	3892 cu/yds

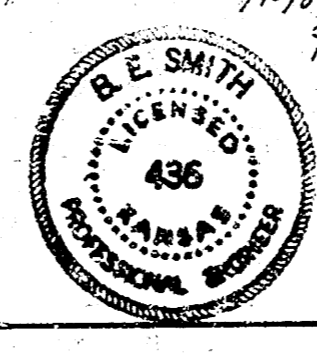

CUSTER AVE.
 S.L. MENTOR S.L. MAPLE
 30" CONC & CB
 CITY OF WICHITA KANSAS
 B.E. SMITH CITY ENGINEER
 DATE MAY 1959, PROJ NO C-1948