

DALLAS AVENUE

from the EL of St. Paul to the WL of Meridian

WORK ON THIS PROJECT SHALL BE COORDINATED WITH THE WORK ON THE OTHER SIX (6) PROJECTS THAT ARE A PART OF THIS CONTRACT. CONSTRUCTION SEQUENCING IS SUBJECT TO THE APPROVAL OF THE ENGINEER.

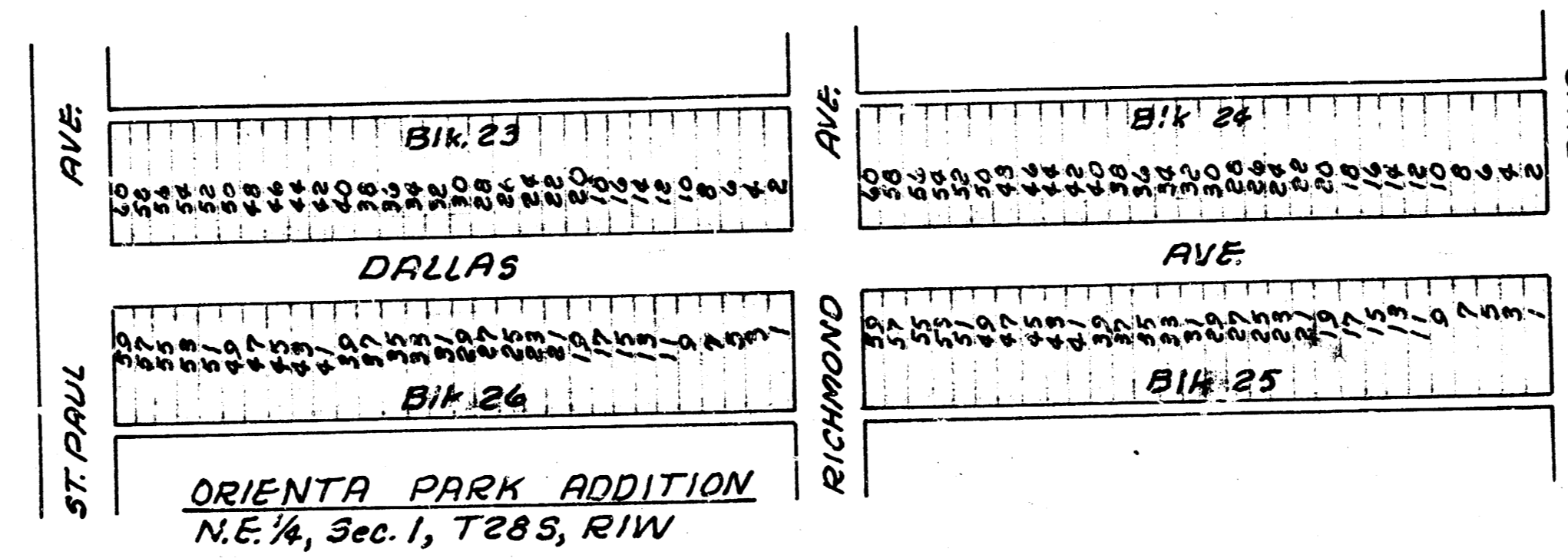

- GENERAL NOTES:
- (1) CONSTRUCT ROLL-TYPE CURB ON THIS PROJECT. CURBS SHALL BE DERESSED THROUGH DRIVES WHEN DRIVES ARE CONSTRUCTED AS A PART OF THIS CONTRACT. NO MORE THAN 40' DRIVES ARE TO BE CONSTRUCTED WITHIN THIS PROJECT.
 - (2) PAVEMENT SHALL BE 7" ASPHALTIC CONCRETE (5" BITUMINOUS BASE AND 2" WEARING SURFACE).
 - (3) TREES TO BE REMOVED ARE INDICATED ON THE PLANS; HOWEVER, ANY TREE WHICH CAN BE SAVED, AS DETERMINED BY THE FIELD ENGINEER, SHALL NOT BE REMOVED.
 - (4) BASTHORE TO MEET EXISTING GROUND ELEVATION AT RIGHT-OF-WAY LINE, UNLESS OTHERWISE NOTED ON THE PLAN WITH A NEW ELEVATION. IF A NEW ELEVATION IS SHOWN, THE BASTHORE SHALL EXTEND ONE FOOT BEYOND RIGHT OF WAY LINE, THENCE UP OR DOWN ON A 1:1 SLOPE TO THE EXISTING GROUND SURFACE.
 - (5) WIDENED GUTTER SECTION OF COMBINED CURB AND GUTTER AT INTERSECTIONS WILL NOT BE PAID FOR DIRECTLY, AND THIS COST SHALL BE CONSIDERED AS SUBSIDIARY TO THE OTHER PAY ITEMS OF WORK.
 - (6) MAILBOXES WITHIN THE PROJECT LIMITS SHALL BE REMOVED AND REPLACED BY THE CONTRACTOR AS APPROVED BY THE ENGINEER. CONTRACTOR SHALL BE REQUIRED TO MAKE SATISFACTORY PROVISIONS FOR MAIL DELIVERY PROPERTIES AFFECTED BY THIS PROJECT DURING CONSTRUCTION.
 - (7) ALL ENTRANCE AND CROSS ROAD DRAINAGE PIPES WITHIN THE PROJECT LIMITS SHALL BE REMOVED BY THE CONTRACTOR, UNLESS OTHERWISE NOTED ON THE PLANS. REMOVAL OF SUCH PIPES SHALL CONFORM TO THE APPLICABLE SECTIONS OF THE STANDARD SPECIFICATIONS.
 - (8) CONTRACTOR SHALL GIVE PROPERTY OWNERS ABUTTING THIS PROJECT WHOSE YARDS WILL BE LOWER THAN THE TOP OF THE NEW CURB AN OPPORTUNITY TO UTILIZE EXCESS EXCAVATED MATERIAL FROM THE PROJECT TO REGRADE THEIR YARDS TO DRAIN TO THE NEW PAVEMENT. CONTRACTOR WILL BE REQUIRED TO DUMP AND SPREAD THE EXCESS MATERIAL AS REQUIRED BY THE STANDARD SPECIFICATIONS. ANY DIRT IN EXCESS OF CONSTRUCTION REQUIREMENTS AND PROPERTY OWNER REQUESTS SHALL BE DELIVERED AND SPREAD ON THE SCHOOL BOARD PROPERTY SOUTH OF 77TH STREET AND ST. PAUL AT NO ADDITIONAL COST. CONTACT LCM PART# 832-1211, EXT. 274, FOR INSTRUCTIONS FOR DUMPING ON SCHOOL BOARD PROPERTY.
 - (9) ~~CONTRACTOR TO BE RESPONSIBLE FOR SUB-GRADE TREATMENT, BASTHORE, BASTHORE, BASTHORE BY THE SUCCESSFUL BIDDER SHALL BE USED FOR CONSTRUCTION ON THIS PROJECT.~~
 - (10) THE CONTRACTOR SHALL SEQUENCE HIS WORK TO ELIMINATE THE NEED FOR "OVERHAUL" IF DIRT IS TO BE DELIVERED TO THE SCHOOL BOARD PROPERTY.
 - (11) REMOVAL OF EXCESS PAVEMENT PLACED IN THE CONSTRUCTION OF THE ST. PAUL AND THE RICHMOND PAVING PROJECTS SHALL BE CONSIDERED INCIDENTAL TO EXCAVATION.
 - (12) RUBBLE AND OTHER WASTE MATERIAL STOCKPILED ON STREET RIGHT OF WAY ABUTTING HOUSE AT 2603 DALLAS SHALL BE REMOVED BY THE CONTRACTOR AND DISPOSED OF AS APPROVED BY THE FIELD ENGINEER. THIS WORK WILL NOT BE PAID FOR DIRECTLY, AND THIS COST SHALL BE CONSIDERED AS SUBSIDIARY TO THE OTHER PAY ITEMS OF WORK.



PROJECT DESCRIPTION DALLAS AVE. <i>(St. Paul to Meridian)</i>		
PROJECT NUMBER 472-76-245-8163-000-000-001		
BOOK NO. DCD-193	APPROVED BY	DATE 10-82
DRAWN BY WSK		REVISED
CITY OF WICHITA DEPARTMENT OF ENGINEERING		
DIRECTOR OF ENG./CITY ENGINEER R. W. RRUJGEMAN		Sheet 1 of 7

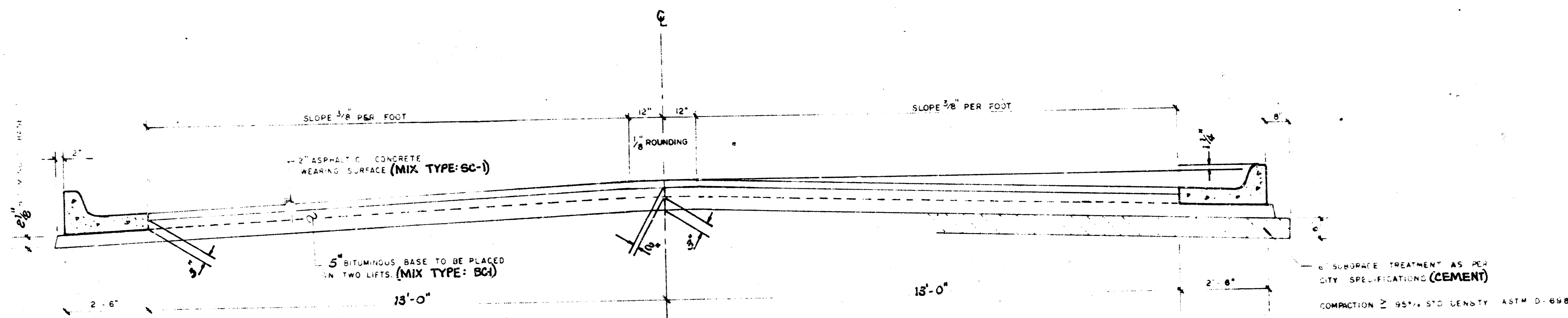

TYPICAL SECTION

ASPHALTIC CONCRETE PAVEMENT WITH BITUMINOUS BASE

A TACK COAT OF EMULSIFIED ASPH (SS-1M or CSS-1M) SHALL BE APPLIED AT AN APPROXIMATE RATE 0.05 GALLONS PER SQ YD BETWEEN LIFTS OF ASPHALTIC MATERIALS WHEN ORDERED BY THE ENGINEER. TACK COAT WILL NOT BE PAID DIRECTLY AND SHALL BE CONSIDERED AS SUBSIDIARY TO PRICE BID FOR ASPHALTIC PAVEMENT. BITUMINOUS BASE AND ASPHALTIC CONCRETE WEARING SURFACE SHALL BE PLACED WITH A LAYDOWN MACHINE HAVING AUTOMATIC CONTROLS FOR CROWN AND GRADE. CONSTRUCTION JOINTS IN EACH LIFT SHALL BE STAGGERED A MINIMUM DISTANCE OF 1' WITH JOINTS IN PRECEDING LIFTS AND PLACED SUCH THAT A JOINT WILL BE CONSTRUCTED ON THE CENTERLINE IN THE TOP LIFT.

THE A.C. PAVEMENT BETWEEN THE COMBINED CURB AND GUTTER SHALL BE PAID AS SQ YDS 7' A.C. PAVEMENT (5" BITUMINOUS BASE). THE BITUMINOUS BASE UNDER THE COMBINED CURB AND GUTTER SHALL BE PAID AS SQ YDS 8 1/2" BITUMINOUS BASE.

COMBINED CURB & GUTTER

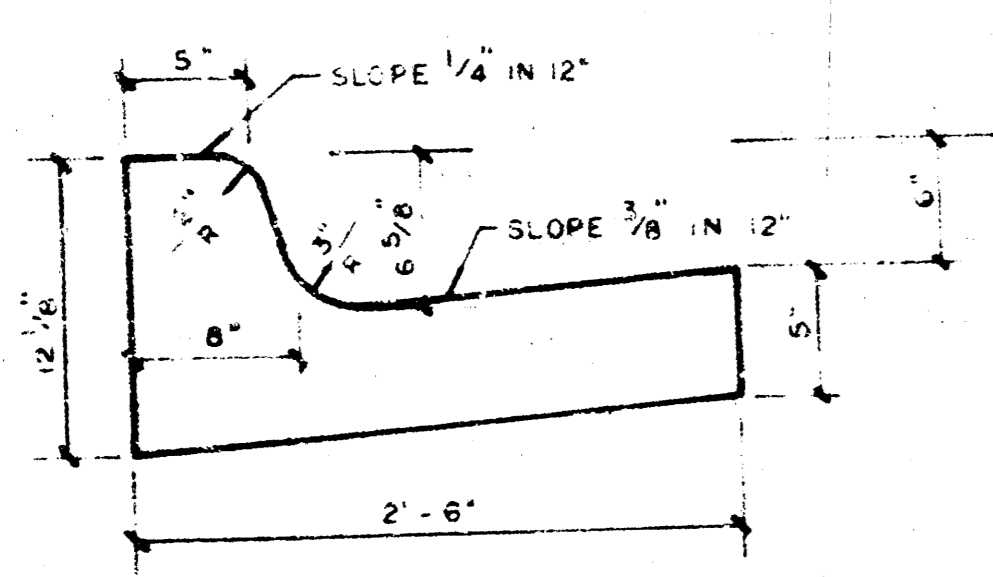

ROLL TYPE CURB & GUTTER

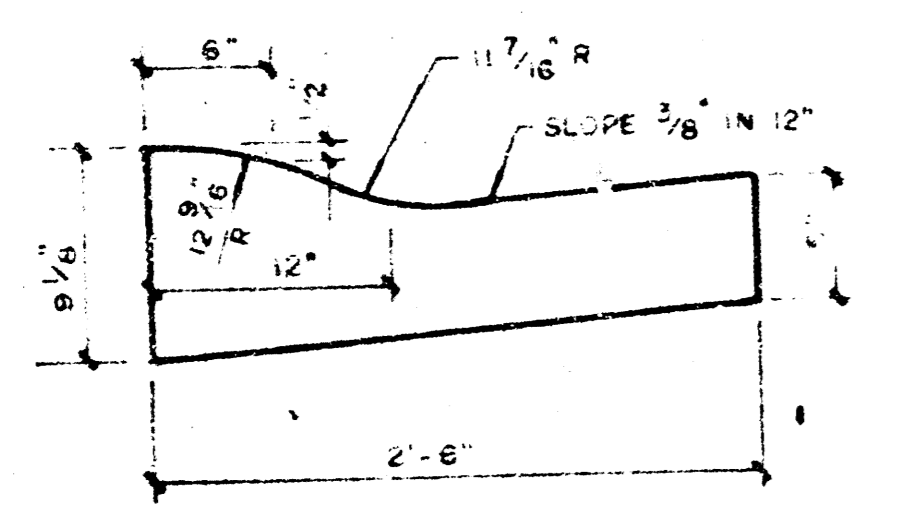

DETAIL OF TRANSVERSE CONSTRUCTION JOINTS

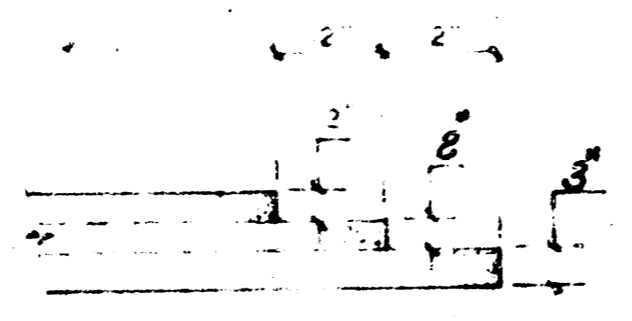

TRANSVERSE CONSTRUCTION JOINTS SHALL BE CONSTRUCTED IN FLEXIBLE BASE PAVEMENTS AT LOCATIONS WHERE PAVEMENT TEMPORARILY ENDS TO FACILITATE FUTURE PAVEMENT CONSTRUCTION AS SHOWN BY DETAIL. THE COST OF CONSTRUCTING THE TRANSVERSE CONSTRUCTION JOINTS SHALL NOT BE MEASURED OR PAID FOR DIRECTLY BUT SHALL BE INCLUDED IN THE BID PRICE FOR SQUARE YARDS OF A.C. PAVEMENT.

CITY OF WICHITA, KANSAS

DALLAS RVE
(St Paul to Meridian)

2
7

B.M. 101.35 R.R. Spk. in S.W. q. Street Light Pole @ N.E. Cor. Dallas & St. Paul
 B.M. 102.03 R.R. Spk. in N.W. q. R.R. @ S.E. Cor. Anita & St. Paul

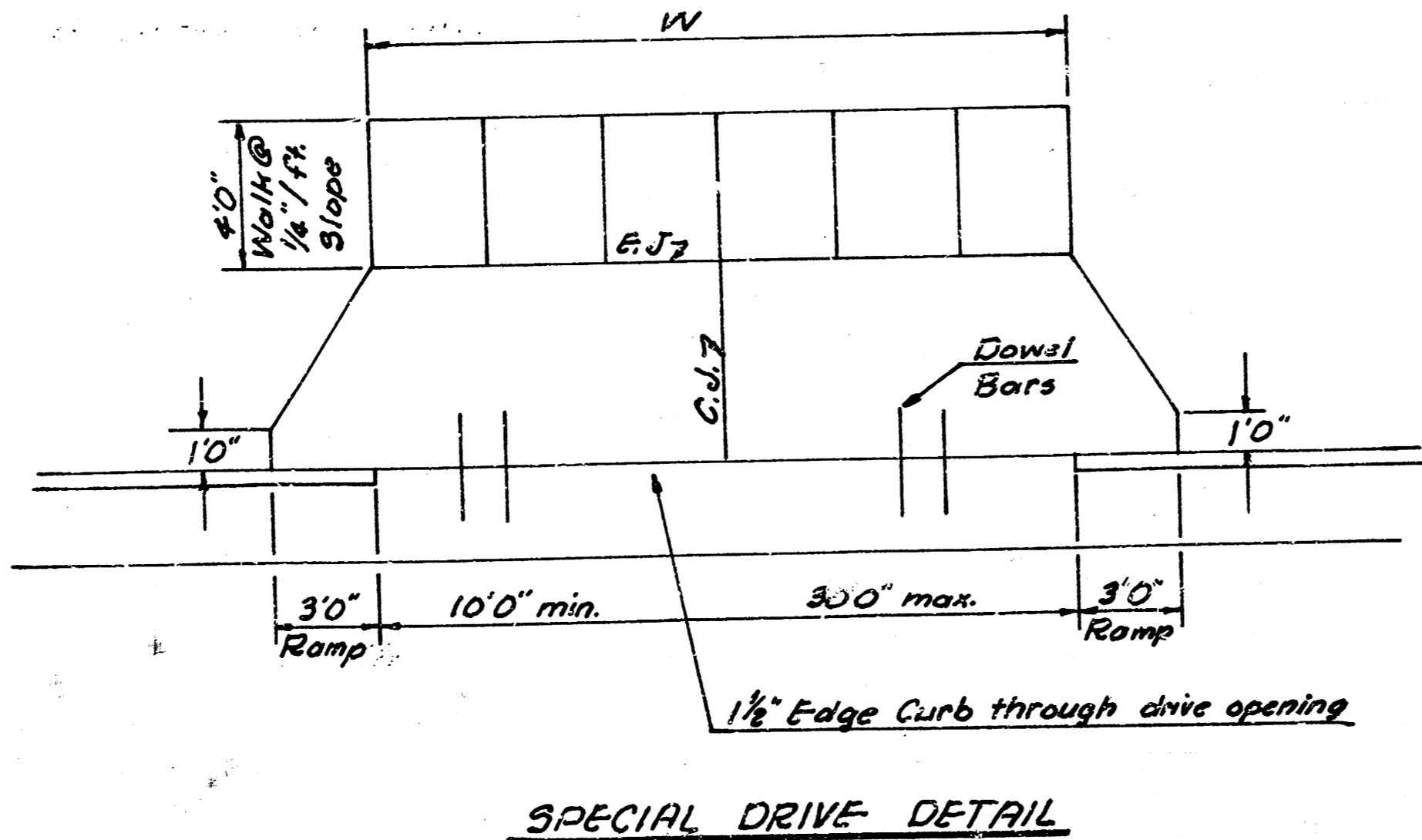
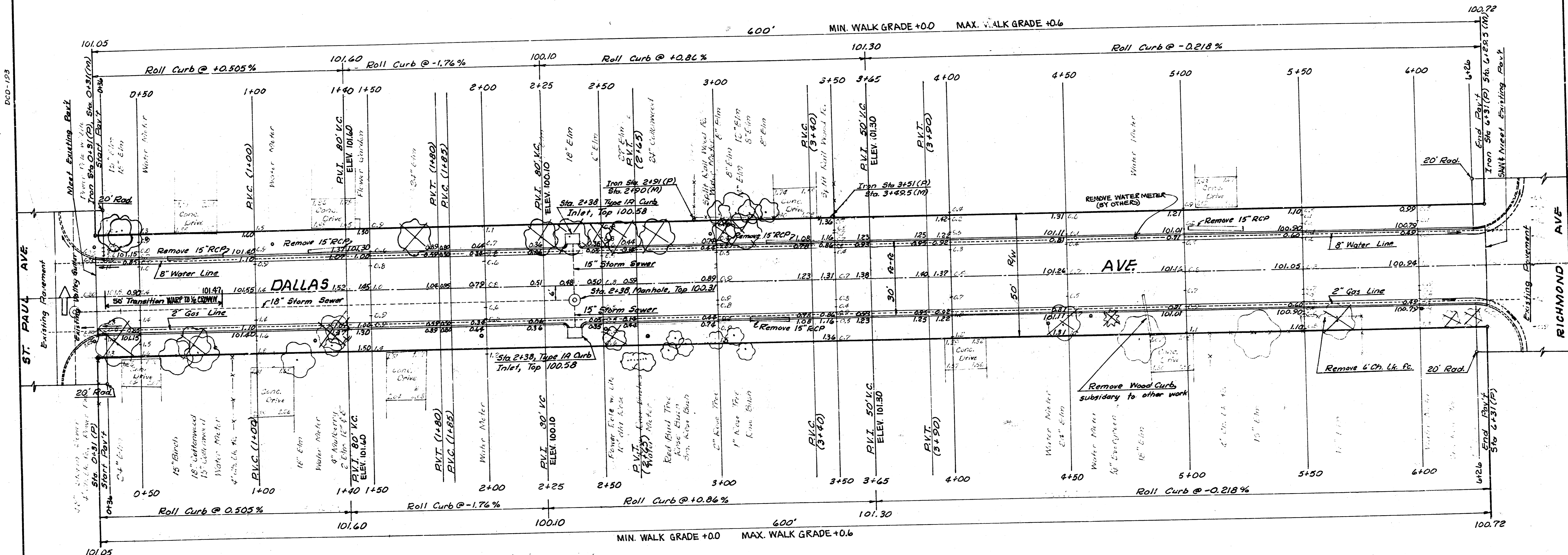
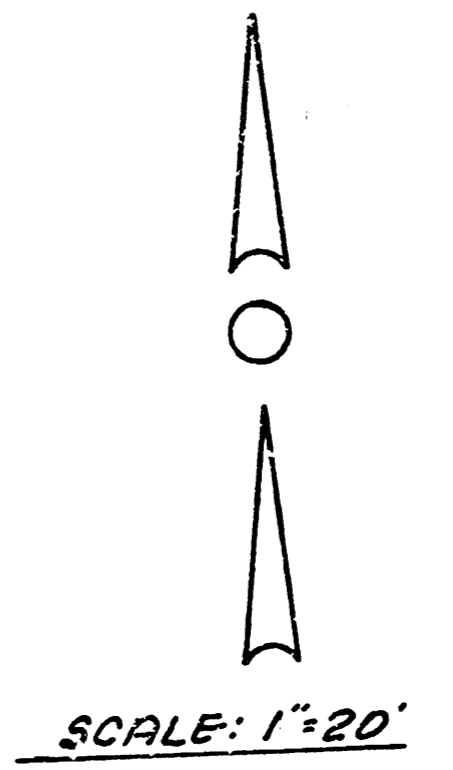

SPECIAL DRIVE DETAIL

THE CONTRACTOR SHALL BE RESPONSIBLE FOR PRESERVING PROPERTY IRONS. THE CONTRACTOR SHALL BE REQUIRED TO RE-ESTABLISH ANY PROPERTY IRONS WHICH ARE DAMAGED OR DESTROYED BY HIS CONSTRUCTION OPERATIONS. SUCH IRONS SHALL BE RE-ESTABLISHED BY A LICENSED LAND SURVEYOR OR A LICENSED PROFESSIONAL ENGINEER IN ACCORDANCE WITH STATE LAWS.

MANIPULATION	4312.0cy		
EARTHWORK			
EXCAVATION	978.1cy	COMPACTED FILL	64.6cy
+10%	97.8cy	+10%	6.5cy
TOTAL	1075.9cy	TOTAL	71.1cy

PROJECT DESCRIPTION
DALLAS AVE
 (St. Paul to Meridian)

PROJECT NUMBER
 472-76-245-81149-000-001

BM See Sheet 3

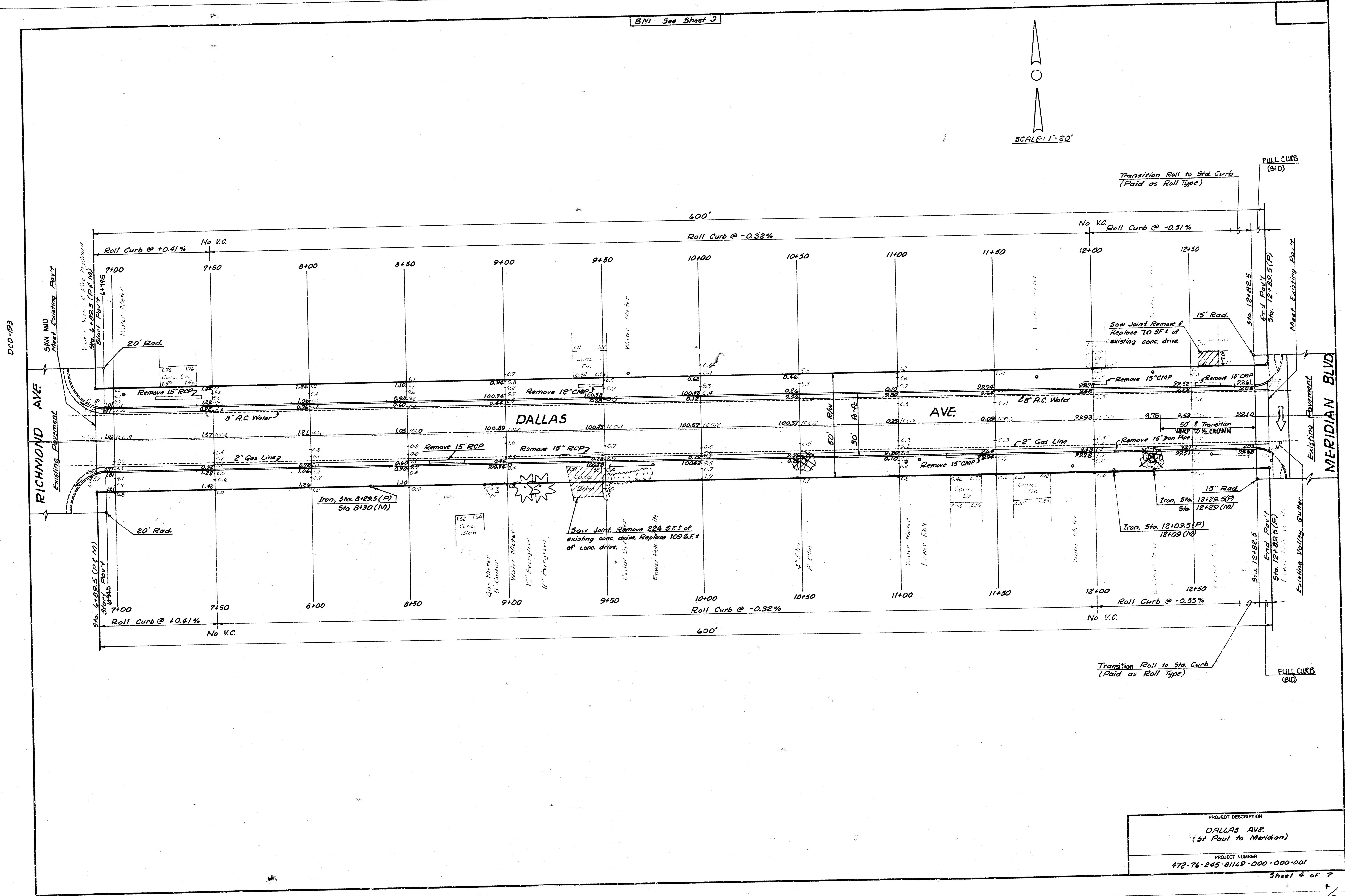
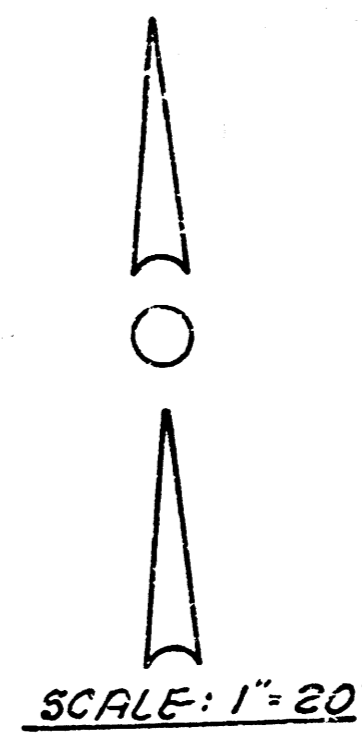

PROJECT DESCRIPTION
 DALLAS AVE.
 (St Paul to Meridian)

PROJECT NUMBER
 472-76-245-81149-000-001

Sheet 4 of 7

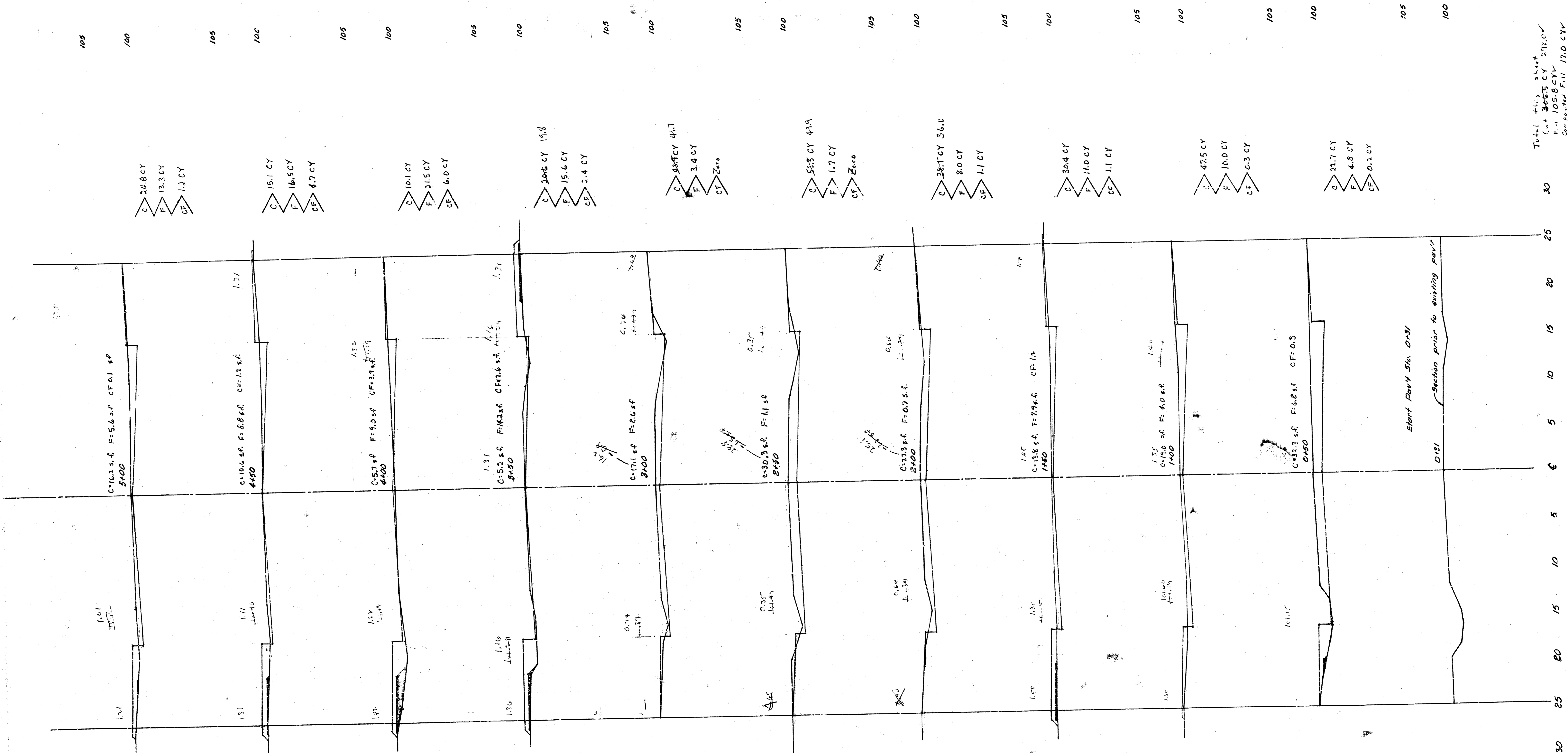

Total this sheet
 Cut 306.5 CY 548.0V
 Fill 105.8 CYL
 Compacted Fill 17.0 CYV

TOTAL ALL SHEETS
 CUT 1036.7 CY 978.1V
 FILL 267.0 CY 270.3V
 COMPACTED FILL 64.6 CYV
 MAJOR FILL 34.2 CY
 DALLAS AVE
 (St. Paul to Meridian)

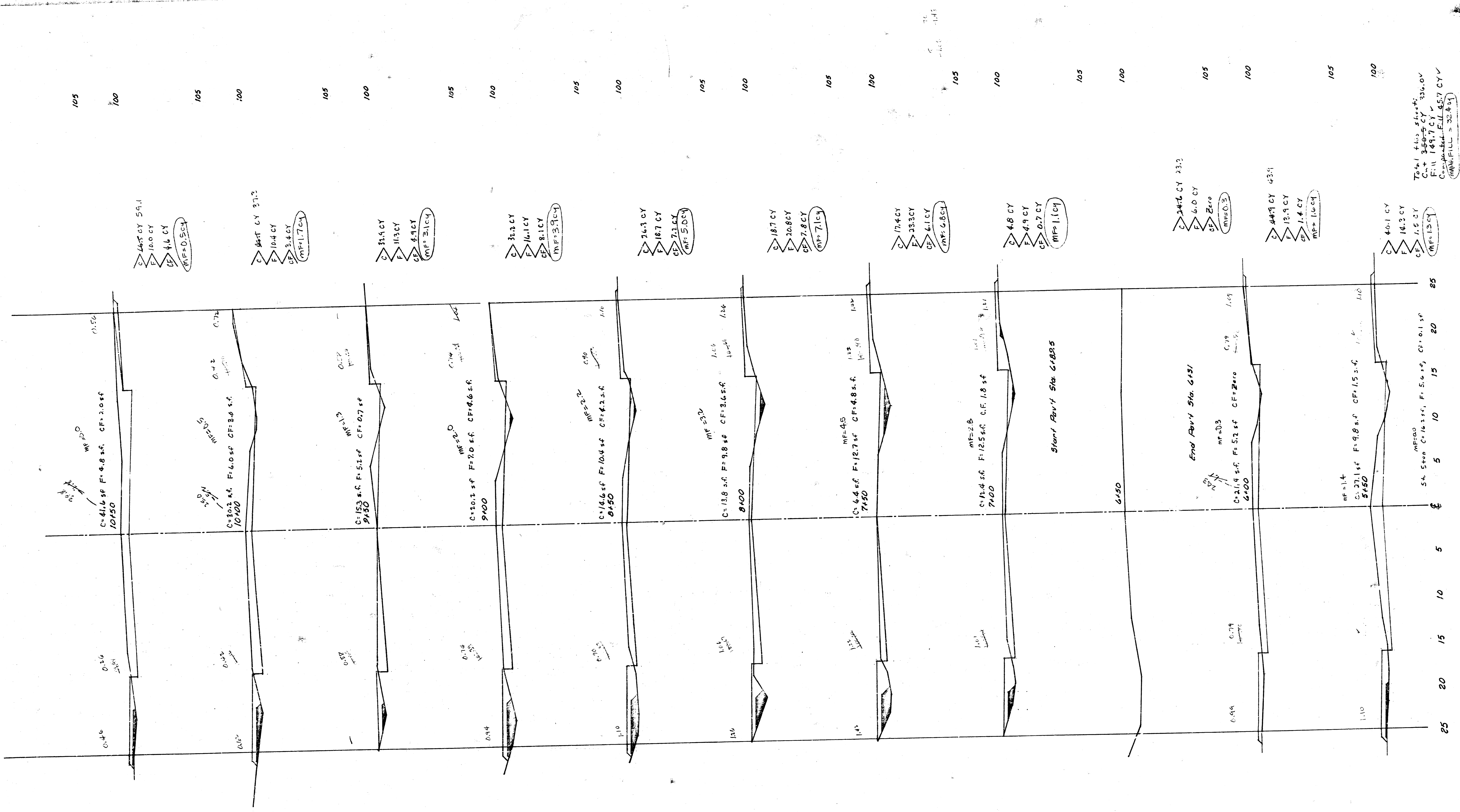

Total
 C=149.7 CY
 F=149.7 CY
 CF=32.4 CY
 MF=13.0 CY

End Part 18+88.5

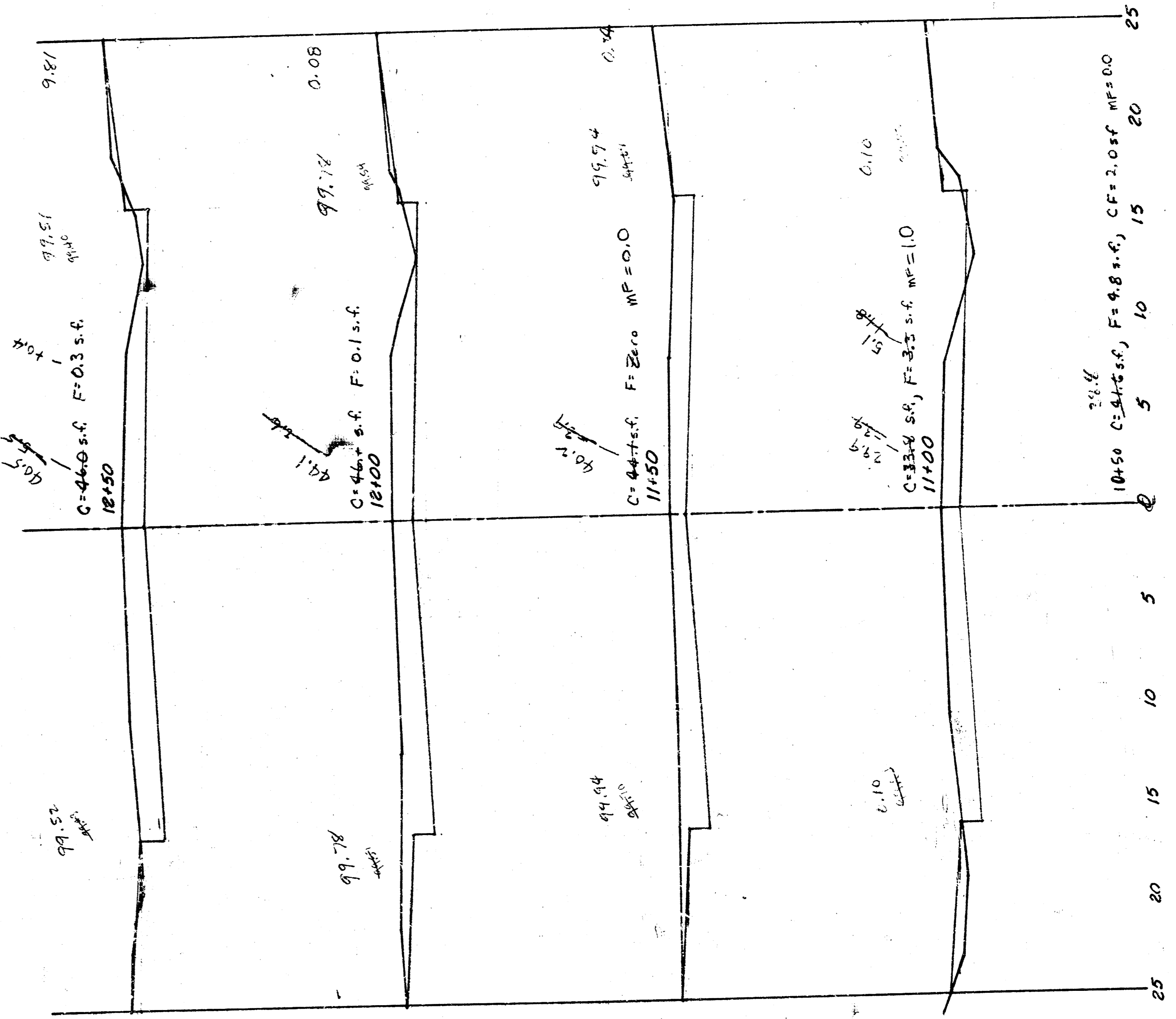

C 425 CY 59.2
F 0.4 CY

C 355 CY 78.3
F 0.4 CY

C 347 CY 78.1
F 0.1 CY

C 227 CY 64.9
F 2.4 CY 4.7
(NF=0.3 CY)

C 438 C.Y. 63.6
F 2.5 CY 9.1
CF 1.9 CY
(NF=0.9 CY)

Total + this sheet = 344.1 V
Cut = 1411.1 CY 14.8 V
Fill = 1411.1 CY 14.8 V
Compaction Fill = 19.9 CY
(NF=0.3 CY)

DALLAS AVE.
(St. Paul to Meridian)

Sheet 7 of 7

10 3 1 8

2/2