

B.M. Std. N.W. Cor. MAY & Seneca Elev. 101.11
 B.M. "1" in Iron P.P. N.W. Cor. Martinson & Dora Elev. 107.35
 B.M. S.E. Cor. Conc. For. Hos. N.W. Cor. Elizabeth & Dora Elev. 101.24

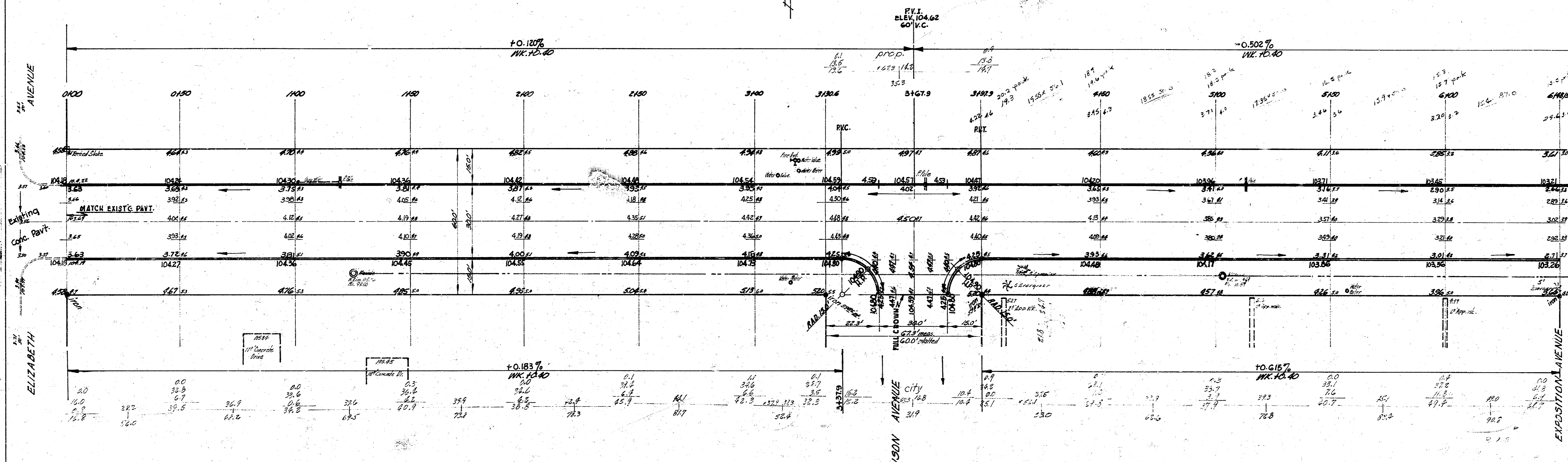
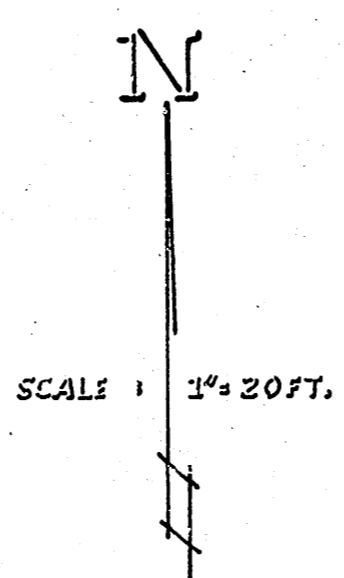

11/18/12
 2-10-13
 11/18/12

EXCAVATION TOTAL

EXCAV.	PROP.	FILL	EXCAV. CITY	FILL
1201.9	118	154.2	0.0	0.0
103.9	103.9	103.9	103.9	103.9
1322.7	114.7	154.2	103.9	103.9

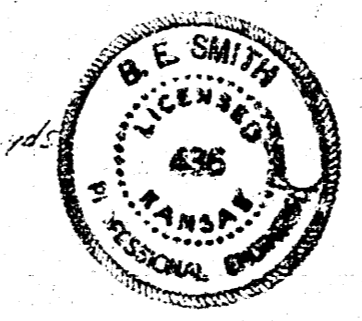
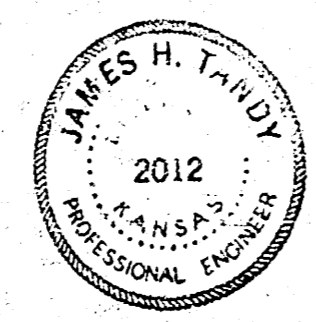

DORA AVENUE
 E.L. ELIZABETH AVE - W.L. SENECA ST.
 300' CONCRETE & C.B.
 City of Wichita, Kansas
 B.E. SMITH CITY ENGINEER
 Date: Aug 5, 13
 Proj. No. C18-138

Sheet 1 of 3

Curve Data Based on Ctr. Line
 $\Delta/2 = 3^{\circ}48'32''$
 Radcl = 1130.0'
 Arc = 130.46'
 Chd = 193.44'
 Tan = 73.38'

NOTE: "CAUTION" do not cross 30" Sanitary Sewer with any heavy equipment.

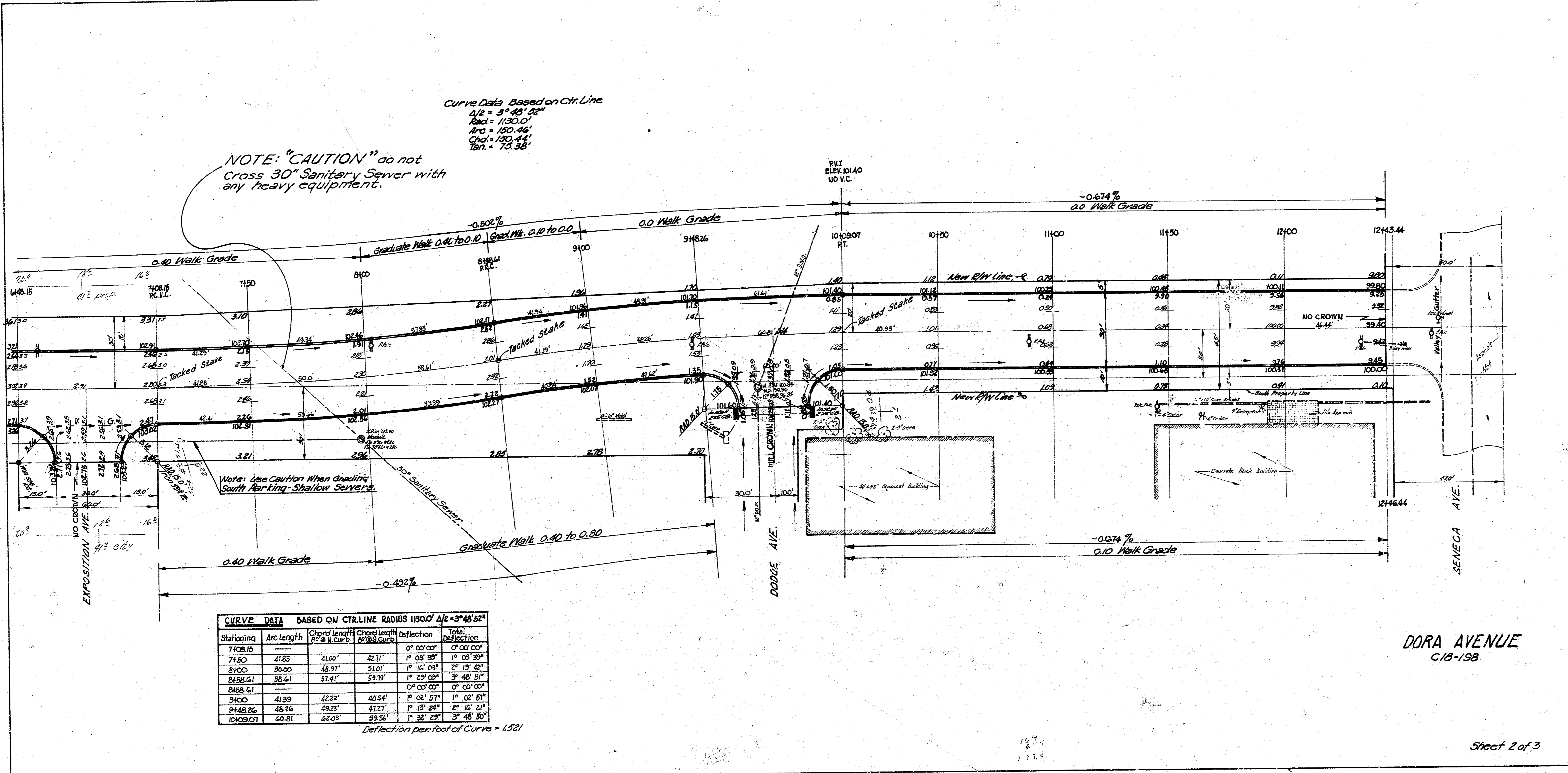

Stationing	Arc length	Chord length P2 @ 1/2 Curve	Chord length P2 @ 3/4 Curve	Deflection	Total Deflection
7408.15	—	—	—	0° 00' 00"	0° 00' 00"
7700	41.85	41.01'	42.31'	1° 03' 39"	1° 03' 39"
8100	30.00	48.31'	51.01'	1° 16' 03"	2° 19' 42"
8156.61	58.61	51.41'	59.79'	1° 29' 00"	3° 48' 51"
8436.61	—	—	—	0° 00' 00"	0° 00' 00"
9100	41.39	42.22'	40.54'	1° 02' 51"	1° 02' 51"
9482.6	48.76	49.23'	47.27'	1° 13' 24"	2° 16' 21"
10030.7	60.81	62.03'	59.34'	1° 32' 23"	3° 48' 50"

Deflection per foot of Curve = 1.521

DORA AVENUE
 C/18-198