

Scale 1"=20'

B.M. 124.94 DOUBLE SPIKE N.S. C.G.E. POLE N.S. 37' 2 1/2" E. OF NEYDOR
B.M. 125.24 R.R. SPIKE N.S. H.L.P. - W. PALE OF H. FRAME TRANSFORMER
POLES 130' N. OF 10TH - 30' E. OF DOUGHERTY

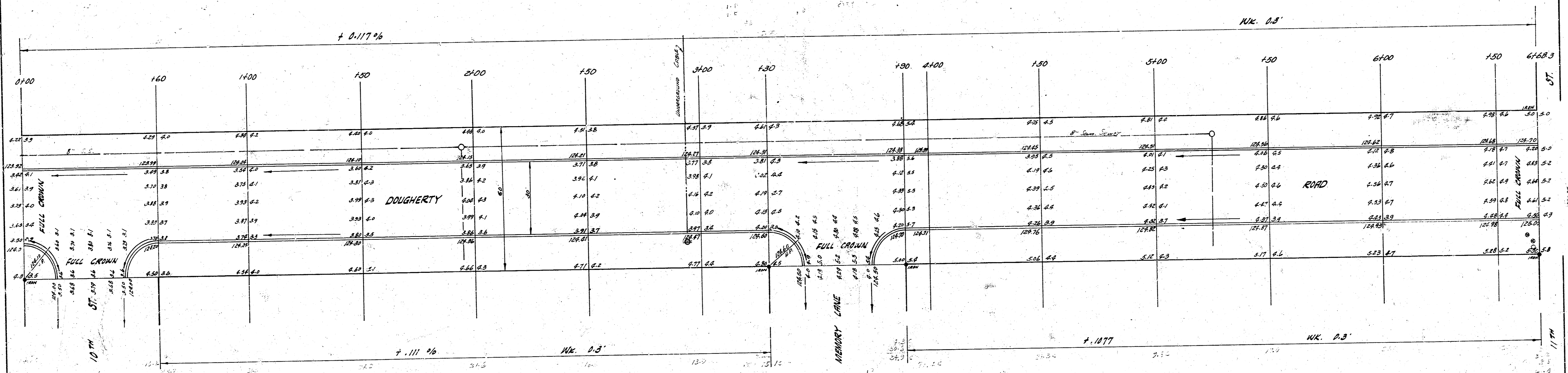

Excavation

OUT	CITY	FILL	CITY
23.50	26.7	15.3	3.6
17.5	14.7	11.3	2.6
22.7	22.2	11.3	3.0

NOTE TO CONTRACTOR & FIELD ENGR.:
Sanitary sewers to be extended
across street prior to paving.

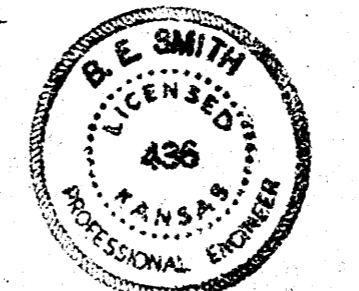

DOUGHERTY ROAD
S.L. 10TH TO S.L. 11
30' CONC. 4' CB.
CITY OF WICHITA, KANSAS
B. E. SMITH, CITY ENGINEER
PRJ. NO. C18-66
AUG. 1958

