

DOUGHERTY AVE.
N.L. 12TH ST. TO S.L. 13TH ST.
TYPICAL SECTIONS OF 30' CONCRETE PAVEMENT

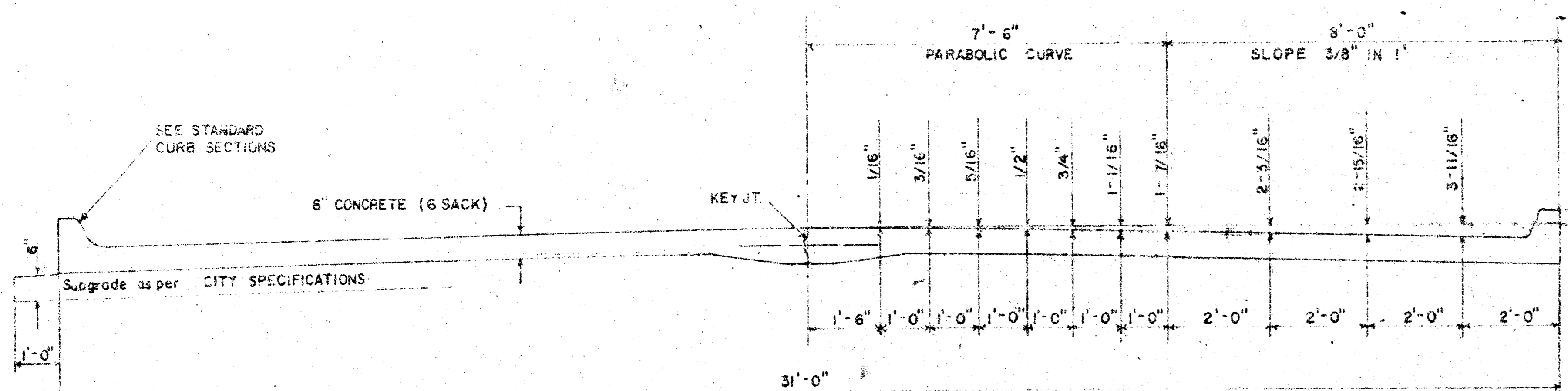

TYPICAL SECTION WITH STANDARD CROWN

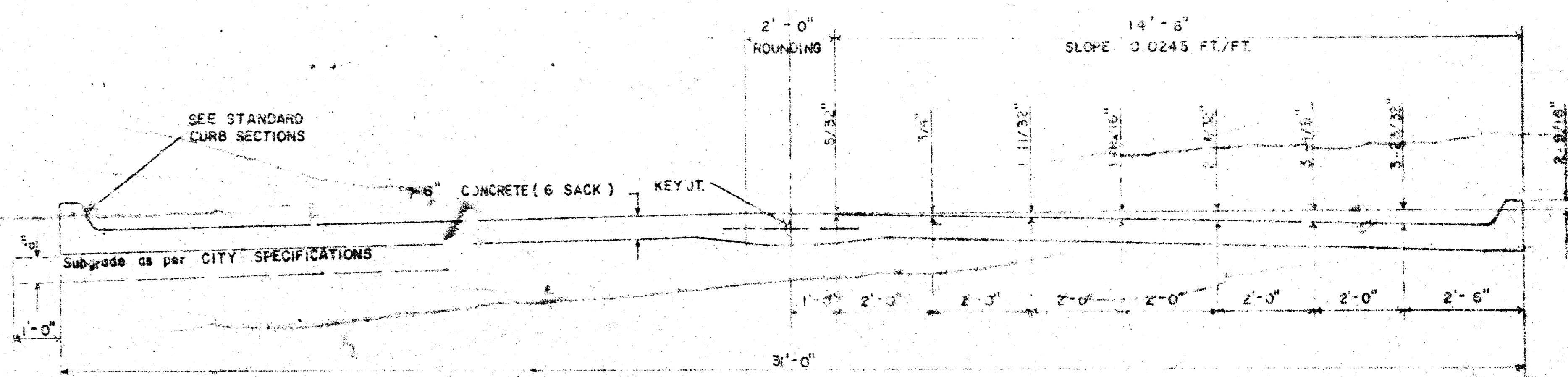

TYPICAL SECTION WITH ALTERNATE CROWN

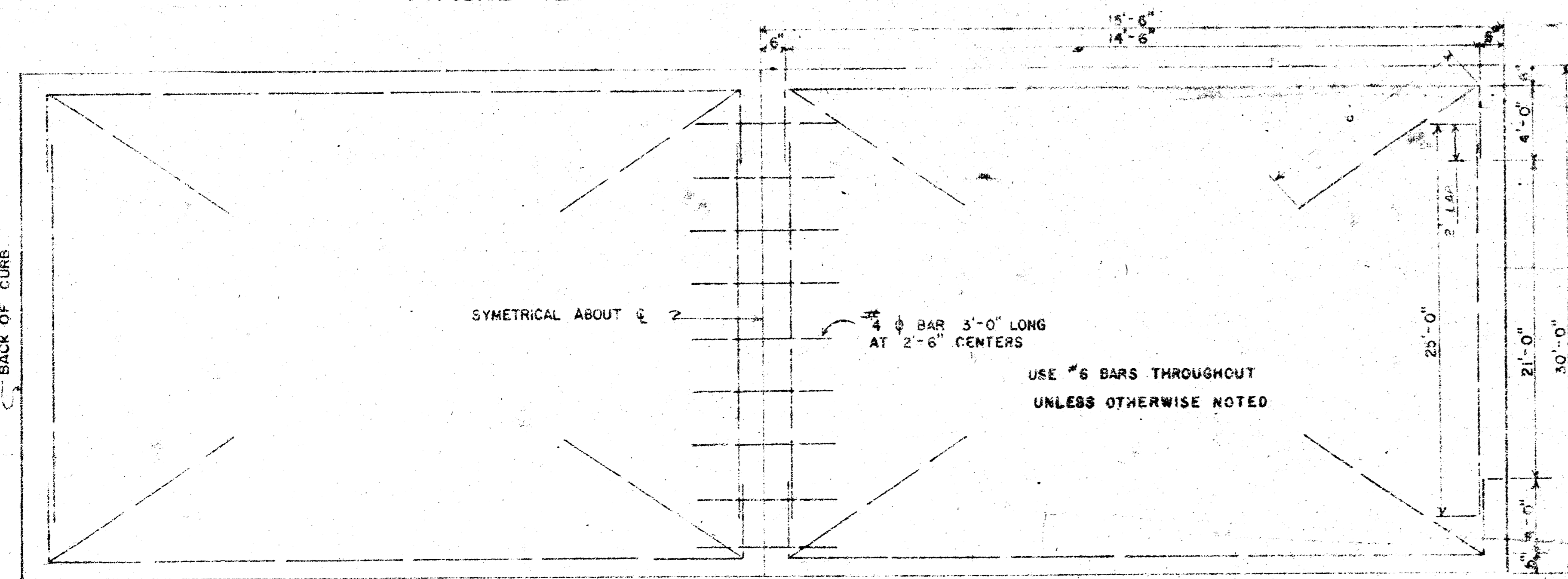

STEEL PATTERN

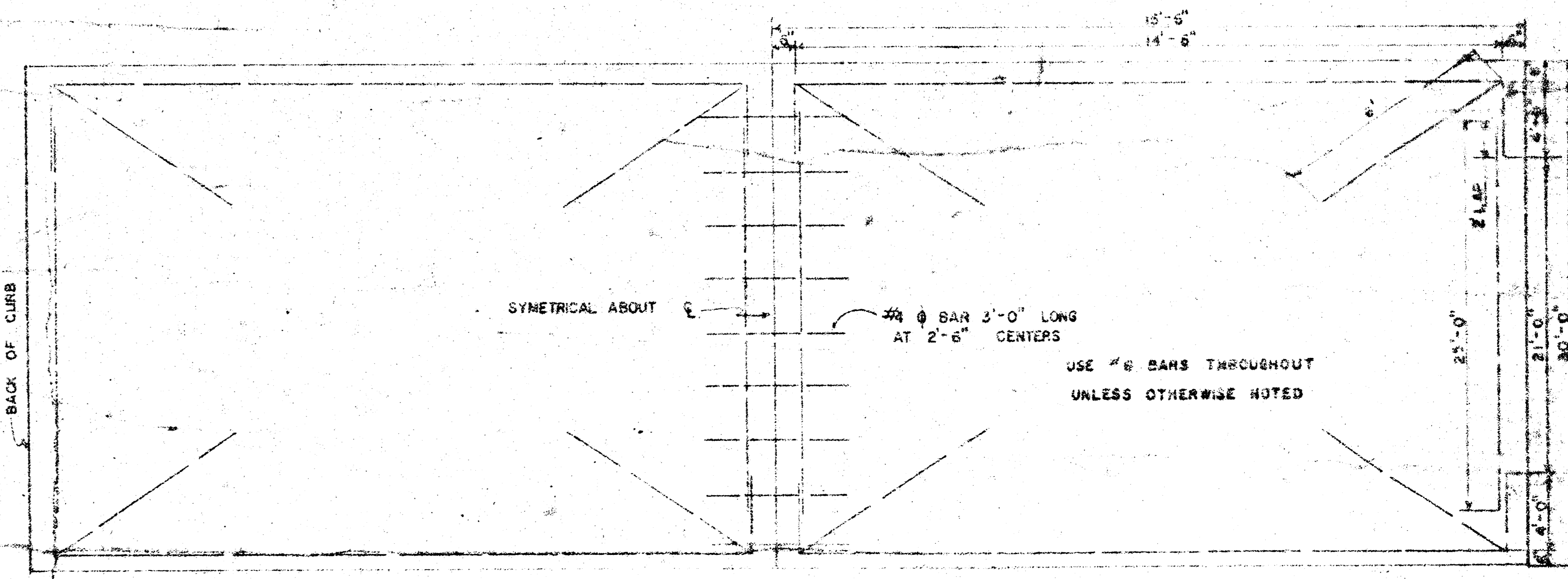

STEEL PATTERN

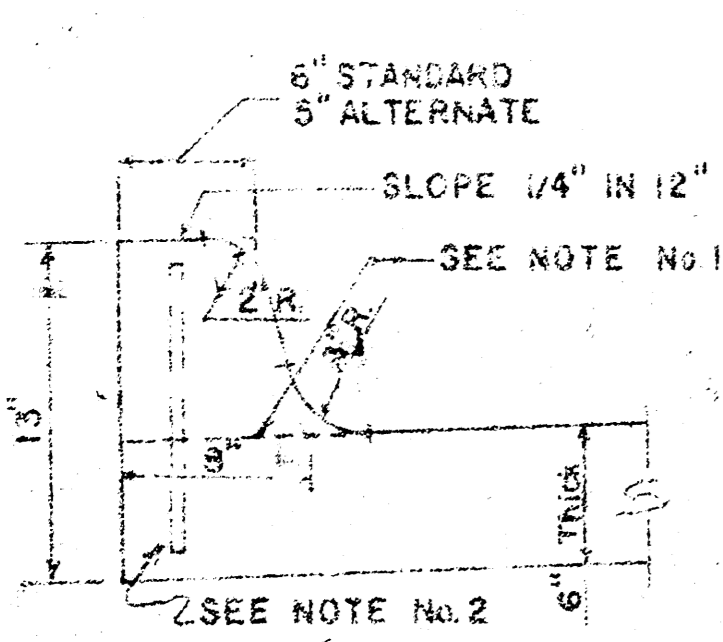

INTEGRAL CURB

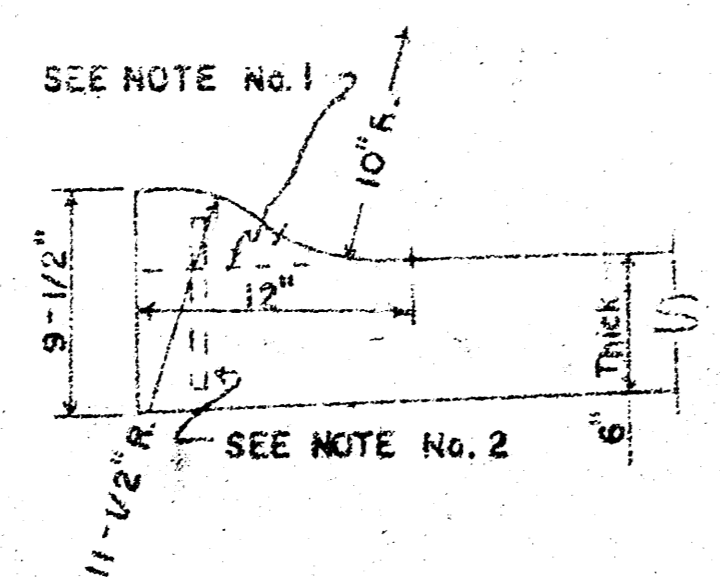

ROLL-TYPE

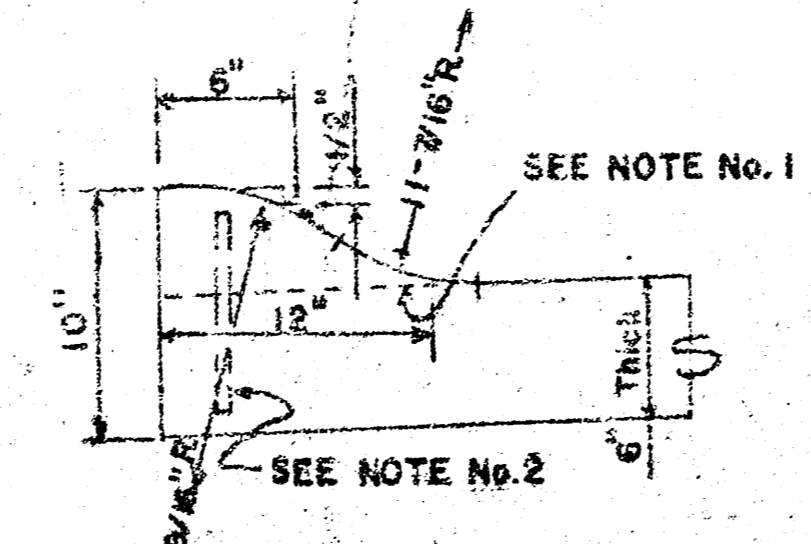

ALTERNATE ROLL-TYPE

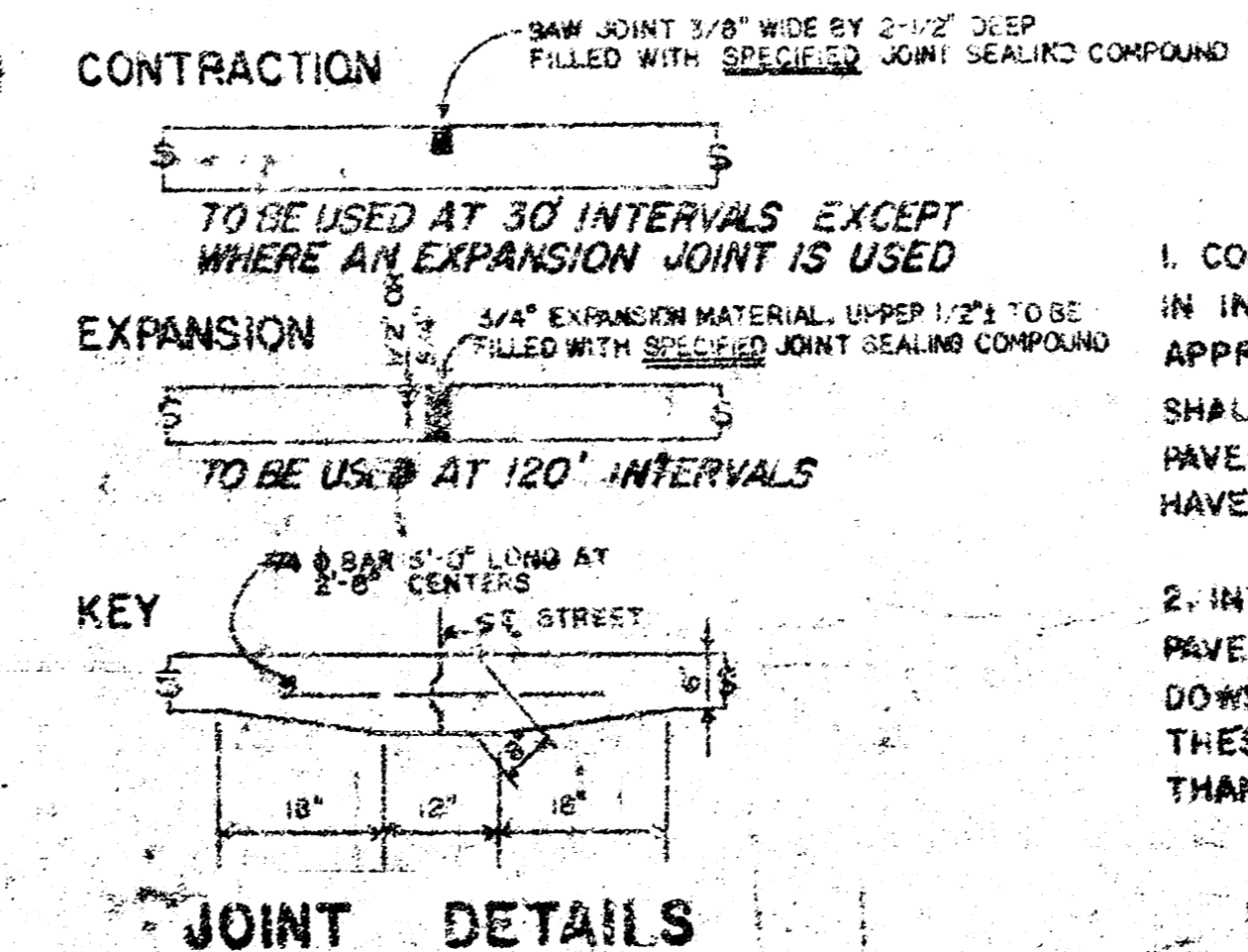

GENERAL NOTES
 1. CONTRACTION JOINTS MAY BE CONSTRUCTED IN INTEGRAL CURB BY SAWING WITH AN APPROPRIATE CONCRETE SAW. THE SAW CUT SHALL EXTEND THROUGH THE CURB TO THE PAVEMENT. SAWED CONTRACTION JOINTS SHALL HAVE A MAXIMUM SPACING OF 10'.
 2. INTEGRAL CURBS SHALL BE TIED TO THE PAVEMENT BASE WITH SHORT DEFORMED DOWEL BARS SPACED AT 2'-6" INTERVALS. THESE DOWEL BARS SHALL NOT BE LESS THAN 1/2" OR MORE THAN 3/4" IN DIAMETER.

CITY OF WICHITA, KANSAS
 Department of Public Works Engineering Division
 R.W. Linn City Engineer
 Date: Project No. DAK5574074

B.M. 126.93 CITY STD. 26' E. & 32' S. OF C.L. OF 13TH & BAKER
 B.M. 132.73 "□" TOP OF CB. N-END MEDIAN ON C.L. ZOO BLVD. SO. OF 13TH
 B.M. 125.88 "□" S-FACE E-W WALK SO. SIDE 12TH ST. AT W.L. DOUGHERTY
 B.M. 128.79 N.W. COR. CONC. PORCH AT 4503 WHITEHALL

℄ IS ℄ OF DOUGHERTY

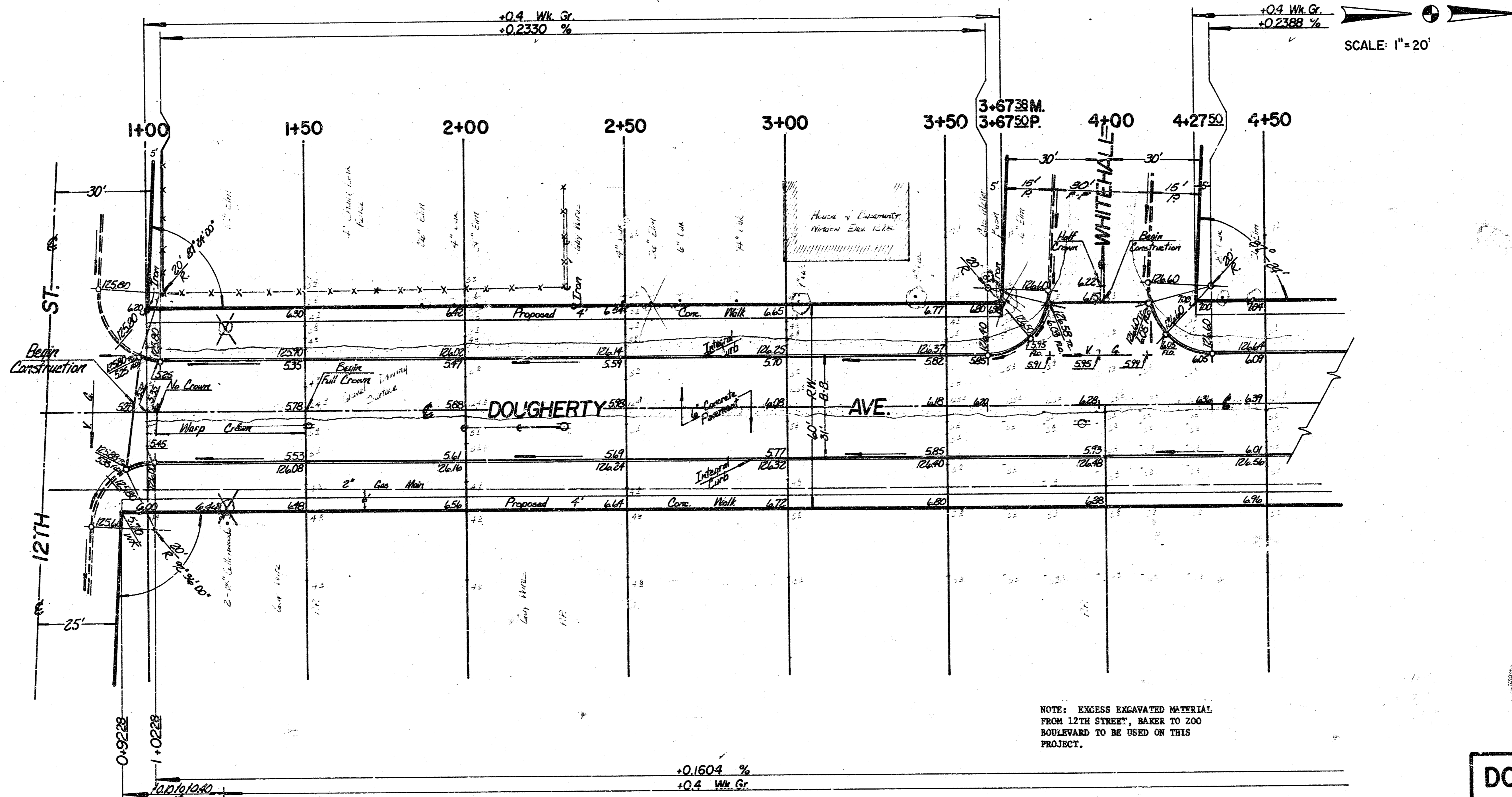

SCALE: 1" = 20'

Survey: KRUIS, BK, DLT, ME
 Plan: NEW & CUB
 Etc.: NEW
 Checked

Manipulation
 Property City
 20625 sr. 1758 sr.

X = Tree Removal
 X = Tree Removal To Be Decided By Engineer

Property		City	
Excavation = 389 c.y.	Comp. Fill = 2601 c.y.	Excavation = 836 c.y.	Comp. Fill = 22 c.y.
+10% = 39 c.y.	+10% = 260 c.y.	+10% = 84 c.y.	+10% = 2 c.y.
Total = 428 c.y.	Total = 2861 c.y.	Total = 920 c.y.	Total = 24 c.y.

NOTE: EXCESS EXCAVATED MATERIAL FROM 12TH STREET, BAKER TO 200 BOULEVARD TO BE USED ON THIS PROJECT.

SUB-GRADE
 TYPE OF SUB-GRADE TREATMENT SHALL BE DETERMINED BY THE FIELD ENGINEER. SUB-GRADE TREATMENT SHALL CONSIST OF LIME TREATMENT, CEMENT TREATMENT, SUB-GRADE MODIFICATION, OR ANY COMBINATION OF THESE.



DOUGHERTY AVE.
 N.L. 12TH ST. TO S.L. 13TH ST.
 30' CONC. W/ INT. CB. (6")
 CITY OF WICHITA, KANSAS
 R.W. LINN - CITY ENGINEER
 DATE: _____
 PROJ. NO. DAKS574074

FILMED FROM THE BEST AVAILABLE COPY.....

B.M. 126.93 CITY STD. 26' E & 32' S. OF C.L. 13TH & BAKER.
 B.M. 132.73 "□" TOP OF CB. N-END MEDIAL ON C.L. ZOO BLVD. SO. OF 13TH.
 B.M. 128.79 N.W. COR. CONC. PORCH AT 4503 WHITEHALL.
 B.M. 125.88 "□" S-FACE E-W WALK SO. SIDE 12TH ST. AT W. L. DOUGHERTY.

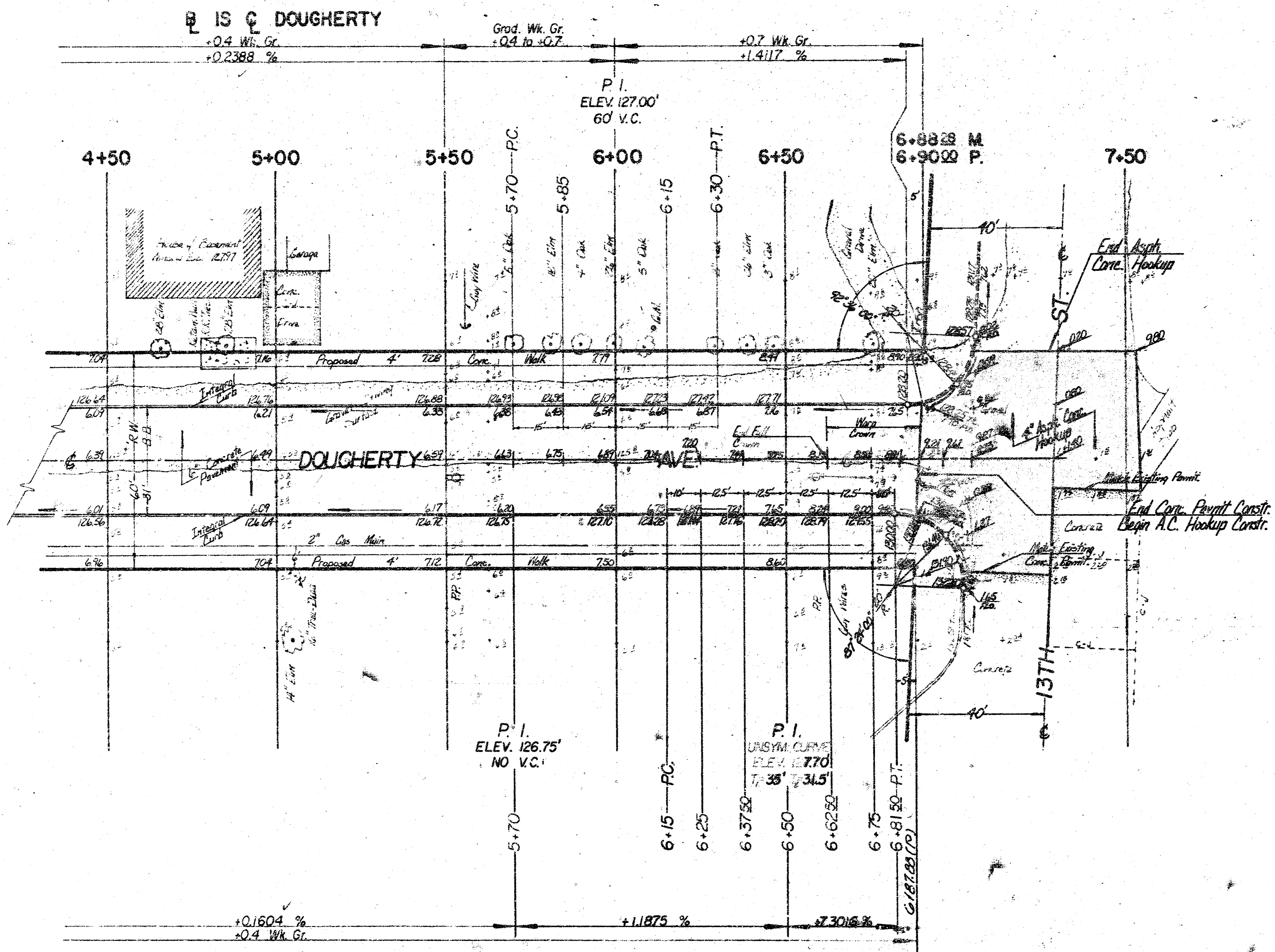
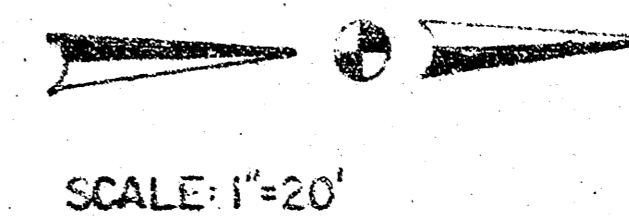

001945 4503 125.88
 Plan: 4503 & 125.88
 Exc: 4503
 Clearing

SUBGRADE
 TYPE OF SUBGRADE TREATMENT SHALL BE DETERMINED BY FIELD ENGINEER. SUBGRADE TREATMENT SHALL BE AS SHOWN OR AS NOTED. THIS IS A GENERAL STATEMENT. MODIFICATIONS SHALL BE MADE AT THE DISCRETION OF THE ENGINEER.

NOT TO FIELD ENGINEER & CONTRACTOR
 Grade existing and clear right-of-way for proposed sidewalk. Compare 11' to sidewalk area. TO BE CONSTRUCTED BY OTHERS.

DOUGHERTY AVE. (3/B)
 PROJ. NO. DAKS574074

FILMED FROM THE BEST AVAILABLE COPY