

DOUGLAS AVE.

W.L. SENECA TO E.L. McLEAN BLVD.

PROJ. C15-32

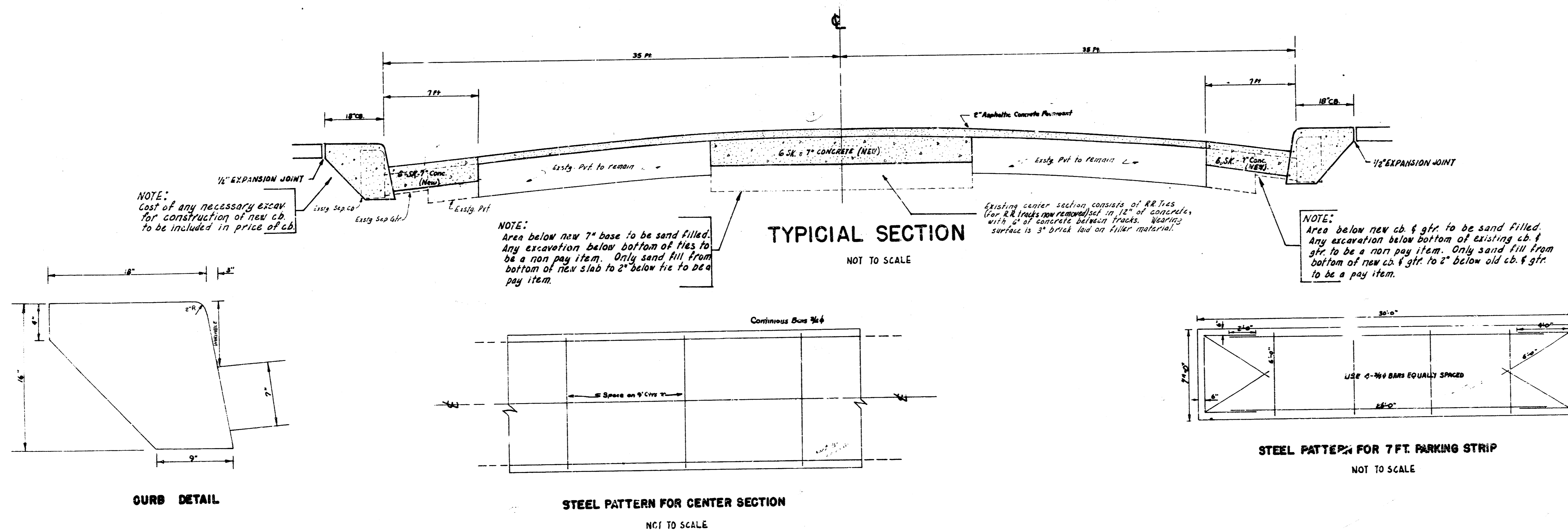

1/6

B.M. 113.67 "X" On bit of w/c @ Cor of Building N.E. Cor of Seneca & Douglas
 B.M. 116.41 "X" On S. Cu. Douglas Ave Bridge E.S. M^oLean.
 Stationed On N4 S. R.

Note to Contractor

Remove the curb & gutter pavement and sidewalk (to nearest joint) to provide for eighteen (18) inch curb and seven (7) foot concrete parking strip seven (7) inches thick. This will consist of removing the first five (5) ft of the old curb as indicated by cross hatched area.

Note to Field Engineer

Contact property owners and see if any drives can be abandoned. Replace desired drives with ramp type opening.

NOTE:
 30' of conc. pvt. & grt. to be removed & replaced with 7" reinforced conc. pvt.

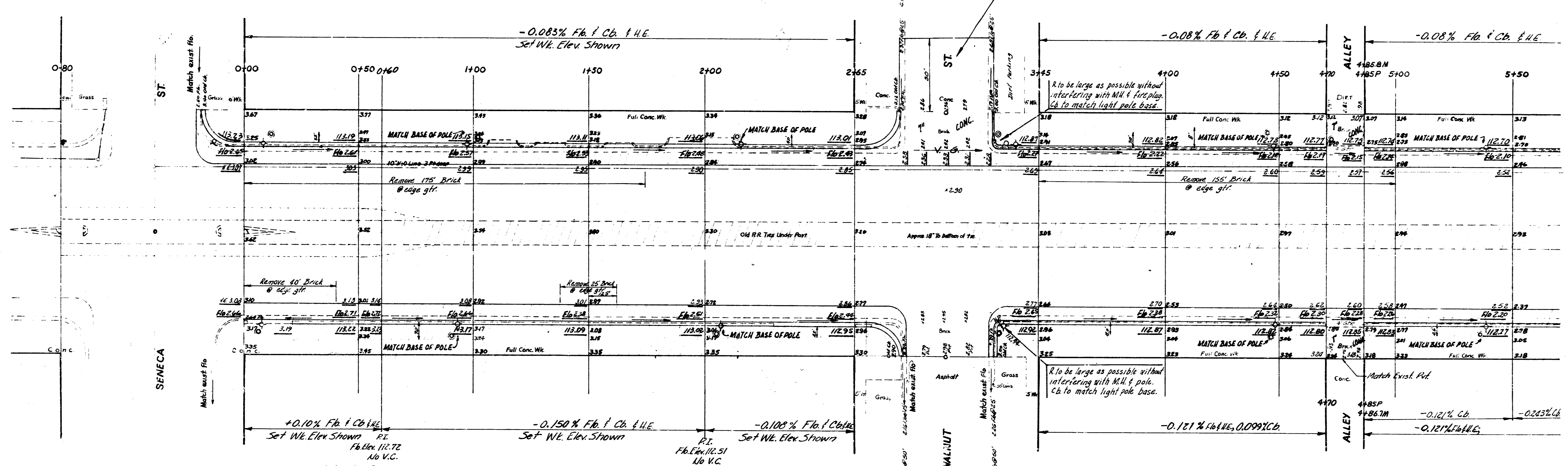
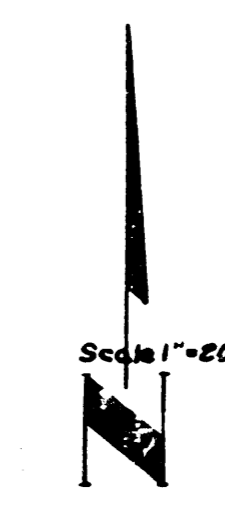

Note to Contractor

The streetway and pavement in the truck area are to be removed and the space filled up with sand to provide for a seven (7) inch reinforced conc. base.

Note:

Place 1' expansion material between curb & sidewalk.

2/6

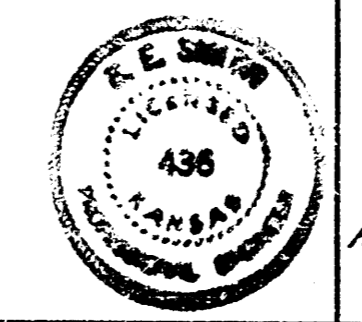

DOUGLAS AVE
 W.L. SENECA TO E.L. M^oLEAN
 RESURFACE A.C.
 CITY OF WICHITA, KANSAS
 B.E. SMITH CITY ENGINEER
 APRIL-1956 Proj. No. C 15-32

NOTE:
Exstg. 18" cb from approx Sta 5140
to Sta 6125 to remain.

NOTE TO FIELD ENGINEER
Control property owners and see if any drives can be
abandoned. Replace abandoned drives with ramp type openings.

NOTE:
Cost of removing siphon
to be included in price of
pvt. removal.

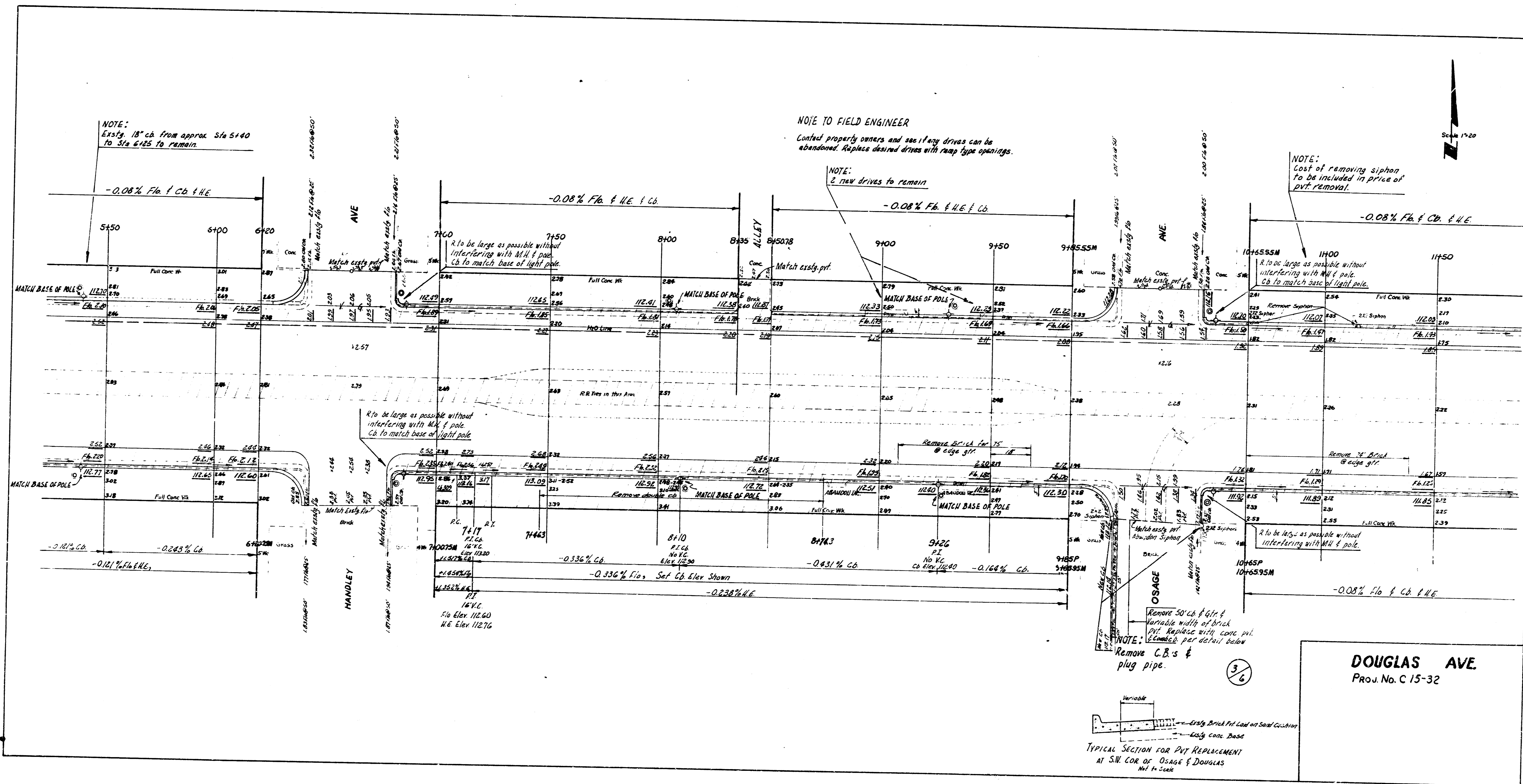

DOUGLAS AVE.
Proj. No. C 15-32

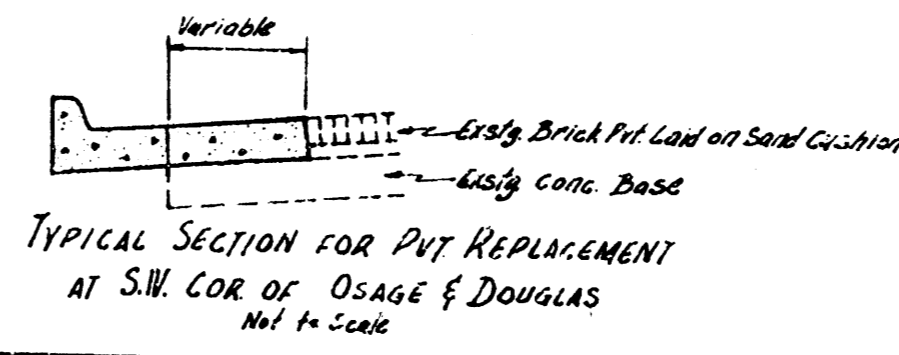

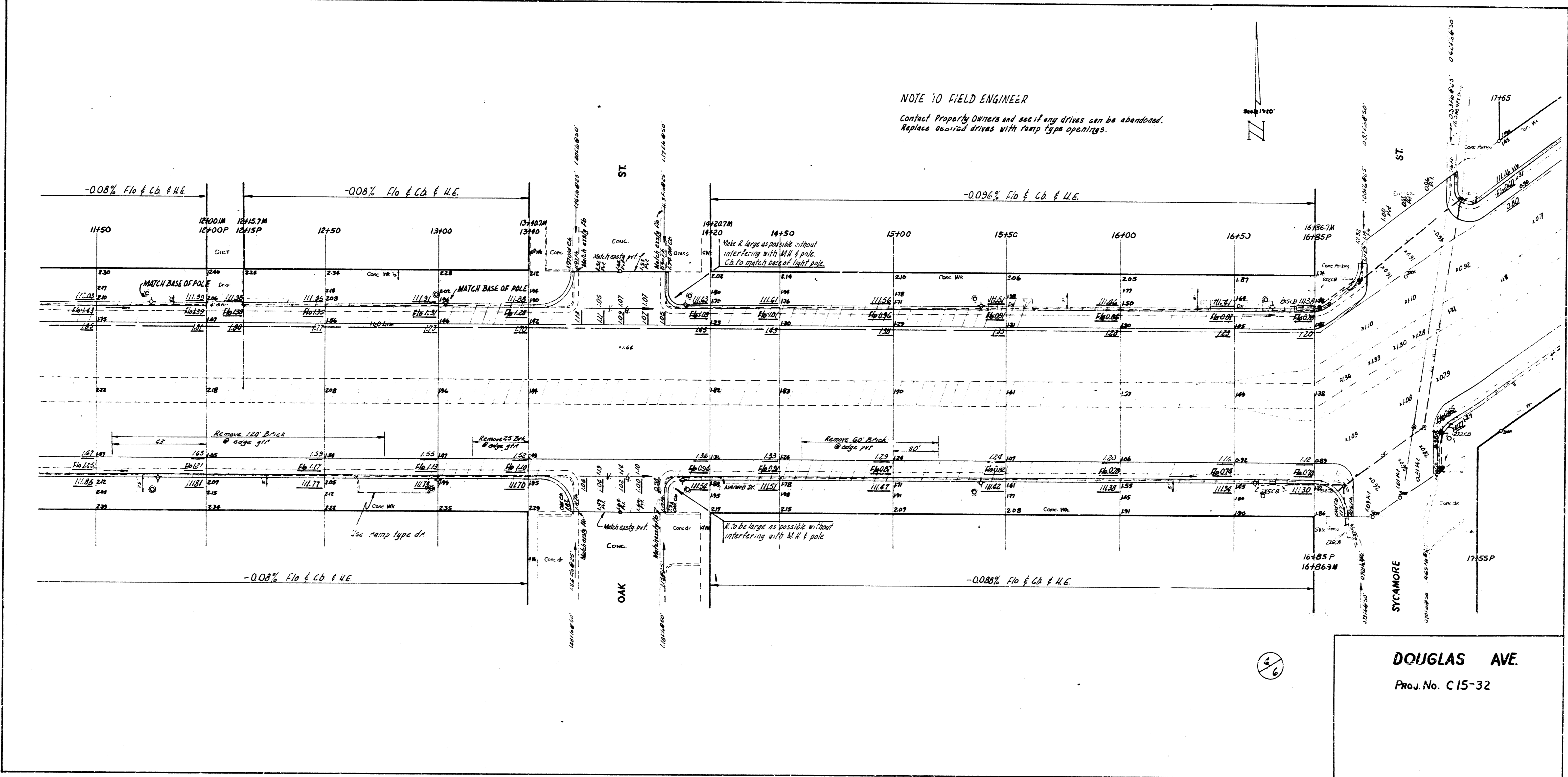

NOTE TO FIELD ENGINEER
 Contact Property Owners and see if any drives can be abandoned.
 Replace abandoned drives with ramp type openings.

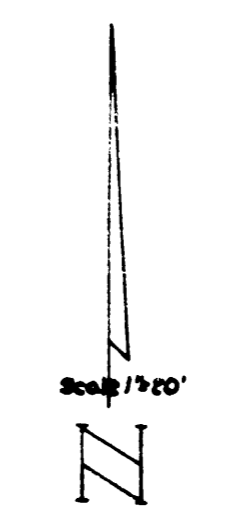

DOUGLAS AVE.
 Proj. No. C 15-32

4/6

