

DOUGLAS AVENUE
 E.L. WEST STREET TO E.L. SHERIDAN AVE.
 PROJECT NO. C19 - 72

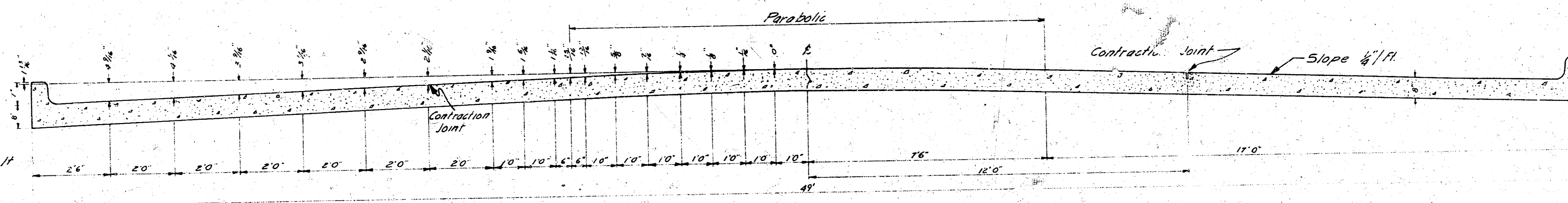

TYPICAL SECTION
 No Scale

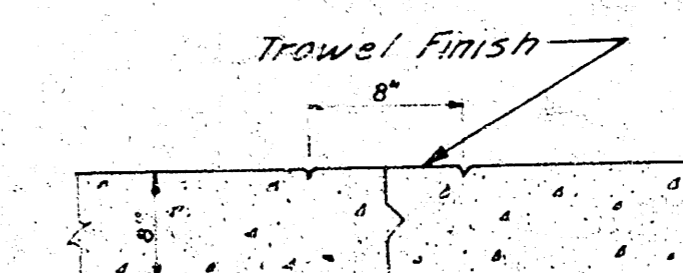

MARKER DETAIL
 No Scale
 Place Full Length of Job

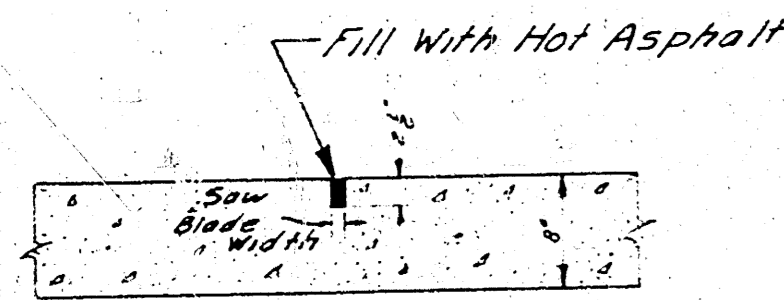

CONTRACTION JOINT
 No Scale
 To Be Used At 30' Intervals
 Except Where An Expansion
 Joint Is Used

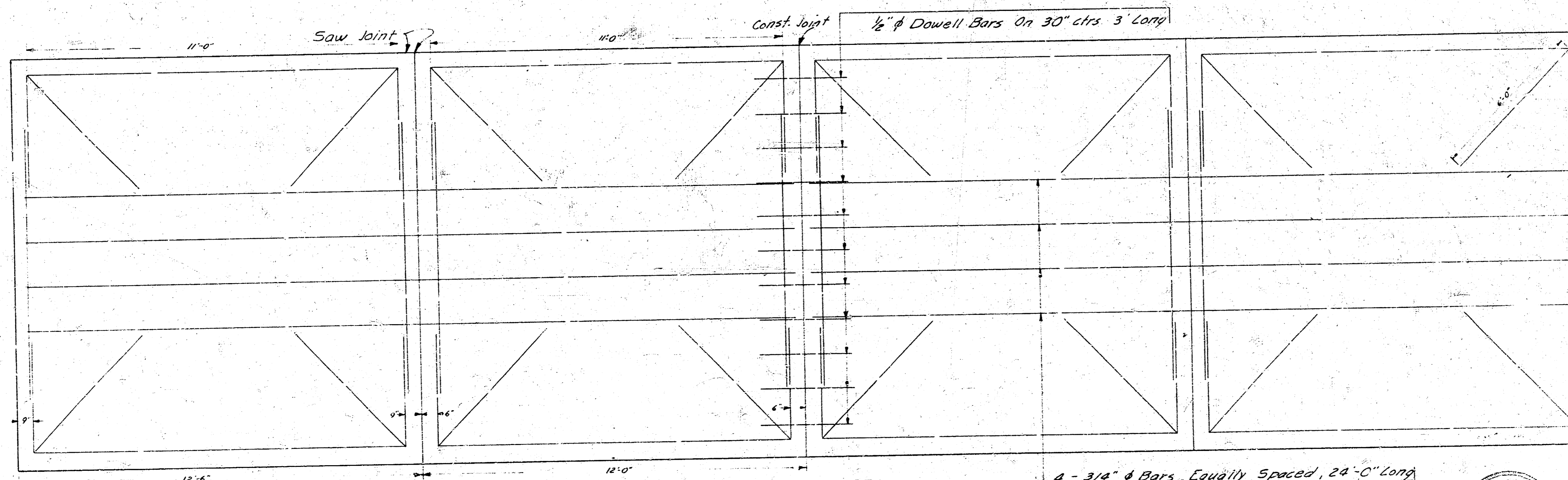

STEEL PATTERN
 No Scale

Use $\frac{3}{8}$ " ϕ Bars Unless Otherwise Specified

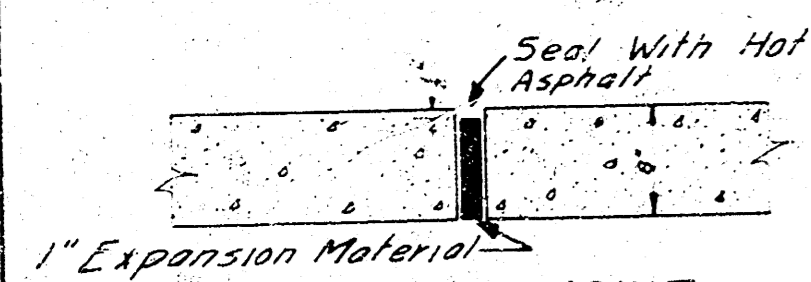

EXPANSION JOINT
 No Scale
 To Be Used At 120' Intervals

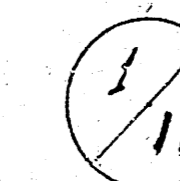
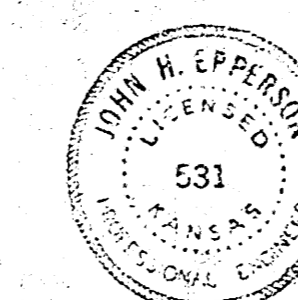

Sheet No. 1 of 2
 Date: 5/11/40
 Scale: 1" = 40'

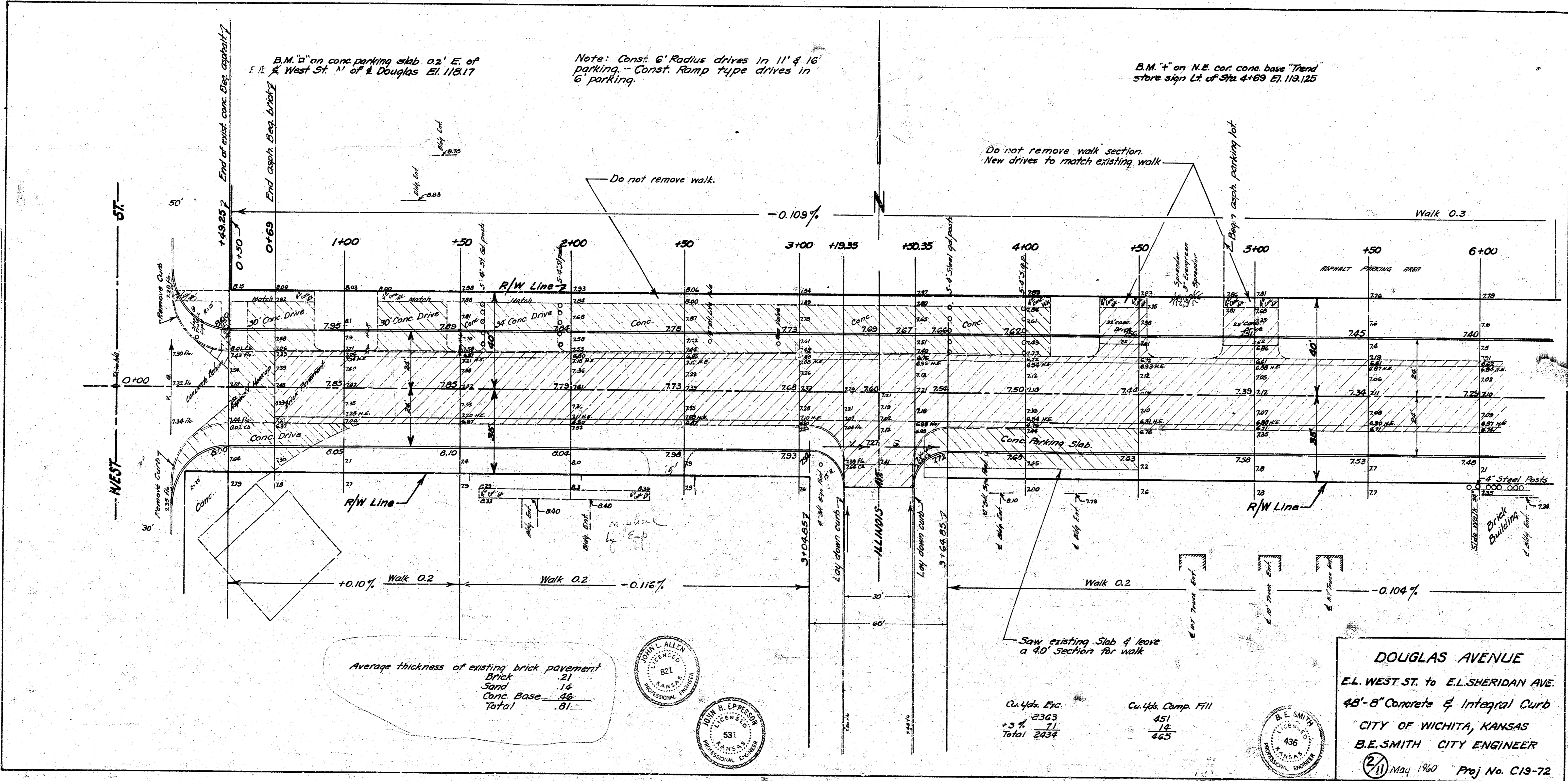

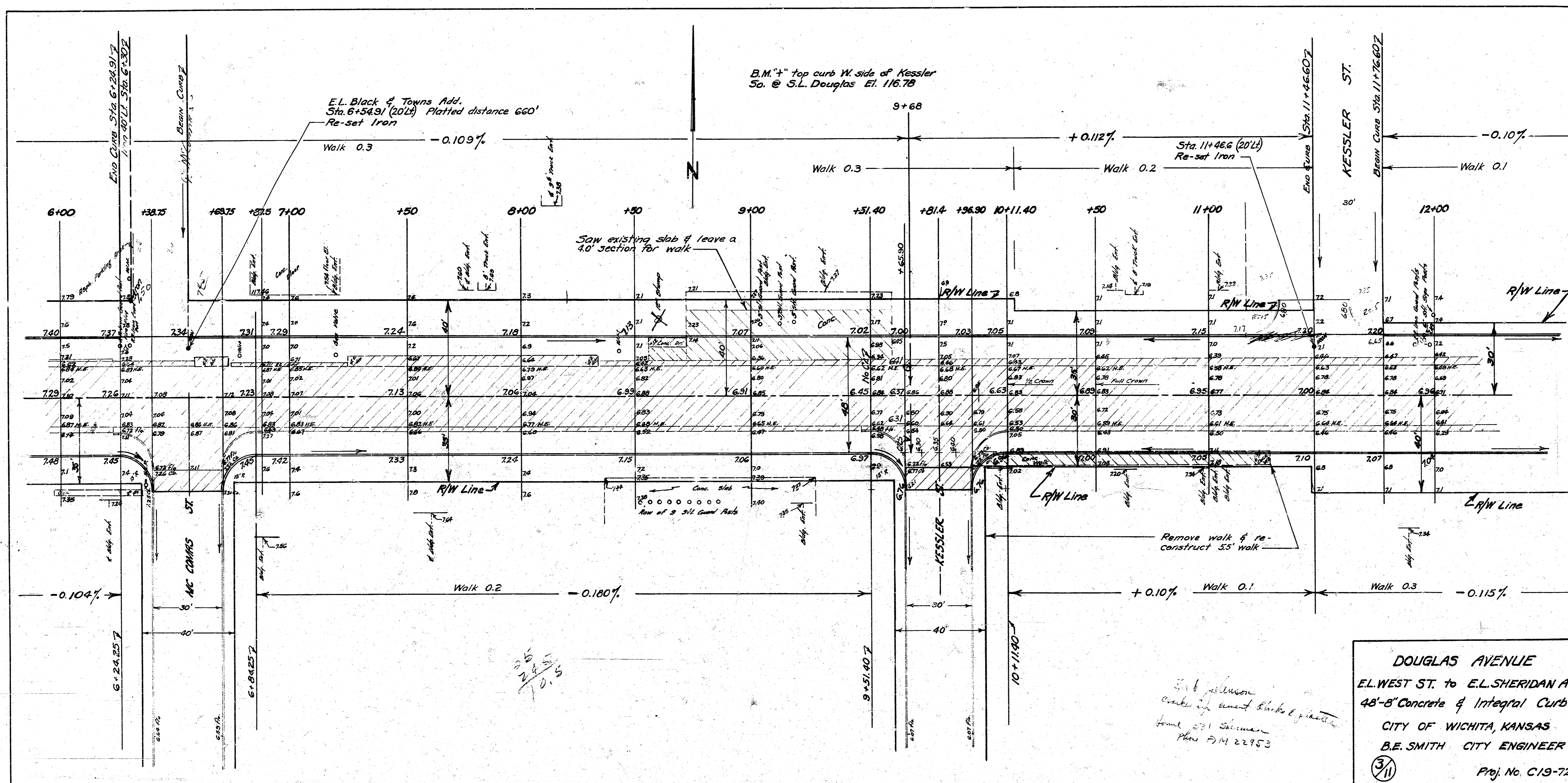

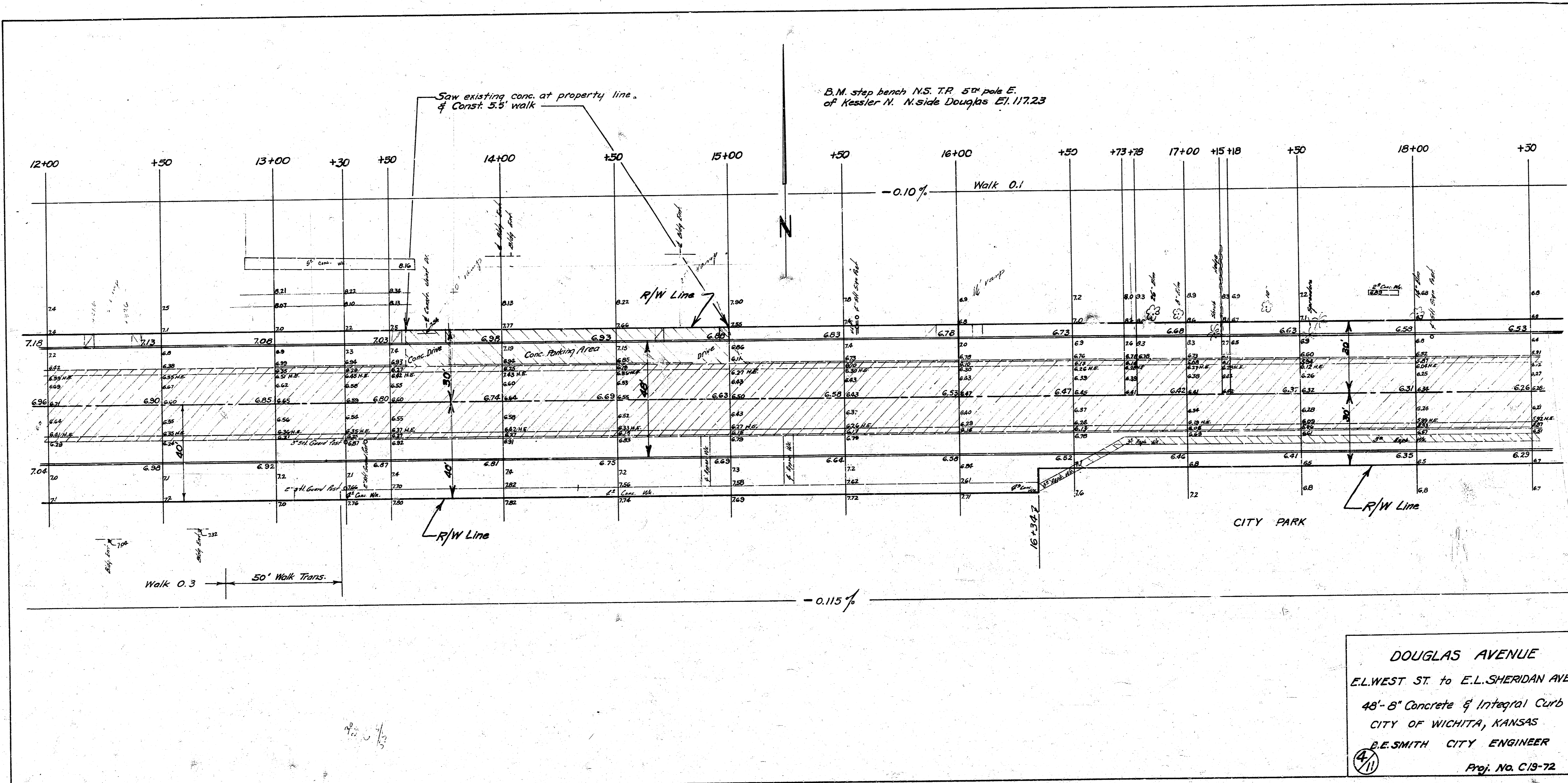

DOUGLAS AVENUE
 E.L. WEST ST. to E.L. SHERIDAN AVE.
 48"-8" Concrete & Integral Curb
 CITY OF WICHITA, KANSAS
 D.E. SMITH CITY ENGINEER
 (47)
 Proj. No. C13-72

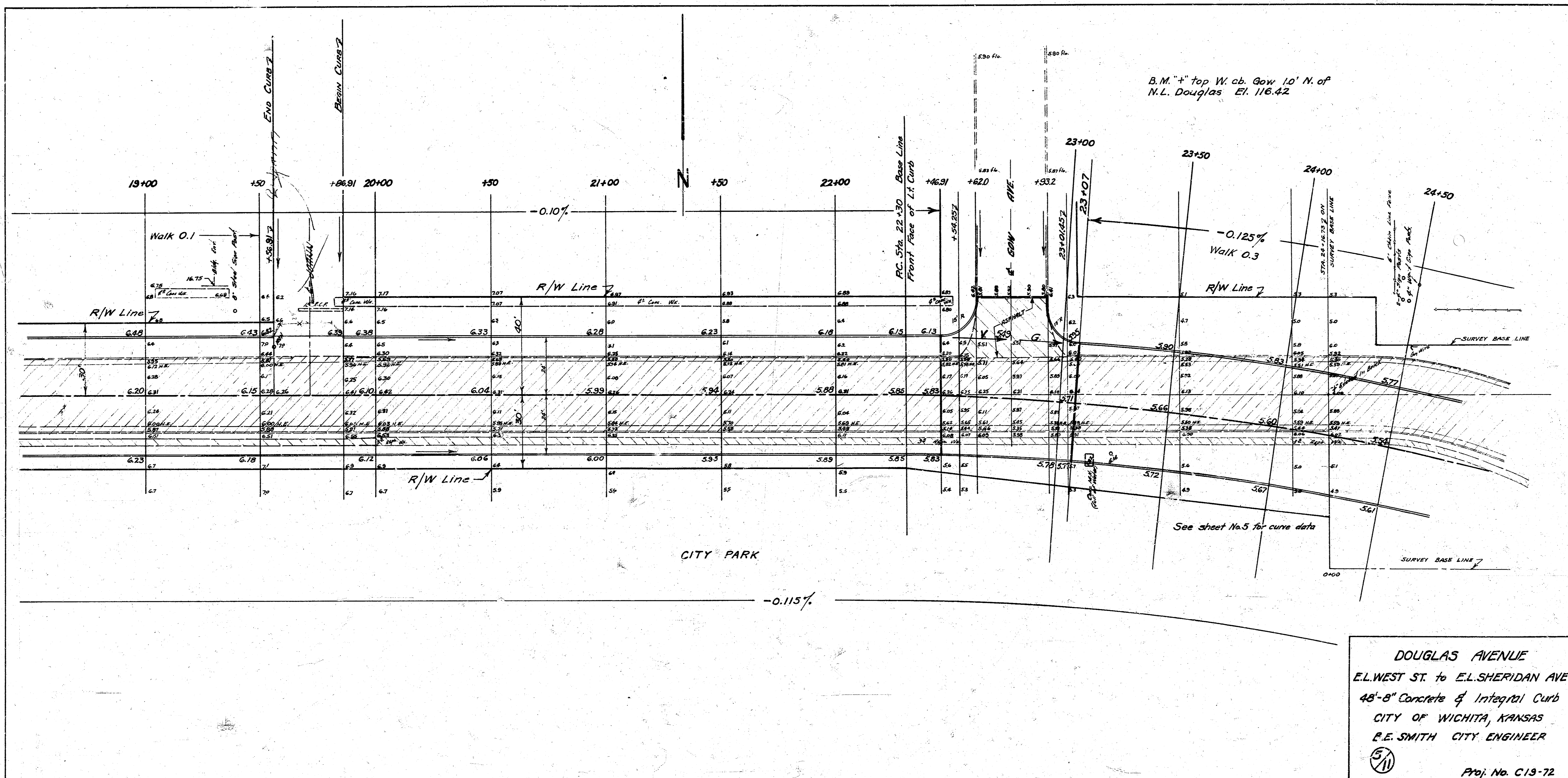

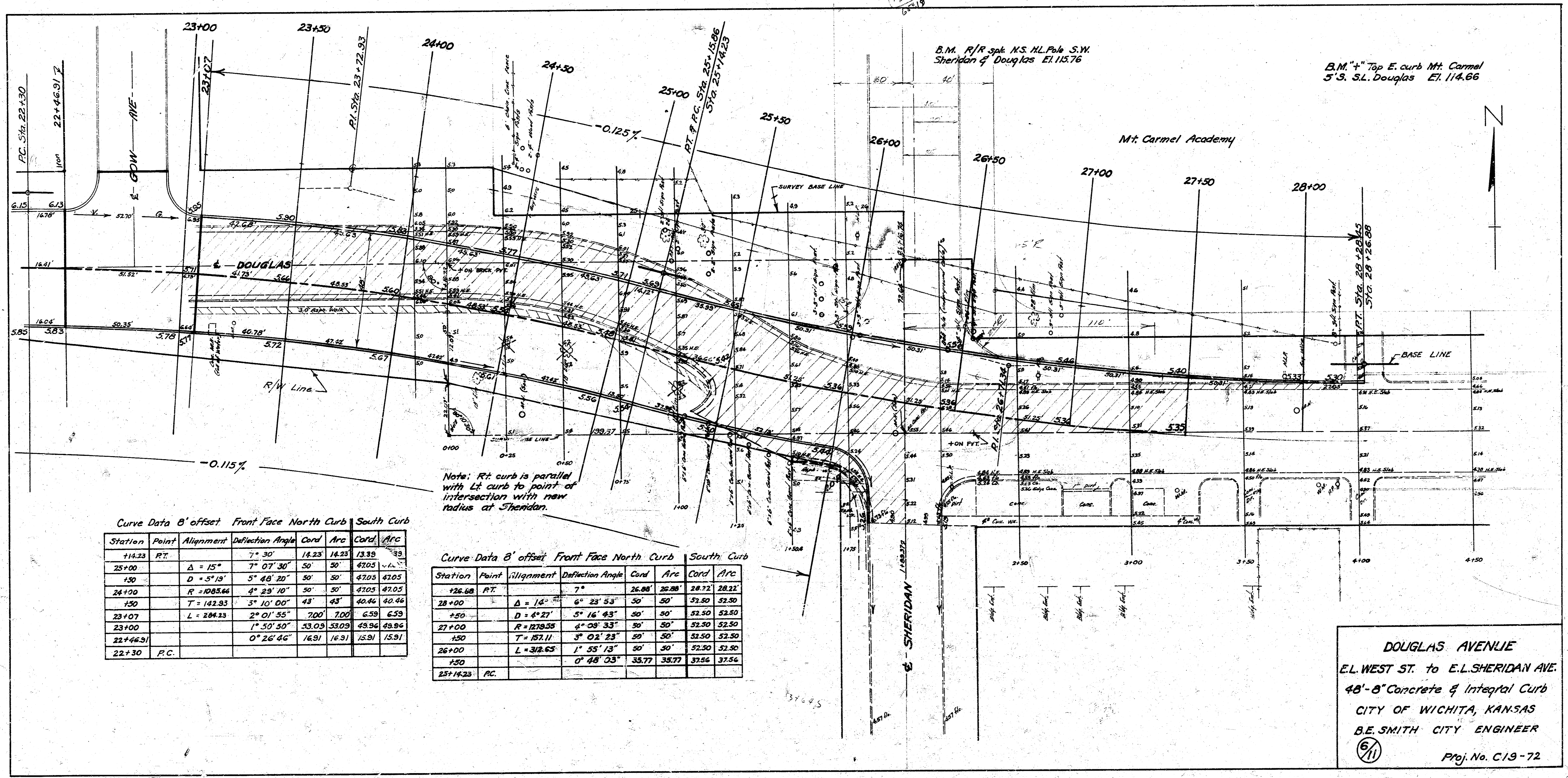

Curve Data @' offset Front Face North Curb South Curb

Station	Point	Alignment	Deflection Angle	Cord	Arc	Cord	Arc
22+30	P.T.		7° 30'	16.23	18.23	13.39	38
25+00		$\Delta = 15^\circ$	7° 07' 30"	50	50	47.05	47.05
24+00		$R = 1285.66$	4° 28' 10"	50	50	47.05	47.05
23+07		$T = 142.83$	3° 10' 00"	43	43	40.44	40.44
23+00		$L = 284.23$	2° 01' 55"	700	700	6.59	6.59
22+46.31			1° 30' 50"	33.03	33.03	49.94	49.94
22+30	R.C.		0° 26' 46"	16.91	16.91	15.91	15.91

Curve Data @' offset Front Face North Curb South Curb

Station	Point	Alignment	Deflection Angle	Cord	Arc	Cord	Arc
26+00	P.T.		7°	26.88	26.88	28.72	28.72
27+00		$\Delta = 14^\circ$	6° 23' 53"	30	30	52.50	52.50
27+00		$R = 1218.58$	5° 16' 43"	30	30	52.50	52.50
26+00		$T = 152.11$	4° 02' 23"	29	29	52.50	52.50
25+00		$L = 304.23$	1° 55' 13"	35.77	35.77	37.54	37.54
25+14.23	R.C.		0° 48' 03"	35.77	35.77	37.54	37.54

DOUGLAS AVENUE
 E.L. WEST ST. to E.L. SHERIDAN AVE.
 48'-8" Concrete & Integral Curb
 CITY OF WICHITA, KANSAS
 B.E. SMITH CITY ENGINEER
 (611)
 Proj. No. C19-72