

BM: 96.08 SW cor. conc. porch Ho # 3502 Downtain  
 BM: 96.42 SW cor. conc. porch Ho # 3548 S Vine  
 Stationing on E.R.

**NOTICE TO CONTRACTOR:**

All entrance pipes are to be disposed of in accordance with instructions of City Dirt Checker.  
 Install Pre-fabricated Mastic Expansion Joint at 60' intervals on the curves.

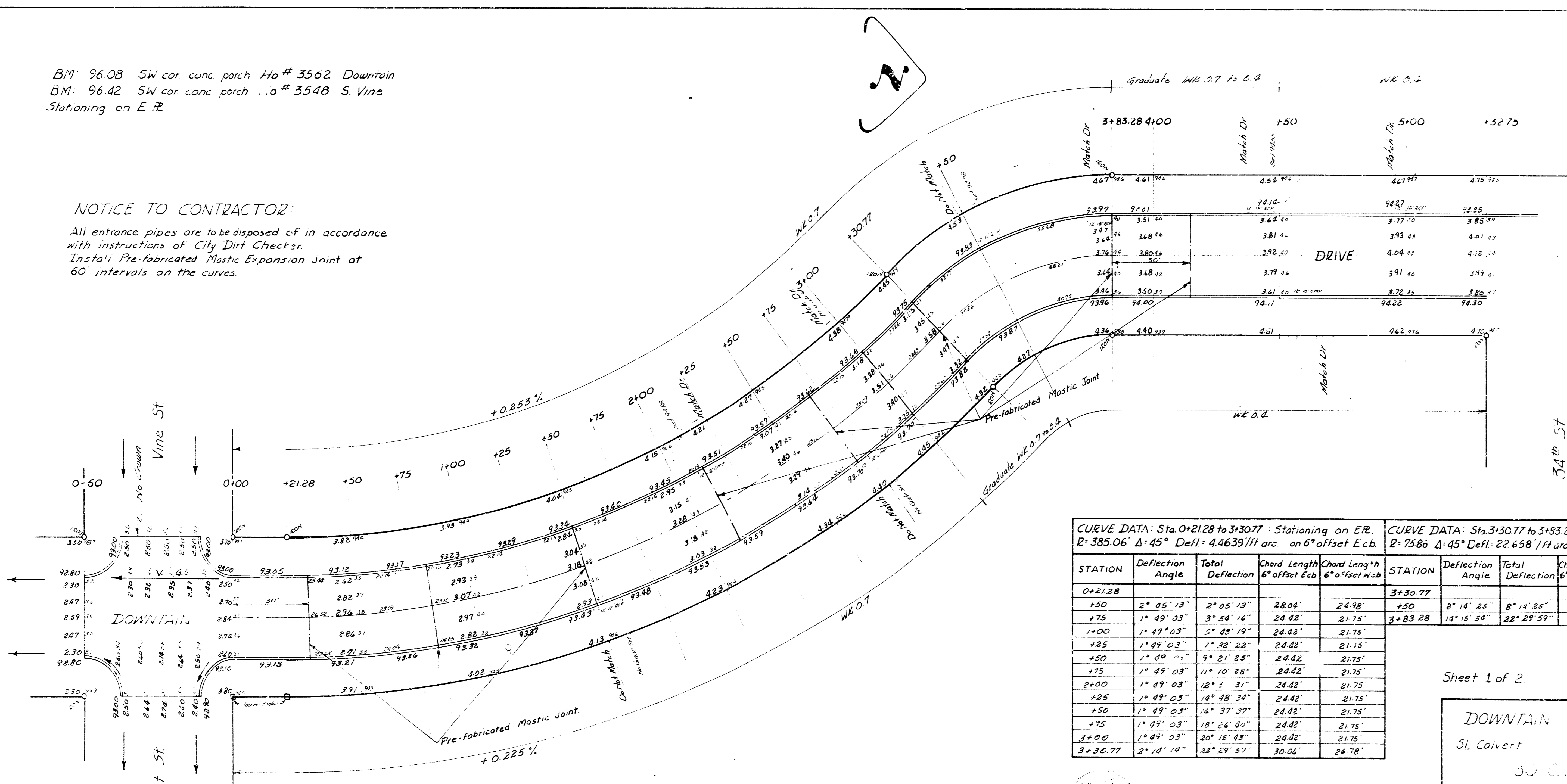

CURVE DATA: Sta 0+2128 to 3+30.77 Stationing on E.R. R: 385.06 Δ: 45° Defl: 4.4639'/ft arc on 6" offset E'cb					CURVE DATA: Sta 3+30.77 to 3+83.28 Stationing on E.R. R: 7586 Δ: 45° Defl: 22.658'/ft arc on 6" offset E'cb				
STATION	Deflection Angle	Total Deflection	Chord Length 6" offset E'cb	Chord Length 6" offset W'cb	STATION	Deflection Angle	Total Deflection	Chord Length 6" offset E'cb	Chord Length 6" offset W'cb
0+2128					3+30.77				
+30	2° 05' 15"	2° 05' 15"	28.06'	24.98'	+50	8° 14' 25"	8° 14' 25"	21.76'	23.18'
+75	1° 49' 03"	3° 54' 18"	24.42'	21.75'	3+83.28	14° 15' 50"	22° 29' 59"	37.37'	29.10'
+100	1° 49' 03"	5° 43' 21"	24.42'	21.75'					
+125	1° 49' 03"	7° 32' 24"	24.42'	21.75'					
+150	1° 49' 03"	9° 21' 27"	24.42'	21.75'					
+175	1° 49' 03"	11° 10' 30"	24.42'	21.75'					
+200	1° 49' 03"	13° 0' 33"	24.42'	21.75'					
+225	1° 49' 03"	14° 50' 36"	24.42'	21.75'					
+250	1° 49' 03"	16° 40' 39"	24.42'	21.75'					
+275	1° 49' 03"	18° 30' 42"	24.42'	21.75'					
3+000	1° 49' 03"	20° 20' 45"	24.42'	21.75'					
3+30.77	2° 14' 18"	22° 29' 59"	30.06'	24.78'					

Sheet 1 of 2

DOWNTOWN  
 St. Covert  
 30 Covert  
 CITY OF WICHITA, KAN.  
 B.E. SMITH CITY ENGINEER  
 June 1906 PRV. NO. 110-11



Young  
 Greene  
 Electric

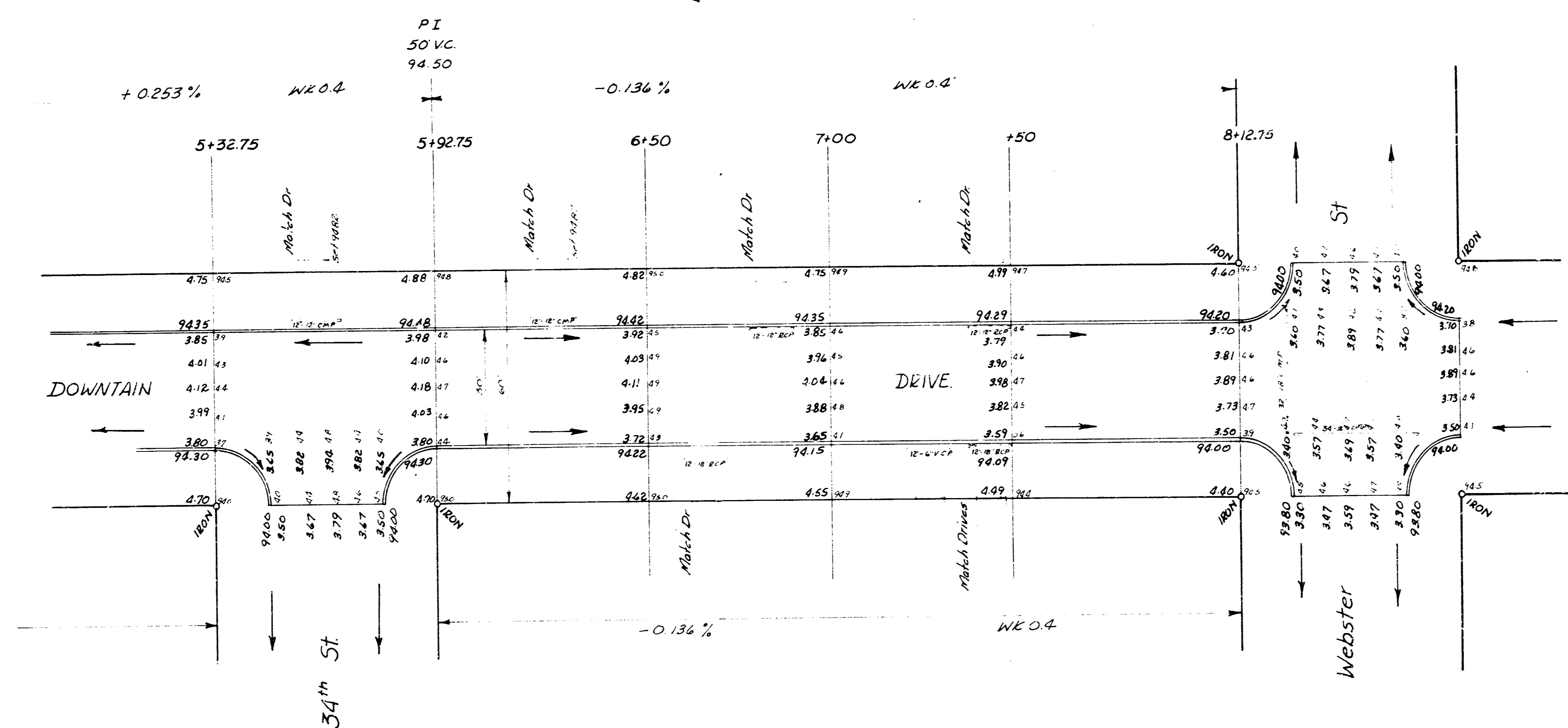

Downtown Drive C16-71  
Sheet 2 of 2