

B.M. 151.45 S.E. corner conc. porch House #1266 Cramer

Scale: 1"=20'



B.M. 151.29 Step bench S side P.Pole S.W. corner 13th & Dunsworth.

NOTE: Depress curb at driveways.

NOTE: Contractor to grade parkings, clear right-of-way and compact fill for proposed sidewalk. Sidewalk to be constructed by others. All excavation not used for compacted fill shall be wasted in parking areas.

Survey Young Blaney  
From J.C.H.  
Ext. 1/2  
Checked 1/2

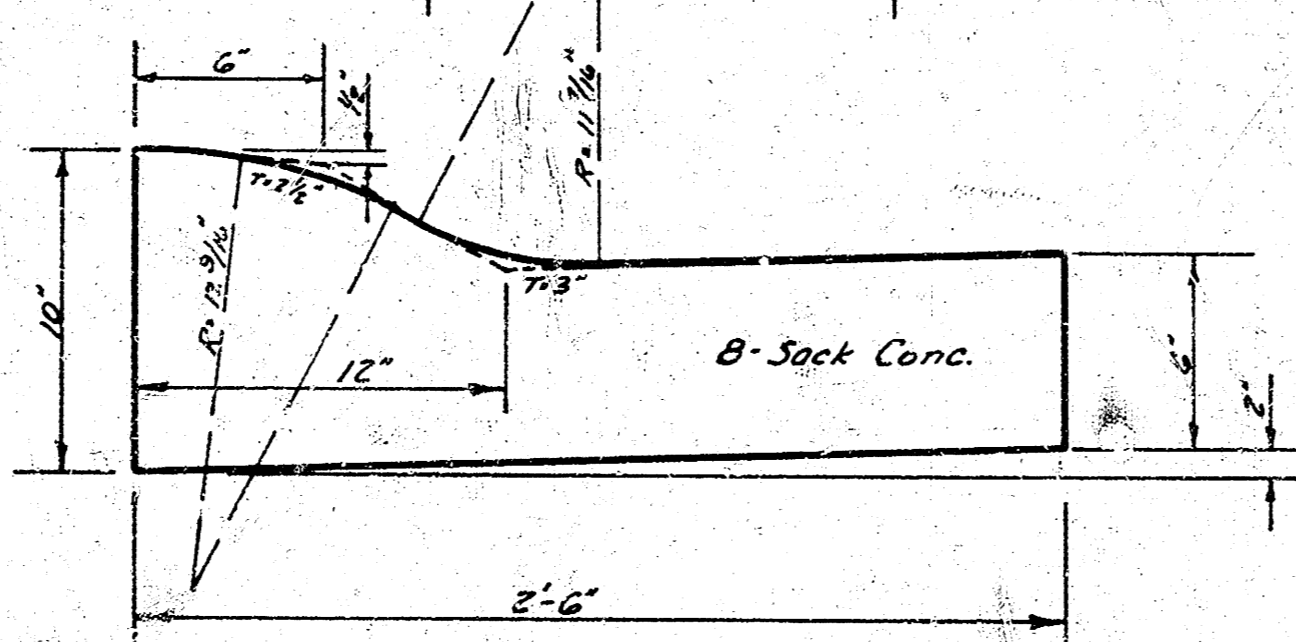
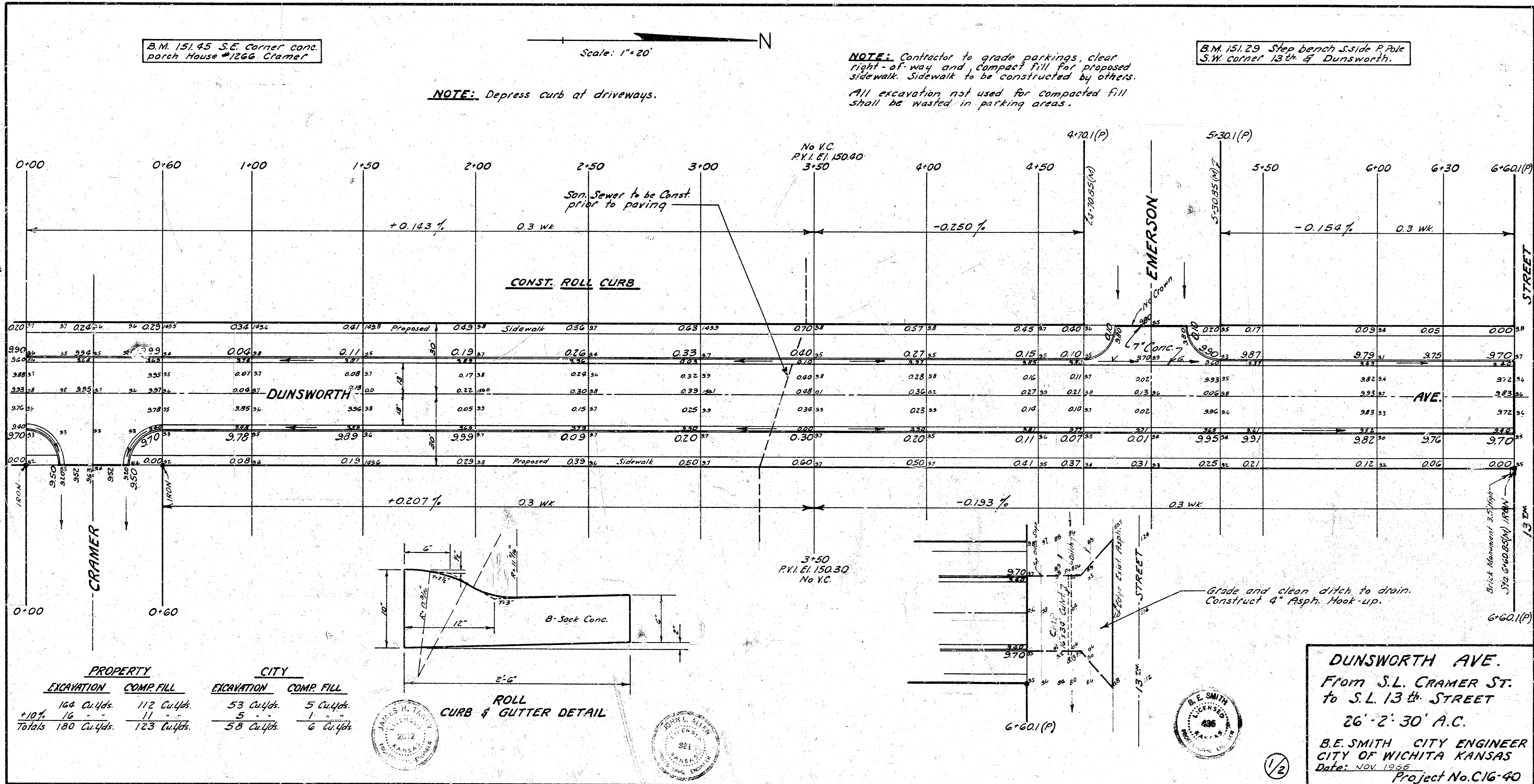

PROPERTY		CITY	
EXCAVATION	COMP. FILL	EXCAVATION	COMP. FILL
164 Cu.Yds.	112 Cu.Yds.	53 Cu.Yds.	5 Cu.Yds.
+104	16	5	1
Totals 180 Cu.Yds.	123 Cu.Yds.	58 Cu.Yds.	6 Cu.Yds.

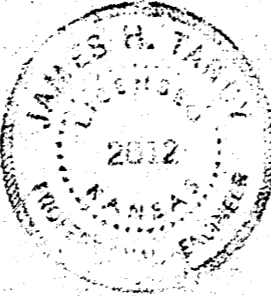

1/2

**DUNSWORTH AVE.**  
From S.L. CRAMER ST.  
to S.L. 13<sup>th</sup> STREET  
26'-2'-30" A.C.  
B.E. SMITH CITY ENGINEER  
CITY OF WICHITA KANSAS  
Date: NOV 1936  
Project No. C16-40