

B. M. 145.38 "I" on N.W. cor. handrail R.C.B.C.
 on Harry 238' E. of E. Rock Rd.
 B. M. 153.26 Hex head bolt N. side R.P. N.W. cor
 Harry & Eastmoor.
 B. M. 143.57 "R" in Ritchie N. cb Boston & E.L. Parke.

⊕ = East PC

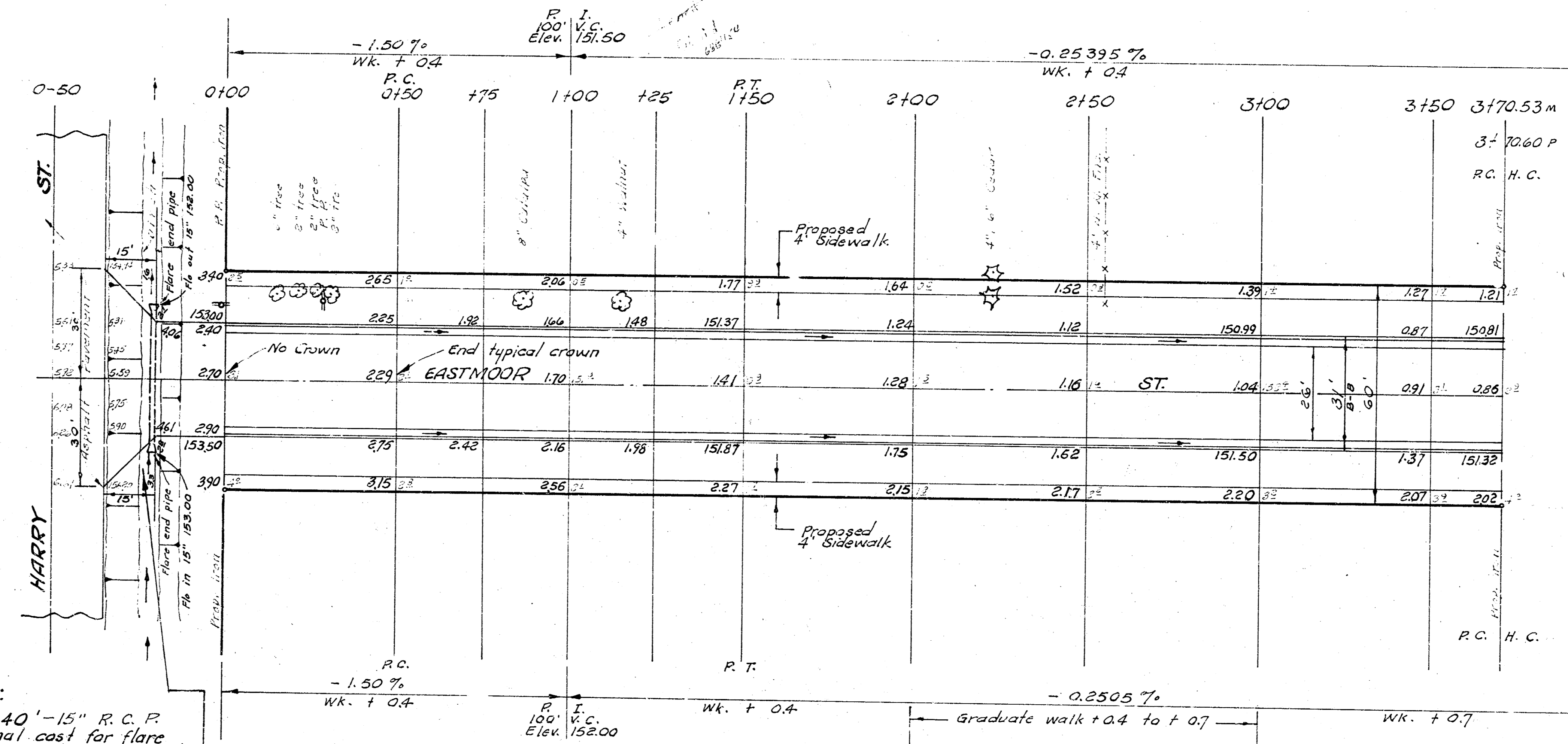
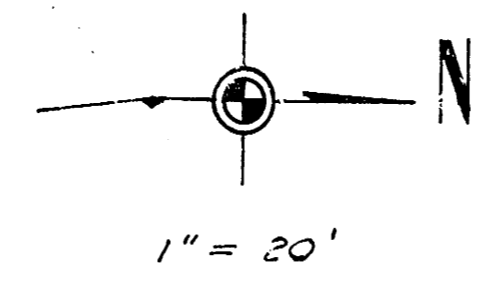

NOTE:
 Install 40' - 15" R.C.P.
 Additional cast for flare
 end pipe is to be incidental
 to bid price of 15" R.C.P.
 Construct (4") asphalt
 Hook-up.

EXCAVATION		FILL COMPACTION		LIME TREATED SUB-GRADE	
PROPERTY	CITY	PROPERTY	CITY	PROPERTY	CITY
1372.0	10.2	72.9	38.3	2336.3	70.1
137.2	1.0	7.3	3.8	2426.4	70.1
1509.2	11.2	79.2	42.1		

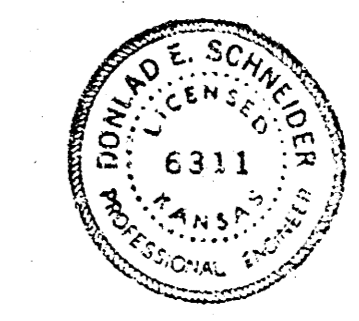

EASTMOOR ST.
 N. L. HARRY ST. TO S. L. BOSTON ST.
 31' ASPHALT CONC. PAV'T, CB & GTR.
 CITY OF WICHITA, KANSAS
 R. W. LINN — CITY ENGINEER
 SEPT. 1972 PROJECT NO. DAKS572044

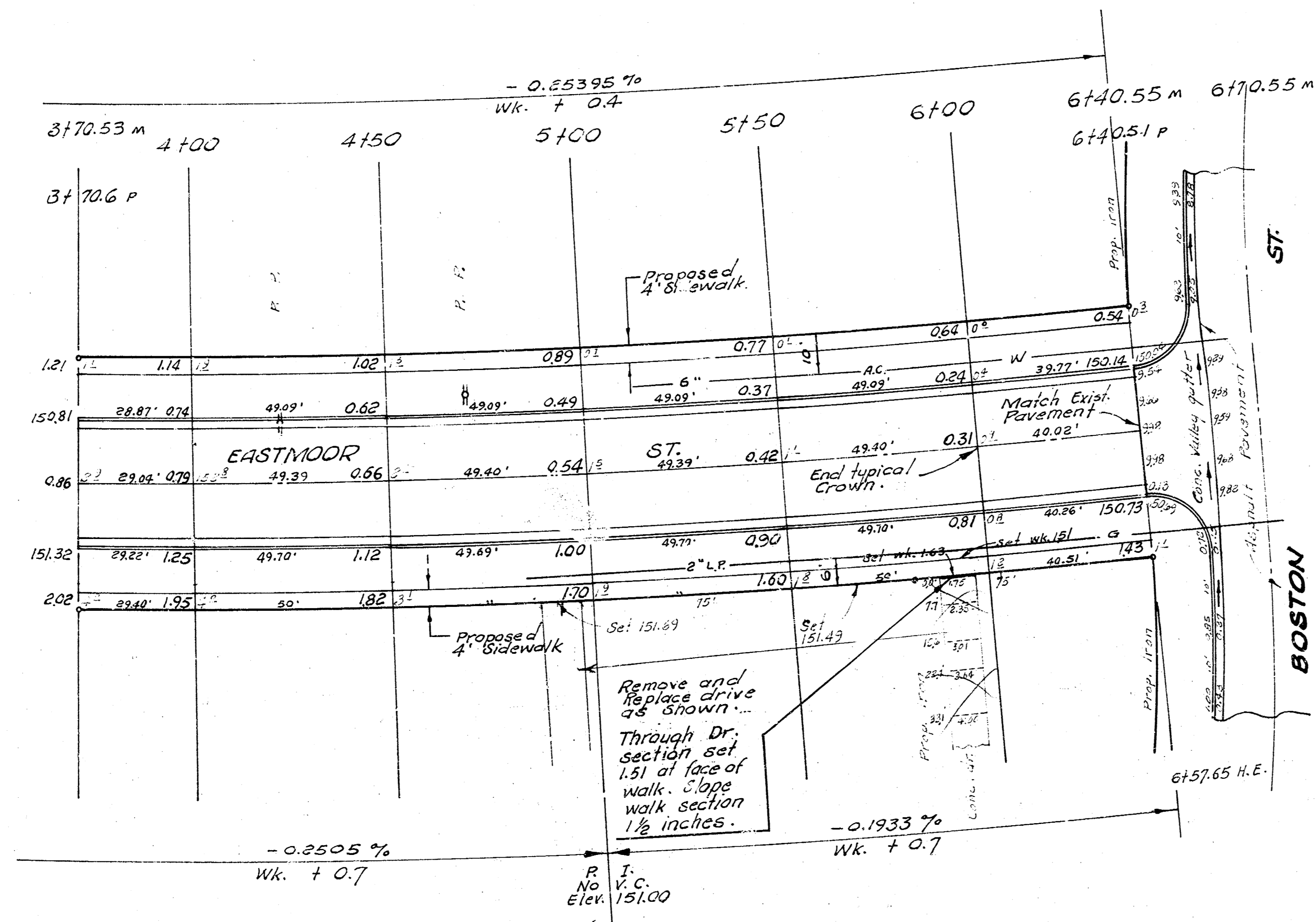
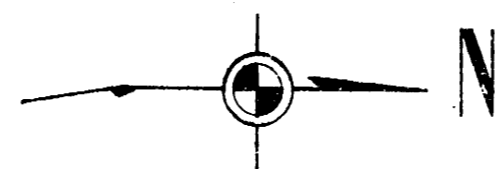

CURVE DATA

$\Delta = 6^\circ - 15''$ $R = 2474.51'$
 $L_c = 269.33'$ $L = 269.97'$ 0.694676 Min./f. Arc

STATION	ARC	CHORD LENGTH		DEFLECTION	TOTAL DEFLECTION
		Off-R. E. Ch	Off-R. W. Ch		
3+70.6	P.C.			0° 00' 00"	0° 00' 00"
4+00	29.40'	29.31'	28.77'	0° 20' 25"	0° 20' 25"
5+00	50.00'	49.84'	48.91'	0° 34' 44"	0° 55' 09"
5+50	"	"	"	0° 34' 44"	1° 29' 53"
6+00	"	"	"	0° 34' 44"	2° 04' 37"
6+40.51	40.51'	40.37'	39.62'	0° 28' 09"	3° 07' 30"

EASTMOOR ST.
 N. L. HARRY ST. TO S. L. BOSTON ST.
 PROJECT NO. DAK 5572044