

DOUGLAS AVE

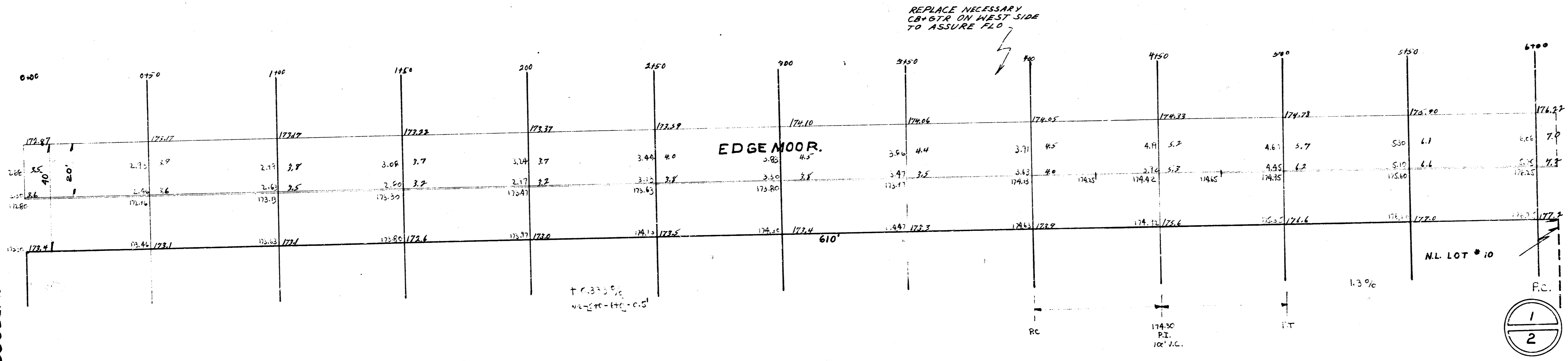

BM 172.41 G in Globe Wch Edgemoor SL 2nd T
BM 173.97 Top Iron Wch Edgemoor SL Douglas

EDGE MOOR
S.L. SECOND
20' CONC. / CB.
CITY OF WICHITA, KANSAS
L.K. WHITE CITY ENGINEER
JULY 1947

