

H-3

B.M. 203.05 "G" IN GLOBE W. CO. EDGEWOOD & S.L. 9TH  
B.M. 204.17 "M" IN MUELLER TWP HYD. S.W. COR. EDGEWOOD & 10TH

Prop. 316.4  
12.70  
345.8

21.1  
55.1  
12.2  
22.2

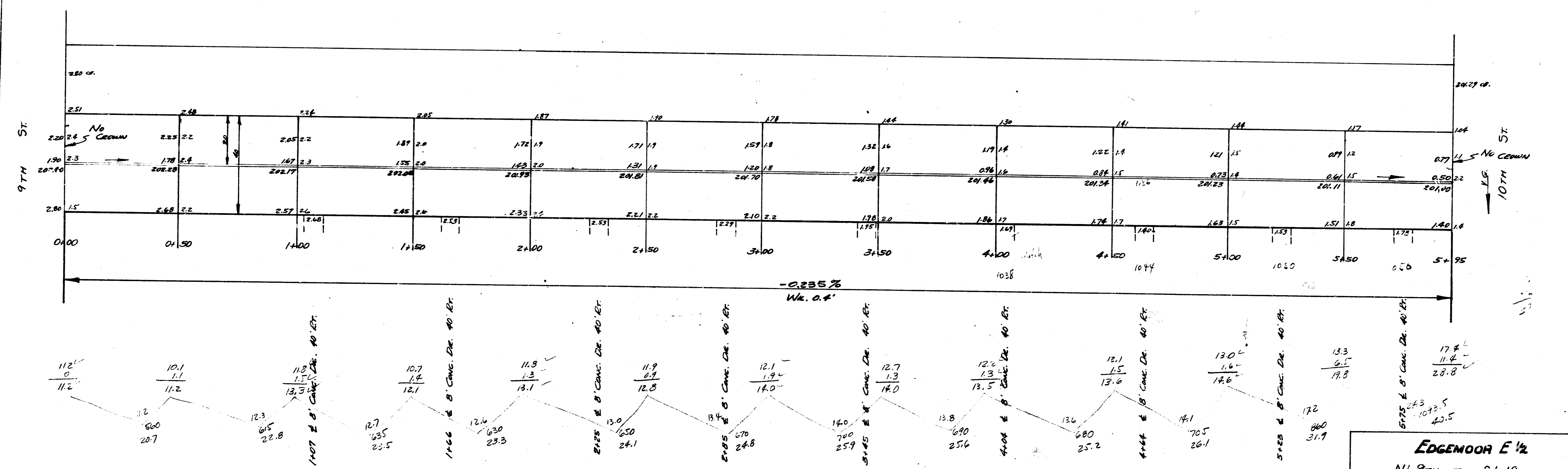
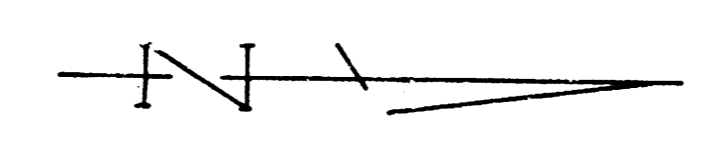

**EDGEWOOD E 1/2**  
 NL. 9TH TO S.L. 10TH  
 15' C & CB  
 WIDEN TO 20'  
 CITY OF WICHITA, KANSAS  
 L.H. WHITE CITY ENGINEER  
 APRIL 1952 PROJ. NO. C-11-303 & C-11-304

B.M. 205.80 5' in 2-302 Top S. Abrie. Valve Dtg. 15' NE. E. 9<sup>th</sup> Edgemoor  
 B.M. 207.40 Top of Iron Post E. Edgemoor, 45' N of B. 10<sup>th</sup>  
 B.M. 203.05 10' in S. 6666 W. Edgemoor, S.L. 9<sup>th</sup>

Property

62.6  
 71.3  
 88.7  
 91.0  
 91.3  
 89.6  
 88.9  
 108.7  
 95.8  
 93.7  
 59.8  
 114.2  
 111.5  
 110.2  
 122.7 C.M.



Wk 10'  
 -0.234%

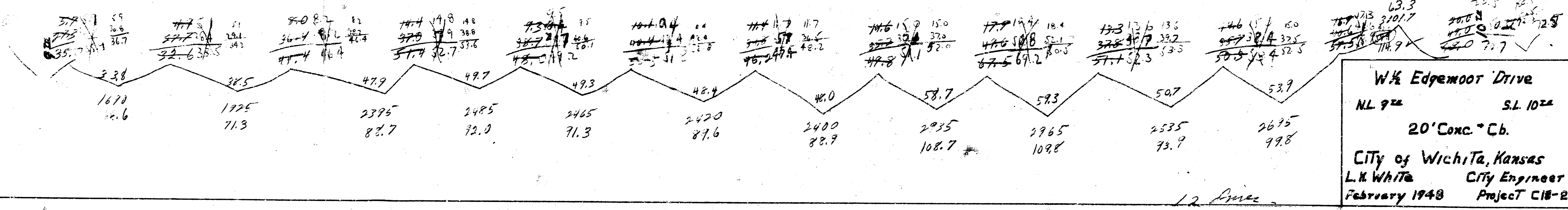
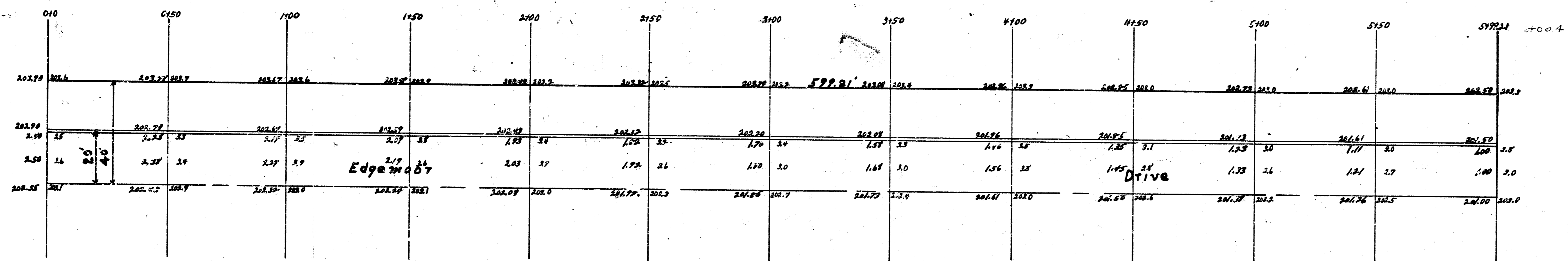

Wk Edgemoor Drive  
 NL 9<sup>th</sup> S.L. 10<sup>th</sup>  
 20' Conc. Cb.  
 City of Wichita, Kansas  
 L.K. White City Engineer  
 February 1948 Project C18-2

12 151 14