

**EDWARDS AVE.**  
**SL Lydia — SL May**  
 PROJ. NO. DAKS 571017  
 CITY OF WICHITA, KANSAS  
 R. W. LINN, CIVIL ENGINEER

SAWED CONTRACTION JOINTS ARE TO BE CONSTRUCTED AT 30'-0" INTERVALS EXCEPT WHERE AN EXPANSION JOINT IS USED.

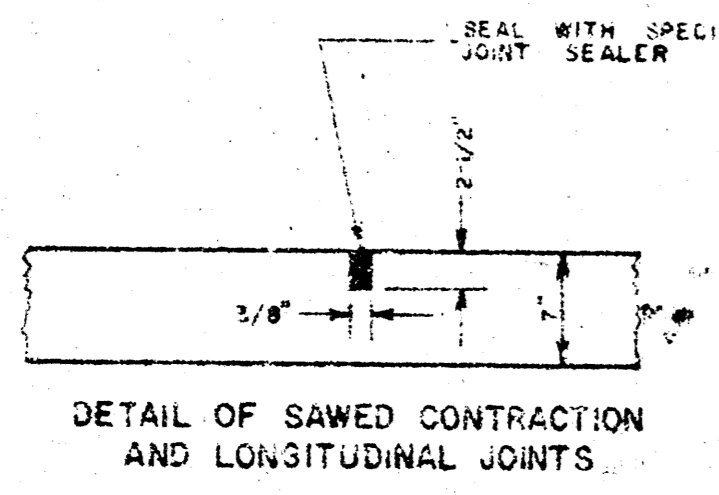

EXPANSION JOINTS ARE TO BE CONSTRUCTED AT MAXIMUM INTERVALS OF 120'-0".

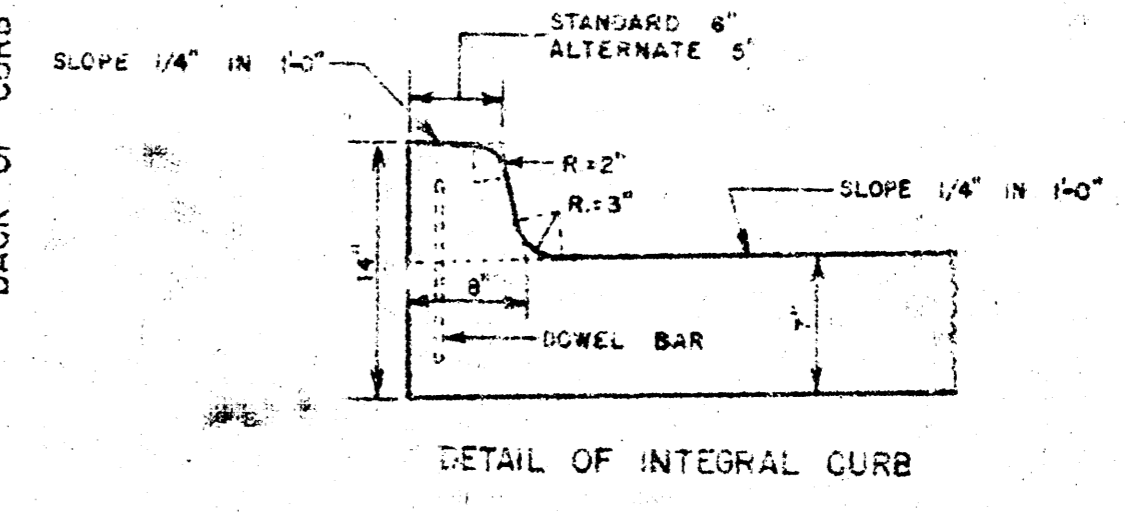
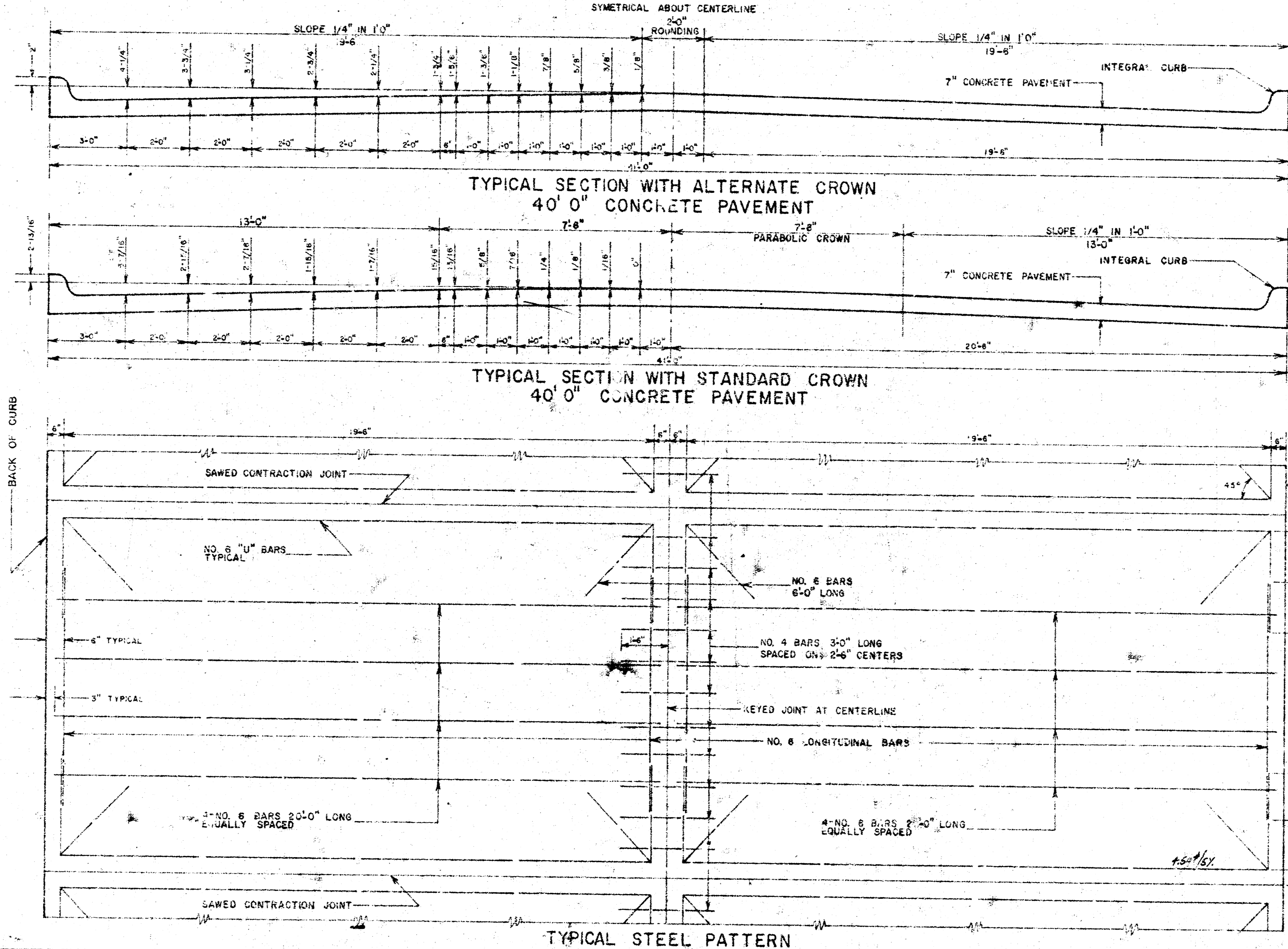
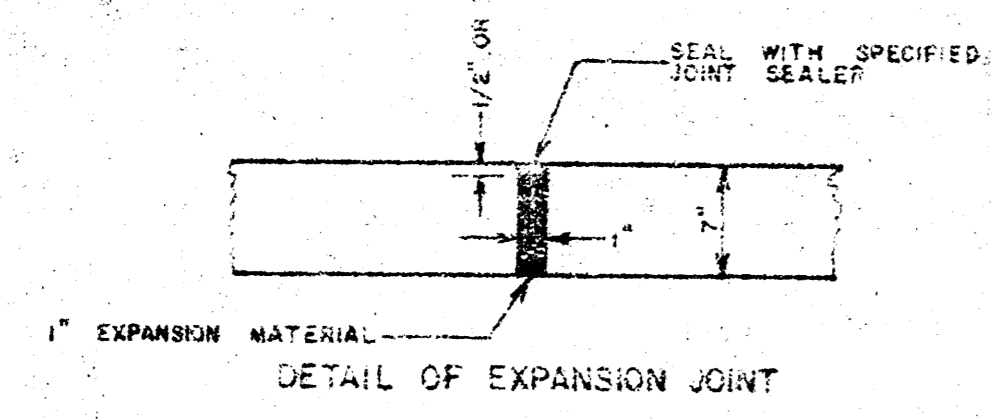

INTEGRAL CURB SHALL BE CUT THROUGH TO THE PAVEMENT IN UNIFORM LENGTHS OF NOT MORE THAN TEN FOOT INTERVALS BETWEEN EXPANSION JOINTS. EXPANSION JOINTS IN THE PAVEMENT SHALL BE CONSTRUCTED IN THE INTEGRAL CURB AT THE SPECIFIED LOCATIONS. NUMBER 4 OR NUMBER 6 BOWELS SHALL BE INSTALLED IN THE INTEGRAL CURB AS SHOWN ON APPROXIMATELY 2'-6" CENTERS. PAVEMENT GRADES SHOWN ON PLANS ARE FOR STANDARD CROWN.

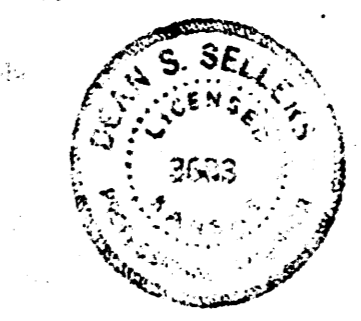

BM 105<sup>th</sup> BRIDGE SITE ON HS. TEL. POLE ON S.S. PAVEMENT 456' W of SL EDWARDS

SCALE 1" = 20'

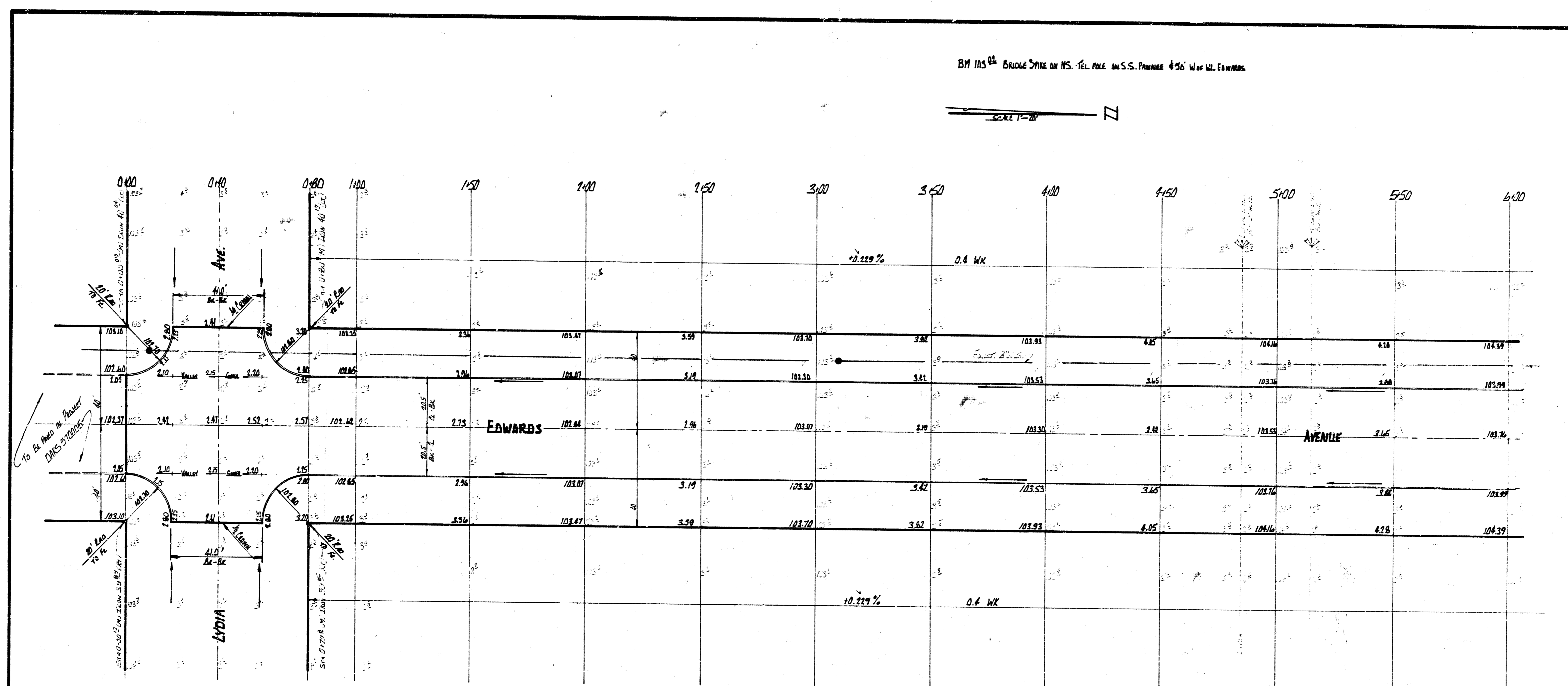

Shown, Kells  
Plan, JDL  
Loc. WDL  
Checked, JDL

To Be Made in Power  
DMS STATIONING

GENERAL NOTES:

1. TYPE OF SUBGRADE TREATMENT SHALL BE AS DETERMINED BY THE FIELD ENGINEER. SUBGRADE TREATMENT MAY CONSIST OF LIME TREATMENT, CEMENT TREATMENT, SUBGRADE REINFORCEMENT OR ANY COMBINATION OF THESE.
2. CONTRACTOR TO USE EXTREME CAUTION WHEN WORKING SUBGRADE, AT SL OF MAY AVENUE DUE TO SHALLOW PIPE FROM C.B. INLETS.

EARTHWORK QUANTITIES

EXCAVATION		LIME FILL	
PROPERTY	CU YDS	PROPERTY	CU YDS
1066.3	327.3	1053	0.0
1066.3	32.7	105	0
1172.3	360.0	115.8	0.0
		6510.0	610.0

CEMENT TREATED SUBGRADE

EDWARDS AVENUE  
SL LYDIA TO SL MAY  
7" CURB - 40' AND CURB  
R.W. LIMA CITY ENGINEER  
CITY OF WICHITA, KANSAS  
DATE: April 1973 SHEET 2 of 7  
PROJECT No. OAKS 571017

B.M. 101.01 CITY STANDARD 42.5 AND 92.5 E OF G. PRINCE AND MERIDIAN.

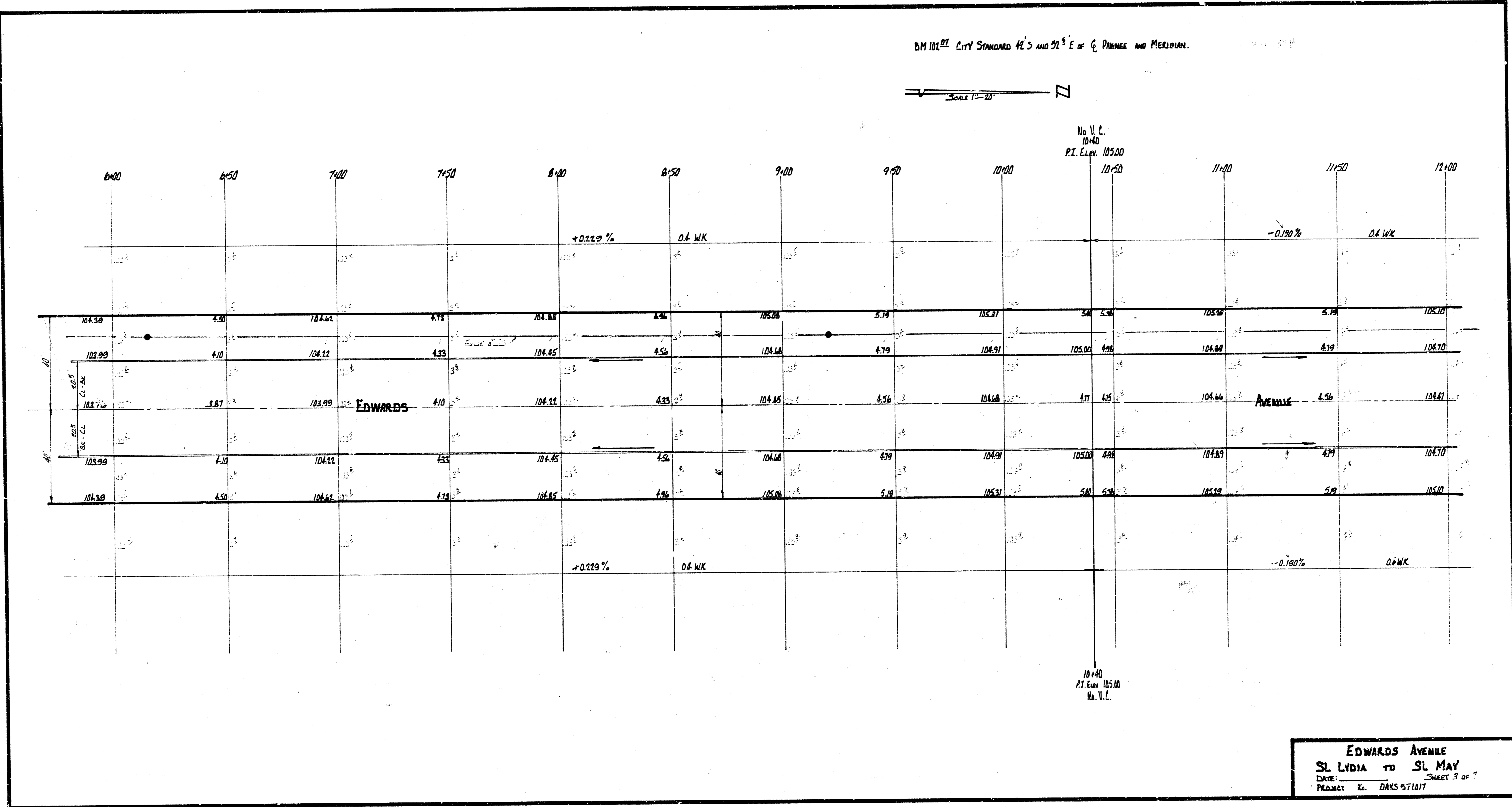
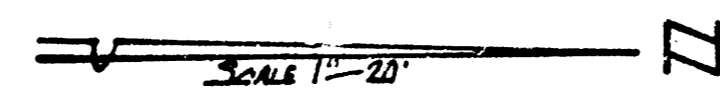

No. V. C.  
10+40  
P.I. Elev. 105.00

10+40  
P.I. Elev. 105.00  
No. V. C.

EDWARDS AVENUE  
SL LYDIA TO SL MAY  
DATE: \_\_\_\_\_  
PROJECT No. DAKS 671817

BM 105<sup>16</sup> R.R. SPIKE S-FACE H.P. S-SIDE MAY 125<sup>02</sup> E OF EDWARDS

SCALE 1"=20'

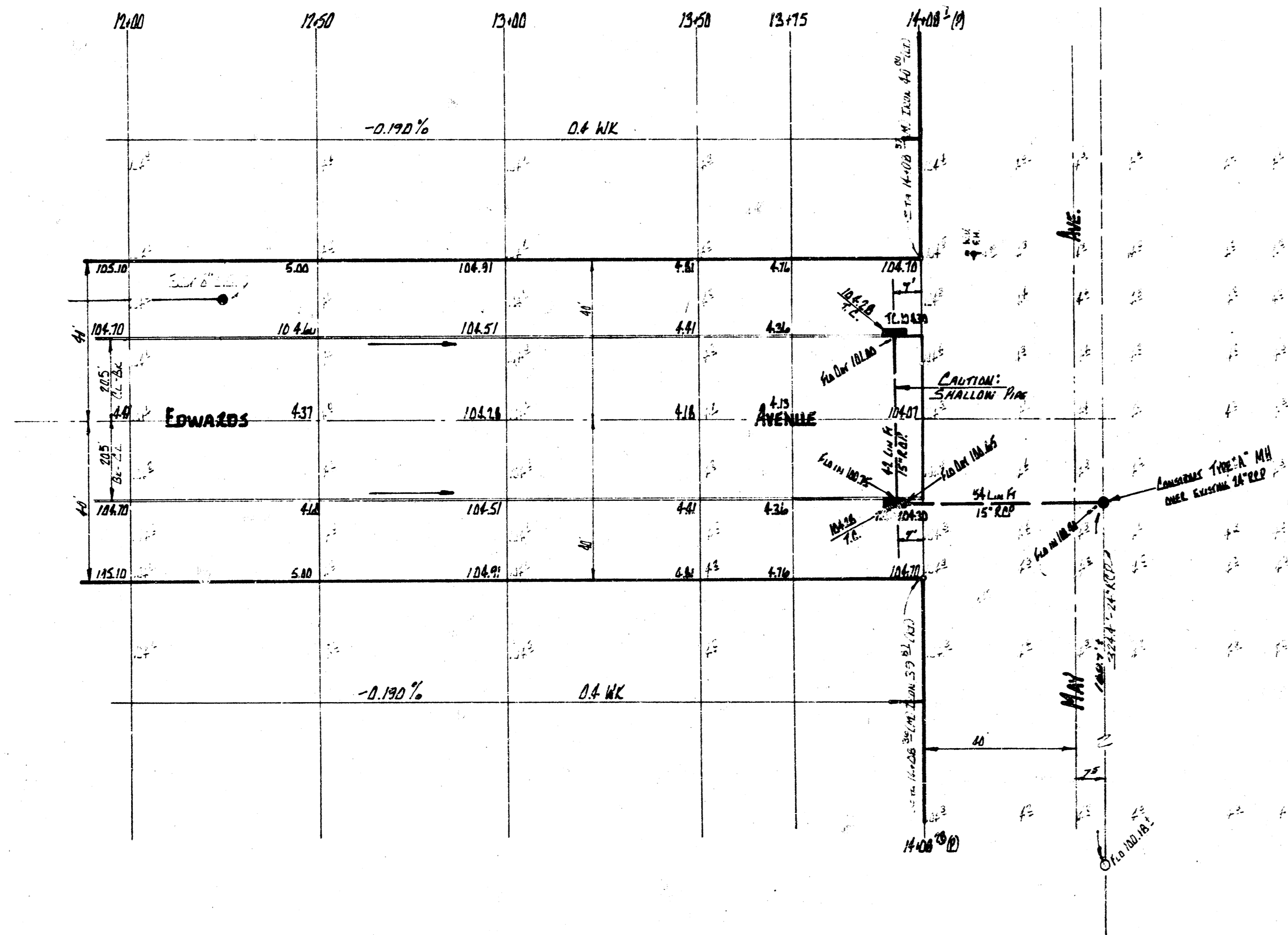

NOTE TO FIELD ENGINEER & INCIDENTAL DRAINAGE CONTRACTOR:  
 1. FIELD ENGINEER TO VERIFY P.I. OF EXISTING 12" R.P.P. AT  
 NEW MANHOLE LOCATION PRIOR TO CONSTRUCTION  
 2. P.I. OF NEW 15" R.P.P. AT MANHOLE TO MATCH  
 P.I. OF EXISTING 12" R.P.P.  
~~CONSTRUCTION SHALL BE TO EXISTING 12" R.P.P.~~  
~~CONSTRUCTION INCIDENTAL TO COST OF MANHOLE~~

EDWARDS AVENUE  
 ST. LYDIA TO ST. MAY  
 DATE: \_\_\_\_\_ SHEET 2 OF 7  
 PROJECT No. DAKS 571017