

BM 109.33 STEP ON P.P. S.E. COR. GORDON & WALKER

37A ON E  
 NOTE: WEST E of EDWARDS VARIES FROM 24.31' LT. OF E AT STA 0+00 TO 27.03' LT. OF E AT STA 6+00

NOTE TO FIELD ENGINEER: ESTABLISH TIES TO IRONS AT INTERSECTIONS OF MONROE & EDWARDS AND WALKER & EDWARDS BEFORE PAVING.

- 0-10 Fireman 337 Ft.
- 0-083 Box 3 Frame Wood Culvert 113 Lt.
- 0-425 End 3 Frame Wood Culvert 113 Lt.
- 0-19 Box 12" CMP 11.5' Lt.  
 0-66 End 12" CMP 11.5' Lt.  
 0-89 End 12" CMP 11.5' Lt.  
 0-93 End 12" CMP 11.5' Lt.
- 1-101 End Picket Fence & Box Frame 122 Lt.
- 1-21 End Fence 17.5' Lt.  
 1-27 Box 12" CMP 18' Lt.
- 1-623 Water Meter 25' Ft.
- 1-777 Box 12" CMP 18' Lt. 20' Thru 20' Lt.  
 1-819 Box 12" CMP 18' Lt.  
 1-867 & 8" Conc. Dr. 30' Ft.  
 1-882 & 18" R.C.P. 18' Lt.  
 1-882 End 18" R.C.P. 18' Lt.
- 2-101 8" Thru 18' Lt.  
 2-103 Gas Meter 18' Lt.
- 2-323 Box 12" R.C.P. 18' Ft.  
 2-339 & 12" Conc. Dr. 30' Ft.  
 2-440 End 12" R.C.P. 18' Ft.
- 2-481 Box 12" R.C.P. 18' Ft.  
 2-489 & Conc. Dr. 30' Ft.
- 3-100 End 12" R.C.P. 18' Ft.

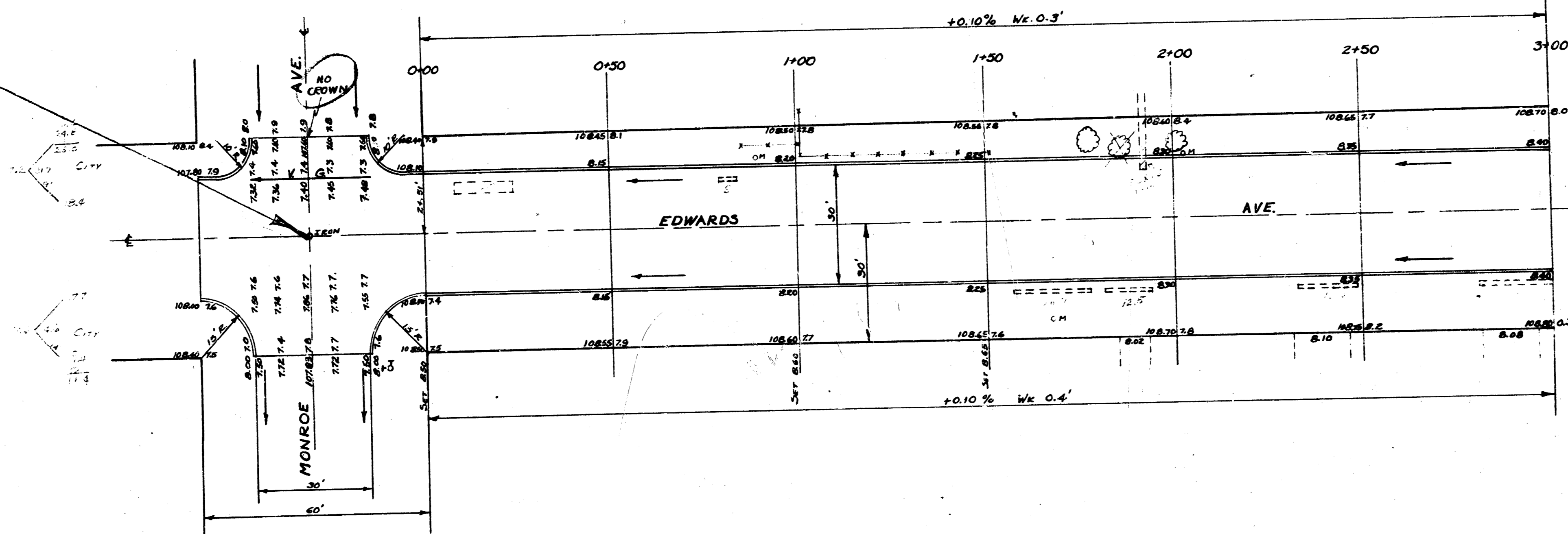

NOTE TO FIELD ENGINEER & CONTRACTOR: ALL ENTRANCE PIPES & CULVERTS ARE TO BE REMOVED AS PER DIRT CHECKERS INSTRUCTIONS.

Excavation

Prop	Fill	Cut	Fill
4.07	22.7	33.2	3.1
4.51	23.3	33.3	3.4
4.28	22.0	32.5	

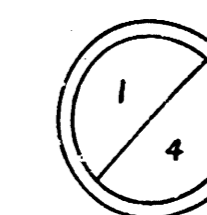
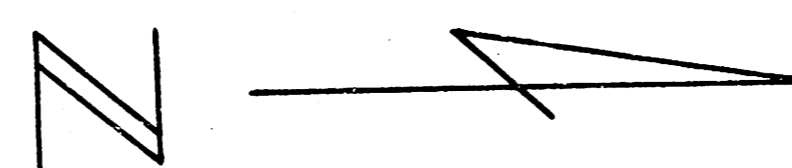

**EDWARDS AVE.**  
 SL. MONROE TO NL. WALKER  
 30' CONC. & C.B.  
 CITY OF WICHITA KANSAS  
 B.E. SMITH CITY ENGINEER  
 OCT. 1953 PROJ. No. C-13-178

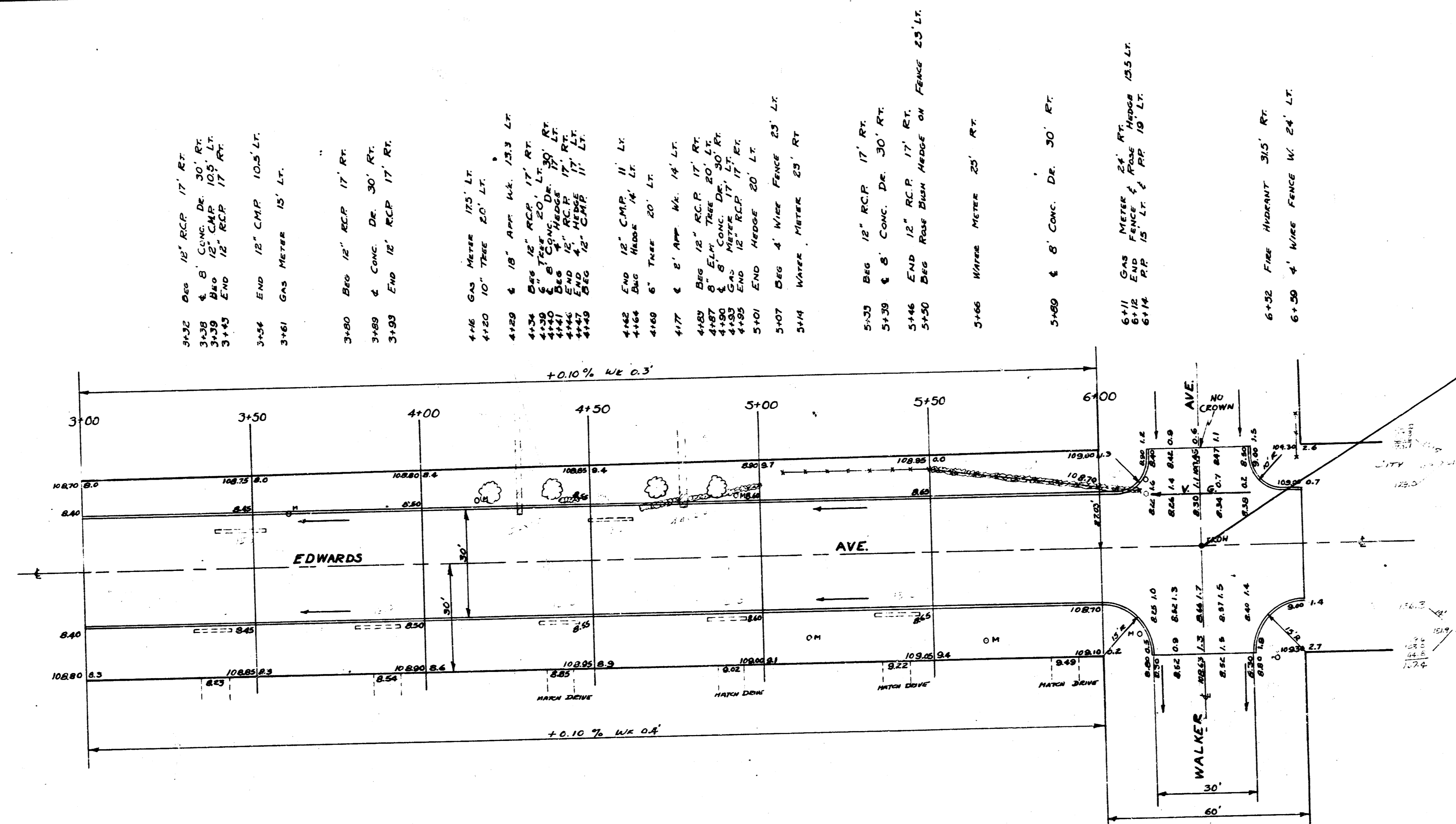

- 3+02 12" RCP 17' RT
- 3+03 12" RCP 17' RT
- 3+04 12" RCP 17' RT
- 3+05 12" RCP 17' RT
- 3+06 12" RCP 17' RT
- 3+07 12" RCP 17' RT
- 3+08 12" RCP 17' RT
- 3+09 12" RCP 17' RT
- 3+10 12" RCP 17' RT
- 3+11 12" RCP 17' RT
- 3+12 12" RCP 17' RT
- 3+13 12" RCP 17' RT
- 3+14 12" RCP 17' RT
- 3+15 12" RCP 17' RT
- 3+16 12" RCP 17' RT
- 3+17 12" RCP 17' RT
- 3+18 12" RCP 17' RT
- 3+19 12" RCP 17' RT
- 3+20 12" RCP 17' RT
- 3+21 12" RCP 17' RT
- 3+22 12" RCP 17' RT
- 3+23 12" RCP 17' RT
- 3+24 12" RCP 17' RT
- 3+25 12" RCP 17' RT
- 3+26 12" RCP 17' RT
- 3+27 12" RCP 17' RT
- 3+28 12" RCP 17' RT
- 3+29 12" RCP 17' RT
- 3+30 12" RCP 17' RT
- 3+31 12" RCP 17' RT
- 3+32 12" RCP 17' RT
- 3+33 12" RCP 17' RT
- 3+34 12" RCP 17' RT
- 3+35 12" RCP 17' RT
- 3+36 12" RCP 17' RT
- 3+37 12" RCP 17' RT
- 3+38 12" RCP 17' RT
- 3+39 12" RCP 17' RT
- 3+40 12" RCP 17' RT
- 3+41 12" RCP 17' RT
- 3+42 12" RCP 17' RT
- 3+43 12" RCP 17' RT
- 3+44 12" RCP 17' RT
- 3+45 12" RCP 17' RT
- 3+46 12" RCP 17' RT
- 3+47 12" RCP 17' RT
- 3+48 12" RCP 17' RT
- 3+49 12" RCP 17' RT
- 3+50 12" RCP 17' RT
- 3+51 12" RCP 17' RT
- 3+52 12" RCP 17' RT
- 3+53 12" RCP 17' RT
- 3+54 12" RCP 17' RT
- 3+55 12" RCP 17' RT
- 3+56 12" RCP 17' RT
- 3+57 12" RCP 17' RT
- 3+58 12" RCP 17' RT
- 3+59 12" RCP 17' RT
- 3+60 12" RCP 17' RT

NOTE  
FIELD ENGINEER: ESTABLISH TIES TO IRON  
AT INTERSECTION OF WALKER & EDWARDS.

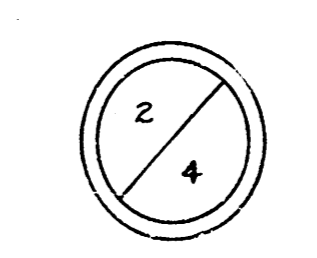

EDWARDS AVE.

Proj. No. C-13-178