

ELIZABETH AVENUE

**S. L. LOT 7, BLOCK E, TO N. L. LOT 4, BLOCK E,
VILM GARDENS SECOND ADDITION
472 76 245 80396 000 000 001**

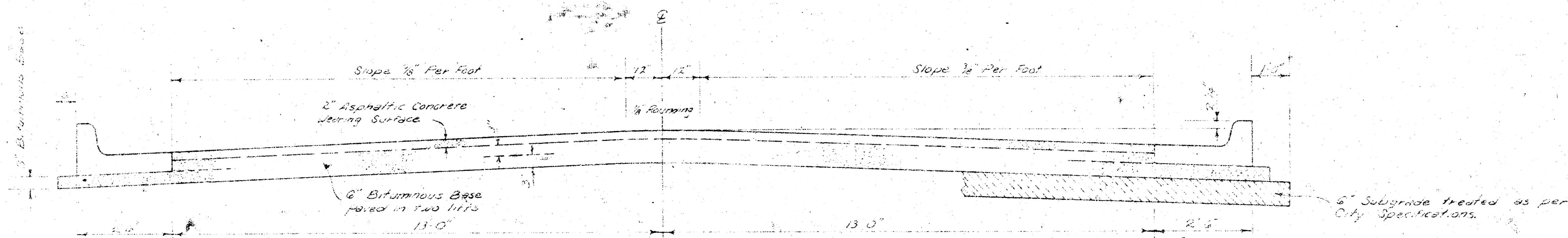

COMBINED CURB & GUTTER

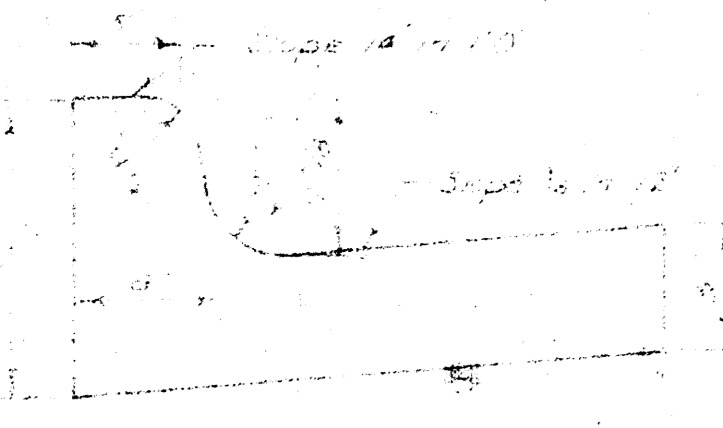

COMBINED CURB & GUTTER

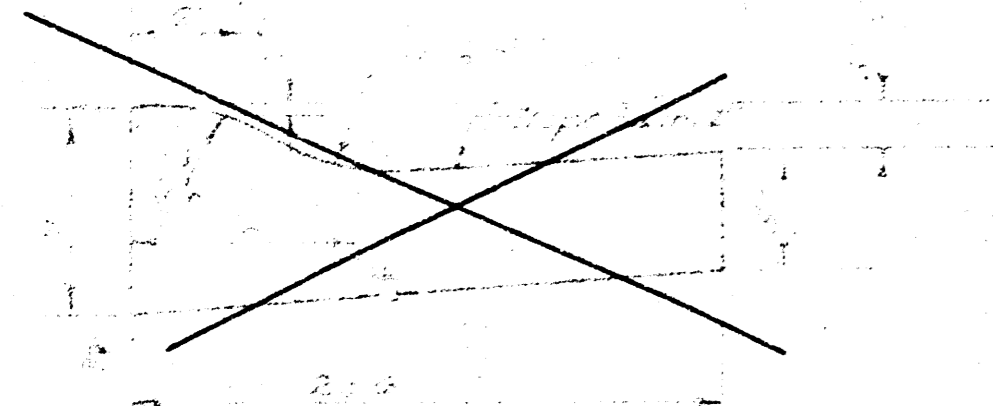

TYPICAL SECTION

31 ASPHALTIC CONCRETE PAVEMENT WITH BITUMINOUS BASE

The A.C. pavement between the Comb. Curb & Gutter shall be paid as 34 lbs. 3" A.C. Pavement (6 Bituminous Base). The Bituminous Base under the Comb. Curb & Gutter shall be paid as 34 lbs. 3" Bituminous Base.

A TACK COAT OF EMULSIFIED ASPHALT (SS-1H) SHALL BE APPLIED AT AN APPROXIMATE RATE OF 0.05 GALLONS PER SQ. YD. BETWEEN LIFTS OF ASPHALTIC MATERIALS WHEN ORDERED BY THE ENGINEER. TACK COAT WILL NOT BE PAID FOR DIRECTLY AND SHALL BE CONSIDERED AS SUBSIDIARY TO PRICE BID FOR ASPHALTIC PAVEMENT. BITUMINOUS BASE AND ASPHALTIC CONCRETE WEARING SURFACE SHALL BE PLACED WITH A LAYDOWN MACHINE HAVING AUTOMATIC CONTROLS FOR CROWN AND GRADE. CONSTRUCTION JOINTS IN EACH LIFT SHALL BE STAGGERED A MINIMUM DISTANCE OF 1' WITH JOINTS IN PRECEDING LIFTS AND SUCH THAT A JOINT WILL BE CONSTRUCTED ON THE PAVEMENT CENTERLINE IN THE TOP LIFT.

DETAIL OF TRANSVERSE CONSTRUCTION JOINTS

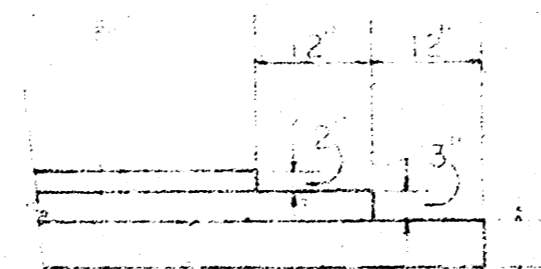

TRANSVERSE CONSTRUCTION JOINTS SHALL BE CONSTRUCTED IN FLEXIBLE BASE PAVEMENTS AT LOCATIONS WHERE PAVEMENT TEMPORARILY ENDS TO FACILITATE FUTURE PAVEMENT CONSTRUCTION AS SHOWN BY DETAIL. THE COST OF CONSTRUCTING THE TRANSVERSE CONSTRUCTION JOINTS SHALL NOT BE MEASURED OR PAID FOR DIRECTLY BUT SHALL BE INCLUDED IN THE BID PRICE FOR SQUARE YARDS OF ASPHALTIC CONCRETE PAVEMENT.



CITY OF WICHITA, KANSAS

DEPARTMENT OF PUBLIC WORKS — ENGINEERING

DEAN SELLERS Acting CITY ENGINEER

DATE _____ PROJ. NO. **DAKS 576035** (1/2)

B.M. 88.96 RR Spike in East side of tree on N.L. of 43rd Street South Extended West.
 B.M. 87.85 RR Spike on South side of power pole on Southwest corner of Elizabeth and 44th Street South.
 @ is @ of Elizabeth.

Scale: 1" = 20'

Note:
 Trees to be removed are marked with X, except that any tree which in the opinion of the Engineer can be saved, shall be spared.
 Contractor to take ties & replace any trees, either moved or destroyed during construction.

No More Than 1-20' Drive Or The Equivalent To Be Constructed.

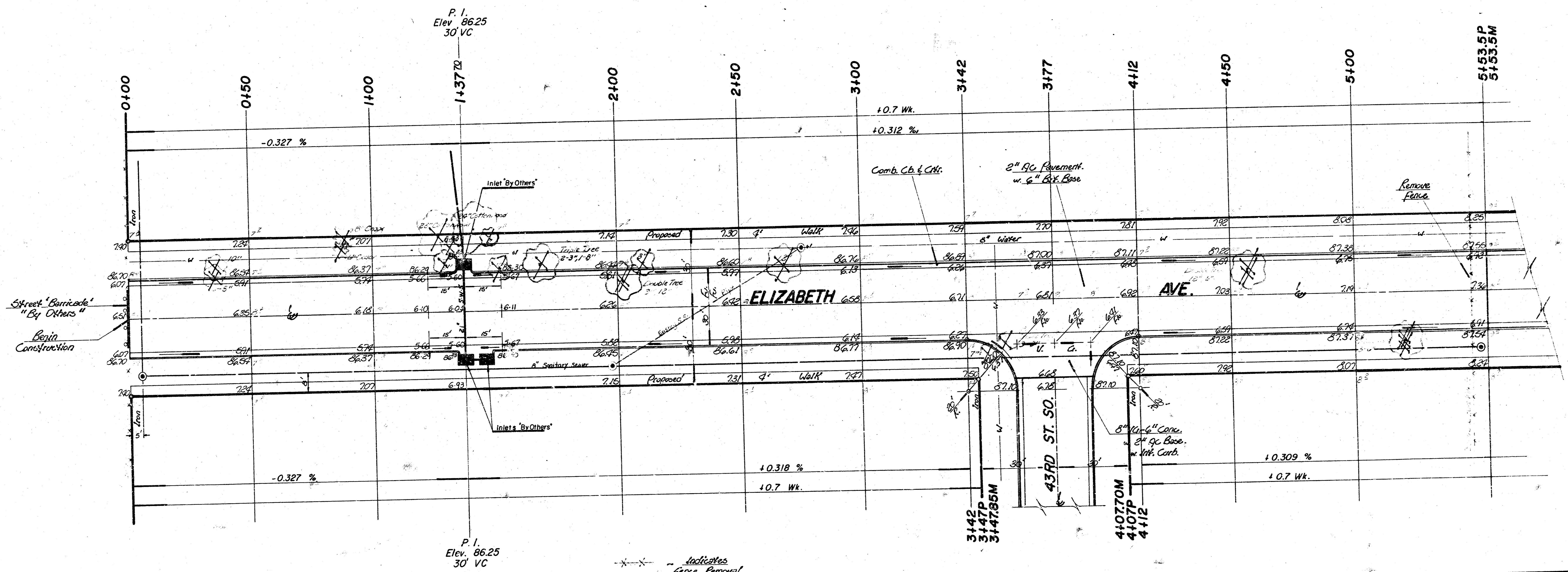

Survey
 Plan
 Exc.
 Checked

NOTE TO FIELD ENGINEER & CONTRACTOR
 Grade parking and clear right-of-way for proposed sidewalk. Compact fill in sidewalk areas. TO BE CONSTRUCTED BY "OTHERS".

SUB-GRADE
 TYPE OF SUB-GRADE TREATMENT SHALL BE DETERMINED BY THE FIELD ENGINEER. SUB-GRADE TREATMENT MAY CONSIST OF LIME TREATMENT, CEMENT TREATMENT, SUB-GRADE MODIFICATION, OR ANY COMBINATION OF THESE.

---X--- Indicates Fence Removal.

Note-Excess Earthwork from construction of Proj. No. DAKS 576035 is to be used for construction of Proj. No. DAKS 576036

Property		City	
Excavation = 2024.3 cy	Comp. Fill = 0	Excavation = 130.8 cy	Comp. Fill = 0
+ 10% = 202.5		+ 10% = 13.1	
Total = 2227.3		Total = 143.9	
Manipulation = 1919.6 cy		Manipulation = 175.6 cy	

ELIZABETH AVENUE
 S.L. Lot 7, Block E, to N.L. Lot 4, Block E,
 Viim Gardens Second Addition
 (26-2-30 Asphaltic Concrete Pav't.)
CITY OF WICHITA, KANSAS
 472 76 245 80396 000 000 001
 DEAN SELLERS CITY ENGINEER
 PROJECT NUMBER: DAKS 576 2/2
 DATE:

2/3