

BM 114.87 SE CORNER CONC. PORCH NO. 401 S.W. CORNER UNIVERSITY & ALL HALLOWS
 BM 114.53 RR SPIKE IN TELEPHONE POLE S.W. CORNER MAPLE & ALL HALLOWS
 BM 113.82 "G" IN GLOBE & WALK E AT NE CORNER SHERIDAN & MAPLE

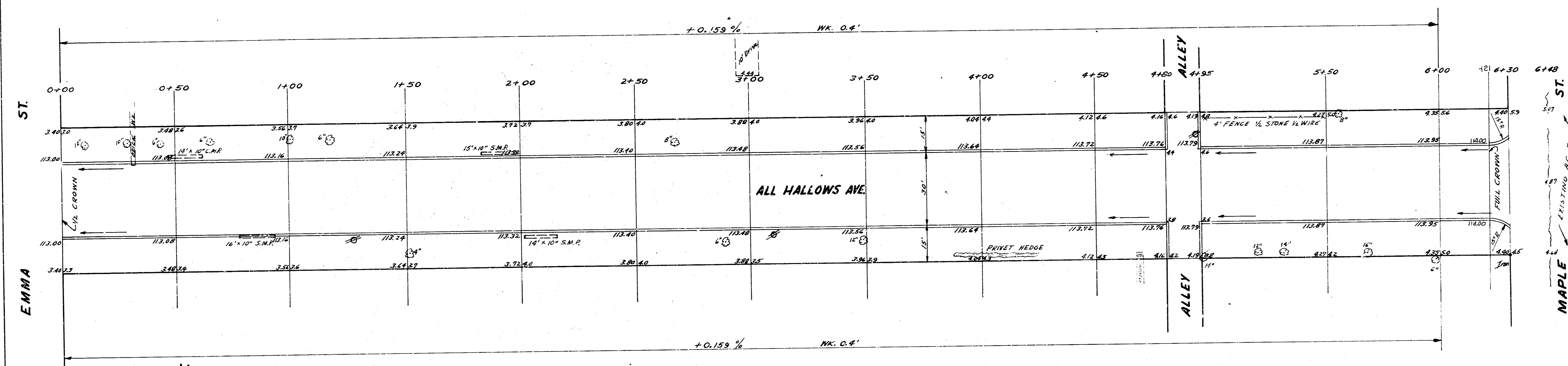

Survey by RIGGS & SEAMAN
 Plan
 Law
 Licensed

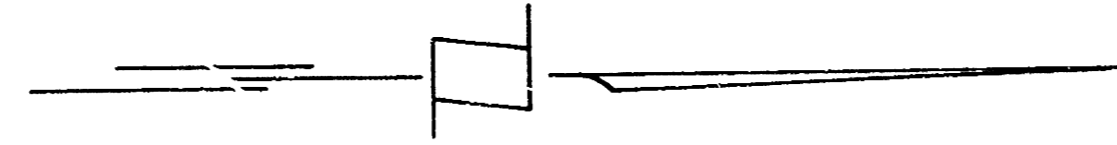
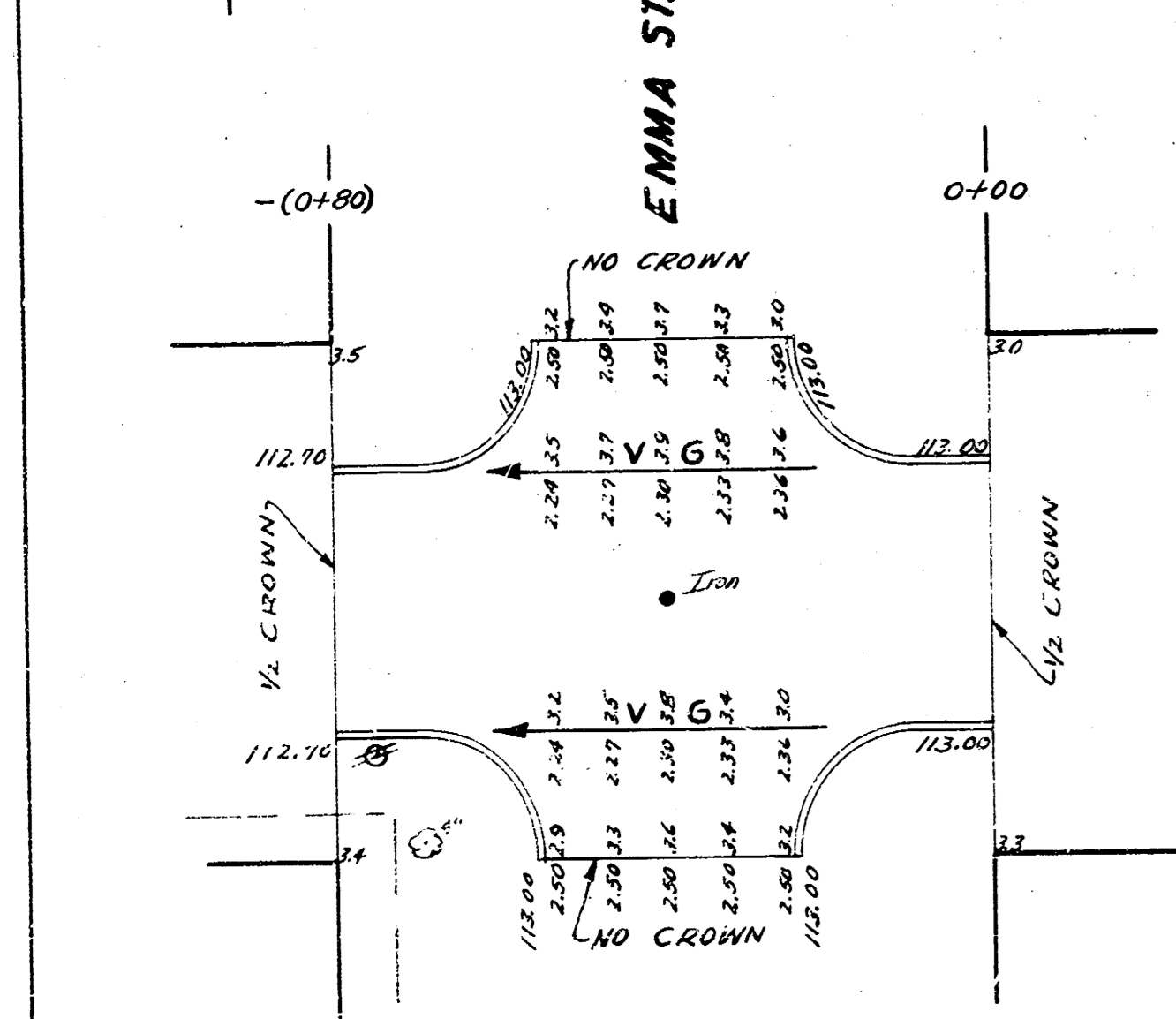

112.80
 112.70
 112.60
 112.50
 112.40
 112.30
 112.20
 112.10
 112.00

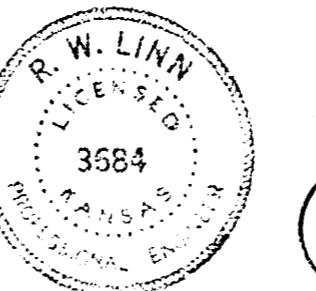

1/2

ALL HALLOWS AVE.
 S.W. MAPLE ST. - TO - S.W. EMMA ST.
 30' CONC. & C.B.
 CITY OF WICHITA KAN.
 BE SMITH CITY ENGINEER
 JULY 1958 PROJ. NO. C16-162