

**AMIDON AVENUE**

**44'-2"-48' A.C.**

N.L. TWENTY-FIRST TO N.L. TWENTY-FIFTH  
C 11-15

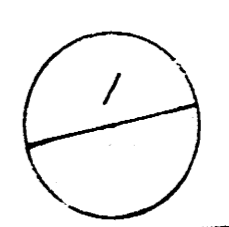
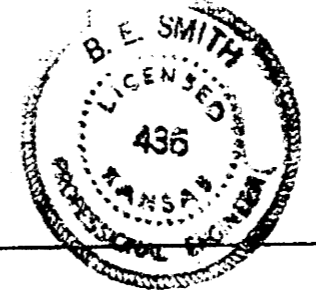
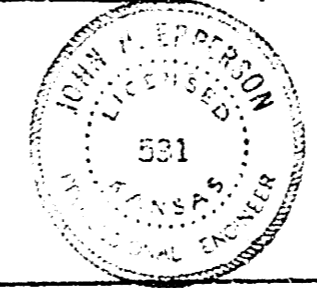
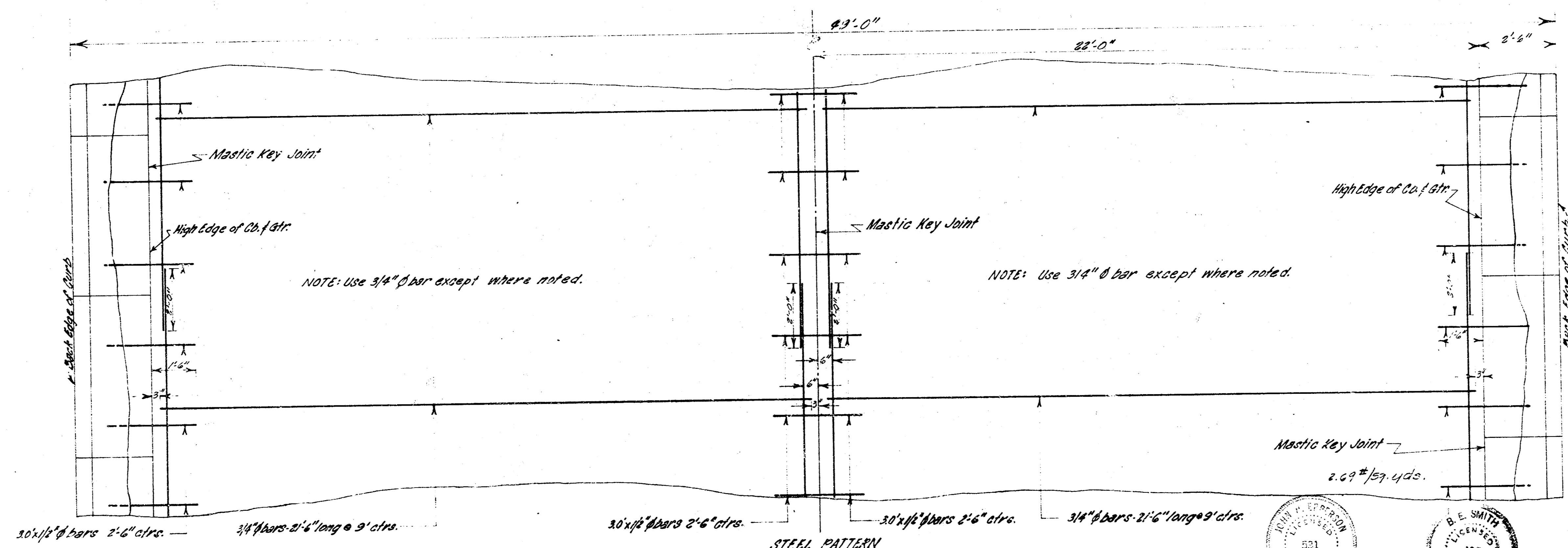
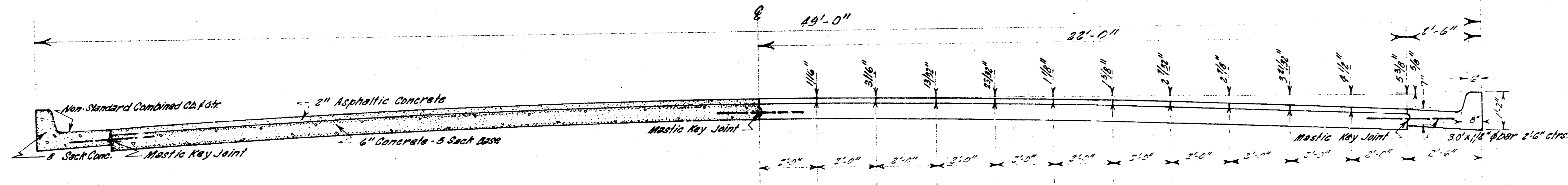

S.M. 128.155 'X'-cut on NE. cor. curb base to flood light, NW cor. Amidon & 21st

**NOTE:**  
Use caution when working near  
48" water main!

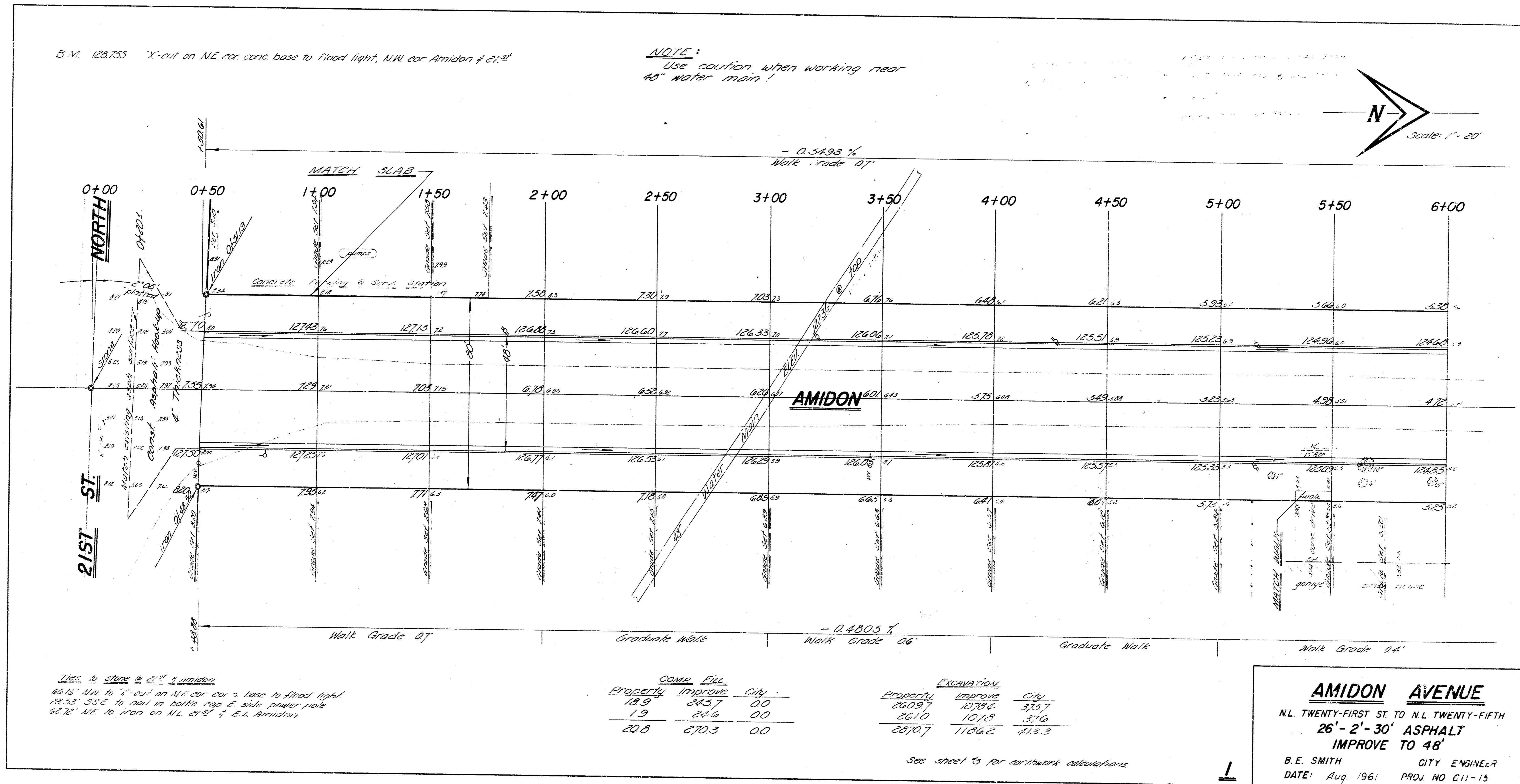
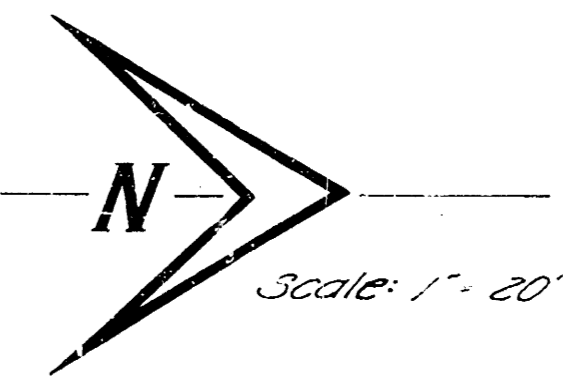

WALK  
 SIDE  
 WALK  
 SIDE  
 WALK

Ties to street & 21st & Amidon  
 66.15' NW to 'X'-cut on NE. cor. curb base to flood light  
 28.33' SSE to rail in 20th. opp. E. side power pole  
 62.72' NE to iron on N.E. 21st & E.L. Amidon

Comp. Fill		
Property	Improve	City
18.9	245.7	0.0
1.9	21.6	0.0
20.8	270.3	0.0

Excavation		
Property	Improve	City
2609.7	1078.2	375.7
2610	1078	376
2870.7	1186.2	413.3

See sheet 5 for cutwork elevations

**AMIDON AVENUE**

N.L. TWENTY-FIRST ST. TO N.L. TWENTY-FIFTH  
**26'- 2'- 30' ASPHALT**  
**IMPROVE TO 48'**

B. E. SMITH CITY ENGINEER  
 DATE: Aug. 1961 PROJ. NO C11-15

3.11 21.35' SW cor. top stone slab to brick monument, Riverlawn Admn., S.E. cor. Amidon & 23rd  
 3.11 27.04' "W" in Mueller, top fire hydrant on W side Amidon @ 1016.9

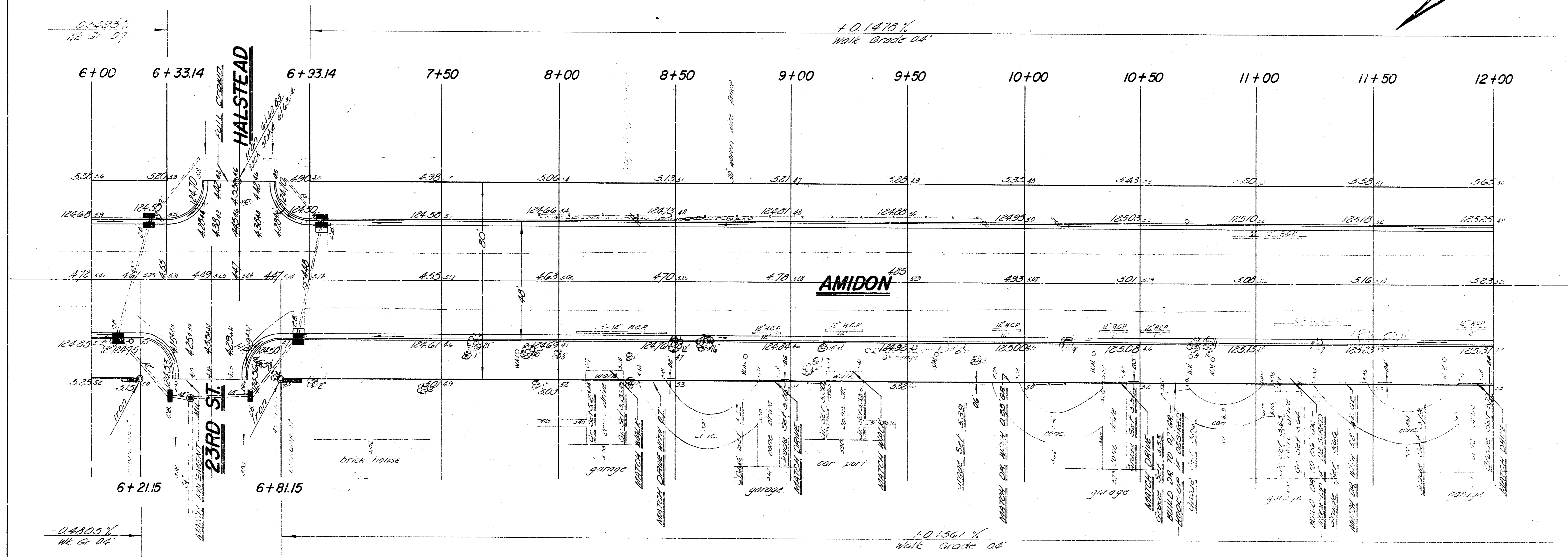
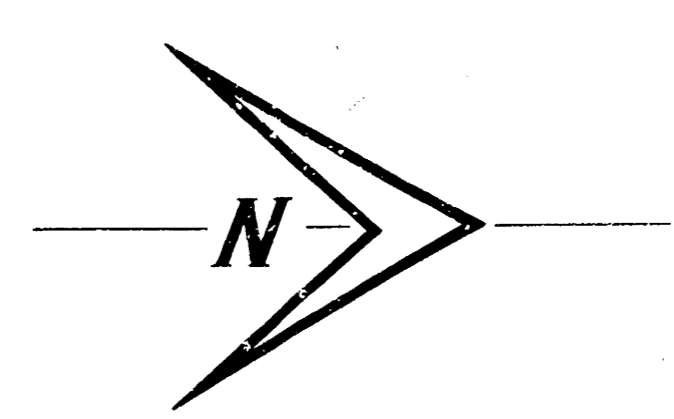

Drainage by Others  
 Remove four existing catch basins & replace as shown on plan. Use existing pipes.

**AMIDON AVENUE**  
 C 11-15

B.M. 125.764 "R" in Ritchie, top curb Marigold @ W.L. Amidon.

NOTE:  
Do Not use extra steel  
reinforcing over 8" R.C.P. sewer.

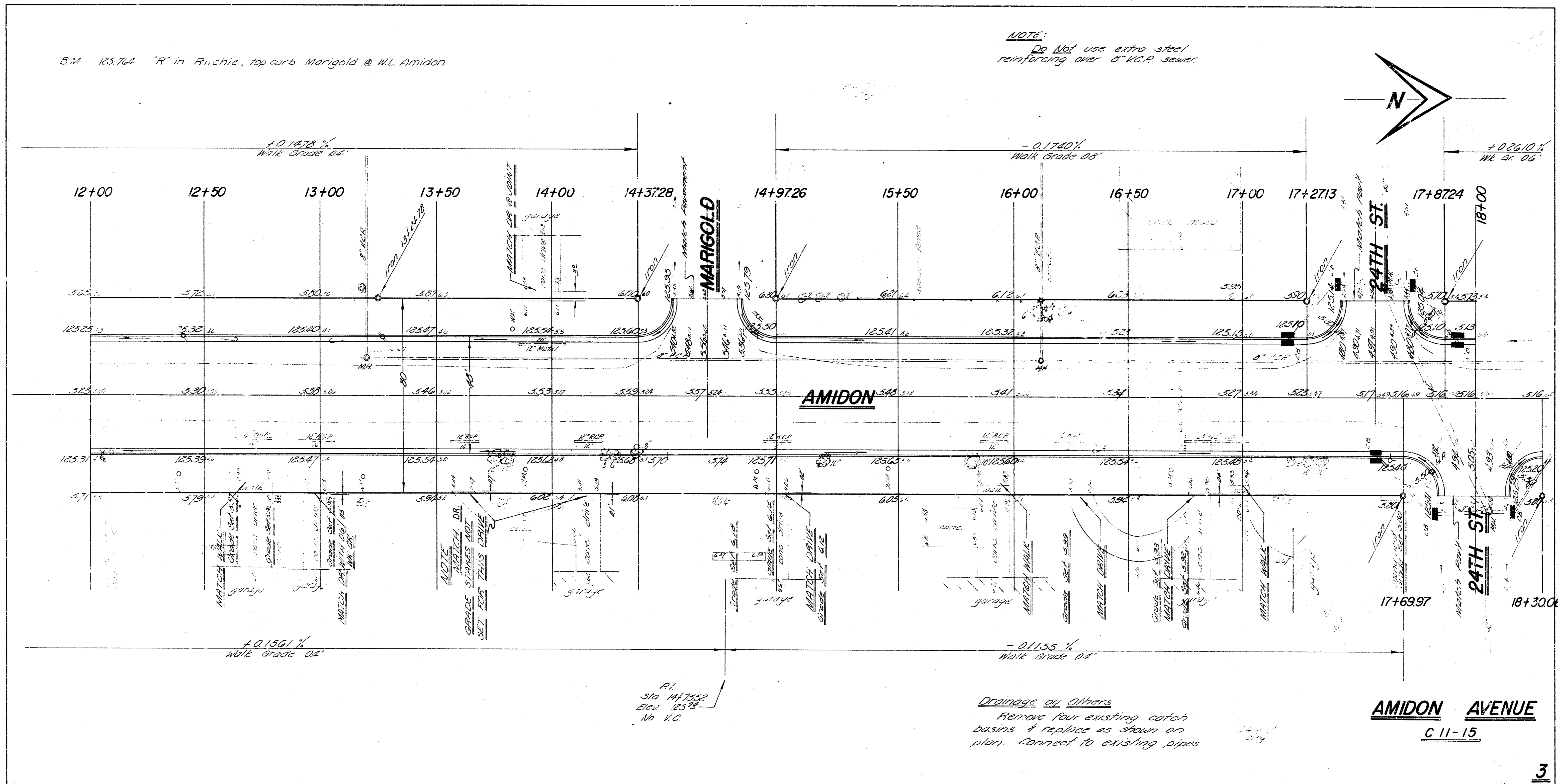

B.M. 125.750 "R" in Ritchie, Top curb Columbine @ N.L. Amidon.

Note:  
DO NOT use extra steel  
reinforcing over 8" R.C.R.

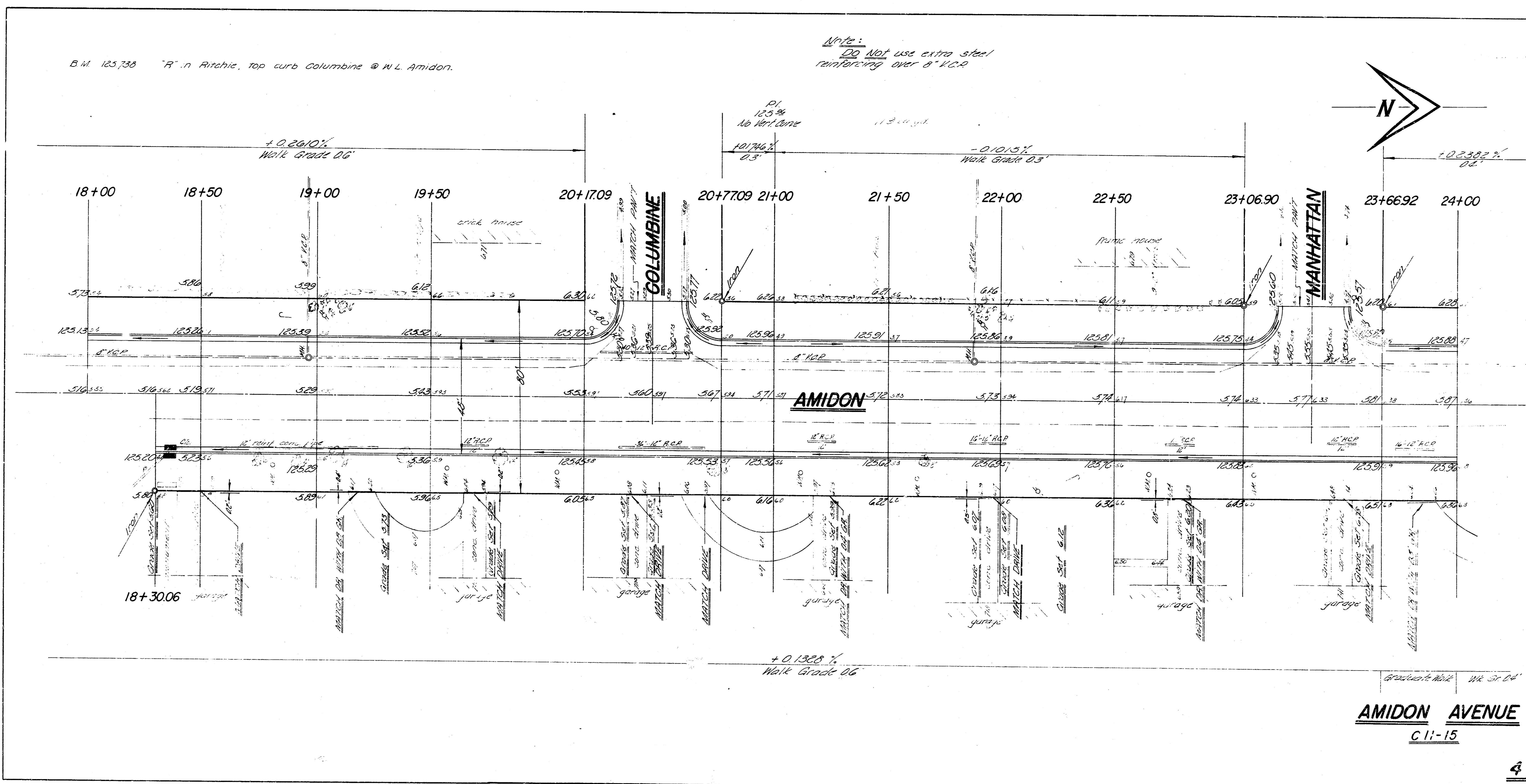
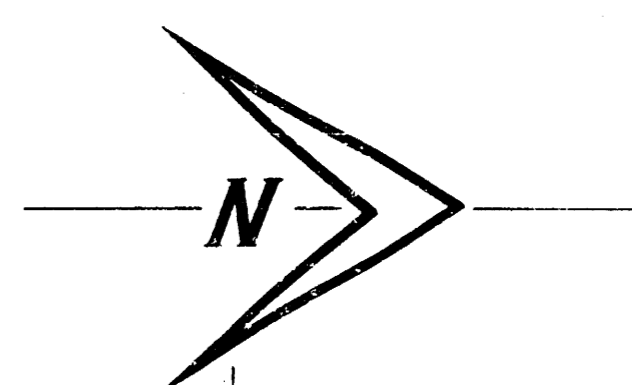

**AMIDON AVENUE**  
C 11-15

B.M. 126.34 City Standard - 6' W. of W.L. Amidon & 2' N. of N. 26 of paving on S 1/2 25th St West

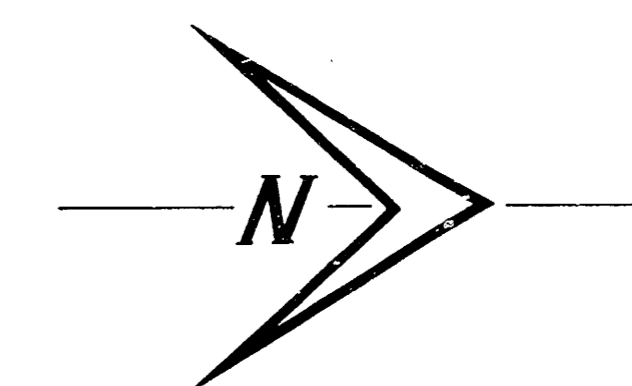

Actual excavation calculated  
 Property 279.70    Improve 85.44    City 42.4

allowing 1" of prep & city excavation to be charged to improvement -  
 property area = 6748 sq.yd @ 1" = 187.5 cu.yd  
 city area = 1320 sq.yd @ 1" = 36.7 cu.yd

New Totals  
 Property 260.97    Improve 107.4    City 37.7

Note:  
 Final estimator shall subtract volume of asphalt mat from these totals.

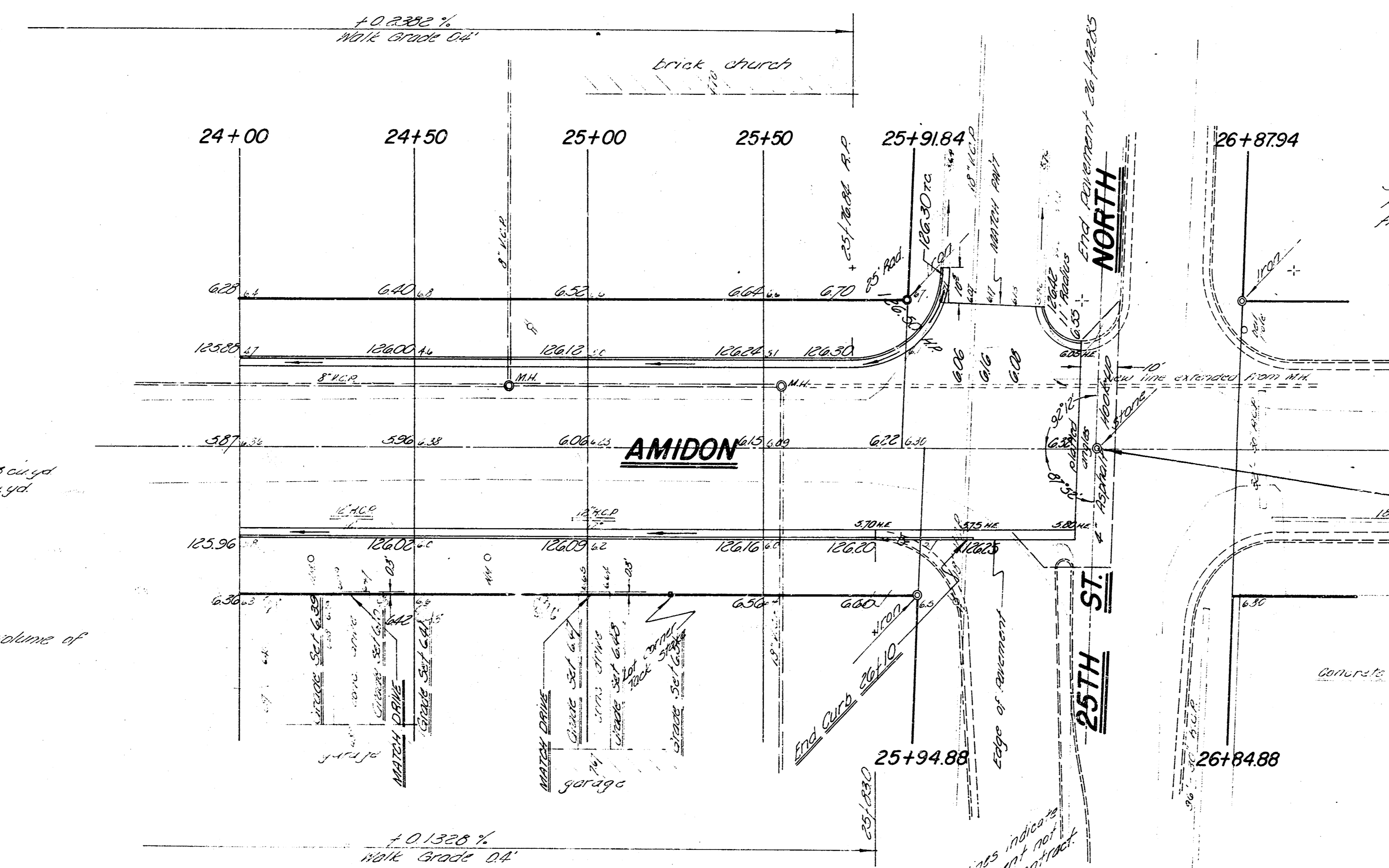

Note:  
 Existing asphalt mat shall be removed separately & paid as sq yds asphalt mat removed. Volume of asphalt shall be subtracted from final earthwork total by final estimator.

Ties to Stone @ 25th St W  
 43.72 N.W. to ctr. of disc on 3rd City B.M.  
 59.64 S.E. to nail in bottle cap NE side power pole  
 38.35 S.W. to nail in bottle cap NW side bell pole

NOTE:  
 Use stone @ 25th St. Do not use iron at same location.

NOTE:  
 Dashed lines indicate proposed pavement not included on this contract.

**AMIDON AVENUE**  
 C11-15