

SECTION A-A

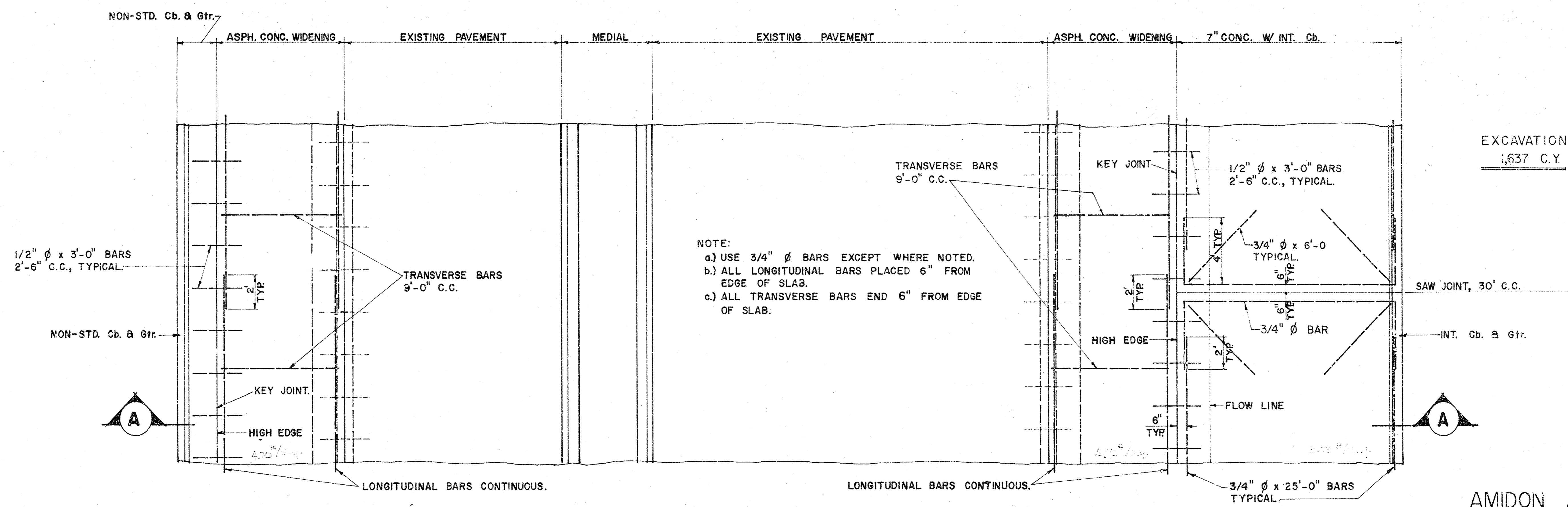

STEEL PATTERN

AMIDON AVENUE, WIDENING
 BRIDGE to 620' SOUTH of \mathcal{C} of 21st. ST.
 PROJECT NO. C18-61
 ASPH. CONC.-WIDEN PVT, MEDIANS, LEFT TURN BAYS
 & DECELERATION LANES.
 CITY of WICHITA, KANSAS
 B. E. SMITH, CITY ENGINEER.



GLANTZ SCHMITT db.

B.M. 127.93 CITY STD. DISK ON N.W. COR. RIVER BRIDGE ON AMIDON SOUTH OF 21ST ST.
 B.M. 123.51 1/2" Ø BOLT IN ASPH.-CONC. PVT. ON E. AMIDON APPROX. 520' N. OF
 CTR. BRIDGE STA. 5+50
 B.M. 123.76 "X" CUT E. END N. RAD. TO ENTRANCE @ CTR. OF TWIN LAKES SHOPPING CTR. ON AMIDON.

LEFT BASE LINE : 28' LT. OR WEST OF C.
 RIGHT BASE LINE : 28' RT. OR EAST OF C.

NOTE:
 GRADE TO EXISTING @ PROPERTY LINE.

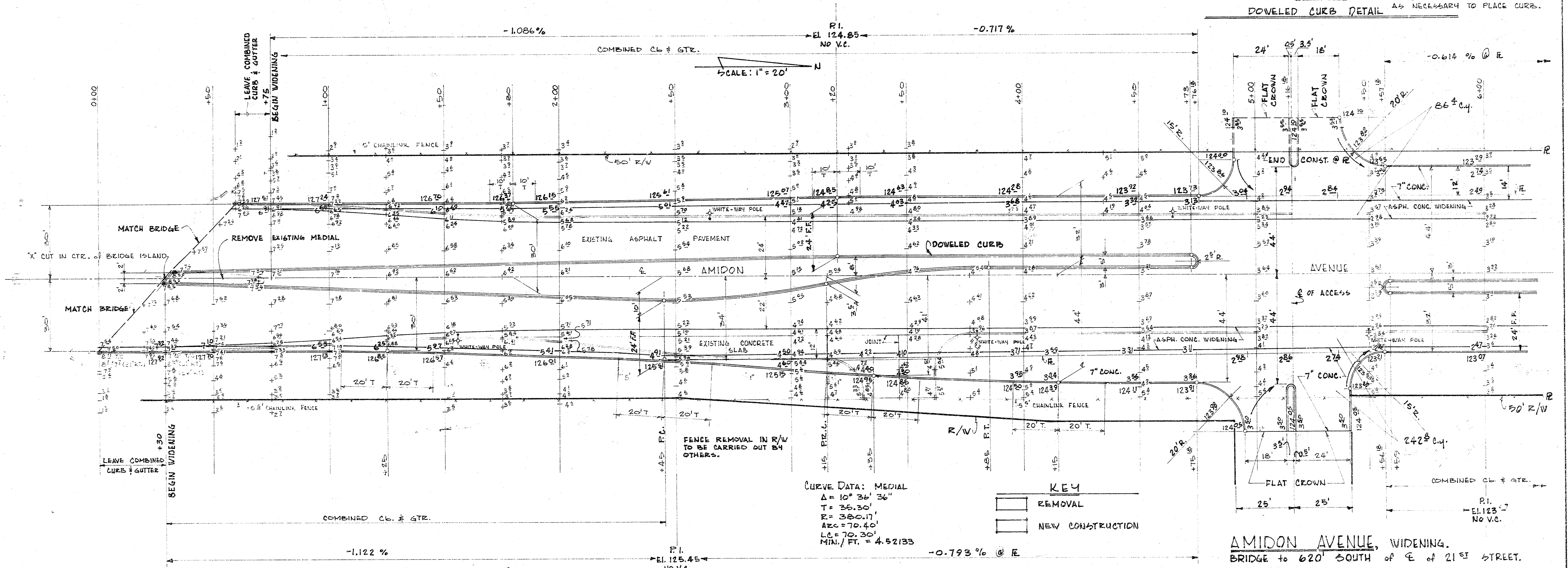
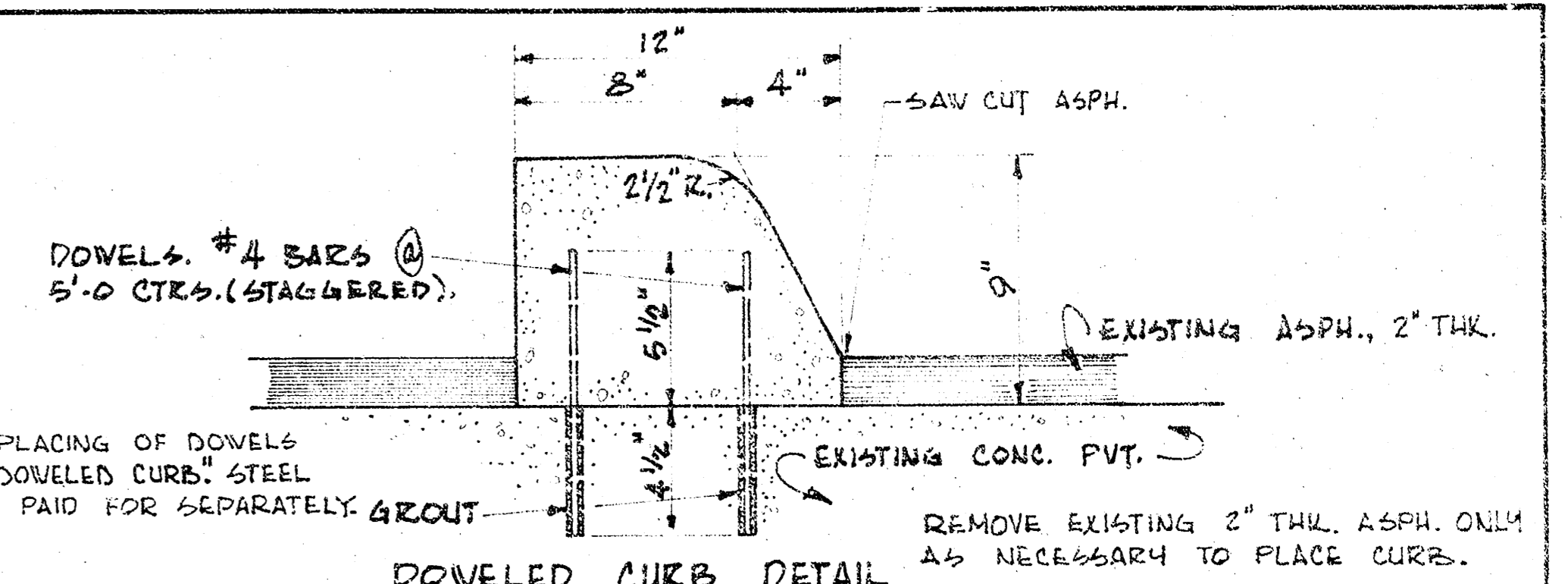
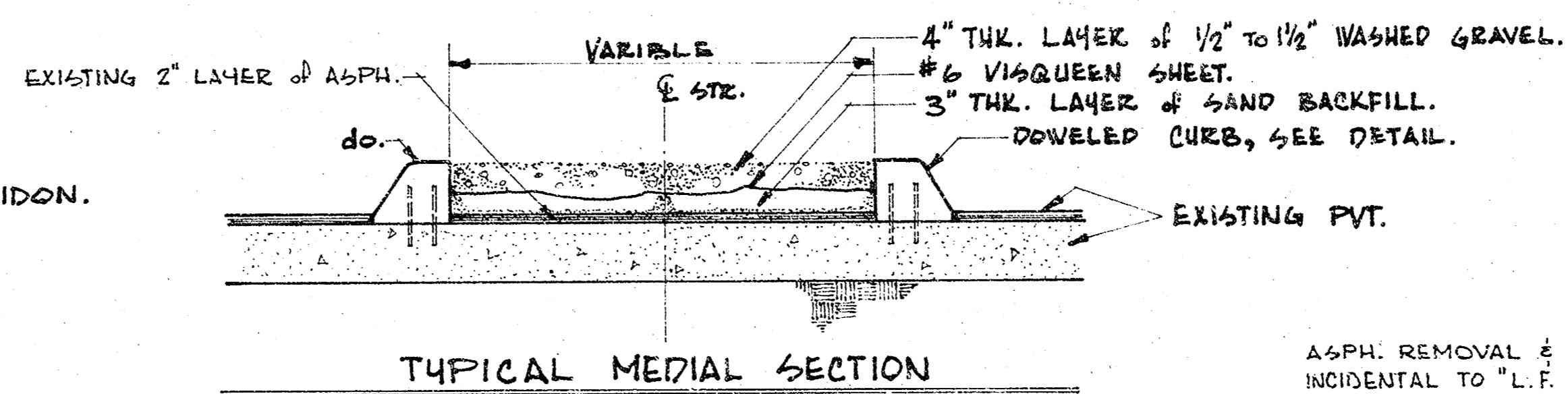

CURVE DATA: MEDIAL
 $\Delta = 10^\circ 36' 36''$
 $T = 35.30'$
 $R = 380.17'$
 $ARC = 70.40'$
 $LC = 70.30'$
 $MIN./FT. = 4.52133$

KEY
 [Hatched Box] REMOVAL
 [White Box] NEW CONSTRUCTION

STA.	ARC	CHORD	DEFLECTION	ACCU. DEFLECT.	STA.	ARC	CHORD	DEFLECTION	ACCU. DEFLECT.
2+45	-	-	-	-	3+15	-	-	-	-
2+50	5.00	5.00	0° 22' 36"	0° 22' 36"	3+25	10.15	10.14	0° 45' 53"	0° 45' 53"
2+75	25.03	23.02	1° 53' 10"	2° 15' 46"	3+50	25.20	25.20	1° 53' 51"	2° 39' 50"
3+00	25.17	25.17	1° 53' 47"	4° 09' 33"	3+75	25.05	25.05	1° 53' 00"	4° 33' 06"
3+15	15.20	15.20	1° 06' 45"	5° 16' 18"	3+85	10.00	10.00	0° 45' 12"	5° 16' 18"

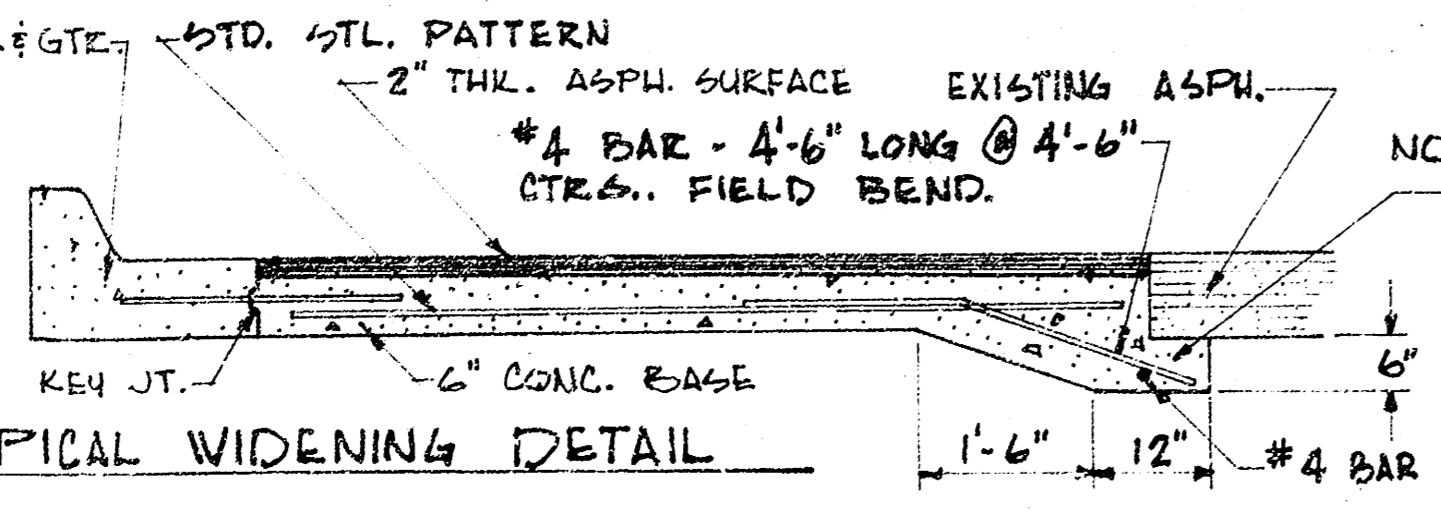

AMIDON AVENUE, WIDENING.
 BRIDGE TO 620' SOUTH OF E. OF 21ST STREET.
 PROJECT NO. C18-61
 ASPH. CONC. - WIDEN PVT., MEDIANS, LEFT TURN BAYS, DECELERATION LANES
 CITY OF WICHITA, KANSAS.
 B.E. SMITH, CITY ENGINEER.

SCALE: 1" = 20'

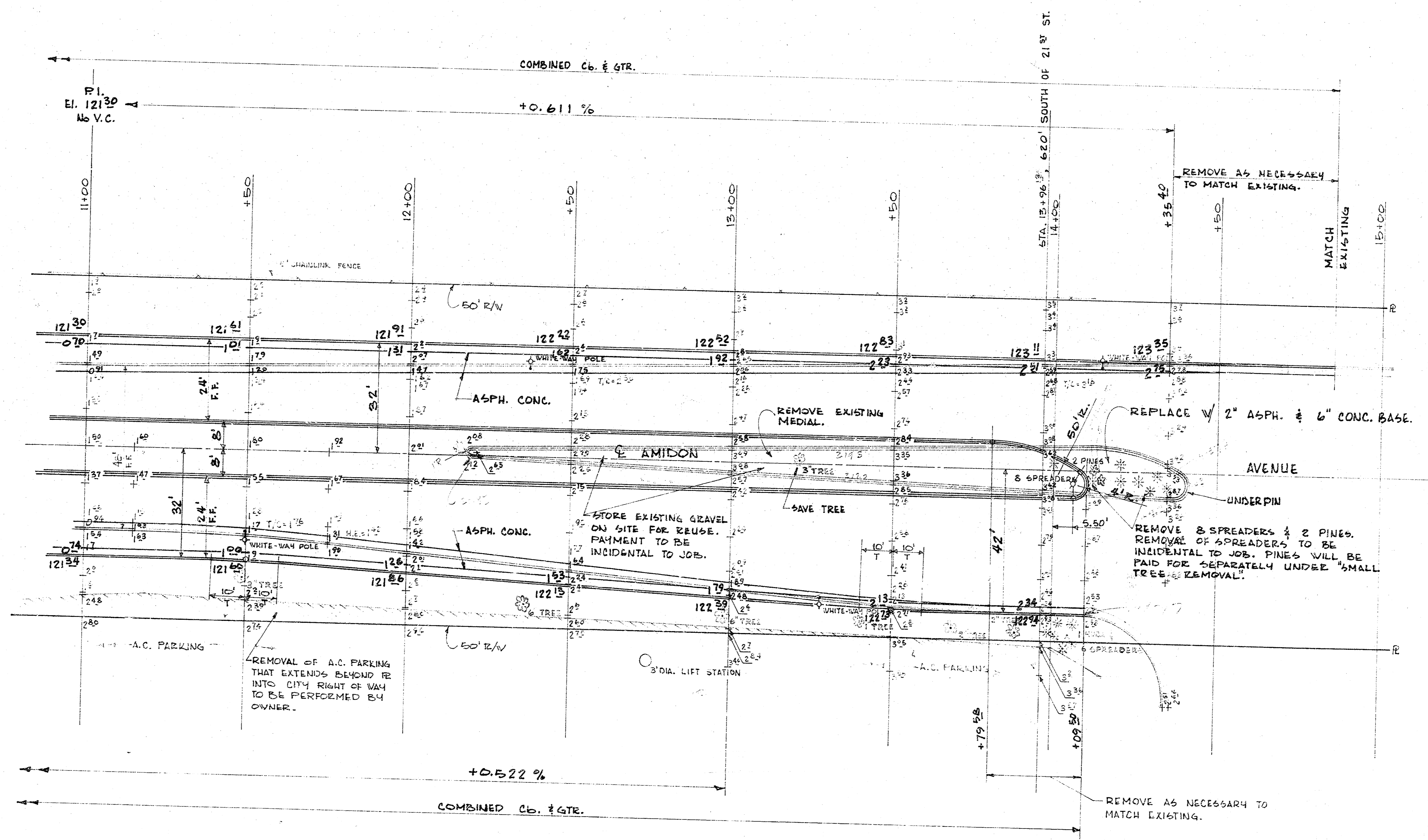

B.M. 127.93 CITY STD. DISC ON N.W. COR. RIVER BRIDGE ON AMIDON SOUTH OF 21ST ST.
 B.M. 123.51 1/2" D BOLT IN A.C. PVT. ON E AMIDON APPROX. 520' N. OF CTR. BRIDGE STA. 5+50.
 B.M. 123.76 "X" CUT E. END N. RAD. TO ENTRANCE @ CTR. TWIN LAKES SHOPPING CTR. ON AMIDON.

LEFT BASE LINE: 28' LEFT OR WEST OF L.
 RIGHT BASE LINE: 28' RIGHT OR EAST OF L.

AMIDON AVENUE WIDENING
 PROJECT No. C 18-61

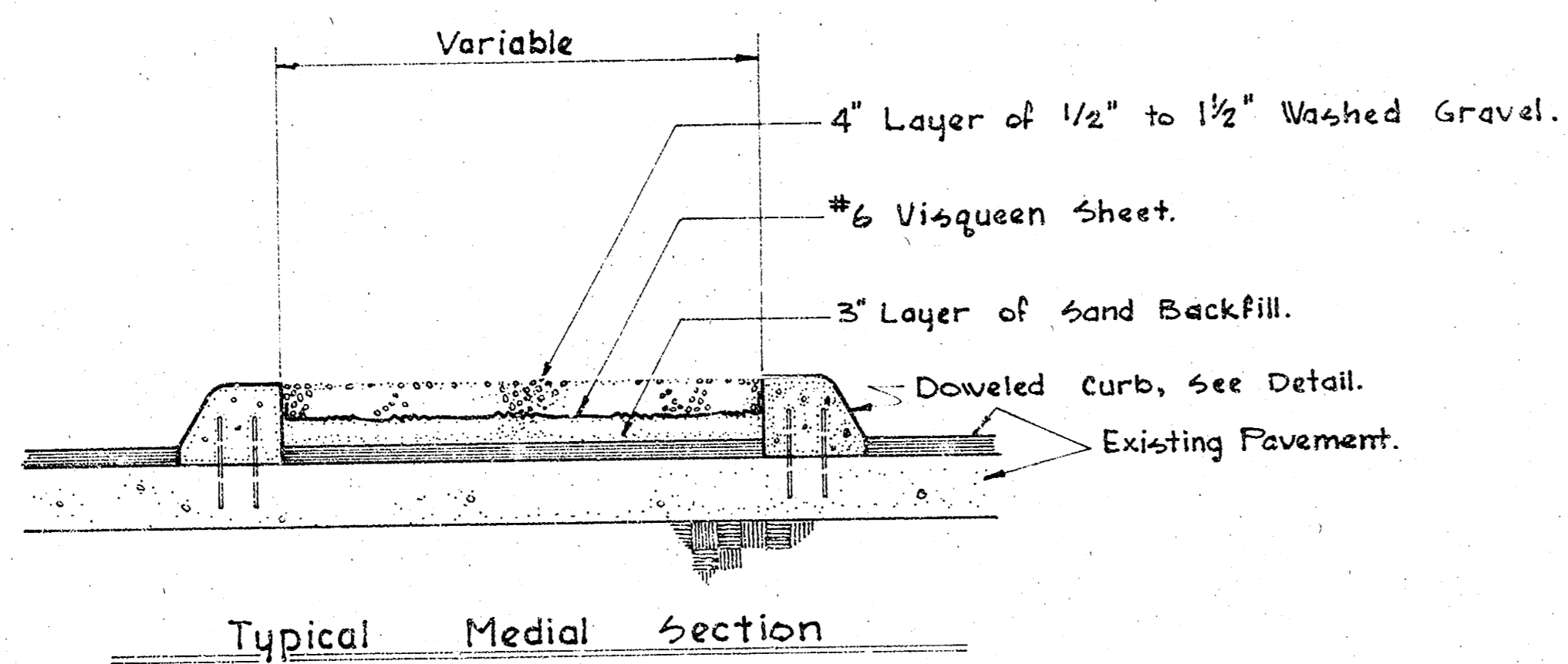

Scale: 1"=20'

General Note:

All medial dimensions are to face of curb unless noted otherwise.

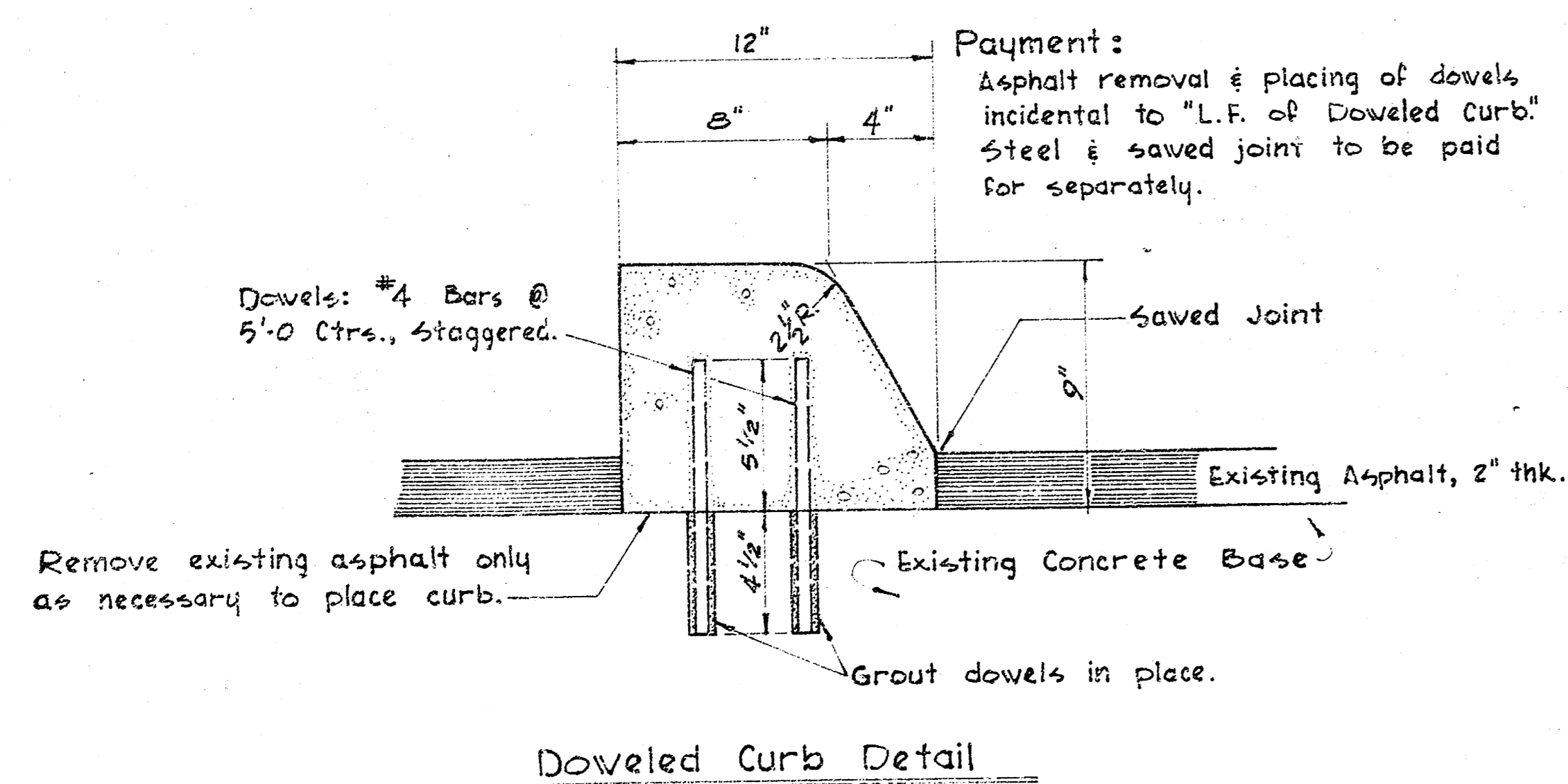
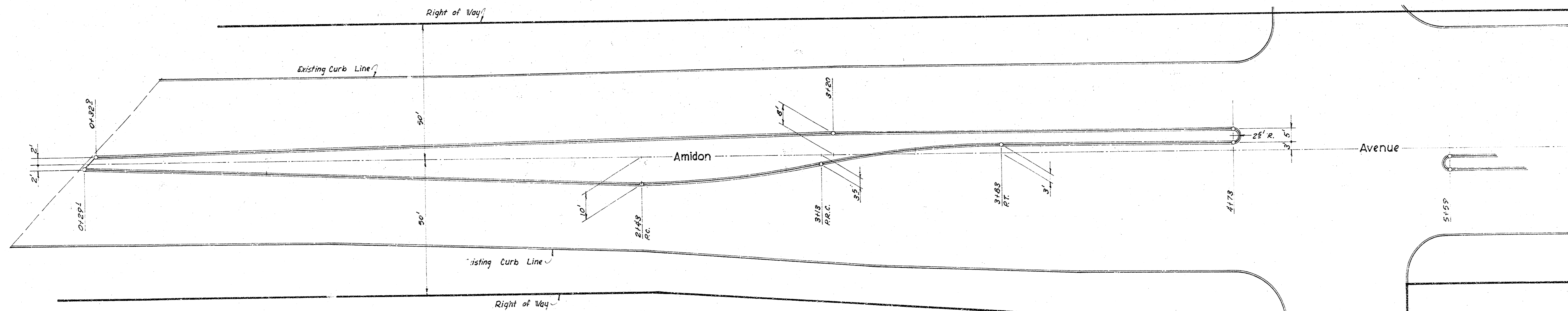

Curve Data for Reverse Curve:
 $A = 10^{\circ} 36' 36''$
 $T = 35.30'$
 $R = 380.17'$
 $ARC = 70.40'$
 $LC = 70.30'$
 $Min./ft. = 4.52133$

Sta.	Offset*	Sta.	Offset*
2+43 R.C.	10.00' Right	3+13 P.R.C.	3.50' Right
2+53	9.87' "	3+23	1.76' "
2+63	9.47' "	3+33	0.31' "
2+73	8.81' "	3+43	0.89' Left
2+83	7.89' "	3+53	1.81' "
2+93	6.69' "	3+63	2.47' "
3+03	5.24' "	3+73	2.87' "
3+13 P.R.C.	3.50' "	3+83 P.T.	3.00' "

*Dimensions from \mathcal{C} to face of curb.

Medial Revision for
 Amidon Avenue
 Bridge to 620' South of \mathcal{C} of 21st St.
 Project No. C18-61

Scale: 1" = 20'

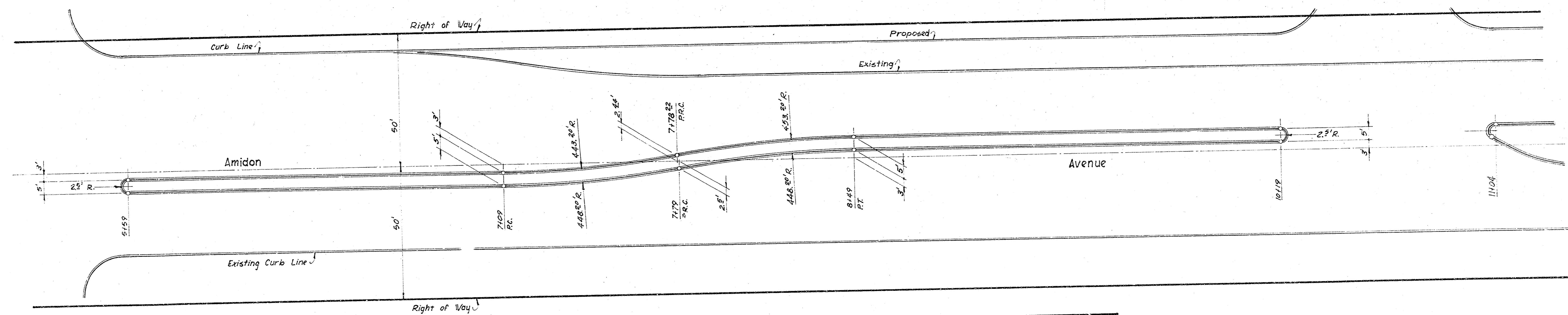

Curve Data for Reverse Curve (East curb of medial) :

	Sta.	Offset *	Sta.	Offset *
R = 448.20'	7+09 P.C.	8.00' Right	7+79 P.R.C.	2.50' Right
Δ = 8° 59' 06"	7+19	7.89' "	7+89	1.03' Right
T = 70.87'	7+29	7.56' "	7+99	0.20' Left
Arc = 70.29'	7+39	6.99' "	8+09	1.21' "
L.C. = 70.22'	7+49	6.21' "	8+19	1.99' "
Min./ft. = 3.83506	7+59	5.20' "	8+29	2.56' "
	7+69	3.97' "	8+39	2.89' "
	7+79 P.R.C.	2.50' "	8+49 P.T.	3.00' "

* Dimensions from C to face of curb.

Medial Revision for Amidon Avenue
Project No. C18-61

Scale: 1" = 20'

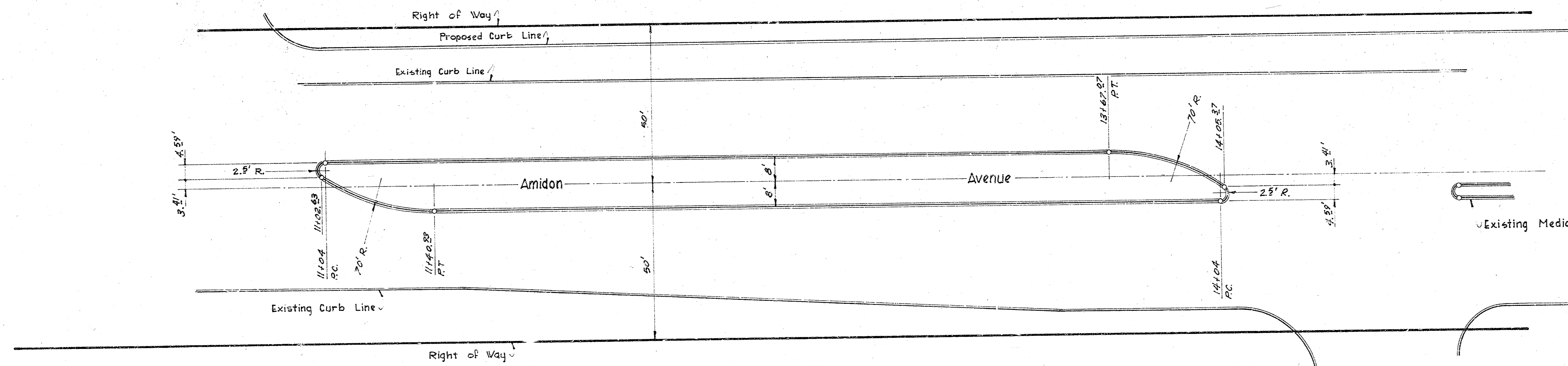

Medial Revision for Amidon Avenue
Project No. C18-61

Sheet 3R.