

BASELINE ON EAST R

B.M. 126.934 CITY STD. & BAKER 1/13TH
B.M. 130.60 N.E. COR. CONC. POLE No. 1355 N. ANNA ON S.W. COR. ANNA 1/13TH

No More Than 22'-20" Drives To Be Constructed On This Project.

$\Delta = 37.09' 00'' R = 231.99' T = 77.96' L = 150.41' LC = 147.80'$

CURVE DATA BASED ON $E = 1/2$ RAD. $\Delta = 113.430'$

STA	ARC	CHORD LENGTH	DEFLECTION	TOTAL DEFLECTION
		Δ OFF CHORD	Δ OFF CHORD	
0+90			0' 00" 30"	0' 00" 00"
1+00	10.00	9.70	1' 14" 26"	1' 14" 06"
1+30	3.90	3.78	0' 28" 53"	1' 42" 59"
1+25	21.10	20.44	16.27	2' 36" 20"
1+30	5.00	4.85	3.86	0' 37" 03"
1+50	20.00	19.39	15.43	2' 28" 11"
1+75	25.00	24.23	19.28	3' 05" 14"
2+00	25.00	24.23	19.28	3' 05" 14"
2+25	25.00	24.23	19.28	3' 05" 14"
2+40	15.41	14.94	11.89	1' 54" 11"

$\Delta = 37.09' 00'' R = 171.99' T = 57.80' L = 111.51' LC = 109.57'$

CURVE DATA BASED ON $E = 1/2$ RAD. $\Delta = 18.3630'$

STA	ARC	CHORD LENGTH	DEFLECTION	TOTAL DEFLECTION
		Δ OFF CHORD	Δ OFF CHORD	
2+40			0' 00" 00"	0' 00" 00"
2+50	9.59	9.98	12.54	1' 35" 51"
2+75	25.00	25.99	32.68	4' 09" 51"
3+00	25.00	25.99	32.68	4' 09" 51"
3+25	25.00	25.99	32.68	4' 09" 51"
3+38.12	13.12	13.45	17.16	2' 11" 07"
3+51.92	13.80	14.36	18.03	2' 17" 55"

SURVEY GRANITE EMBLEM COPIED FROM PLAN BY NEWELL BR. C.L.G. CO. BY NEWELL BR. C.L.G. CO.

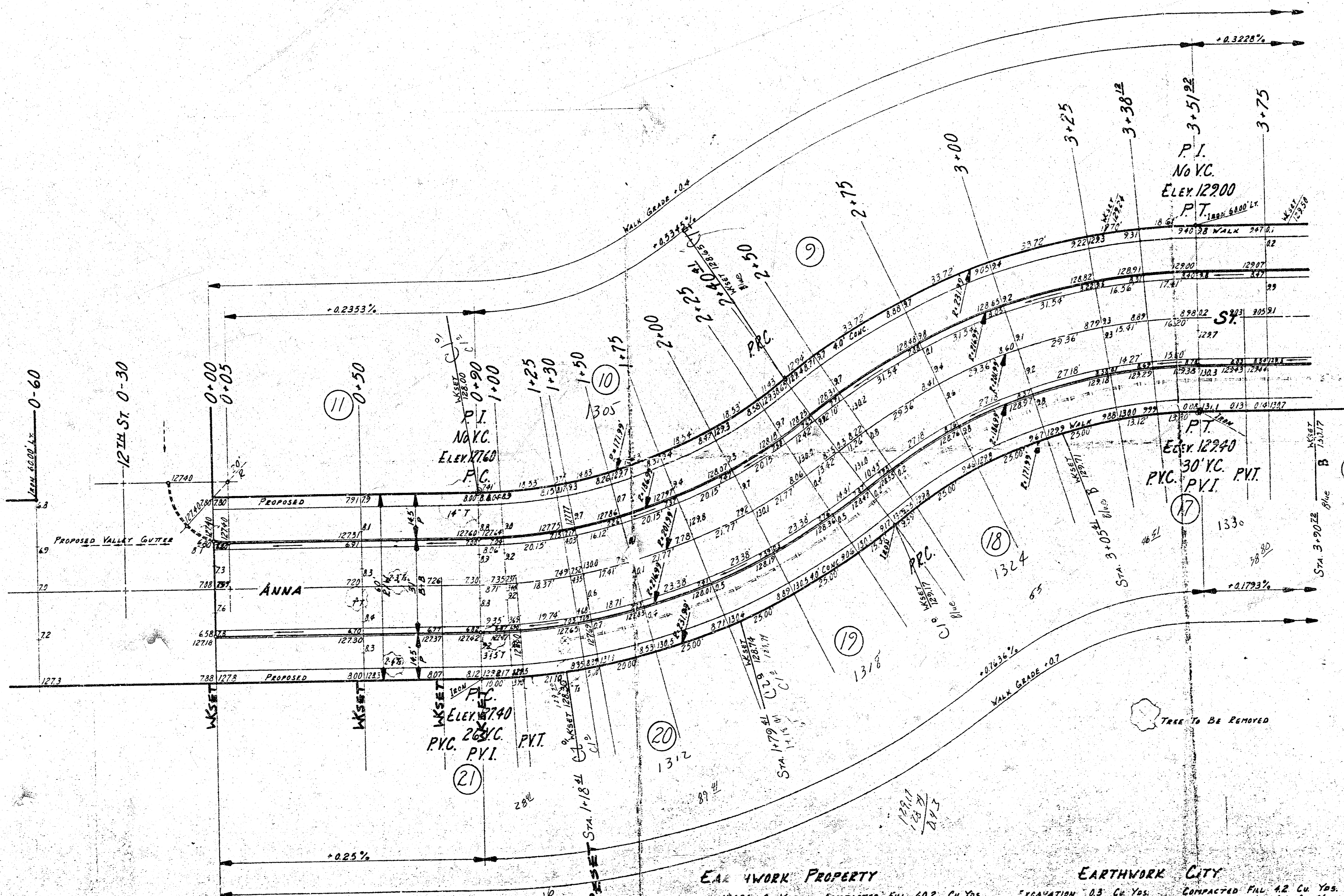

SCALE 1" = 20'

351
242
111

RETURN PRINT TO THIS OFFICE

SUB-GRADE
TYPE OF SUB-GRADE TREATMENT SHALL BE DETERMINED BY THE FIELD ENGINEER. SUB-GRADE TREATMENT MAY CONSIST OF LIME TREATMENT, CEMENT TREATMENT, SUB-GRADE MODIFICATION, OR ANY COMBINATION OF THESE.

NOTE TO FIELD ENGINEER & CONTRACTOR
GRADE PARKING AND CLEAR RIGHT-OF-WAY FOR PROPOSED SIDEWALK. COMPACT FILL IN SIDEWALK AREA TO BE CONSTRUCTED BY OTHERS.

E.A. WORK PROPERTY		EARTHWORK CITY	
EXCAVATION	175.9 Cu. Yds.	EXCAVATION	0.3 Cu. Yds.
+10%	175.9 Cu. Yds.	+10%	0.8 Cu. Yds.
TOTAL	175.9 Cu. Yds.	TOTAL	1.1 Cu. Yds.
		EXCAVATION	0.3 Cu. Yds.
		+10%	0.8 Cu. Yds.
		TOTAL	1.1 Cu. Yds.
		EXCAVATION	0.3 Cu. Yds.
		+10%	0.8 Cu. Yds.
		TOTAL	1.1 Cu. Yds.

MANIPULATION (6' LIFT) 2835.2 Sq. Yds.

ANNA STREET
ILL. 12TH ST. TO SL. 13TH ST.
26-2-30 ASPHALTIC CONCRETE
CITY OF WICHITA, KANSAS
R.W. LINN CITY ENGINEER
PROJECT NO. DAKS. 569004
DATE
2/16

FILMED FROM THE BEST AVAILABLE COPY.....