

DLX 105
 King
 Plummer
 Plummer

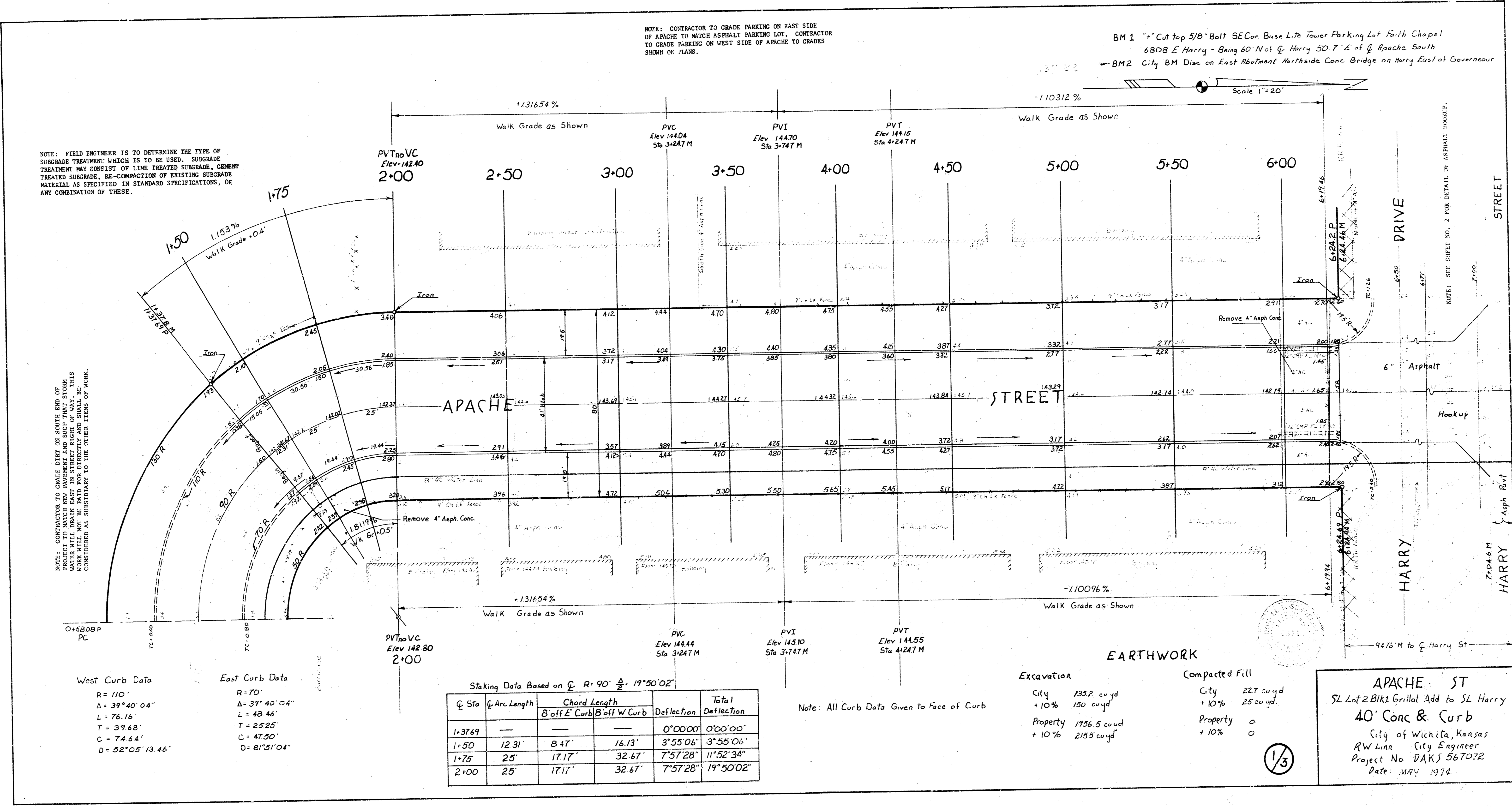

NOTE: FIELD ENGINEER IS TO DETERMINE THE TYPE OF SURGRADE TREATMENT WHICH IS TO BE USED. SURGRADE TREATMENT MAY CONSIST OF LIME TREATED SURGRADE, CEMENT TREATED SURGRADE, RE-CORRECTION OF EXISTING SURGRADE MATERIAL AS SPECIFIED IN STANDARD SPECIFICATIONS, OR ANY COMBINATION OF THESE.

NOTE: CONTRACTOR TO GRADE DIRT ON SOUTH END OF PROJECT TO MATCH NEIGHBORING DRIVE AND SUDY THAT STORM WORK WILL NOT BE PAID FOR DIRECTLY AND SHALL BE CONSIDERED AS SUBSIDIARY TO THE OTHER ITEMS OF WORK.

NOTE: CONTRACTOR TO GRADE PARKING ON EAST SIDE OF APACHE TO MATCH ASPHALT PARKING LOT. CONTRACTOR TO GRADE PARKING ON WEST SIDE OF APACHE TO GRADES SHOWN ON PLANS.

BM 1 "+ Cut top 5/8" Bolt SECor Base L to Tower Parking lot Faith Chapel
 6808 E Harry - Being 60' West of Harry 50.7' E of Apache South
 BM 2 City BM Disc on East Abutment Northside Conc Bridge on Harry East of Governor

West Curb Data
 R = 110'
 Δ = 39°40'04"
 L = 76.16'
 T = 39.68'
 C = 74.64'
 D = 52°05'13.46"

East Curb Data
 R = 70'
 Δ = 39°40'04"
 L = 48.46'
 T = 25.25'
 C = 47.00'
 D = 81°51'04"

Staking Data Based on $C, R=90', \frac{1}{2}, 19^{\circ}50'02''$

Sta	Chord Length	8 off E Curb	8 off W Curb	Deflection	Total Deflection
1+37.69	—	—	—	0°00'00"	0°00'00"
1+50	12.31'	8.47'	16.13'	3°55'06"	3°55'06"
1+75	25'	17.17'	32.67'	7°57'28"	11°52'34"
2+00	25'	17.17'	32.67'	7°57'28"	19°50'02"

Note: All Curb Data Given to Face of Curb

Excavation
 City 135.2 cu yd
 + 10% 150 cu yd
 Property 195.5 cu yd
 + 10% 215.0 cu yd

Compacted Fill
 City 227 cu yd
 + 10% 250 cu yd
 Property 0
 + 10% 0

APACHE ST
 SL Lot 2 Blk 1 Griddle Add to SL Harry
 40' Conc & Curb
 City of Wichita, Kansas
 RW Linn City Engineer
 Project No DAKJ 567032
 Date MAY 1974

1/3

MEASURED QUANTITIES FOR FINAL ESTIMATES ON PAVING

STATION	ITEM	QUANTITY	UNIT	PRICE	TOTAL
0+00	1.00	1.00	cu yd	1.00	1.00
1+00	1.00	1.00	cu yd	1.00	1.00
2+00	1.00	1.00	cu yd	1.00	1.00
3+00	1.00	1.00	cu yd	1.00	1.00
4+00	1.00	1.00	cu yd	1.00	1.00
5+00	1.00	1.00	cu yd	1.00	1.00
6+00	1.00	1.00	cu yd	1.00	1.00
7+00	1.00	1.00	cu yd	1.00	1.00
8+00	1.00	1.00	cu yd	1.00	1.00
9+00	1.00	1.00	cu yd	1.00	1.00
10+00	1.00	1.00	cu yd	1.00	1.00
11+00	1.00	1.00	cu yd	1.00	1.00
12+00	1.00	1.00	cu yd	1.00	1.00
13+00	1.00	1.00	cu yd	1.00	1.00
14+00	1.00	1.00	cu yd	1.00	1.00
15+00	1.00	1.00	cu yd	1.00	1.00
16+00	1.00	1.00	cu yd	1.00	1.00
17+00	1.00	1.00	cu yd	1.00	1.00
18+00	1.00	1.00	cu yd	1.00	1.00
19+00	1.00	1.00	cu yd	1.00	1.00
20+00	1.00	1.00	cu yd	1.00	1.00
21+00	1.00	1.00	cu yd	1.00	1.00
22+00	1.00	1.00	cu yd	1.00	1.00
23+00	1.00	1.00	cu yd	1.00	1.00
24+00	1.00	1.00	cu yd	1.00	1.00
25+00	1.00	1.00	cu yd	1.00	1.00
26+00	1.00	1.00	cu yd	1.00	1.00
27+00	1.00	1.00	cu yd	1.00	1.00
28+00	1.00	1.00	cu yd	1.00	1.00
29+00	1.00	1.00	cu yd	1.00	1.00
30+00	1.00	1.00	cu yd	1.00	1.00
31+00	1.00	1.00	cu yd	1.00	1.00
32+00	1.00	1.00	cu yd	1.00	1.00
33+00	1.00	1.00	cu yd	1.00	1.00
34+00	1.00	1.00	cu yd	1.00	1.00
35+00	1.00	1.00	cu yd	1.00	1.00
36+00	1.00	1.00	cu yd	1.00	1.00
37+00	1.00	1.00	cu yd	1.00	1.00
38+00	1.00	1.00	cu yd	1.00	1.00
39+00	1.00	1.00	cu yd	1.00	1.00
40+00	1.00	1.00	cu yd	1.00	1.00
41+00	1.00	1.00	cu yd	1.00	1.00
42+00	1.00	1.00	cu yd	1.00	1.00
43+00	1.00	1.00	cu yd	1.00	1.00
44+00	1.00	1.00	cu yd	1.00	1.00
45+00	1.00	1.00	cu yd	1.00	1.00
46+00	1.00	1.00	cu yd	1.00	1.00
47+00	1.00	1.00	cu yd	1.00	1.00
48+00	1.00	1.00	cu yd	1.00	1.00
49+00	1.00	1.00	cu yd	1.00	1.00
50+00	1.00	1.00	cu yd	1.00	1.00
51+00	1.00	1.00	cu yd	1.00	1.00
52+00	1.00	1.00	cu yd	1.00	1.00
53+00	1.00	1.00	cu yd	1.00	1.00
54+00	1.00	1.00	cu yd	1.00	1.00
55+00	1.00	1.00	cu yd	1.00	1.00
56+00	1.00	1.00	cu yd	1.00	1.00
57+00	1.00	1.00	cu yd	1.00	1.00
58+00	1.00	1.00	cu yd	1.00	1.00
59+00	1.00	1.00	cu yd	1.00	1.00
60+00	1.00	1.00	cu yd	1.00	1.00
61+00	1.00	1.00	cu yd	1.00	1.00
62+00	1.00	1.00	cu yd	1.00	1.00
63+00	1.00	1.00	cu yd	1.00	1.00
64+00	1.00	1.00	cu yd	1.00	1.00
65+00	1.00	1.00	cu yd	1.00	1.00
66+00	1.00	1.00	cu yd	1.00	1.00
67+00	1.00	1.00	cu yd	1.00	1.00
68+00	1.00	1.00	cu yd	1.00	1.00
69+00	1.00	1.00	cu yd	1.00	1.00
70+00	1.00	1.00	cu yd	1.00	1.00
71+00	1.00	1.00	cu yd	1.00	1.00
72+00	1.00	1.00	cu yd	1.00	1.00
73+00	1.00	1.00	cu yd	1.00	1.00
74+00	1.00	1.00	cu yd	1.00	1.00
75+00	1.00	1.00	cu yd	1.00	1.00
76+00	1.00	1.00	cu yd	1.00	1.00
77+00	1.00	1.00	cu yd	1.00	1.00
78+00	1.00	1.00	cu yd	1.00	1.00
79+00	1.00	1.00	cu yd	1.00	1.00
80+00	1.00	1.00	cu yd	1.00	1.00
81+00	1.00	1.00	cu yd	1.00	1.00
82+00	1.00	1.00	cu yd	1.00	1.00
83+00	1.00	1.00	cu yd	1.00	1.00
84+00	1.00	1.00	cu yd	1.00	1.00
85+00	1.00	1.00	cu yd	1.00	1.00
86+00	1.00	1.00	cu yd	1.00	1.00
87+00	1.00	1.00	cu yd	1.00	1.00
88+00	1.00	1.00	cu yd	1.00	1.00
89+00	1.00	1.00	cu yd	1.00	1.00
90+00	1.00	1.00	cu yd	1.00	1.00
91+00	1.00	1.00	cu yd	1.00	1.00
92+00	1.00	1.00	cu yd	1.00	1.00
93+00	1.00	1.00	cu yd	1.00	1.00
94+00	1.00	1.00	cu yd	1.00	1.00
95+00	1.00	1.00	cu yd	1.00	1.00
96+00	1.00	1.00	cu yd	1.00	1.00
97+00	1.00	1.00	cu yd	1.00	1.00
98+00	1.00	1.00	cu yd	1.00	1.00
99+00	1.00	1.00	cu yd	1.00	1.00
100+00	1.00	1.00	cu yd	1.00	1.00

BM 1 1/2" Cut top 3/8" Bolt SE Cor. Base L. To Tower Parking Lot Faith Chapel
 6808 E Harry - Being 60' N of Q. Harry 50' E of Q. Apache South.
 BM 2 City BM Disc on East Abutment Northside Conc Bridge on Harry East of Governour

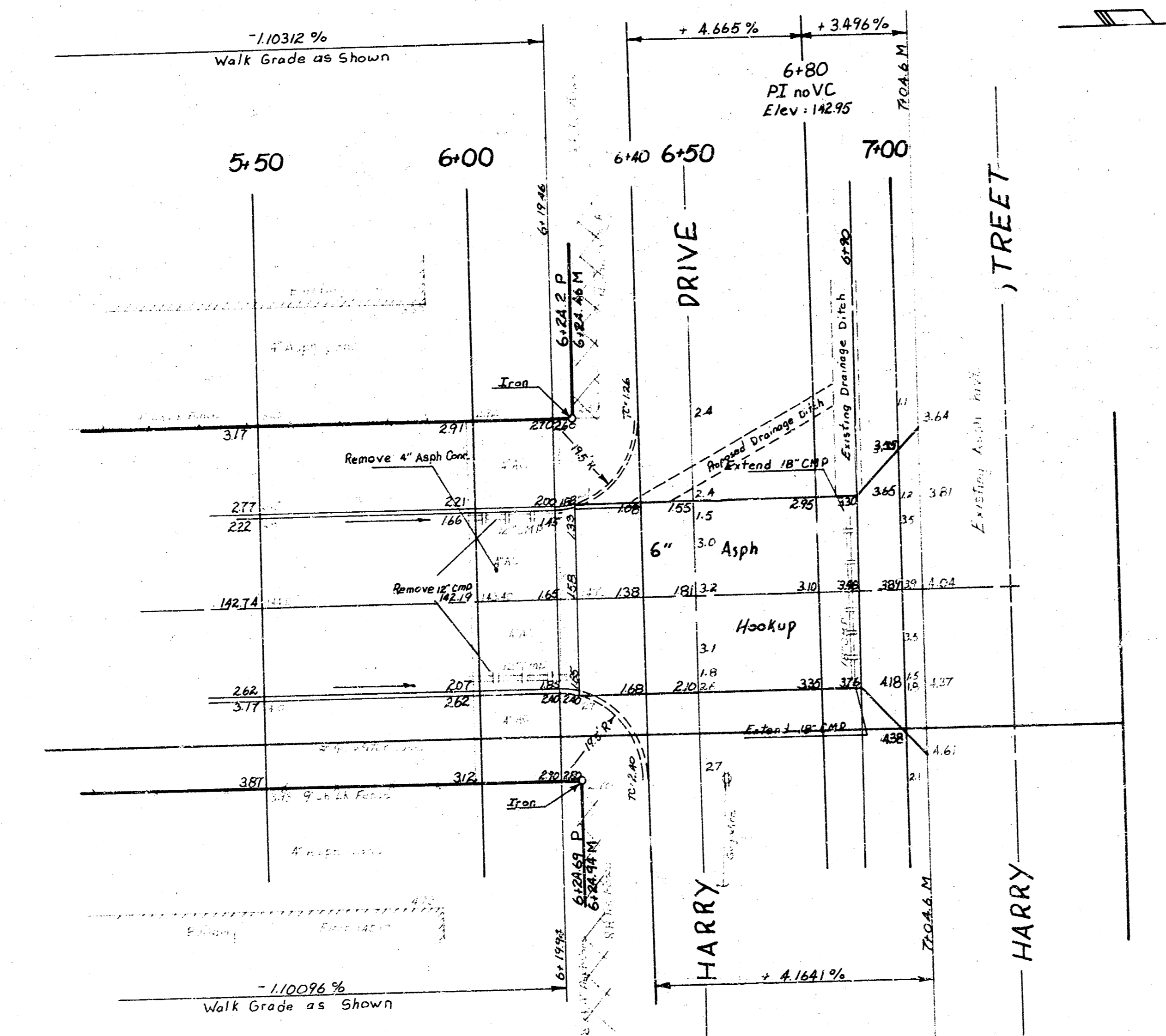

Note: Construct 6" Asphalt Curb on West side of Asphalt Hookup between Sta. 6+24.46 & Sta. 6+40. All costs for Constructing 6" Asphalt Curb shall be paid for by the Ton of asphalt.

Note: Construct drainage ditch from Sta. 6+40 to existing drainage ditch as shown. Cost shall be incidental to project.

Note: Extend existing 18" CMP of Sta. 6+87.8 to 2' beyond edge of 6" Asphalt hookup and install end sections. End sections to be paid for as linear ft. of pipe.

Detail of 6" Asphalt Hookup in Connection with
 APACHE ST
 S.L. Lot 2 BIKI Gravel 4' to S.L. Harry