

NOTE: CONTRACTOR TO GRADE PARKING ON EAST SIDE OF APACHE TO MATCH ASPHALT PARKING LOT. CONTRACTOR TO GRADE PARKING ON WEST SIDE OF APACHE TO GRADES SHOWN ON PLANS.

BM 1 "+ Cut top 5/8" Bolt SE Cor. Base Lite Tower Parking Lot Faith Chapel
6808 E Harry - Being 60' N of Q Harry 50.7' E of Q Apache South.
BM 2 City BM Disc on East Abutment Northside Conc Bridge on Harry East of Governour

NOTE: FIELD ENGINEER IS TO DETERMINE THE TYPE OF SUBGRADE TREATMENT WHICH IS TO BE USED. SUBGRADE TREATMENT MAY CONSIST OF LIME TREATED SUBGRADE, CEMENT TREATED SUBGRADE, RE-COMPACTION OF EXISTING SUBGRADE MATERIAL AS SPECIFIED IN STANDARD SPECIFICATIONS, OR ANY COMBINATION OF THESE.

NOTE: CONTRACTOR TO GRADE DIRT ON SOUTH END OF PROJECT TO MATCH NEW PAVEMENT AND SUCH THAT STORM WATER WILL DRAIN EAST IN STREET RIGHT OF WAY. THIS WORK WILL NOT BE PAID FOR DIRECTLY AND SHALL BE CONSIDERED AS SUBSIDIARY TO THE OTHER ITEMS OF WORK.

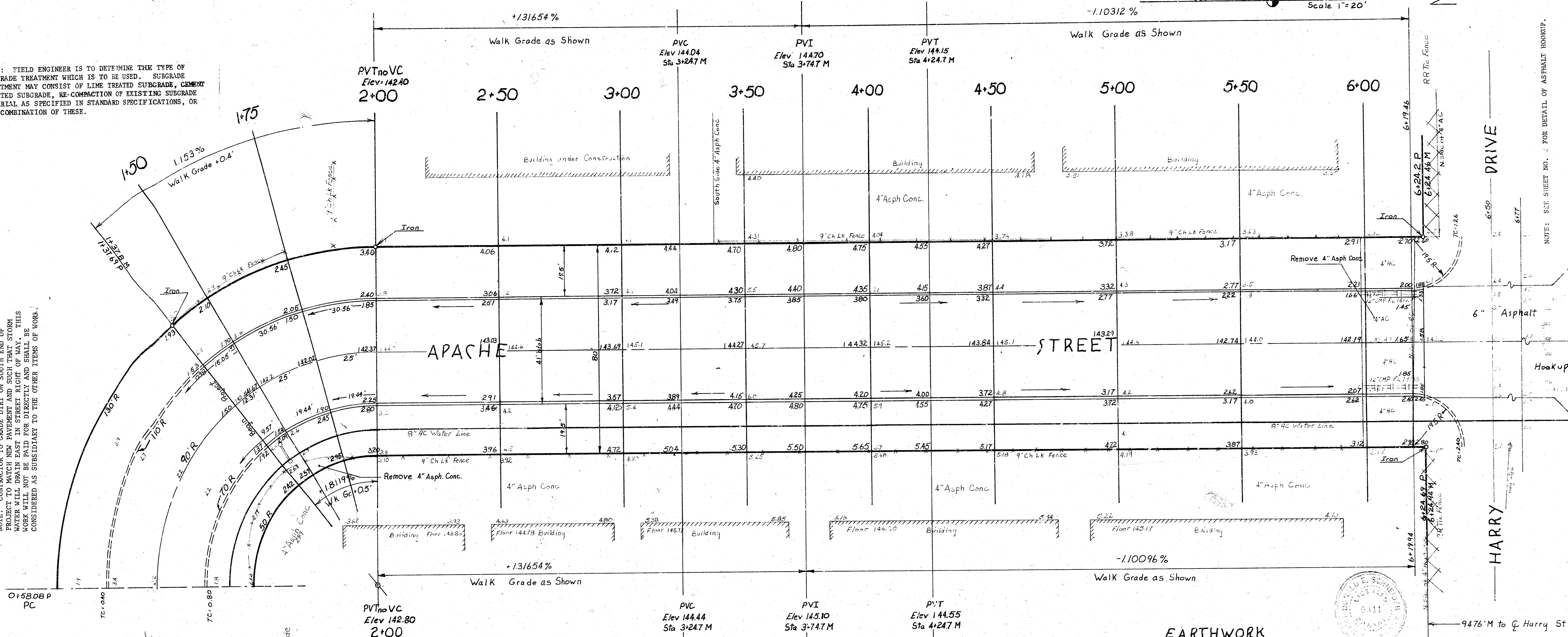

West Curb Data
R = 110'
Δ = 39° 40' 04"
L = 76.16'
T = 39.68'
C = 74.64'
D = 52° 05' 13.46"

East Curb Data
R = 70'
Δ = 39° 40' 04"
L = 48.46'
T = 25.25'
C = 47.50'
D = 81° 51' 04"

Staking Data Based on $Q R = 90' \frac{A}{2} = 19° 50' 02''$

Q Sta	Q Arc Length	Chord Length		Deflection	Total Deflection
		8' off E Curb	8' off W Curb		
1+37.69	---	---	---	0° 00' 00"	0° 00' 00"
1+50	12.31'	8.47'	16.13'	3° 55' 06"	3° 55' 06"
1+75	25'	17.17'	32.67'	7° 57' 28"	11° 52' 34"
2+00	25'	17.17'	32.67'	7° 57' 28"	5° 00' 02"

Note: All Curb Data Given to Face of Curb

EARTHWORK

Excavation	Compacted Fill
City 135.2 cu yd	City 22.7 cu yd
+ 10% 150 cu yd	+ 10% 25 cu yd
Property 1956.5 cu yd	Property 0
+ 10% 2155 cu yd	+ 10% 0

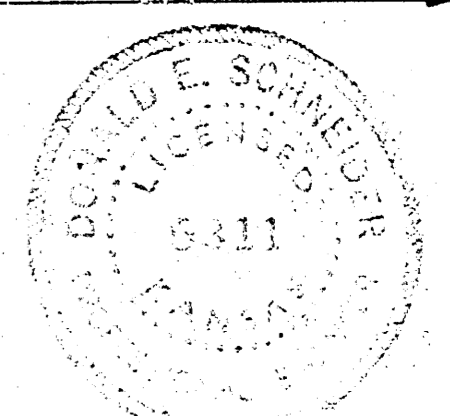

APACHE ST
SL Lot 2 B1K1 Grillo Add to SL Harry
40' Conc & Curb
City of Wichita, Kansas
RW Linn City Engineer
Project No. DAKS 567072
Date: MAY 1974

1/3

NOTE: SEE SHEET NO. 1 FOR DETAIL OF ASPHALT HOOKUP.

BM 1: "x" Cut top 5/8" Bolt SE Cor. Base Lite Tower Parking Lot Faith Chapel
 6808 E Harry - Being 60' N of Q Harry 50.7' E of Q Apache South.
 BM 2: City BM Disc on East Abutment Northside Conc Bridge on Harry East of Governor

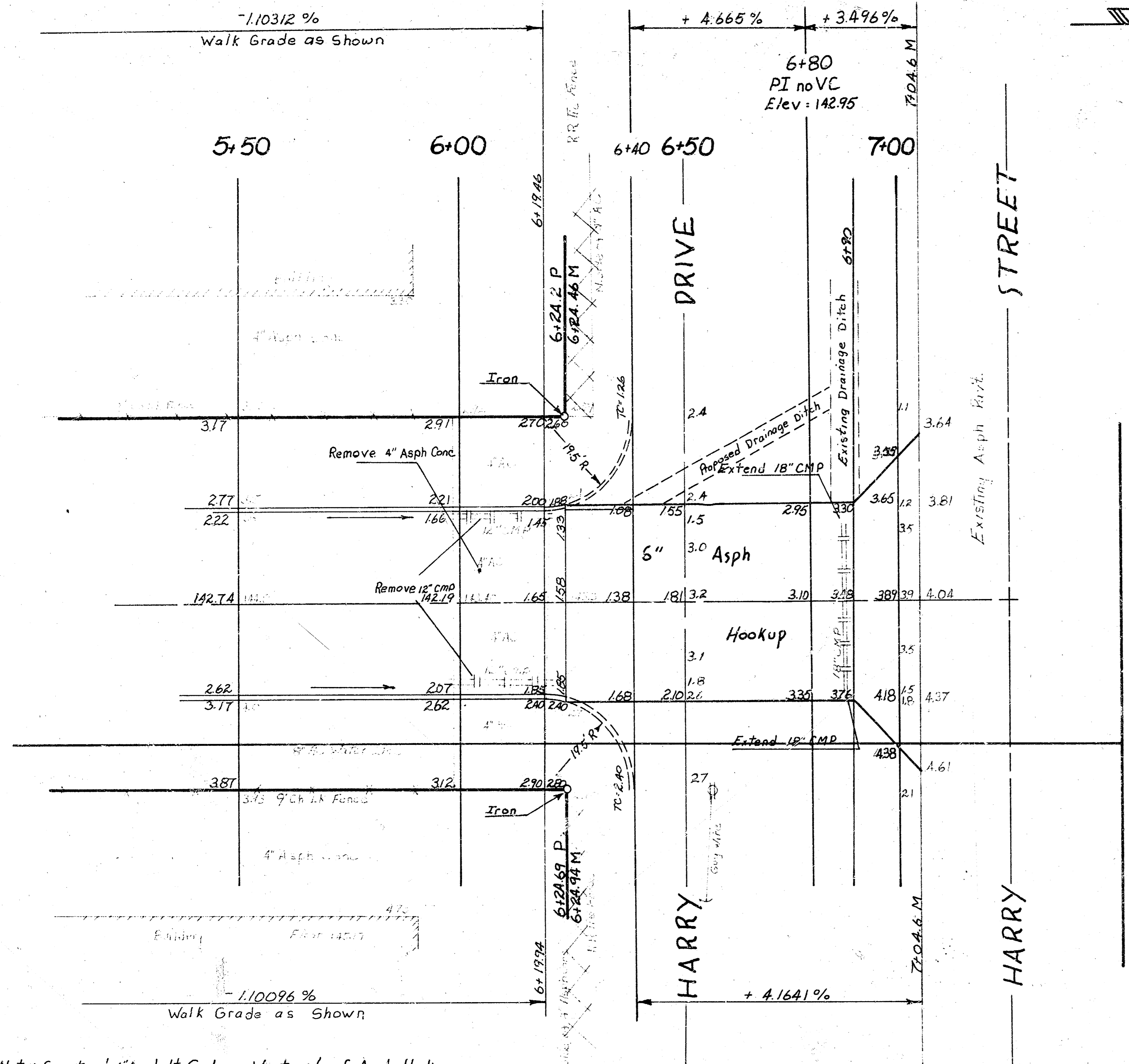
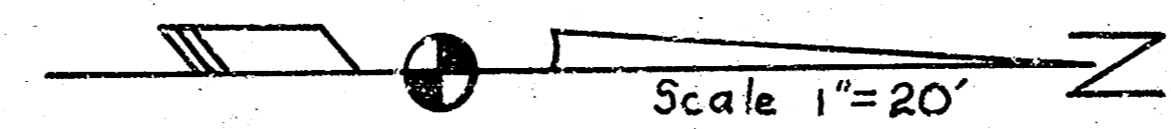

- Note: Construct 6" Asphalt Curb on West side of Asph Hookup between Sta. 6+24.46 & Sta 6+40. All costs for Constructing 6" Asph. Curb shall be paid for by the ton of asphalt.
- Note: Construct drainage ditch from Sta 6+40 to Existing drainage ditch as shown. Cost shall be incidental to project.
- Note: Extend existing 18" CMP at Sta 6+87.8 to 2' beyond edge of 6" Asph hookup and Install end sections. End sections to be paid for as linear ft. of pipe

Detail of 6" Asphalt Hookup in Connection
APACHE ST
 SL Lot 2 BIK1 Grillo Add to SL H