

B.M. 113.76 T in Troy Top Fire Hy. S.W. Cor. Pratt & Murdock

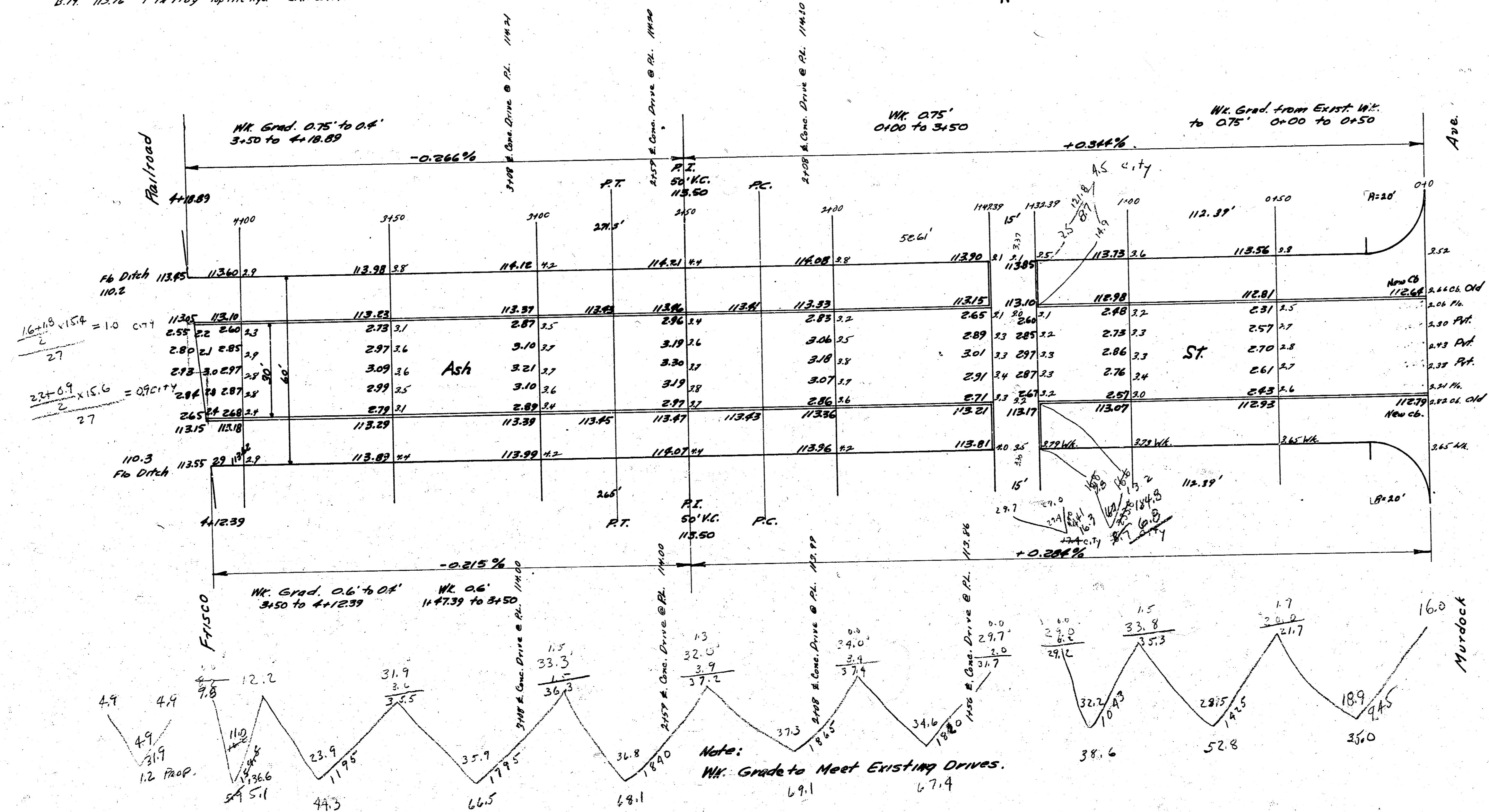

$\frac{16+10 \times 15.4}{27} = 10$   
 $\frac{27+0.9 \times 15.6}{27} = 0.9$

Prop. 12	2.74
5.1	4.5
	18.7
	16.5
	18.1
	30.6
	10.9
	38.6
	32.8
	35.0
	33.7 cu. yds.
4477.448.1	10
+1070	6.1
492.5 cu. yds.	16.3
	6.8
	4.5
	29.5 cu. yds. City

Ash St  
 N.L. Frisco & S.L. Murdock  
 90' Conc. & Cb.  
 City of Wichita, Kansas  
 L.M. White City Engineer  
 January 1999 Project 018-177